

103619 | FIRA

UNDERMOUNT WITH APRON FRONT FIRECLAY KITCHEN SINK WITH ACCESSORY LEDGE

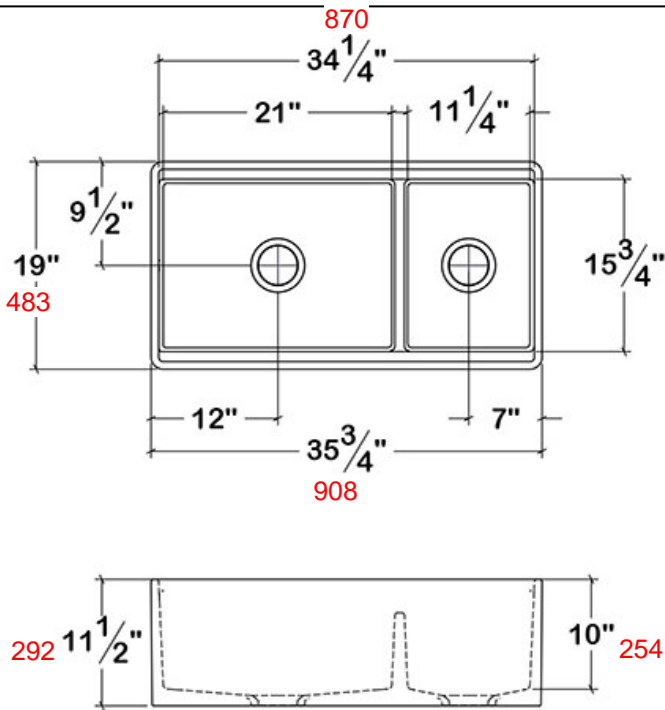

Specifications

Model	103619
Collection	Fira
Bowls dimensions	L 21" × 15 3/4" × 10" R 11 1/4" × 15 3/4" × 10"
Overall dimensions	35 3/4" × 19" × 11 1/2"
Recommended cabinet	39"

Recommended accessories

Drain	100080
Grid (coming soon)	200942
Grid (coming soon)	200943
Colander	205038
Bin	205039
Tray	205041
Cutting board	210060
Drying Rack	215009

Features

- Designed in Canada
- Integrated accessory ledge to sit full range of accessories
- Includes a 12-3/4" wide solid walnut cutting board
- Flat apron front design
- Two deep 10" bowls and 3/4" thick walls for optimized work space
- Product dimensional variability ±3/16", due to manufacturing process
- Made of fireclay and glazed on all sides, white gloss finish
- Two center 3-1/2" drains
- Sloped bottom for maximized drainage
- Waste disposal unit compatible, recommended to confirm waste disposal or drain maximal thickness specifications
- No template provided, recommended to have the sink on hand for final sizing of cabinet and countertop
- ASME A112.19.2/CSA B45.1

Warranty

Home Refinements offers a 1-YEAR LIMITED WARRANTY against manufacturing defects and a 10-YEAR LIMITED WARRANTY on fading/staining issues on its fireclay sinks. For further details on our product warranty, please refer to our catalog or Web site.

G 7966 SCVi 24" Fully Integrated Dishwasher K2o

Features:

- AutoDos - an integrated automatic detergent dispensing system
- M Touch Vi Controls - an intuitive touch display
- QuickIntenseWash - a full wash and dry cycle in 58 minutes
- 40 dBa (38 dBa when using ExtraQuiet)
- 3D MultiFlex Cutlery Tray
- Panel-Ready
- WifiConn@ct
- Knock2Open
- Water Softener
- EnergyStar

MATERIAL

11388300



SPECIFICATIONS

Overall Unit Dimensions	23 ⁹ / ₁₆ " (598 mm) W x 33 ¹¹ / ₁₆ " - 36 ¹ / ₄ " (855 - 920 mm) H x 22 ⁷ / ₁₆ " (570 mm) D [Depth does not include door panel]
Niche	
Minimum Cabinet Niche Opening	23 ⁵ / ₈ " (600 mm) W x 33 ³ / ₄ " (857 mm) H x 22 ⁷ / ₁₆ " (570 mm) D
Plumbing	
Water Supply Requirements	<ul style="list-style-type: none"> • Cold or Hot (max 150°F/65°C) water connection • Male 3/8" compression fitting • Water pressure range 7.25 psi (0.5 bar) and 145 psi (10 bar)
Water Connection Line (Supplied)	Length: 5 ft (1.5 m) Female 3/8" compression.
Drain Hose (Supplied)	Length: 5 ft (1.5 m) 7/8" (22 mm) internal diameter
Electrical	
Electrical Requirements	110V / 120V, 60Hz, 15 Amps
Power Cord (Convertible to hardwire)	NEMA 5-15 plug, 5 ft (1.52 m)
Shipping	
Shipping Weight	121 lbs (55 kg)
Shipping Dimensions	27 ¹ / ₈ " W x 38 ¹ / ₈ " H x 26 ³ / ₈ " D

PRODUCT DIMENSIONS

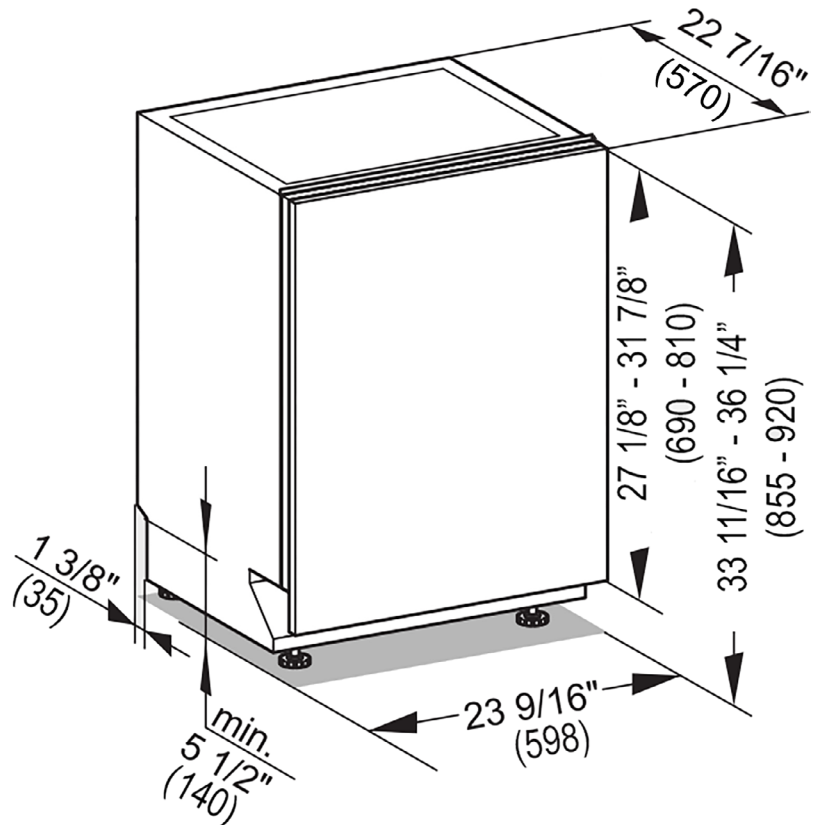

CUTOUT DIMENSIONS

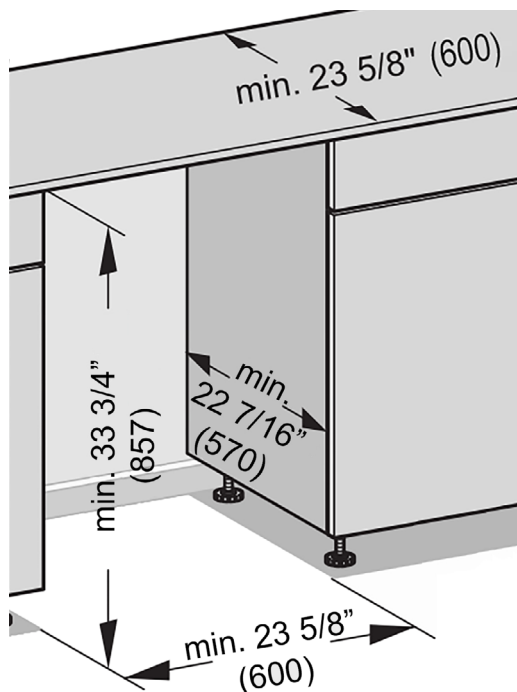

CUSTOM PANEL

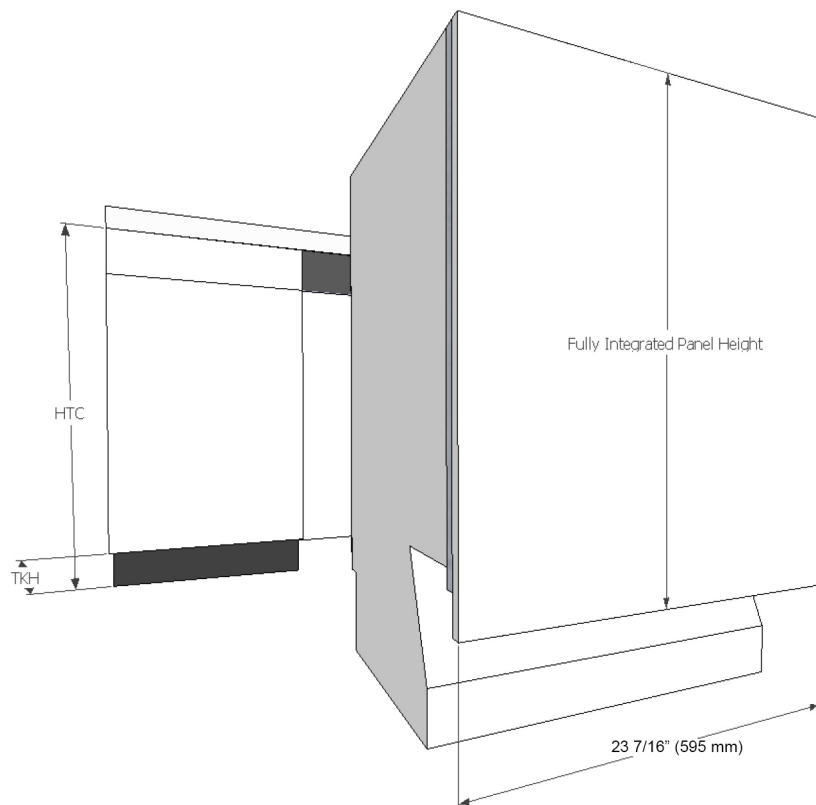

Width: 23 7/16" (595 mm) in all Cases
Thickness: 3/4" (19 mm) in all Cases
Height: Determined using the following calculation:

$$\text{Panel Height} = \text{HTC} - \text{TKH}$$

HTC = Height to the underside of countertop
TKH = Toe kick height

Note: Control panel is along the top edge of the unit. It is not visible when the unit is closed. A handle **MUST** be located on front of panel in order to open unit. (Except K2o models).

Maximum panel height: 31 7/8" (810 mm)

Minimum panel height: 27 1/8" (690 mm)

Maximum panel weight: 24 lbs (11 kg)

Fully Integrated 36" MasterCool

#KF2901Vi

CUTOUT DIMENSIONS

- Niche depth assumes a 3/4" (19 mm) panel, please adjust according to custom panel thickness

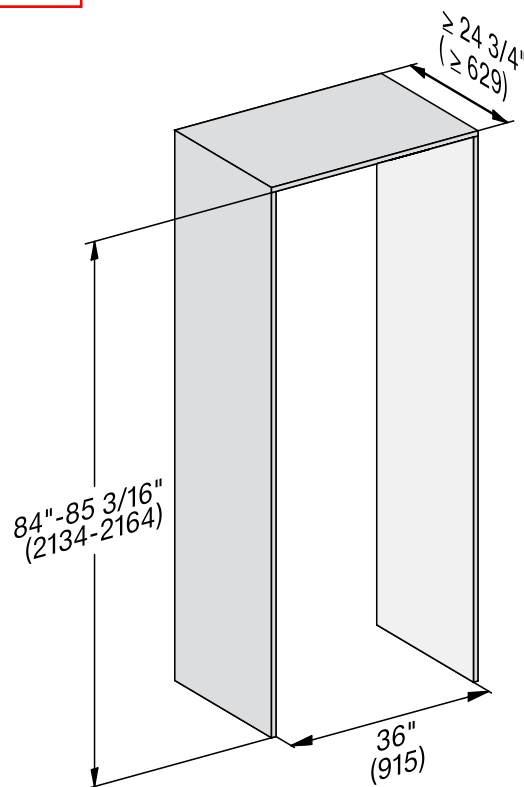

CUTOUT DETAILS

- The electrical connection must not be positioned higher than 9" (228.6 mm) above the floor.

For All Freezers and Bottom Mount units only:

- The 1/4" (6.4 mm) plumbed water connection should not be positioned higher than 2" (50.8 mm) above the floor.

Notes:

In case of an emergency the electrical outlet and water shutoff must be easily accessible and must not be concealed behind the appliance.

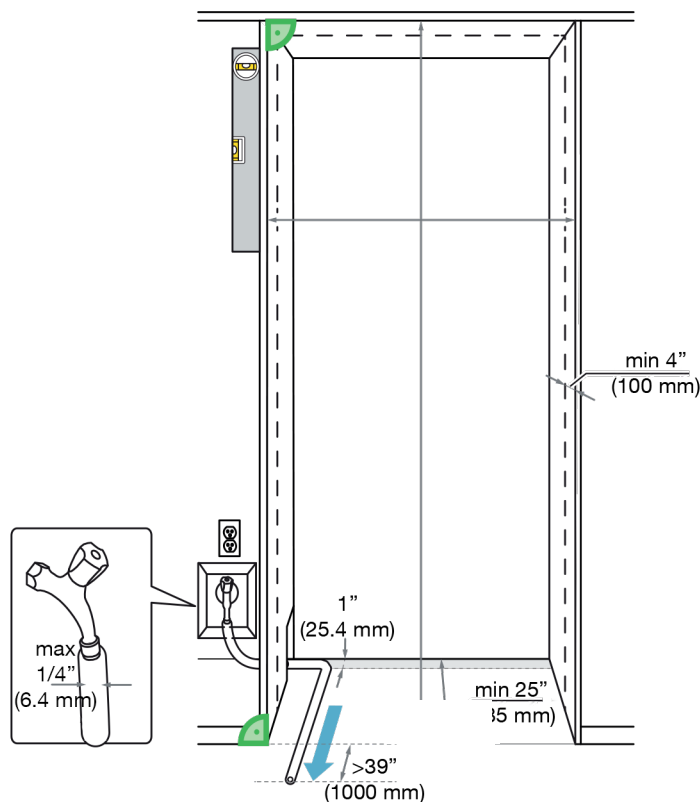

Fully Integrated 36" MasterCool

#KF2901Vi

ELECTRICAL AND WATER CONNECTION

(Water Connection For F 29x1 Vi & KF 29x1 Vi Only)

Rear View

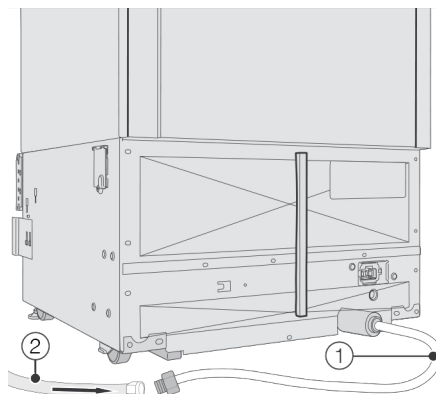

Water Connection:

- 1/4" water line is required
- Located at the rear of the appliance on a 4' 11" line.
- 1/4" compression fitting, ready to accept 1/4" line.

Side View

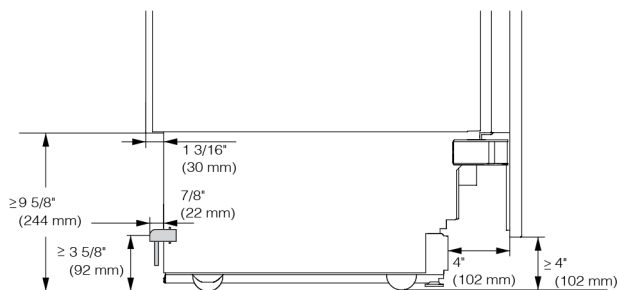

Notes:

- In case of an emergency the electrical outlet and water shutoff must be easily accessible and must not be concealed behind the appliance.
- In the event that connection points are located behind the unit the electrical outlet and water connection should be located no higher than 9 5/8" from the floor.

Fully Integrated 36" MasterCool

#KF2901Vi

CUSTOM PANEL DETAILS

For Models:

- F 2901 Vi • F 2911 Vi
- K 2901 Vi • K 2911 Vi

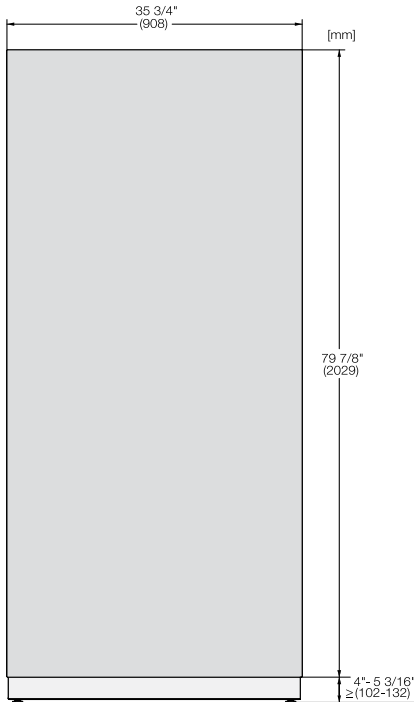

Max. Panel Weight:
F 29x1 Vi - 68;bs
K 29x1 Vi - 106 lbs

Optional Accessory:
Clean Touch Steel Panel:
• KFP 3605
Material# 11499100

For Models:

- KF 2901 Vi • KF 2911 Vi

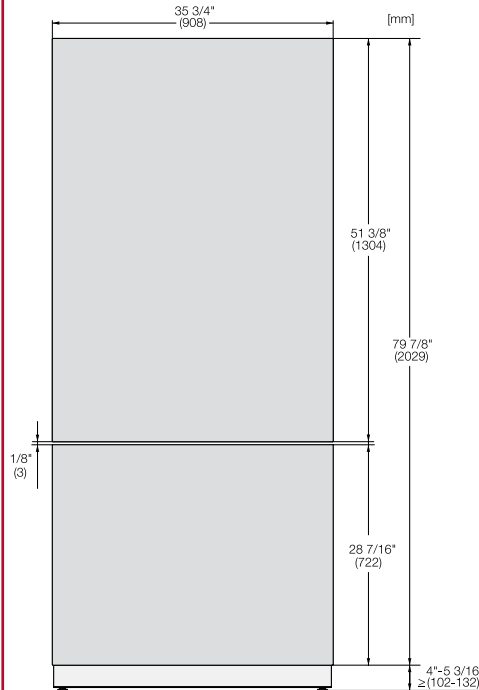

Max. Top Panel Weight: 86 lbs
Max. Bottom Panel Weight: 19 lbs

Optional Accessory:
Clean Touch Steel Panel:
• KFP 3615 - Top Panel
Material# 11499140
• KFP 3625 - Bottom Panel
Material# 11499150

For Models:

- KF 2981 Vi

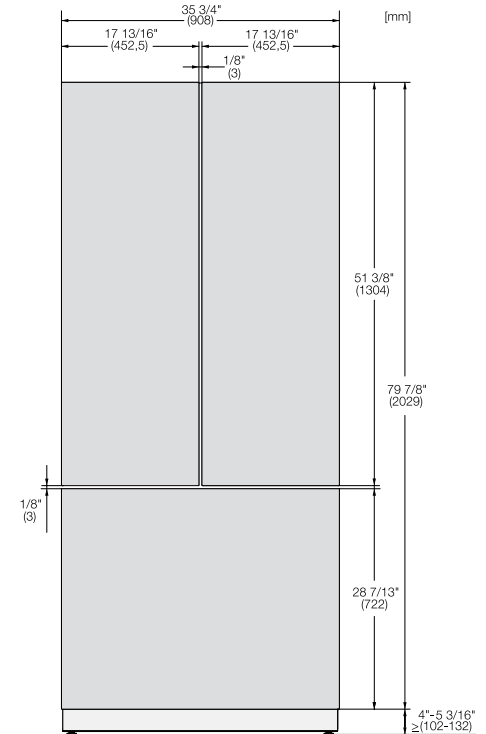

Max. Top Panel Weight (x2): 150 lbs
Max. Bottom Panel Weight: 19 lbs

Optional Accessory:
Clean Touch Steel Panel:
• KFP 3635 - Top Panel
Material# 11499420
• KFP 3625 - Bottom Panel
Material# 11499150

Panel Notes

*If the adjoining cabinets are taller than the height of machine (HOM) - the front panel may be extended accordingly.
Simply maintain the toe kick height and extend the panel the needed distance.*

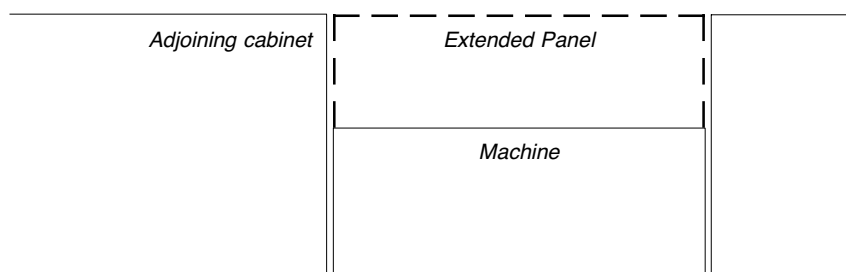

Fully Integrated 36" MasterCool

HINGING DETAILS 115° OPENING

Available for the following models:

- K 29x1 Vi
- F 29x1 Vi
- KF 29x1 Vi

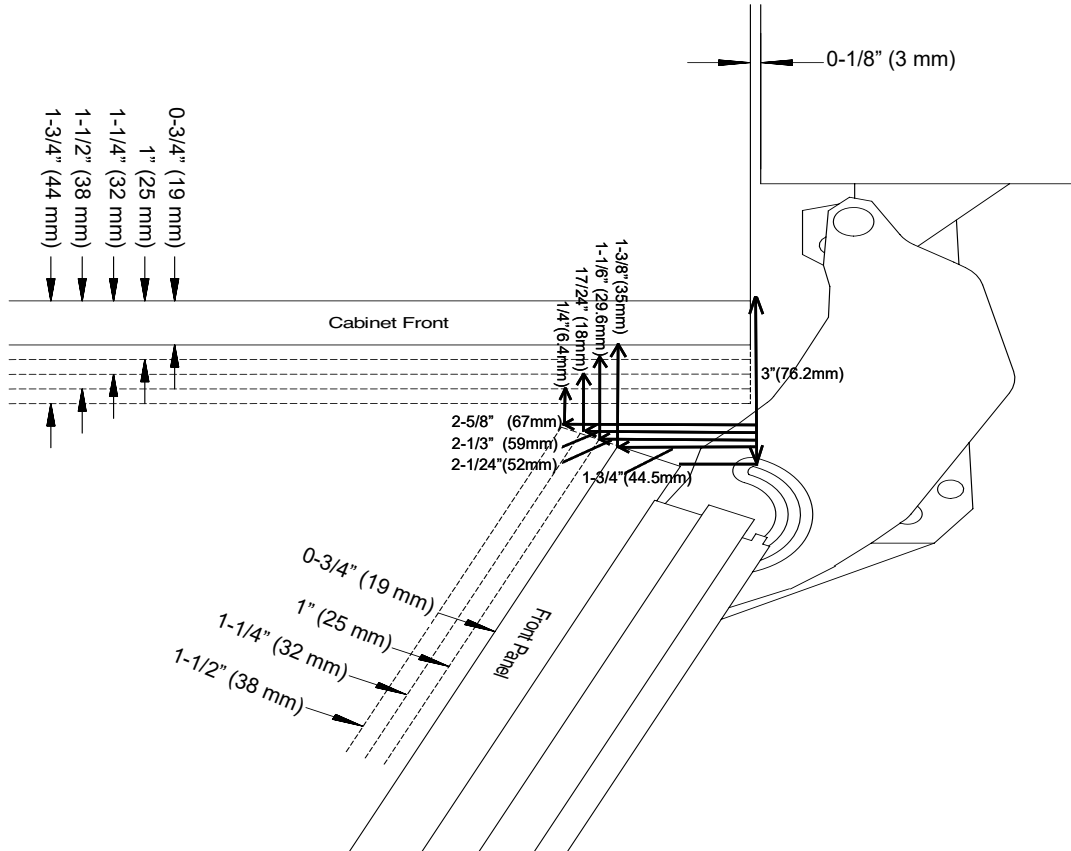

Top View)
(K29x1Vi, F29x1Vi, KF29x1Vi)

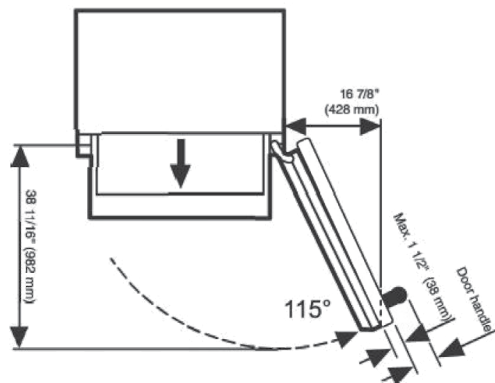

Top View
(KF2981Vi)

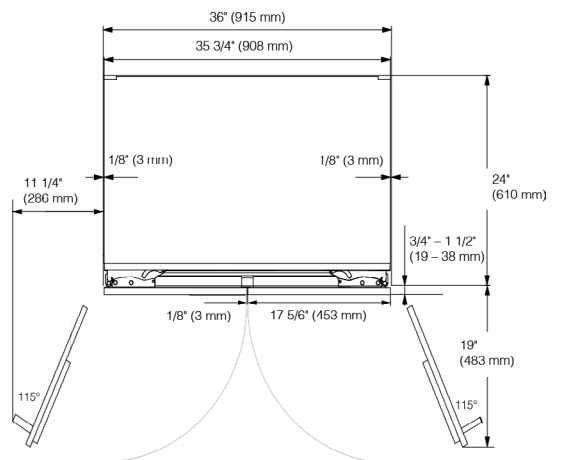

Fully Integrated 36" MasterCool

HINGING DETAILS 90° OPENING

Available for the following models:

- K 29x1 Vi
- KF 29x1 Vi

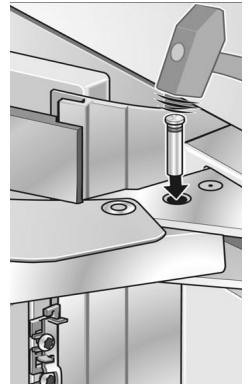
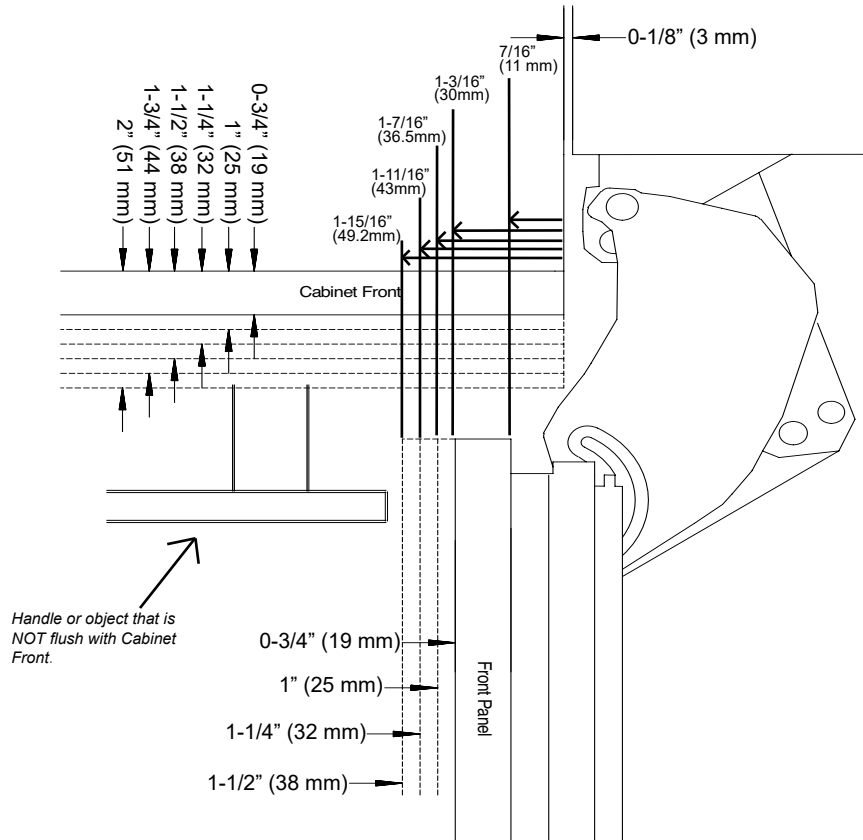

Top View
(K29x1Vi, KF29x1Vi)

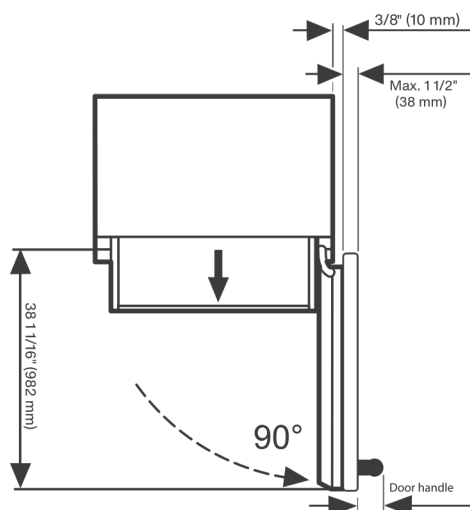

Top View
(KF2981Vi)

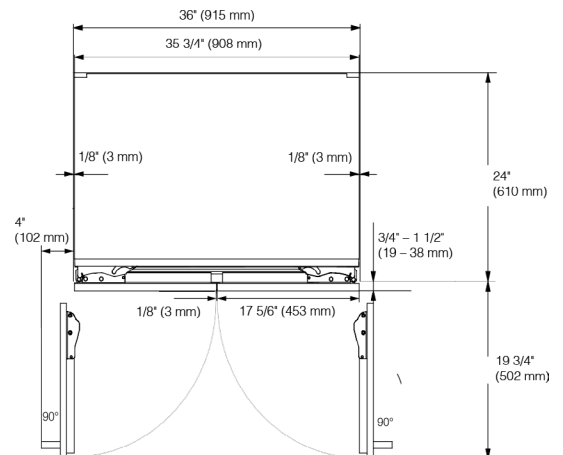

Freezer units cannot be stop pinned at 90°

ContourLine Combi-Steam Oven DGC 6760 XXL



PRODUCT SPECIFICATIONS

Isometric View

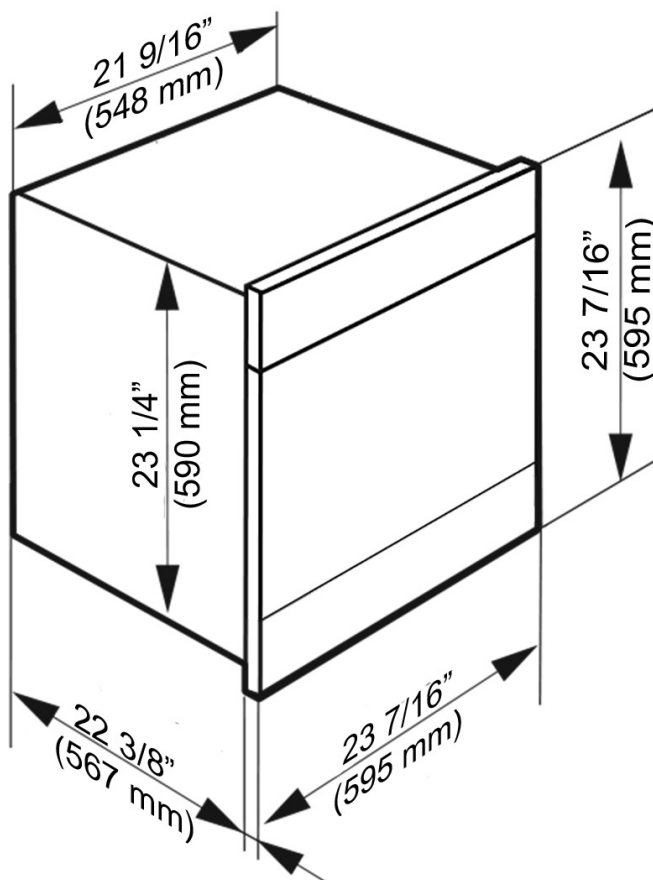

ContourLine Combi-Steam Oven DGC 6760 XXL



INSTALLATION SPECIFICATIONS

Door Swing Detail

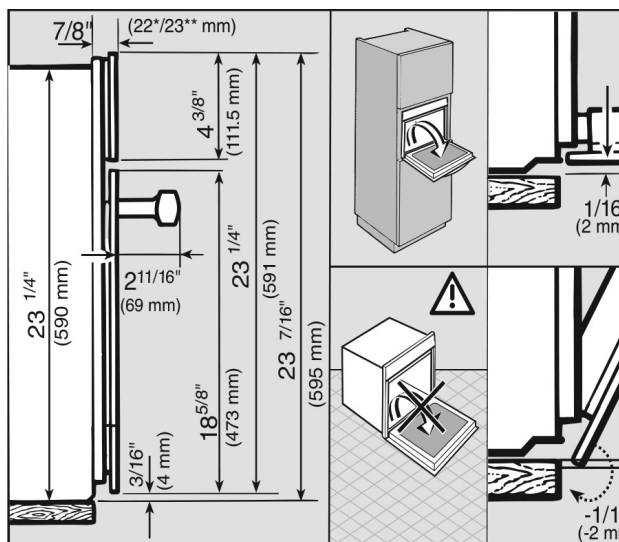

* Glass front / ** Metal front

Lift Panel Side View

The area in front of the control panel must not be blocked by anything (such as a door handle) that would hinder it from opening and closing.

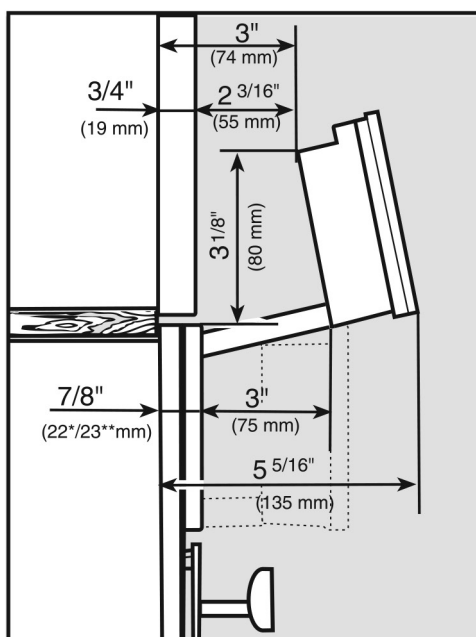

* Glass front / ** Metal front

ContourLine Combi-Steam Oven DGC 6760 XXL



INSTALLATION SPECIFICATIONS

Tall Cabinet Installation

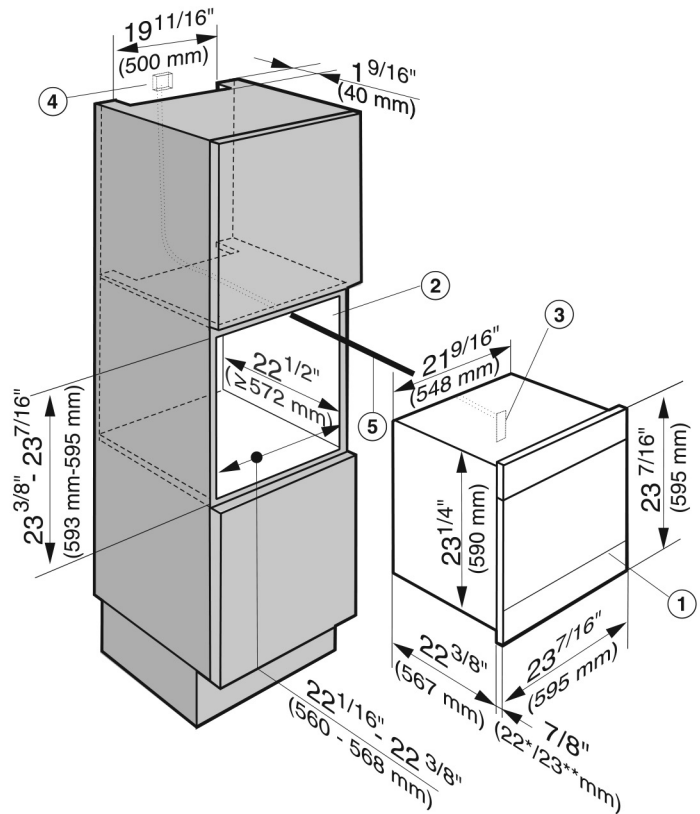

- ① Steam oven
- ② Niche
- ③ Pass-through for the power cord
- ④ Recommended position for electrical outlet
- ⑤ Power cord, L = 78 3/4" (2,000 mm)

* Glass front / ** Metal front

Tall Cabinet Installation — Venting and/or Plumbing Requirements

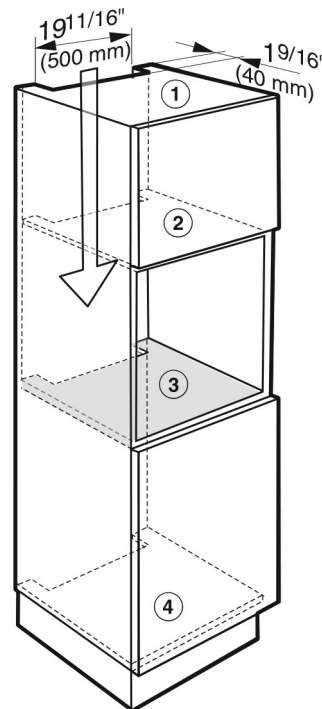

- ① Cut-out in top of unit (ventilation)
- ② Cut-out in the interim shelf above the building-in niche (for ventilation)
- ③ Cut-out in the interim shelf below the building-in niche (plumbing)
- ④ Cut-out in unit floor (plumbing)

24" Speed Oven - Flush Installation

#H6700BM

PRODUCT DIMENSIONS

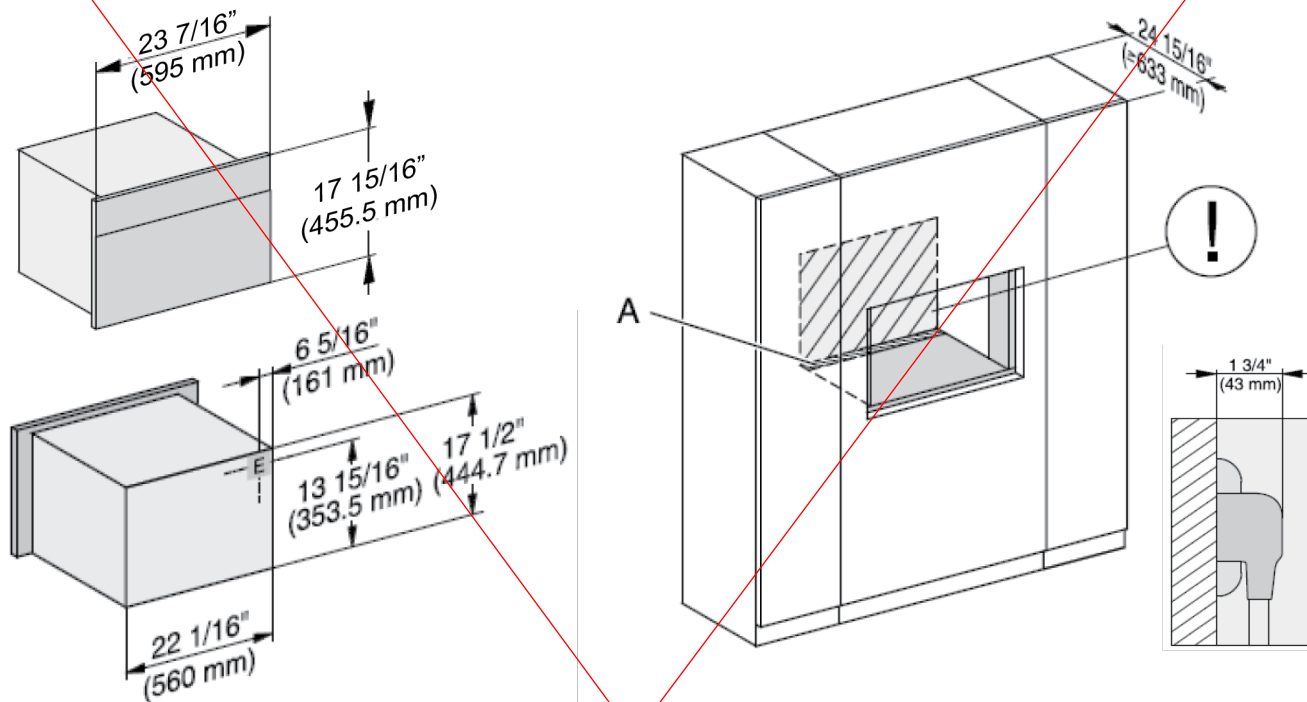

A - Cut-out (4" x 28" / 100 mm x 720 mm) in the bottom of the cabinet for power cord and ventilation

- ! - Electrical and water supplies are recommended to be placed in adjacent cabinetry.
Additional cabinet depth is required when placing the electrical and water supplies behind the appliance.

E = Electric connection

FLUSH INSTALLATION

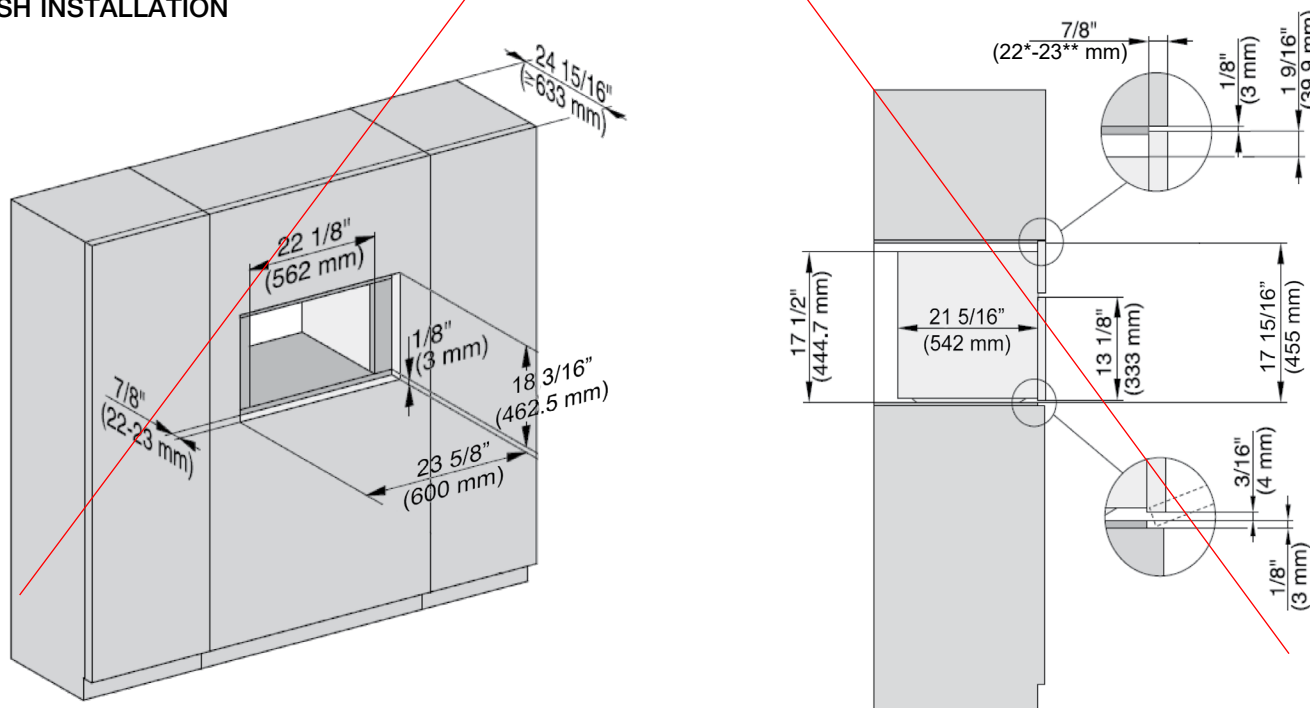

* Oven with glass
** Oven with metal

24" Speed Oven - Proud Installation

#H6700BM

PRODUCT DIMENSIONS

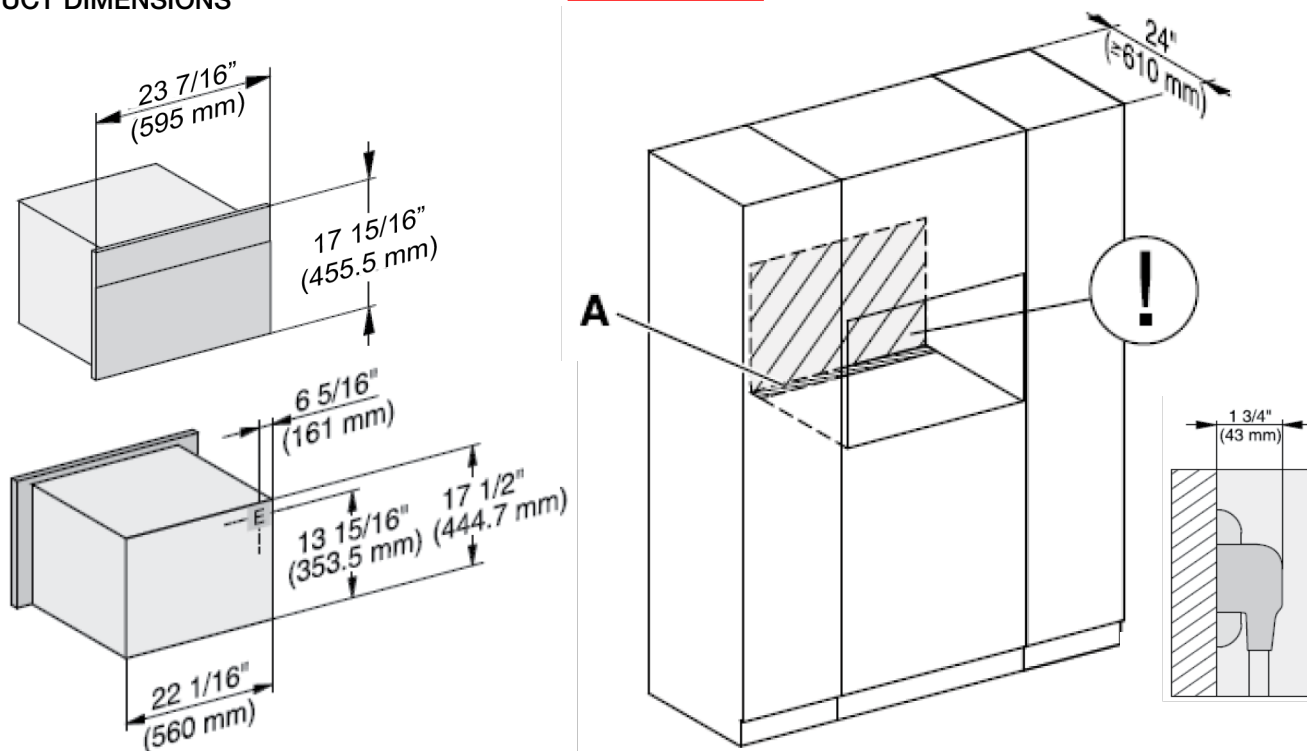

A - Cut-out (4" x 28" / 100 mm x 720 mm) in the bottom of the cabinet for power cord and ventilation

- ! - Electrical and water supplies are recommended to be placed in adjacent cabinetry.
Additional cabinet depth is required when placing the electrical and water supplies behind the appliance.

E = Electric connection

PROUD INSTALLATION

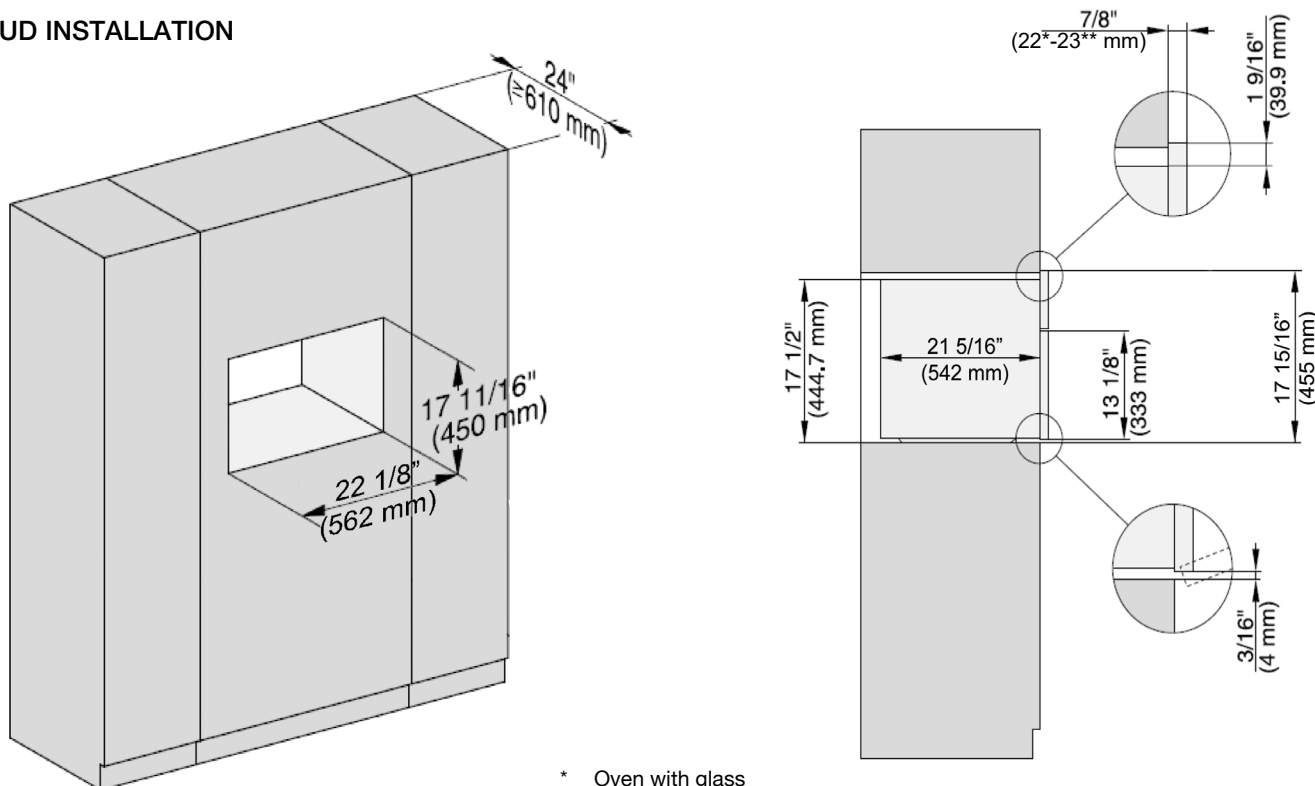

* Oven with glass
** Oven with metal

36" Induction Cooktop KM 6370



INSTALLATION DIMENSIONS

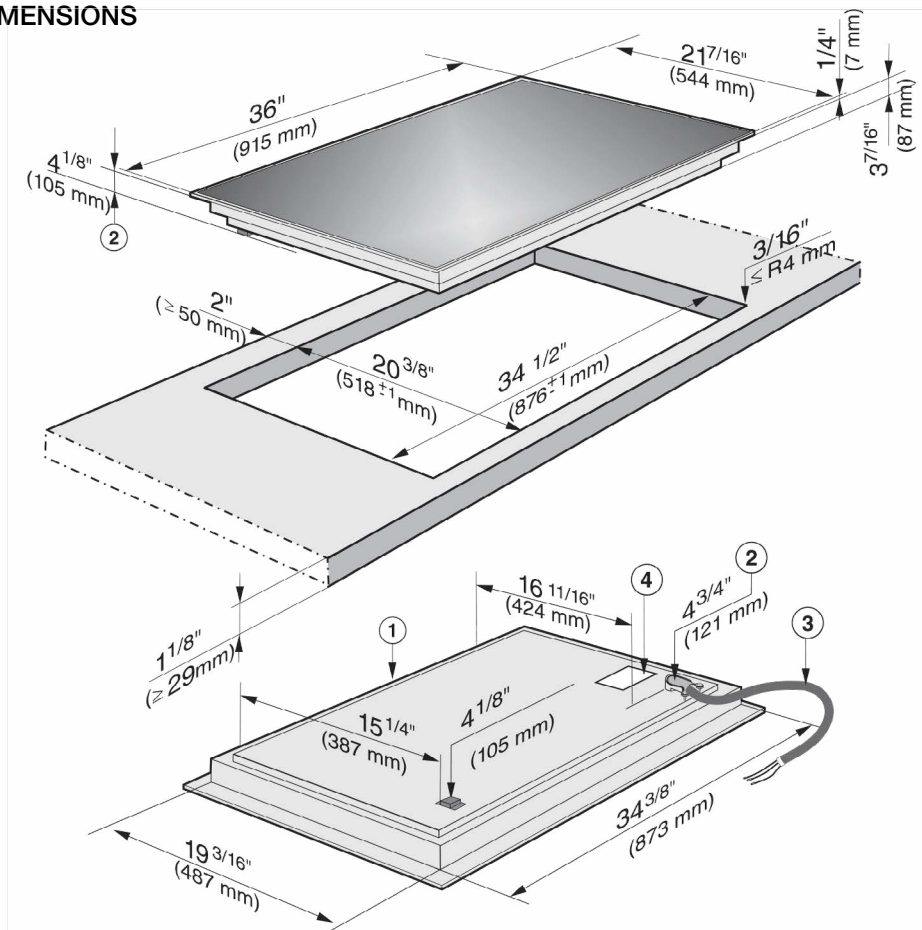

- ① Front
- ② Installation height
- ③ Flexible metal hose with power cord L = 3' 11 1/4" (1200 mm)
- ④ Data plate

36" Induction Cooktop KM 6370



INSTALLATION

Ventilations

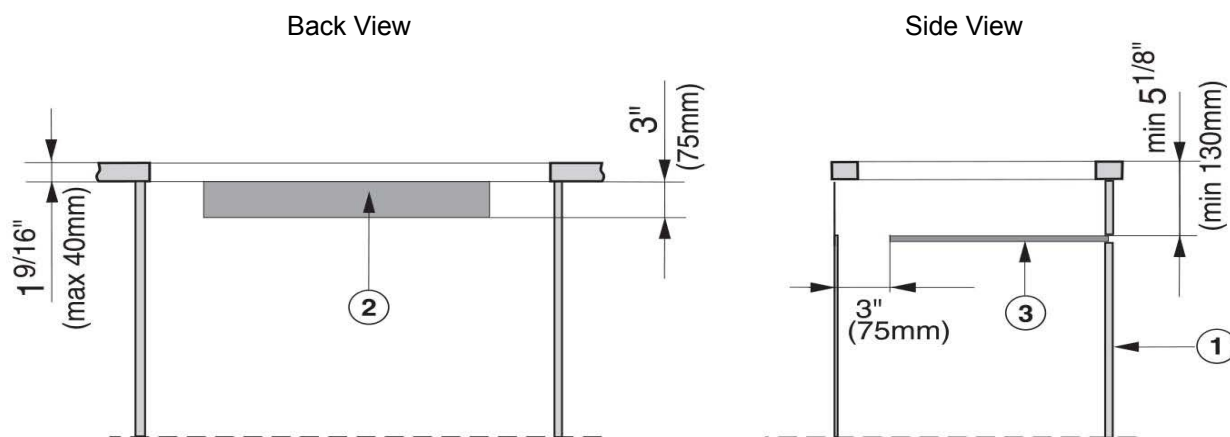

① Front of cooktop

② Cut-out in cabinet for ventilation.

Shown as an example in the rear wall of the cabinet.

③ Protective base

Installation of a protective base under the cooktop is allowed but not required.

If a protective base is fitted, there must be a clearance of at least 5 1/8" (130 mm) between the top of the protective base and the top of the countertop, for proper ventilation of the cooktop.

At the back there has to be a gap of 3" (75 mm) for the power cord.

Cooktop	Measurements cut-out
KM 6370 / KM 6375	90 sq-in. Example: 30" x 3" (762 x 75mm)

#DA6891

PRODUCT SPECIFICATIONS

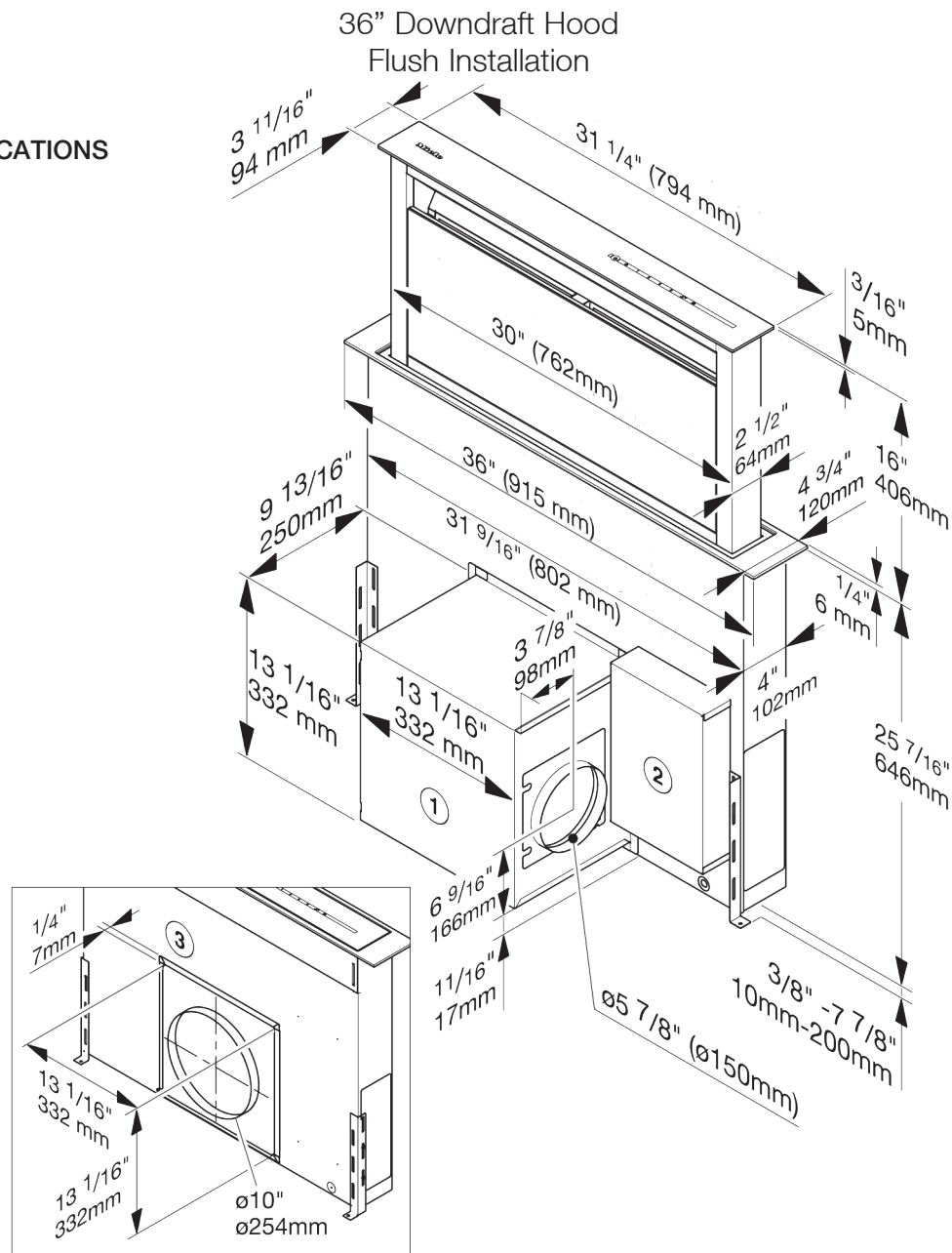

- ① The DAG 600 blower can be rotated and mounted with the exhaust air direction pointing up, to the left, to the right or down.
- ② The connection box can be positioned anywhere in the cabinet. The DA 6891 can be mounted to the left, right or behind the blower.
- ③ Cover for use with the DAG 1000 external blower.

The DAG 600 blower or the cover for the DAG 1000 blower can also be installed in the same position at the back of the appliance.

Exhaust connection:

with internal DAG 600 blower: Ø 6" (150 mm).

with external DAG 1000 blower: Ø 10" (254 mm).

Please refer to the cooktop manufacturer's instructions when installing in combination with a cooktop. The installation and safety distance requirements must be maintained.

The total output of a multi-burner gas cooktop must not exceed 21.6 kW, with no single burner exceeding 4.8 kW. Gas cooktops with a greater output cannot be used in combination with this downdraft.

36" Downdraft Hood Flush Installation

#DA6891

TWO INDIVIDUAL CUTOUTS INSTALLATION SPECIFICATIONS

Cutout Dimensions for Two (2) Cutouts

- Flush Mount Installation
- Allows for Installation with Flush Mounted Downdraft in Combination with Flush or Proud Mounted Combisets and Cooktops

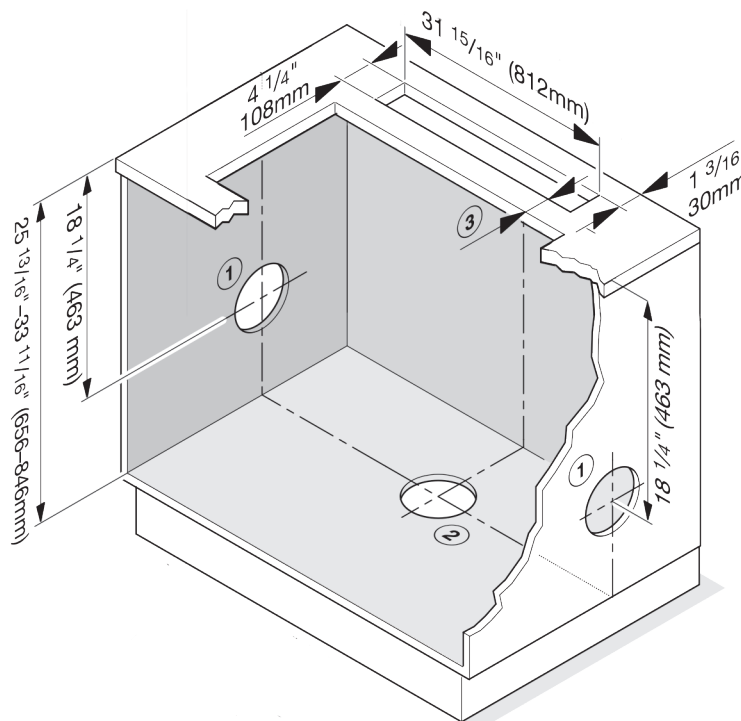

Exhaust or recirculation mode with DAG 600 blower installed at the front of the downdraft. Exhaust ducting (Ø 6" (150 mm))

- ① Exhaust ducting to the right or left.
- ② Exhaust ducting downwards.
- a) Overhang of the cooktop
- b) Cooktop cutout
- ③ If the downdraft and cooktop are installed in separate cutouts, ensure adequate stability of the strip in between.

If the blower is to be installed at the back of the downdraft, ensure that there is adequate space for installation.

36" Downdraft Hood Flush Installation

Recirculation Kit DUU 2900 (Optional Accessory)

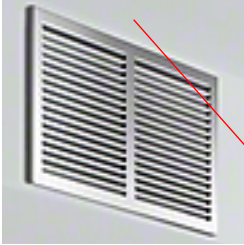

Ventilation Cutout

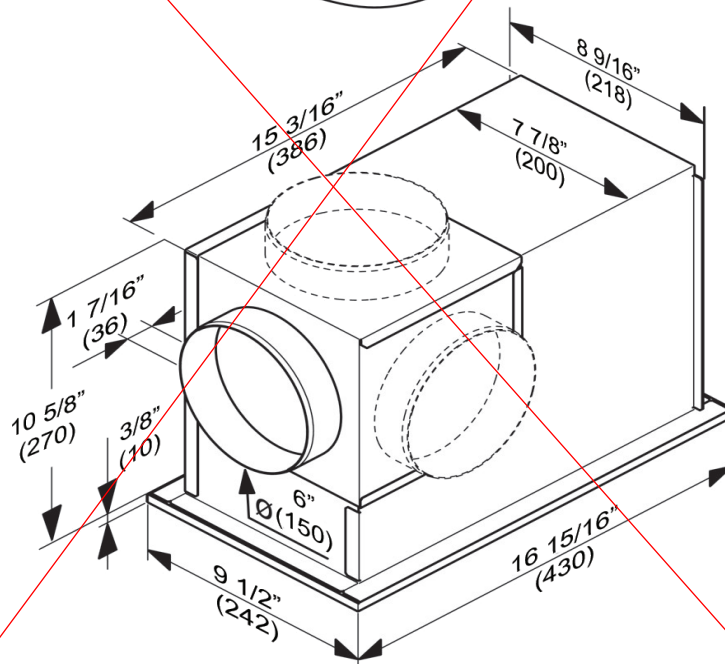
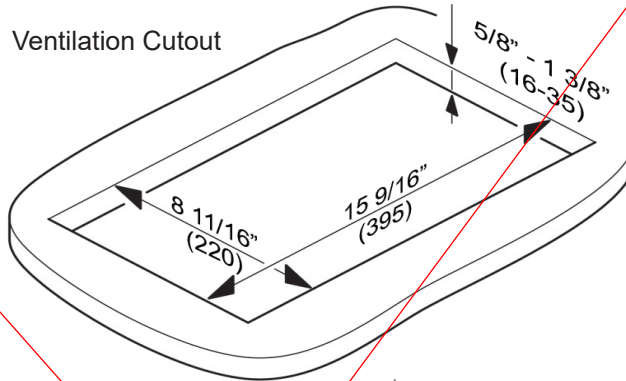

Installation

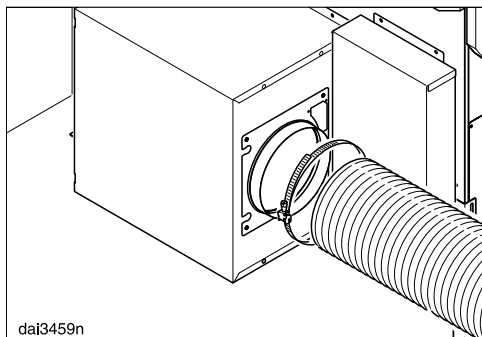

- Secure the exhaust ducting to the exhaust socket, e.g., with a hose clip (available as an optional accessory) on flexible ducting.

Vented mode

- See “Connection for vented mode” for additional instructions on attaching the ducting.

Recirculation mode

If site conditions are not suitable for the downdraft extractor to be used with vented extraction, it must be set up for recirculation:

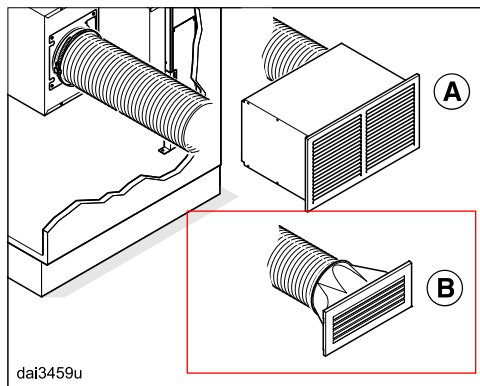

- Connect the DUU 2900 recirculation box ① to the exhaust socket.

The charcoal filters are integrated in the recirculation box. Therefore, charcoal filters do not have to be fitted in the downdraft extractor.

or

- Alternatively for the DA 6891 only: Connect the DUU 151 recirculation conversion kit ② to the exhaust socket. The downdraft extractor grease filters must be fitted with DKF 22-1 charcoal filters (see “Cleaning and care”).

Conversion kits DUU 2900 and DUU 151 are available as optional accessories.

- See the relevant installation instructions for more information.