

IC-36RID

Left hinge

FEATURES

- All-refrigerator storage solves capacity problems
- Ready to be fitted with custom panels and handles to blend with cabinetry
- Air purification system fights spoilage, odors
- Internal water dispenser works with seamless design
- Nano-coated spill-proof shelves for easy clean-up
- Smart-touch controls for streamlined access to more settings
- Water-filtration system reduces contaminants, chlorine taste and odor
- Rigorously tested in our U.S. manufacturing facilities to ensure decades of use
- Exceptional 24/7 support from Madison, WI-based Customer Care team
- Soft-close doors and drawers

ACCESSORIES

- Air Purification Cartridge
- Egg Container
- Stainless steel tubular handles
- Stainless steel pro handles
- Dual installation kits
- Stainless steel front panels with tubular or pro handles
- Stainless steel kickplate
- Stainless steel side enclosure
- Stainless steel top enclosure
- Reduced toe kick divider for toe kicks from 2" to 3.875"
- Replacement water filter

Accessories are available through an authorized Sub-Zero dealer. For local dealer information, visit subzero-wolf.com/locator.



HANDLE ACCESSORIES

Custom Panels

TYPICAL PANEL DIMENSIONS

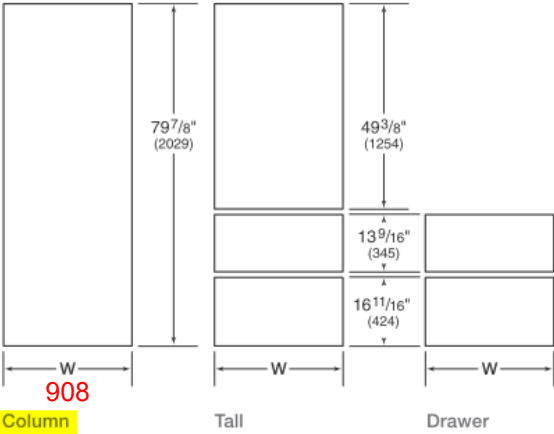

Typical panel dimensions are based on an 84" (2134) finished height for column and tall models and 34 1/2" (876) for drawer models, with a 4" (102) toe kick and 1/8" (3) reveals. Panel dimensions must be adjusted accordingly for all other installations. Refer to the illustration for panel heights and the chart below for panel widths.

PANEL WIDTH	W
18" Model	17 3/4" (451)
24" Model	23 3/4" (603)
27" Model	26 3/4" (679)
30" Model	29 3/4" (756)
36" Model	35 3/4" (908)

36" INTEGRATED COLUMN REFRIGERATOR WITH INTERNAL DISPENSER - PANEL READY



PRODUCT SPECIFICATIONS

Model	IC-36RID
Dimensions	36"W x 84"H x 24"D
Door Clearance	34 1/2"
Weight	460 lbs
Refrigerator Capacity	21.4 cu. ft.
Electrical Supply	115 VAC, 60 Hz
Electrical Service	15 amp dedicated circuit
Plumbing Supply	1/4" OD copper, braided stainless steel or PEX tubing
Plumbing Pressure	35–120 psi
Receptacle	3-prong grounding-type

ELECTRICAL

PLUMBING

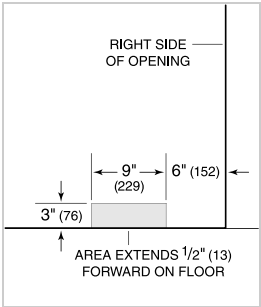
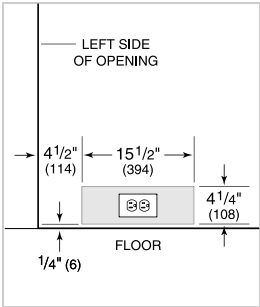

INTERIOR VIEW

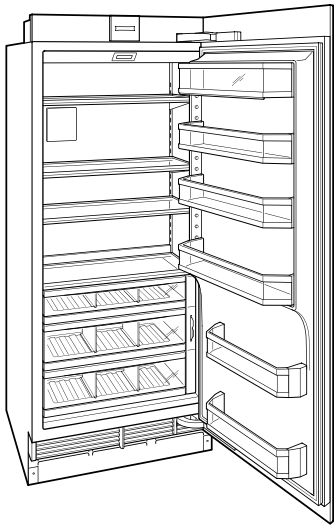

This illustration is intended for interior reference only and may not represent the exterior of the model being specified.

DIMENSIONS

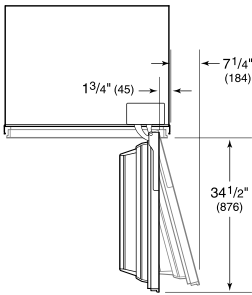
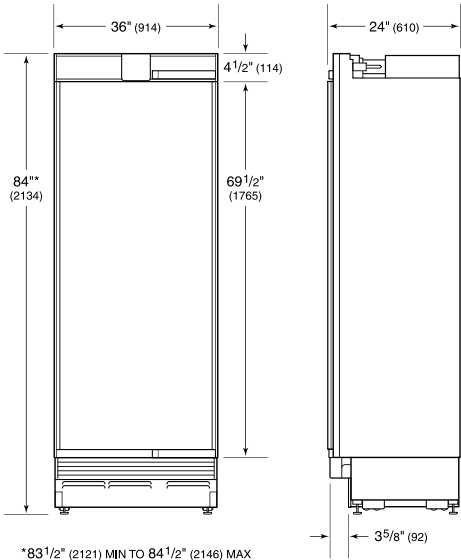

STANDARD INSTALLATION

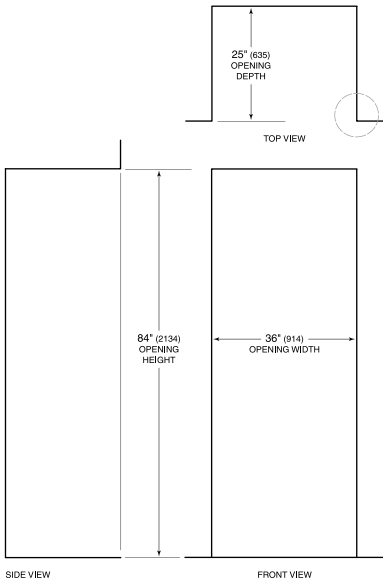

NOTE: 3/2" (89) finished returns will be visible and should be finished to match cabinetry.

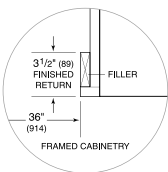
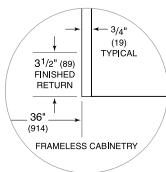

SO30CM/B



FEATURES

Black glass, handleless design for Wolf performance at its sleekest

10 cooking modes for predictably delicious results (Convection, Roast, Bake, Broil, Convection Roast, Stone, Gourmet, Warm, Proof and Dehydrate)

Advanced Dual VertiCross convection system for faster preheats and consistent cooking across all racks

Gourmet feature has menu of presets that automatically controls cooking of popular meals

5.1 cubic feet capacity to handle multiple dishes at once

Interactive color touchscreen for advanced cooking control

Enhanced interior views with triple-pane glass and three halogen lights

Can be installed flush with surrounding cabinetry for integrated look

Rigorously tested in our U.S. manufacturing facilities for decades of use

Exceptional 24/7 support from our Customer Care team in Madison

ACCESSORIES

30" Premier Baking Sheet

Bake stone kit (stone, rack and peel)

Dehydration kit (racks and door stop)

Full-extension, easy-glide oven racks

Temperature probe

Set of three standard oven racks

Accessories available through an authorized Sub-Zero dealer.
For local dealer information, visit subzero-wolf.com/locator.





PRODUCT SPECIFICATIONS

Model	SO30CM/B
Dimensions	29 7/8"W x 28 1/2"H x 23"D
Oven 1 Interior Dimensions	25 1/4"W x 17 1/2"H x 19 7/8"D
Overall Capacity	5.1 in.
Usable Capacity	3.3 in.
Door Clearance	21 3/8"
Weight	273 lbs
Electrical Supply	240/208 VAC, 60 Hz
Electrical Service	30 amp dedicated circuit
Conduit Length	4 Feet

ELECTRICAL

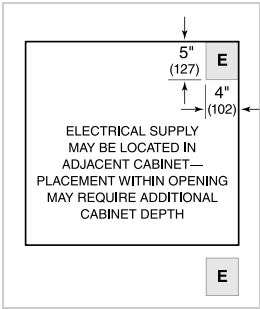

DIMENSIONS

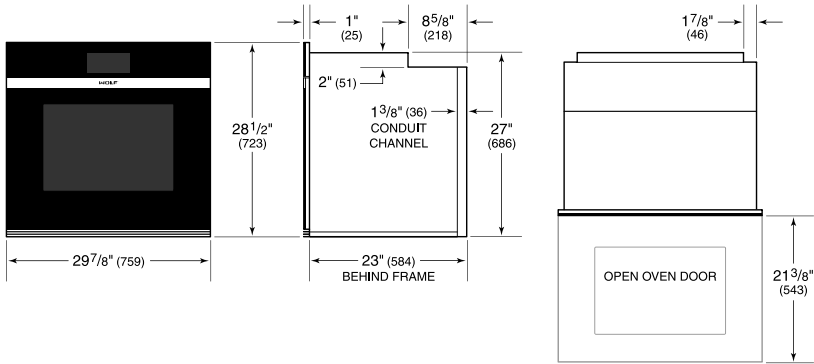

STANDARD INSTALLATION

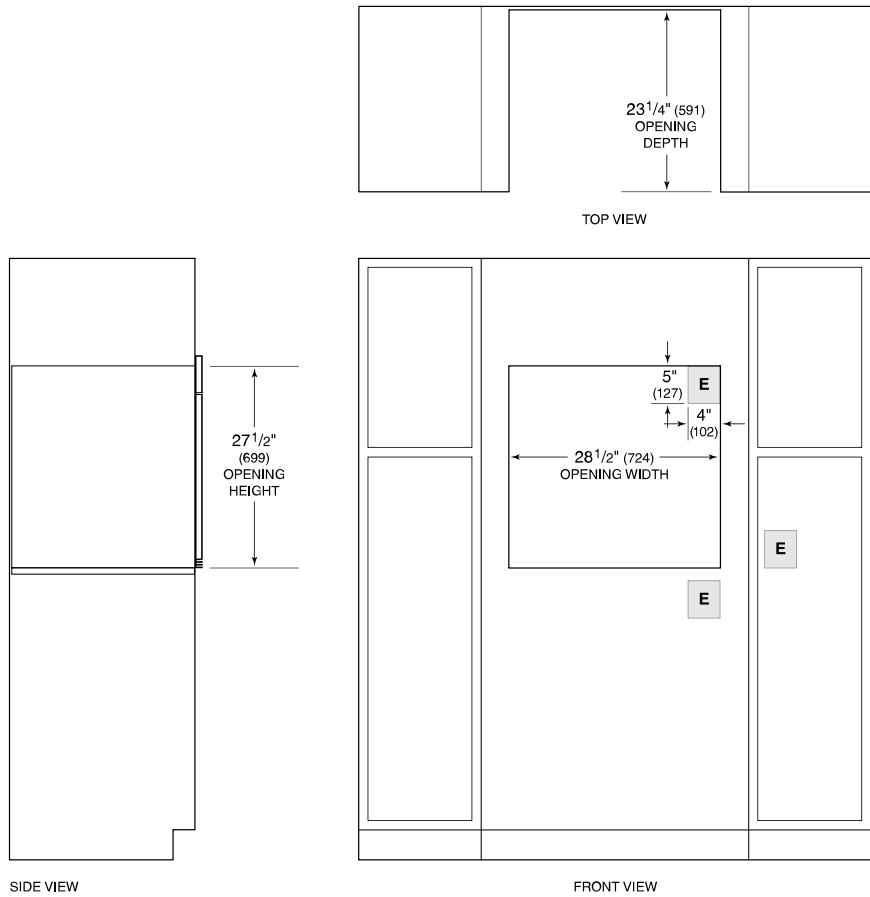

NOTE: Location of electrical supply within opening may require additional cabinet depth.

CSO30CM/B/TH**FEATURES**

Larger than similar units, can make multiple dishes at once

10 cooking modes make meals easy

Easy-access water tank provides 90 minutes of steam cooking

Installs flush with cabinetry or integrated into your kitchen design

Gourmet mode adjusts time, temperature, humidity for perfect results

Rigorously tested in our U.S. manufacturing facilities for decades of use

Exceptional 24/7 support from our Customer Care team in Madison

Steam mode captures nutrition, flavor and color

Reheat mode rehydrates leftovers flavorfully

Auto Steam Bake mode for bagels, breads, pastries

Convection mode for consistent results and beautiful browning

Convection Humid mode seals in moisture for juicy results

Convection Steam mode for foods tender inside, crisped outside

Slow Roast mode cooks dinner while you're away

Recipes mode cooks from collection of built-in recipes

"Keep Warm" mode

Program in when you want your dish to be ready

Temperature probe lets you know when it's done

Two pans, four rack positions

ACCESSORIES

Solid Pan 12 3/4" x 1 1/2" x 7"

Solid Pan 12 3/4" x 1 1/4" x 14"

Solid Pan 17 3/4" x 1 1/4" x 15"

Perforated Pan 12 3/4" x 1 1/2" x 7"

Perforated Pan 12 3/4" x 2 1/2" x 7"

Perforated Pan 17 3/4" x 1 1/4" x 15"

Porcelain Baking Sheet

Descaling Solution

Full Extension Rack Guides

Oven Rack

Accessories available through an authorized Sub-Zero dealer.
For local dealer information, visit subzero-wolf.com/locator.





PRODUCT SPECIFICATIONS

Model	CSO30CM/B/TH
Dimensions	29 7/8"W x 17 7/8"H x 21 1/2"D
Oven Interior Dimensions	17 7/8"W x 11"H x 15 3/4"D
Capacity	1.8 cu. ft.
Door Clearance	14 3/16"
Weight	80 lbs
Electrical Supply	240/208 VAC, 60 Hz
Electrical Service	20 amp dedicated circuit
Power Cord Length	6 Feet
Receptacle	NEMA 6-20R grounding-type

ELECTRICAL

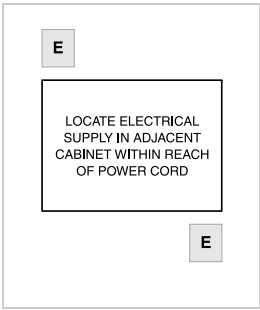

DIMENSIONS

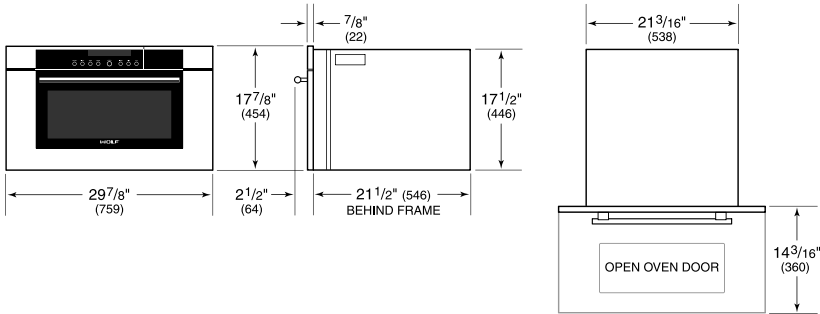

STANDARD INSTALLATION

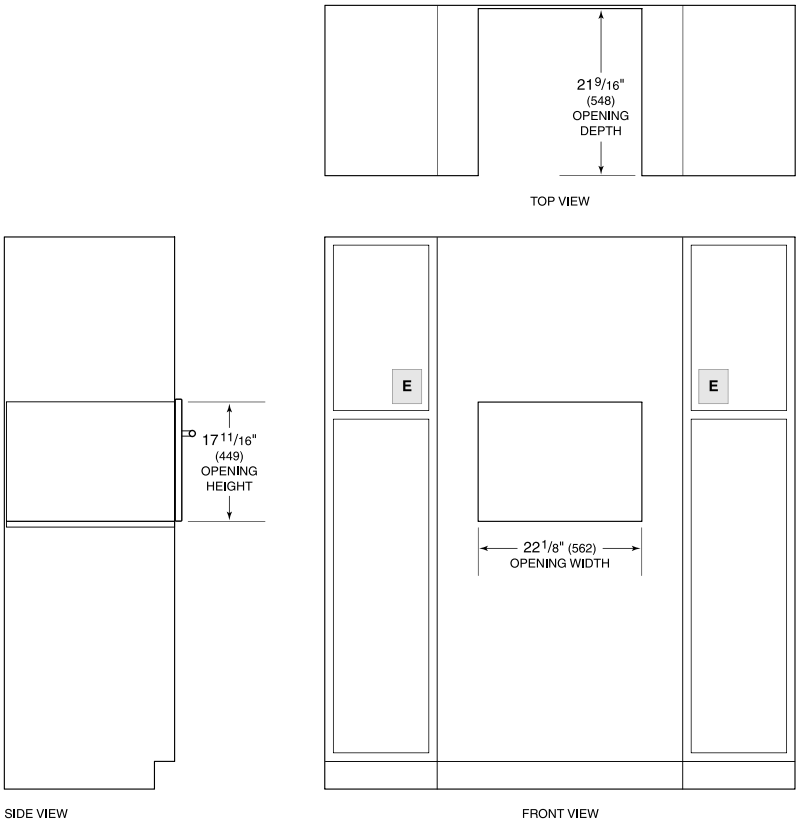

Electrical supply must be located in adjacent cabinet within 3' (9 m) of opening.

Asko Dishwashers

At Asko, we design and manufacture premium quality dishwashers with a special Scandinavian touch for design and function. Panel ready models accept a custom panel and handle. Tubular and pro handle models match Sub-Zero and Wolf products. Our products meet the highest demands in performance and durability, as well as environmental awareness.

DISHWASHER MODELS

INTEGRATED HANDLE

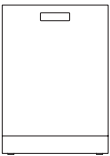

DBI663IS
DBI663ISSOF



DBI664IXXLS
DBI664IXXLSSOF



DBI675IXXLS

TUBULAR HANDLE

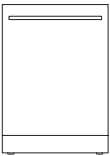

DBI663THS



DBI664THXXLS



DBI675THXXLS

PRO HANDLE

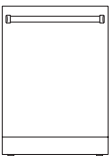

DBI663PHS



DBI664PHXXLS



DBI675PHXXLS

PANEL READY



DFI663
DFI663XXL



DFI664
DFI664XXL
DFI664XXLSOF



DFI675XXL

OUTDOOR

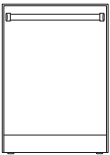

DOD651PHXXLS

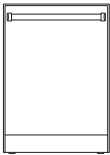

D5956OUTDOORPH

Overall Dimensions

PANEL READY

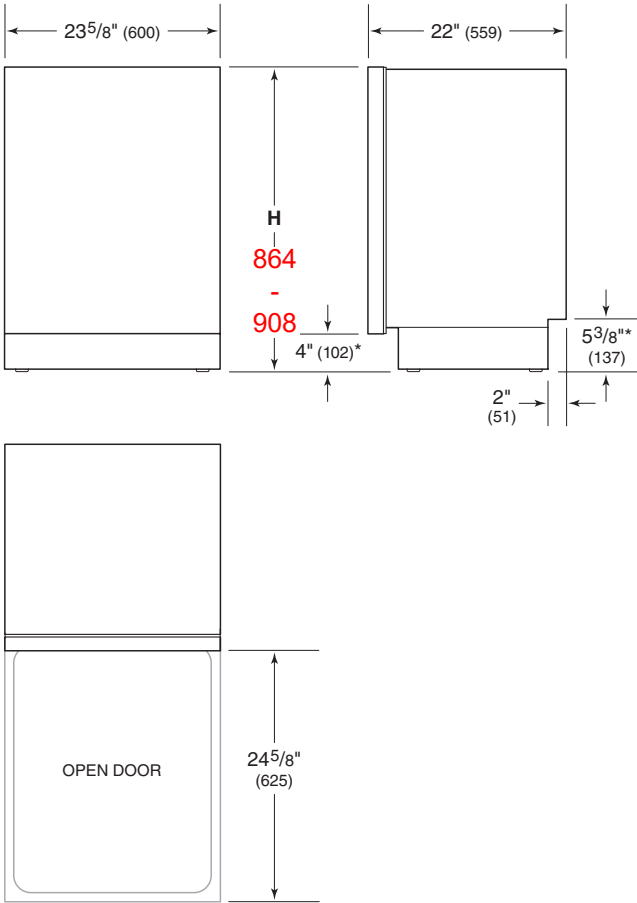

*Dimension will vary with product height.

HEIGHT	H
Non-XXL Model	32 3/4" (832)* – 34 3/4" (883)
XXL Model	34" (864) – 35 3/4" (908)

*Can be reduced to 32 1/4" (819).

IMPORTANT NOTE: Overall dimensions for panel ready models do not include panels or handles. Dimensions will vary with panel thickness.

OUTDOOR

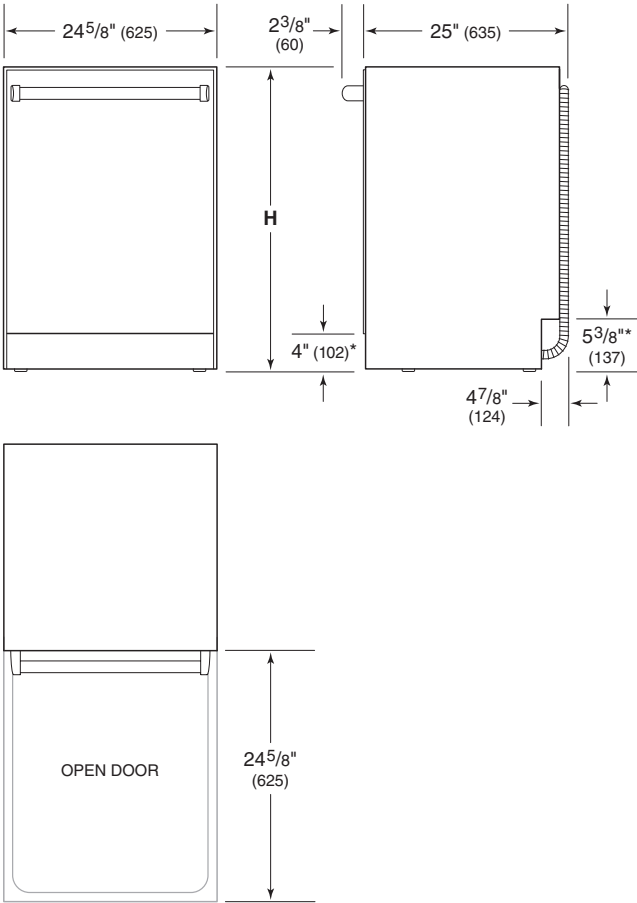

*Dimension will vary with product height.

HEIGHT	H
Outdoor Model	35" (889) – 35 3/4" (908)

Opening Dimensions

DISHWASHERS

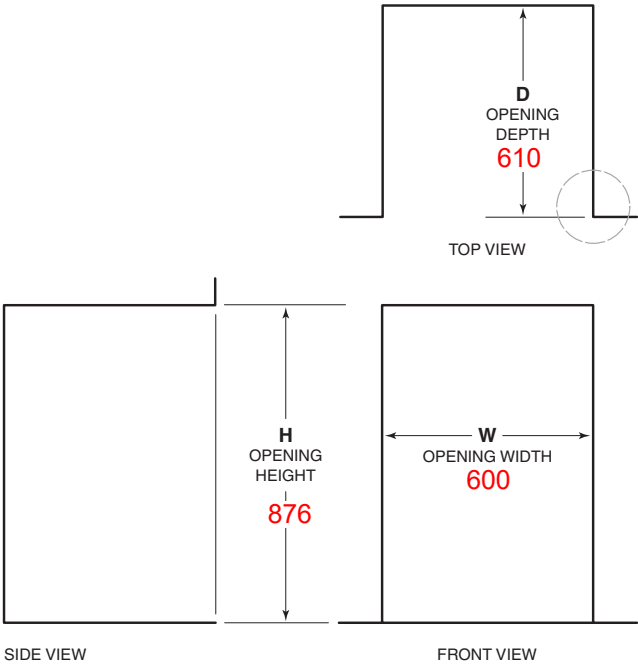

NOTE: 3 1/2" (89) finished returns will be visible and should be finished to match cabinetry.

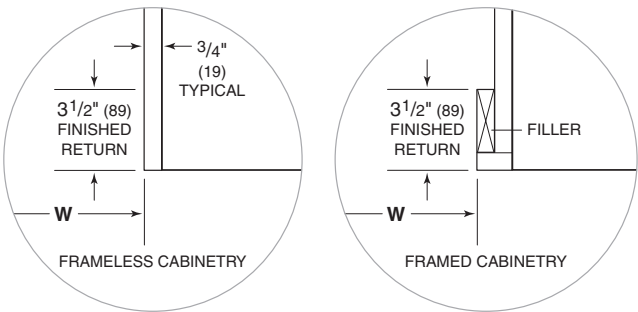

IMPORTANT NOTE: All indoor models can accommodate varying opening widths, however, 24" (610) and 23 5/8" (600) are the two most common. A 23 5/8" (600) opening will provide minimum reveals.

OPENING	W	H	D
Indoor Model	23 5/8" (600)	34 1/2" (876)	24" (610)
Outdoor Model	24 7/8" (632)	35 1/2" (902)	25 1/4" (641)

A minimum 3 1/2" (89) finished return is required on all sides of the opening. Framed cabinets will require additional finished filler material behind the face frame for a proper installation. Refer to the illustration.

Indoor models include top and side trim to accommodate varying opening dimensions. Top and side trim can be removed to achieve minimum reveals.

For ADA installations and height restricted openings, all indoor, non-XXL models can be installed in a 32 1/4" (819) opening by removing top trim and lowering side trim.

Custom Panel

PANEL READY

IMPORTANT NOTE: The size of the custom door panel is directly related to the size of the opening.

The two most common dishwasher opening widths are 24" (610) and 23⁵/₈" (60 cm). For all other widths, the panel should be ¹/₄" (6) less than the opening to achieve minimum reveals. The minimum panel width is 23³/₈" (594).

The most common dishwasher opening height is 34¹/₂" (876). The panel dimensions in the chart below are based on a 34¹/₂" (876) opening, with a 4" (102) toe kick and ³/₈" (10) top reveal. For all other opening and toe kick heights, the panel must be adjusted accordingly. The minimum panel height is 28" (711). The minimum toe kick height is 4" (102).

Finish all sides of the custom panel. They may be visible when the door is open.

PANEL DIMENSIONS	W	H
23 ⁵ / ₈ " (60 cm) Opening	23 ³ / ₈ " (594)	30 ¹ / ₈ " (765)
24" (610) Opening	23 ³ / ₄ " (603)	30 ¹ / ₈ " (765)

PANEL REQUIREMENTS

Max Weight (including handle)	20 lb (9 kg)
Min Thickness	³ / ₄ " (19)

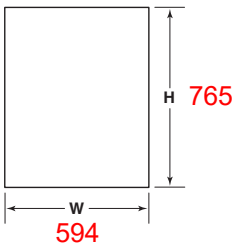

Panel dimensions

ADA CUSTOM PANEL HEIGHT

The American with Disabilities Act limits the countertop height to 34" (864). Differing countertop thickness will affect the overall panel height.

Typical panel dimensions are based on a 32¹/₂" (826) opening height with a 4" (102) toe kick and ³/₈" (10) top reveal. The panel height cannot be less than 28" (711). Refer to the chart below for typical panel dimensions.

PANEL DIMENSIONS (ADA)	W	H
23 ⁵ / ₈ " (60 cm) Opening	23 ³ / ₈ " (594)	28 ¹ / ₈ " (714)
24" (610) Opening	23 ³ / ₄ " (603)	28 ¹ / ₈ " (714)

PANEL REQUIREMENTS

Max Weight (including handle)	20 lb (9 kg)
Min Thickness	³ / ₄ " (19)

ID-30FI



FEATURES

- Ready to be fitted with custom panels and handles to blend with cabinetry
- Automatic ice maker with "max ice" feature
- Smart-touch controls for streamlined access to more settings
- Soft-close doors and drawers
- Soft-on LED lights for varying degrees of brightness
- Rigorously tested in our U.S. manufacturing facilities to ensure decades of use
- Exceptional 24/7 support from Madison, WI-based Customer Care team

ACCESSORIES

- Dual Installation Kit

TYPICAL PANEL DIMENSIONS

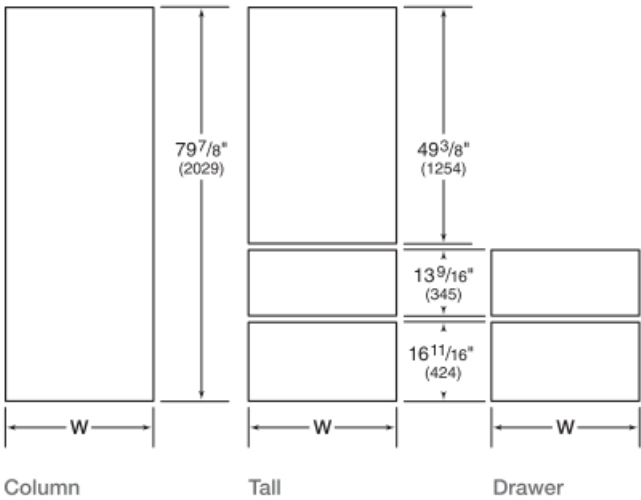

Typical panel dimensions are based on an 84" (2134) finished height for column and tall models and 34 1/2" (876) for drawer models, with a 4" (102) toe kick and 1/8" (3) reveals. Panel dimensions must be adjusted accordingly for all other installations. Refer to the illustration for panel heights and the chart below for panel widths.

PANEL WIDTH	
MODEL	W
18" Model	17 3/4" (451)
24" Model	23 3/4" (603)
27" Model	26 3/4" (679)
30" Model	29 3/4" (756)
36" Model	35 3/4" (908)



HANDLE ACCESSORIES

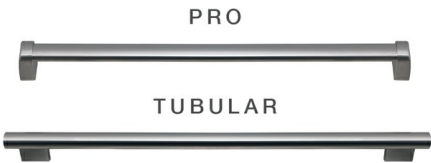

PRODUCT DETAILS

FREEZER

- Adjustable drawer dividers
- Automatic ice maker
- Removable ice container

PRODUCT SPECIFICATIONS

Model	ID-30FI
Dimensions	30"W x 34 1/2"H x 24"D
Drawer Clearance	18 3/8"
Weight	210 lbs
Freezer Capacity	4.9 cu. ft.
Electrical Supply	115 VAC, 60 Hz
Electrical Service	15 amp dedicated circuit
Receptacle	3-prong grounding-type

ELECTRICAL

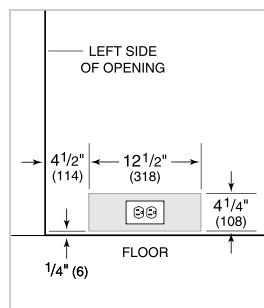

PLUMBING

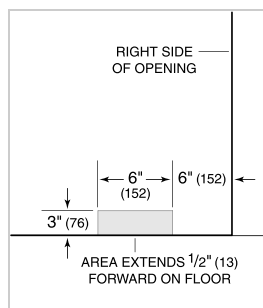

PANEL SPECIFICATIONS For complete panel specifications including width/height, weight requirements and thickness requirements visit subzero-wolf.com/integratedconfigurator.

NOTE: Dimensions in parenthesis are in millimeters unless otherwise specified

INTERIOR VIEW

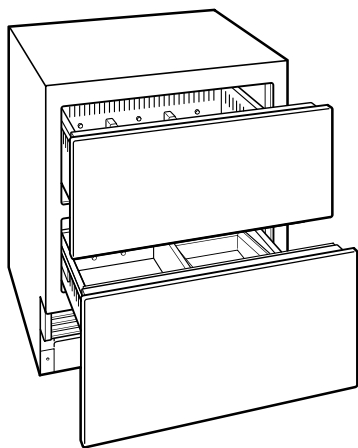

This illustration is intended for interior reference only and may not represent the exterior of the model being specified.

DIMENSIONS

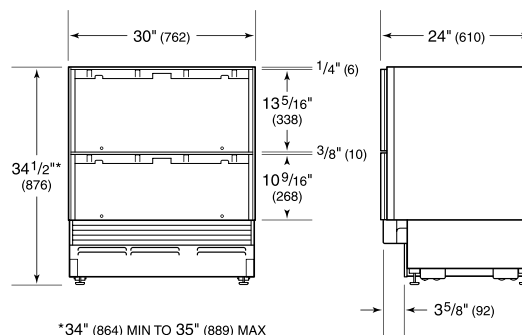

*34" (864) MIN TO 35" (889) MAX

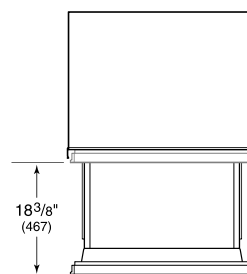

STANDARD INSTALLATION

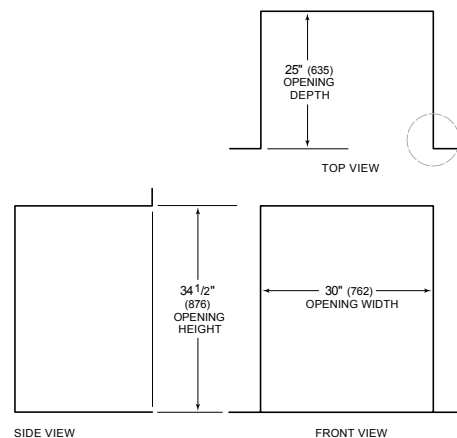

NOTE: 3 1/2" (89) finished returns will be visible and should be finished to match cabinetry

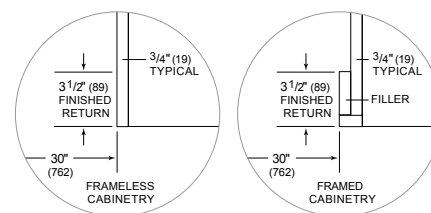



LORRAINE

24" French door beverage center. -DBC047D1BSSPR



PRODUCT FEATURES

Cutting-Edge Temperature Management System

Superior fan-forced cooling removes the risks of inner climate fluctuations and inconsistencies, while the advanced airflow system efficiently dissipates heat to considerably improve the longevity of the cooling system.

Keep In the Cool

Low E-Glass seals in the cold in a way that's similar to a thermostat lining. The extremely thin layers of safe and low emissivity materials used in this unit reflect interior temperatures back inside, keeping your drinks properly chilled and protected.

Non-Existent Interference Issues

The zero-clearance hinge system on this unit makes for a flush fit integrated built-in that will blend seamlessly with neighboring cabinets. Surrounding surfaces will also be safe from bumps and nicks due to these ingenious door joints.

*Where some see room for an appliance;
We see room for an experience*

www.silhouetteappliances.com

PRODUCT DESCRIPTION

Whether you prefer a pint over a Pinot, or corks rather than cans, this dual temperature zone center has room for both. The French door design makes each side equally accessible, and you will never have to sacrifice any beverage selection again.

SPECIFICATIONS

Dimensions

Width	60.50cm	23.82"
Depth	65.00cm	25.59"
Height	87.40cm	34.41"

Capacity

Volume	133.10liters	4.7 cu.ft.
--------	--------------	------------

Temperature Range

Temperature	Low: 39 °F	High: 64 °F
-------------	------------	-------------

WARRANTY

The Silhouette Professional DBC047D1BSSPR model comes with a 24-month in-home warranty on parts and labour. Installation and yearly maintenance (cleaning) of the fridge are not covered under the warranty.

Danby Products Ltd. PO Box 1778, Guelph, Ontario Canada N1H 2Z9 (519) 837-0920 FAX: (519) 837-0449

We can make elegance look effortless, but it is always evolving. This is why our specifications may also change along the way, so these specifications are subject to change without notice. MSRP is Manufacturer's Suggested Retail Price and may not necessarily be the price at which the product is sold.

CI365TF/S

FEATURES

Incredible cooking control, with lightning fast high heat and very low lows

Pair with module cooktops for a custom cooking array

Efficiently transfers heat, because energy is supplied directly to the cookware

Cookware sensing guards against hot burners being left on

Cooktop stays relatively cool for added safety and easy cleanup

Rigorously tested in our U.S. manufacturing facilities for decades of use

Exceptional 24/7 support from our Customer Care team in Madison

ACCESSORIES

Filler strip for installation with another cooktop or module

Filler strip for installation with another cooktop or module and downdraft

Accessories available through an authorized Sub-Zero dealer.
For local dealer information, visit subzero-wolf.com/locator.



COOKTOP SPECIFICATIONS

- 2 - 2100 W Element
- 2 - 2100 W Element with 3000 W Boost
- 1 - 2600 W Element with 3700 W Boost

PRODUCT SPECIFICATIONS

Model	CI365TF/S
Dimensions	36"W x 2"H x 21"D
Weight	61 lbs
Electrical Supply	3-wire, 240/208 VAC, 60 Hz
Electrical Service	50 amp dedicated circuit
Conduit Length	4 Feet

ELECTRICAL

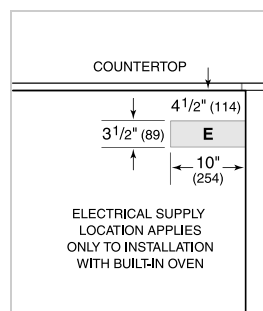

NOTE: Dimensions in parenthesis are in millimeters unless otherwise specified

DIMENSIONS

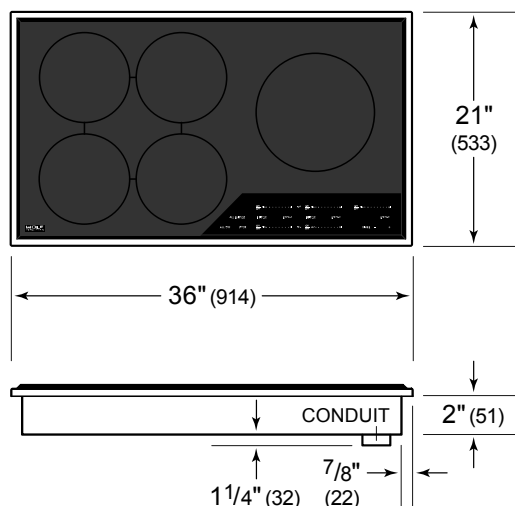

STANDARD INSTALLATION

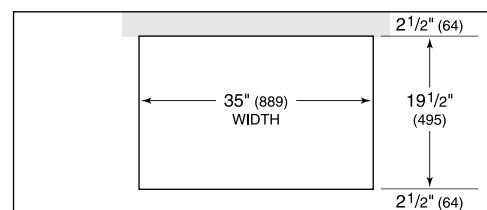

COUNTERTOP CUT-OUT

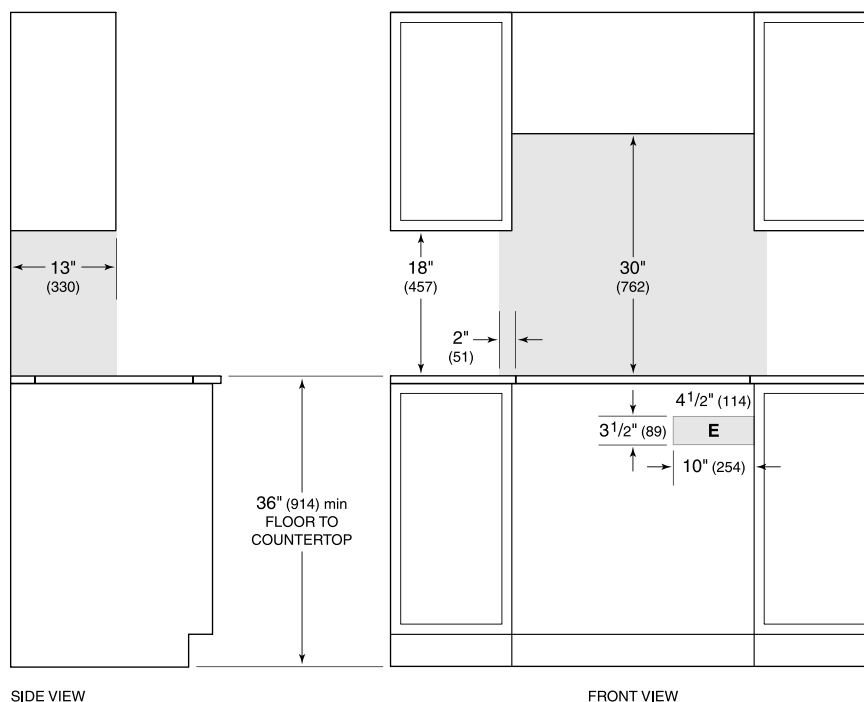

SIDE VIEW

FRONT VIEW

NOTE: Shaded area above countertop indicates minimum clearance to combustible surfaces, combustible materials cannot be located within this area.
Electrical supply location only applies to installations with built-in oven.

Whirlpool Dawndraft - UXD8636DYS

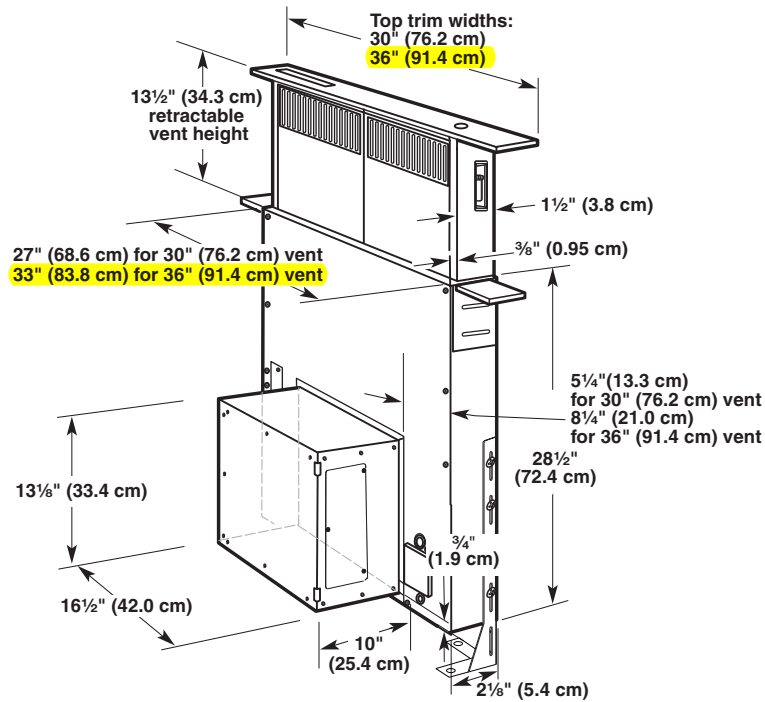

As-Received Blower

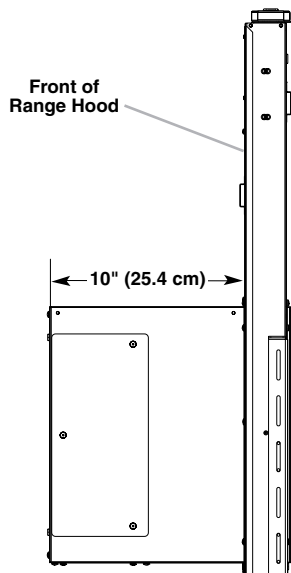

Reversed Blower

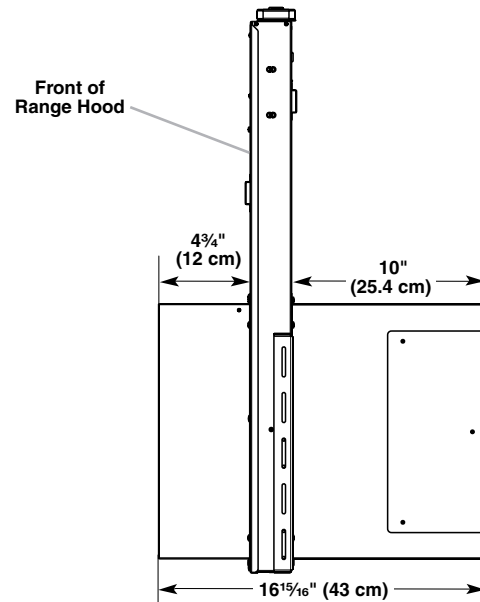

Cabinet Dimensions

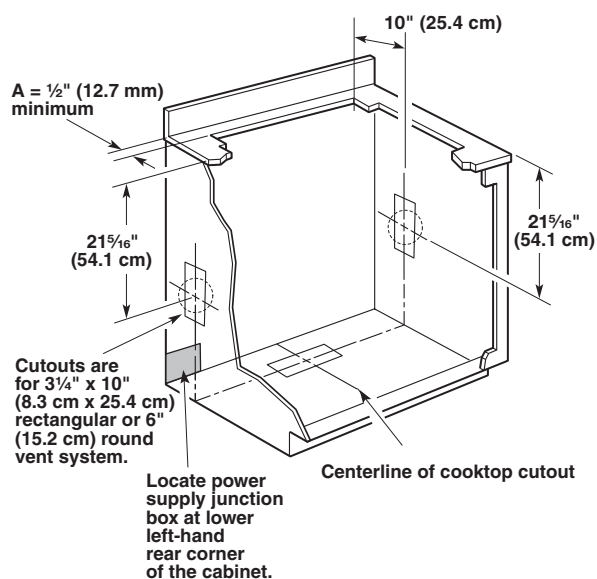

NOTES:

- See cooktop manufacturer's instructions for cooktop cutout depth and width.
- Use dimensions for vent system cutout location that applies to your installation.
- Interior-mounted blower systems connect with 3 1/4" x 10" (8.3 cm x 25.4 cm) rectangular or 6" (15.2 cm) round vent system. The cutout locations for this vent system will depend on your specific installation.

Countertop Cutout Dimensions

IMPORTANT: Countertops with a bull-nosed front edge are not recommended for these installations.

Some models require a countertop deeper than 25" (63.5 cm); see the following illustrations.

To avoid mistakes, it is recommended that the cooktop and vent cutouts be drawn on the countertop before making any cutouts.

See the Installation Instructions that came with your cooktop for complete cutout dimensions, location dimensions, and installation details.

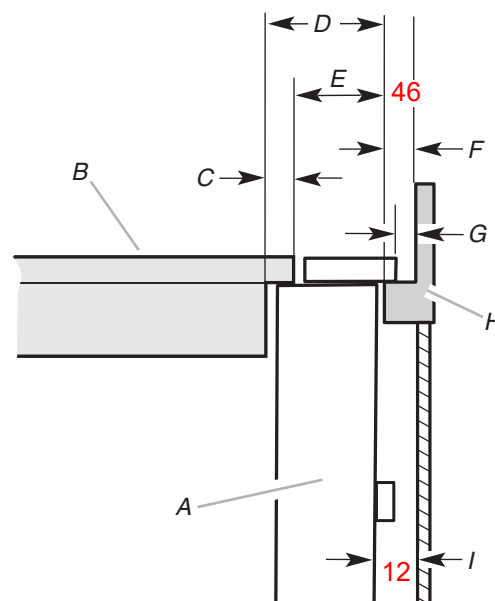

- | | |
|---|--|
| A. Downdraft vent | E. 1 ¹³ / ₁₆ " (46.2 mm) |
| B. Cooktop | F. 1/2" (12.7 mm) minimum |
| C. Measurement of cooktop rear overhang | G. 1/4" (6.4 mm) minimum |
| D. D = Measurement of cooktop rear overhang (C) + 1 ¹³ / ₁₆ " (46.2 mm) (E) | H. Countertop and backsplash |
| | I. 1/2" (12.7 mm) minimum |

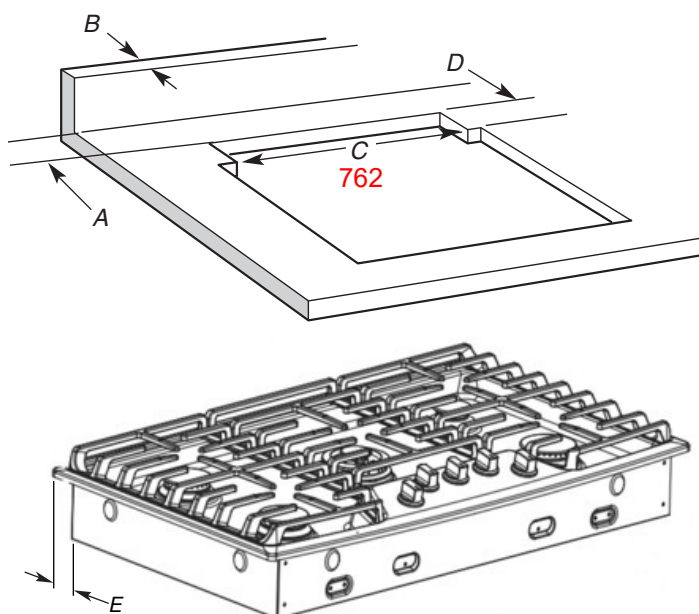

- | | |
|--|--|
| A. 1/2" (12.7 mm) minimum to backsplash or rear wall | C. 27 1/2" (69.9 cm) on 30" (76.2 cm) models |
| B. 3/4" (19.1 mm) maximum backsplash depth | 33 1/2" (85.9 cm) on 36" (91.4 cm) models |
| | D. D = E + 1 ¹³ / ₁₆ " (46.2 mm) |
| | E. Cooktop rear overhang |

INSTALLATION INSTRUCTIONS

Venting Methods

Determine which venting method is best for your application. Vent system can terminate either through the wall or floor.

Island Location

Front-Mounted Blower Motor (Standard)

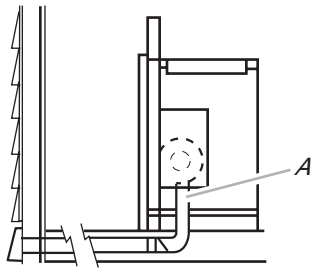

Rear-Mounted Blower Motor

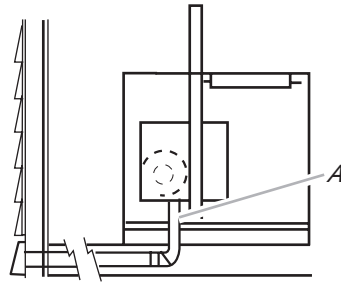

A. Down vent

NOTE: For island locations, a front- or rear-mounted blower motor can also be mounted for right or left venting if needed for your application. Most island applications would still require the venting to be directed down through the floor.

Built-In Cabinet Location

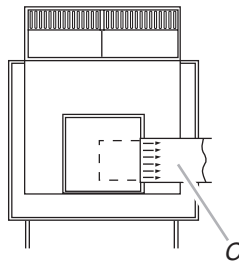
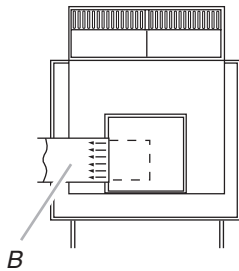
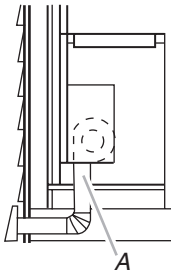

A. Down vent
B. Left vent
C. Right vent

Island Location — Vent System Installed Under a Concrete Slab Using PVC Sewer Pipe

Front-Mounted Blower Motor (Standard)

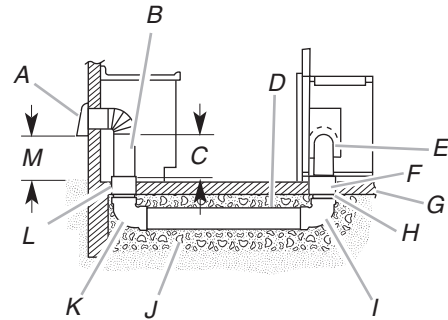

Rear-Mounted Blower Motor

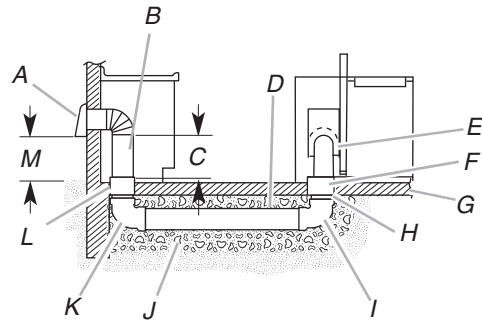

- A. Wall cap
- B. 6" (15.2 cm) round metal vent
- C. 16" (40.6 cm) maximum
- D. 6" (15.2 cm) round PVC sewer pipe
- E. 6" (15.2 cm) round metal vent transition with damper (supplied)
- F. 6" (15.2 cm) round PVC coupling
- G. Concrete slab
- H. 6" (15.2 cm) round PVC sewer pipe
- I. 6" (15.2 cm) round 90° PVC sewer pipe elbow
- J. Tightly pack gravel or sand completely around pipe.
- K. 6" (15.2 cm) round 90° PVC sewer pipe elbow
- L. 6" (15.2 cm) round PVC coupling
- M. 12" (30.5 cm) minimum





Calculating Vent System Length

3 1/4" x 10" (8.3 cm x 25.4 cm) rectangular vent is required from the blower motor box. It can be transitioned to 6" (15.2 cm) round vent if needed.

Maximum Length of Vent System

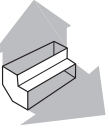
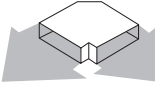
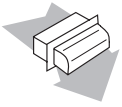
Vent	Length
6" (15.2 cm) round	35 ft (8.9 m)
3 1/4" x 10" (8.3 cm x 25.4 cm)	35 ft (8.9 m)

To calculate the length of the system you need, add the equivalent feet (meters) for each vent piece used in the system.

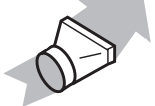
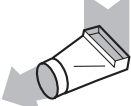
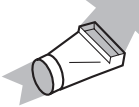
Vent Piece		3 1/4" x 10" (8.3 cm x 25.4 cm) Rectangular
3 1/4" x 10" (8.3 cm x 25.4 cm) 90° elbow	5.0 ft (1.5 m)	
3 1/4" x 10" (8.3 cm x 25.4 cm) flat elbow	12.0 ft (3.7 m)	
3 1/4" x 10" (8.3 cm x 25.4 cm) wall cap	0.0 ft (0.0 m)	
Vent Piece		6" (15.2 cm) Round
45° elbow	2.5 ft (0.8 m)	
90° elbow	5.0 ft (1.5 m)	
6" (15.2 cm) wall cap	0.0 ft (0.0 m)	
3 1/4" x 10" (8.3 cm x 25.4 cm) to 6" (15.2 cm) transition	4.5 ft (1.4 m)	
6" (15.2 cm) to 3 1/4" x 10" (8.3 cm x 25.4 cm) transition	1 ft (0.3 m)	
3 1/4" x 10" (8.3 cm x 25.4 cm) to 6" (15.2 cm) 90° elbow transition	5.0 ft (1.5 m)	
6" (15.2 cm) to 3 1/4" x 10" (8.3 cm x 25.4 cm) 90° elbow transition	5.0 ft (1.5 m)	

Example Vent System

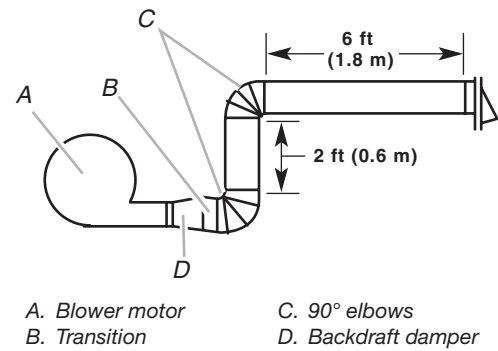

The following example falls within the maximum vent length of 35 ft (8.9 m).

2 - 90° elbow	= 10.0 ft (3 m)
1 - wall cap	= 0.0 ft (0.0 m)
8 ft (2.4 m) straight	= 8.0 ft (2.4 m)
Transition	= 4.5 ft (1.4 m)

Length of 6" (15.2 cm) or 3 1/4" x 10" (8.3 cm x 25.4 cm) system = 22.5 ft (6.8 m)

Install Vent System

⚠ WARNING

Excessive Weight Hazard

Use two or more people to move and install downdraft vent.

Failure to do so can result in back or other injury.

1. Place cardboard or similar material on top of a flat surface where you can easily assemble the downdraft vent system.
2. Remove parts packages, downdraft vent, and blower box from the carton.
3. Remove all shipping materials, tape, and film from the downdraft vent and blower box.
4. Measure distance "X" from the cabinet floor to the top of the countertop. Subtract 28 1/2" (72.4 cm) from distance "X" to determine dimension "Y" ($X - 28\frac{1}{2} = Y$).

