

MODELDual Zone Wine Cooler
Black Stainless Steel**PRW24C02CB SG**

Size 24" **610mm**
Dimensions 23-7/8"W x 33-7/8"H x 23-5/8"D
Weight 129lbs.
Installation Type Compact / Built-in / Freestanding
Refrigerant Type R600a

FEATURES

Capacity 45 bottles (750 ml)
Volume 5.2 cu/ft
Temperature Range 38° - 65° F (each zone)
Sound Level 39 dBA
Door Finish Black Stainless + Glass
Cabinet Finish Black
Interior Finish Black
Field-Reversible Door Yes
Zero-Clearance Door Hinge Yes, concealed
Door Glass Dual-pane, Low-e Argon-filled
Shelving 5 full-extension, black wood racks w/
black stainless trim
Controls 3-Color Electronic Touch
Lighting 3-Color LED Light Strips
Cloud White, Deep Blue, Amber
Four Light Levels Yes
Door Open Alarm Yes, after 3 minutes
Door Lock Yes
Sabbath Mode Yes
ENERGY STAR® Certified Yes
Air Filtration Yes, w/ carbon filter
PreciseTemp™ Yes
Active Cooling Technology Yes
Vibration Dampening System Yes

AC POWER 115V, 60Hz at Max. 1.5A**OPTIONAL ACCESSORIES**

Contemporary Handle Kit PRHAN-C102 (Brushed Gold)
Contemporary Handle Kit PRHAN-C104 (Matte Black)

WARRANTY 2 years parts, 2 years labor
 5 years compressor

DID YOU KNOW?

The designated 7 bottle capacity rack easily stores large diameter bottles such as pinot noir, chardonnay, and champagne.

Transforming the Kitchen through Design, Discovery, and Care

Specifications subject to change, check zephyronline.com for up-to-date information.
 Zephyr | 2277 Harbor Bay Parkway, Alameda, CA 94502 | 888.880.8368

MAR23.0101

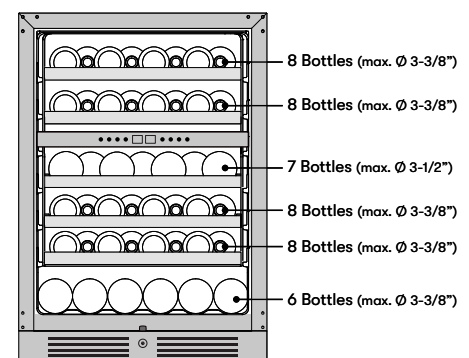
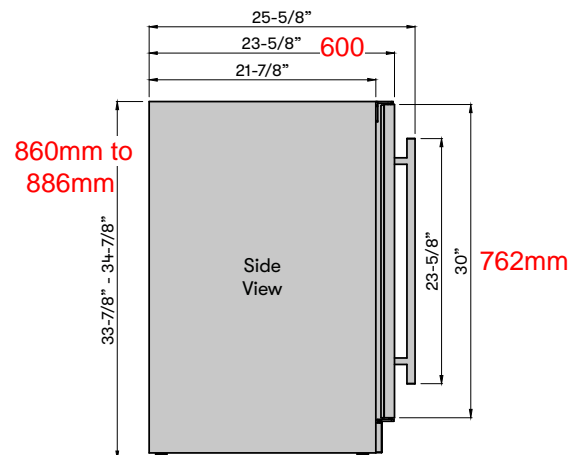
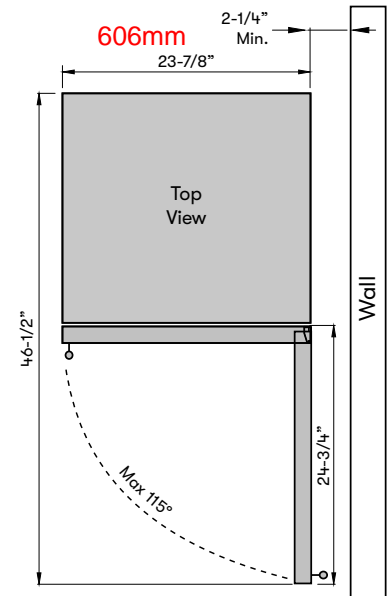

CVA 7845

24" Built-In Coffee Machine With DirectWater - PureLine

Features:

- M-Touch Display - Simple to use touch controls
- WifiConn@ct - Monitor appliances from your mobile device
- Coffee Select - choose between up to 3 different bean varieties
- AutoClean and AutoDescale - run most maintenance programs automatically



MATERIAL

11733840

SPECIFICATIONS	
Overall Unit Dimensions	23 ⁷ / ₁₆ " (595 mm) W x 17 ¹⁵ / ₁₆ " (477 mm) H x 19 ⁵ / ₈ " (498 mm) D [including water connection]
Niche	
Minimum Cabinet Niche Opening	22 ¹ / ₈ " (562 mm) W x 17 ¹¹ / ₁₆ " (450 mm) H x 24" (610 mm) D
Plumbing	
Water Supply Requirements	Connect to a cold water supply only. Must be connected to a shut-off valve. The water shut-off valve must be accessible after installation. The water pressure must be between 14.5 psi (1 bar) and may not exceed 145 psi (10 bar). If the pressure is higher than 145 psi (10 bar), a pressure reducing valve must be installed.
Water Connection Line	³ / ₄ " BSP to ¹ / ₄ " Compression fitting is supplied. Suitable ¹ / ₄ " O.D flexible water line or copper piping is not supplied. Maximum water line length 4'11" (1.5 m).
Electrical	
Electrical Requirements	120V, 60Hz, 15 Amps
Power Cord	NEMA 5-15 plug, 6 ft (1.8 m)
Shipping	
Shipping Weight	65 lbs (29.4 kg)
Shipping Dimensions	22 ¹ / ₁₆ " (560 mm) W x 22 ¹ / ₁₆ " (560 mm) H x 25 ³ / ₁₆ " (640 mm) D

PRODUCT DIMENSIONS

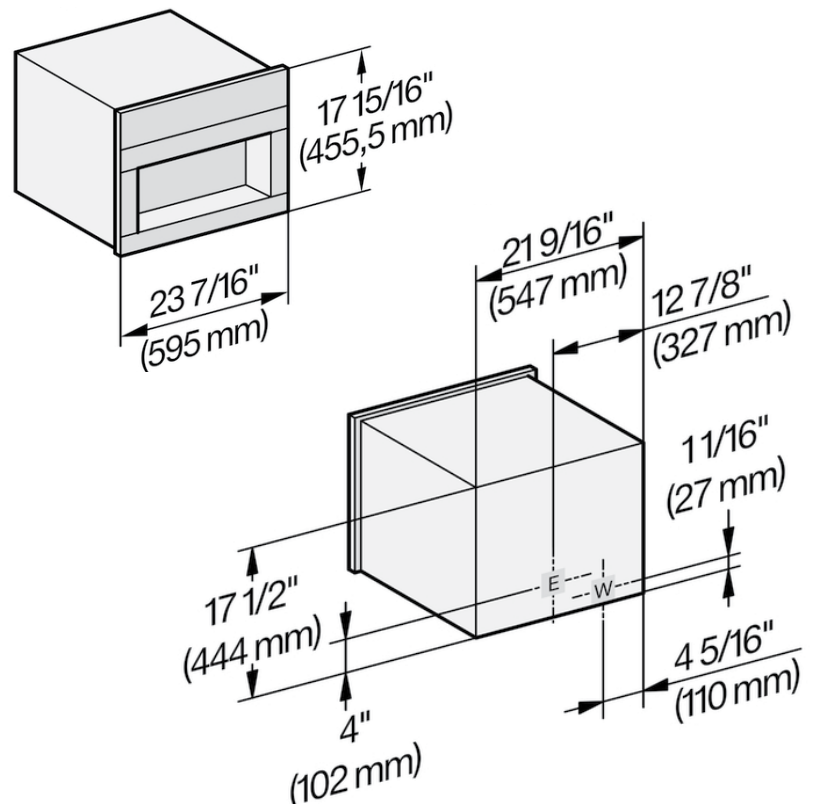

PROUD CUTOUT DIMENSIONS

Front View

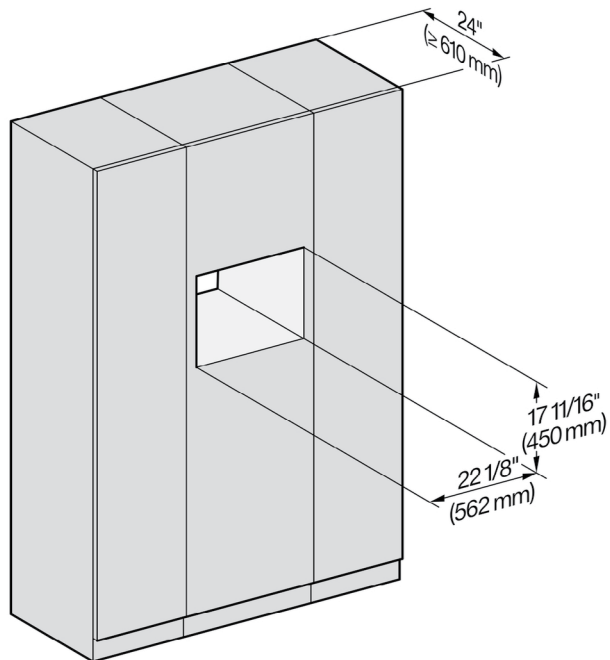

Side View

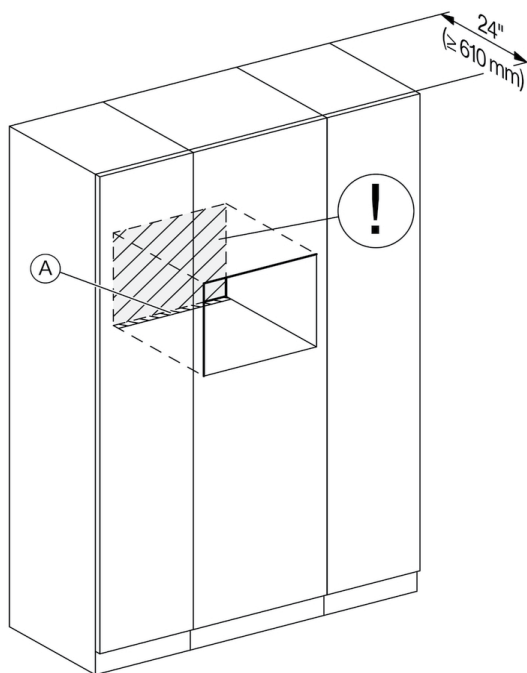
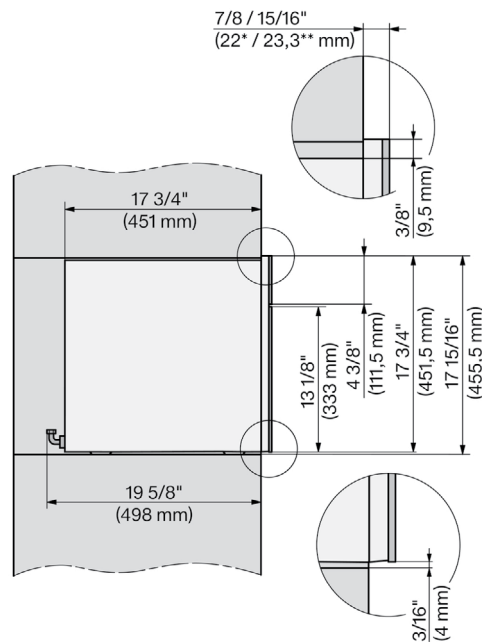

A - Cut-out (4" x 28" [100 mm x 720 mm]) in the bottom of the cabinet for the power cord and Ventilation

ⓘ - Electrical and water supplies are recommended to be placed in adjacent cabinetry.

Additional cabinet depth is required when placing the electrical and water supplies behind the appliance.