

# 24" MARVEL All Refrigerator

Model # ML24RAS1\*\*



Certified to meet  
ENERGY STAR® requirements

- Dynamic Cooling Technology™ delivers rapid cooldown and the industry's best temperature stability
- MARVEL Intuit™ Integrated Controls ensure precise temperature management from 34°F to 42°F
- Flat interior door allows for full-depth storage
- Cantilevered FreshFlo™ white commercial-grade steel shelves are perforated to allow cool air to efficiently circulate throughout the cabinet
- Pristine arctic white interior easily wipes clean and efficient white LED lighting illuminates interior for better viewing
- Close Door Assist System™ gently and automatically closes door
- Audible and visual alarms signal when door is left ajar to protect food integrity and energy use
- Vacation/Sabbath mode conserves energy during times when the unit is not in use and complies with Star-K requirements
- Height adjustment up to 1" with leveling legs
- 4" black adjustable toe kick
- 1-year warranty



## Storage Capacity

Up to 190 12-oz cans

## Storage Configuration

(2) cantilever, fully adjustable FreshFlo™ white commercial-grade steel shelves

## Product Dimensions

23 $\frac{7}{8}$ " W x 33 $\frac{3}{4}$ " minimum H x 25 $\frac{5}{8}$ " D  
(including handle)

## Finish/Door Options

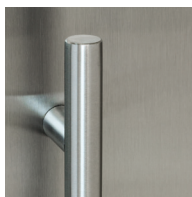

Stainless Steel

### Ordering Details

Solid Stainless Steel Door, Right Hinge	ML24RAS1RS
Solid Stainless Steel Door, Left Hinge	ML24RAS1LS

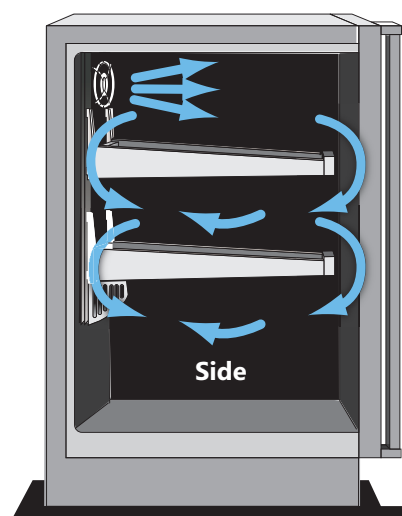
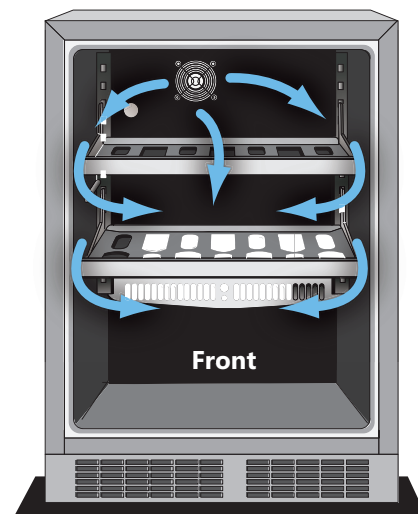
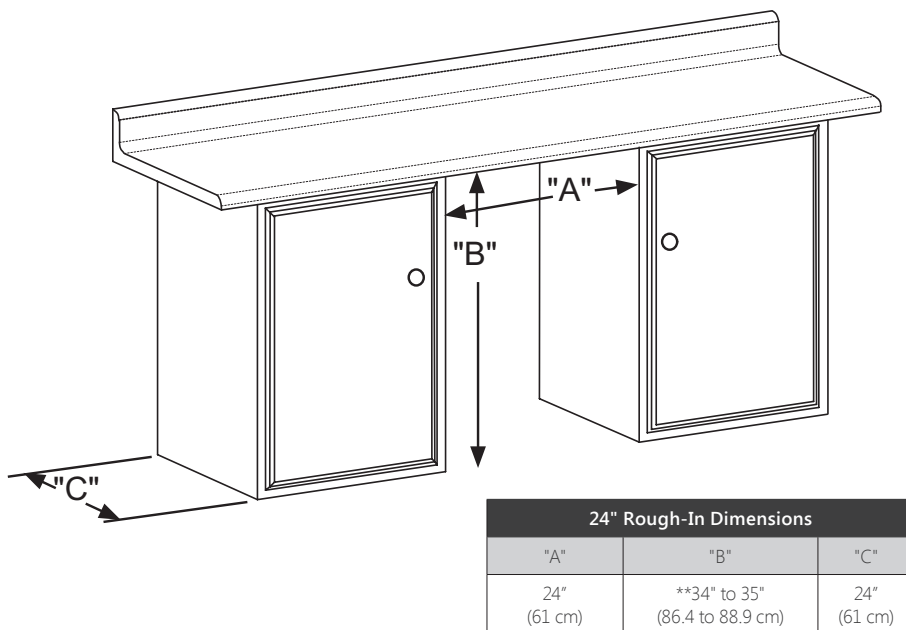

## Dynamic Cooling Technology™ delivers rapid cool down and the industry's best temperature stability

The distinctive Marvel design features a thermal-efficient cabinet and door combined with Dynamic Cooling Technology™ for superior temperature stability, faster cooling times and speedy temperature recovery even with high frequency.

Cabinet Dimensions		
"D"	"E"	"F"
23 7/8" (60.7 cm)	33 3/4" to 34 3/4" (85.7 to 88.3 cm)	23 23/32" (60.2 cm)
"G"	"H"	"J"
25 21/32" (65.2 cm)	46 13/32" (117.9 cm)	25 11/16" (65.2 cm)

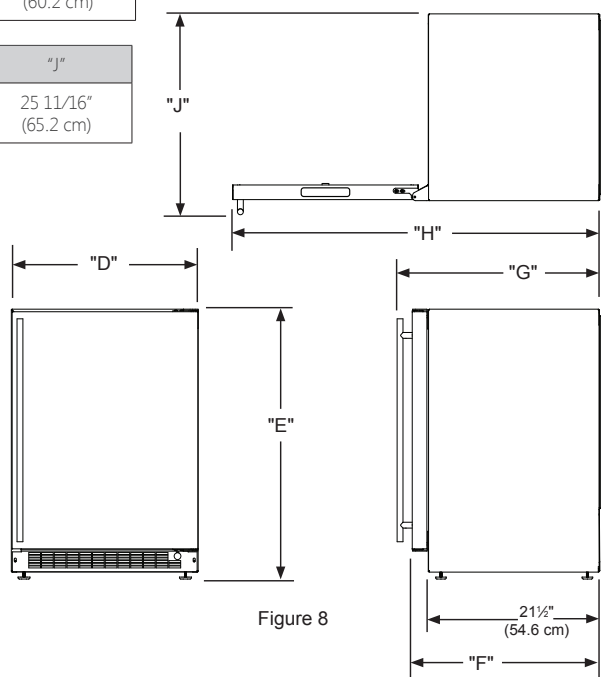

Figure 8

Width	23 7/8"
Interior Finish	White
Capacity	up to 190 12-oz cans
Shelving System	Cantilever
Shelf Fronts	Black painted maple
Other Storage	NA
Interior Lighting	2 White LED Pods
Toe Grill Finish	Black
Hinge	Classic Hinge
Handle	Designer

Control Type	Intuit™
Temperature Range	34° - 42° F
Lock	NA
Electrical Requirements	120V / 60Hz / 15A
Length of Power Cord	5'
Product Dimensions	23 7/8" W x 33 3/4" H x 21 1/2" D
Depth to Front of Door	23 23/32"
Depth to Handle	25 21/32"
Depth with door at 90°	46 13/32"
Shipping Weight	160 lbs

Finishes	SS
Vacation / Sabbath Mode	Yes
Agency Approvals	CSA

## Finishes Key

SS = Stainless Steel

**MOEN®**

# Specifications

Model Number	Faucet Holes	Depth-Inches	Drain Placement	ADA/FHA Compliant
G18190	N/A	10"	Center	No
G18191	N/A	8"	Center	No
G18192 (pictured)	N/A	7"	Center	No
G18192B	N/A	7"	Rear (Center)	FHA
G18192L	N/A	7"	Rear (Left)	FHA
G18195	N/A	5-1/2"	Rear (Center)	ADA/FHA
G18195L	N/A	5-1/2"	Rear (Left)	ADA/FHA

## SINK DESCRIPTION

- 1800 Series single bowl undermount sink
- 18 gauge stainless steel, brushed finish
- Mounting brackets included, no other hardware included
- SoundSHIELD™ sound absorbing system

## WARRANTY

- Lifetime limited warranty to the original homeowner
- 10 year limited warranty when used in a Multi-family installation
- 5 year limited warranty when used in a Commercial installation
- Visit [www.moen.com/customer-support/warranty](http://www.moen.com/customer-support/warranty) for complete details and limitations

## SINK DIMENSIONS

- Overall: 23" x 18"
- Bowl: 21" x 16"
- Drain Size: 3-5/8"

## CUT OUT DIMENSIONS

- Cut out template included
- Template ordering number 22507

## CRITICAL DIMENSIONS

(DO NOT SCALE)

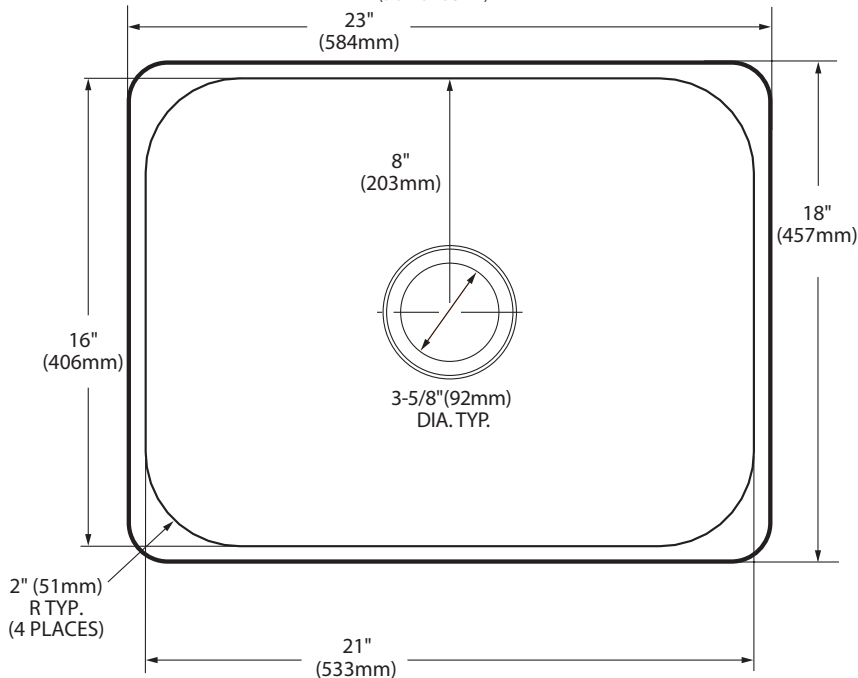

## STANDARDS

- Third party certified to meet ASME A112.19.3/CSA B45.4 and all applicable specifications referenced therein
- \***ADA/FHA** Sink compliant to ADA (ICC A117.1) and FHA accessibility specifications when installed to these required standards. Always consult with your local building department for the specific installation requirements.
- \***FHA** Sink compliant to FHA accessibility specifications when installed to these required standards. Always consult with your local building department for the specific installation requirements.

## Rear Configuration

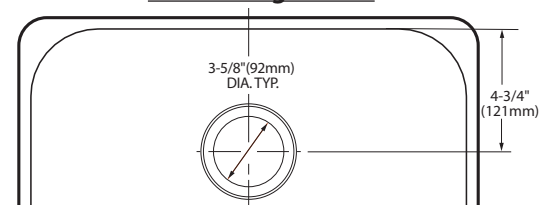

## Left Rear Configuration

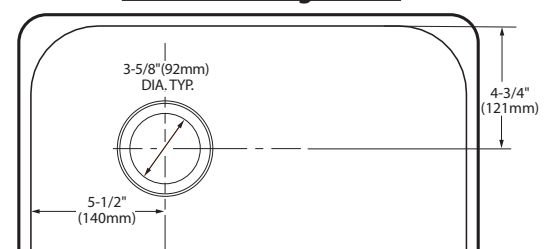

## Installation Detail

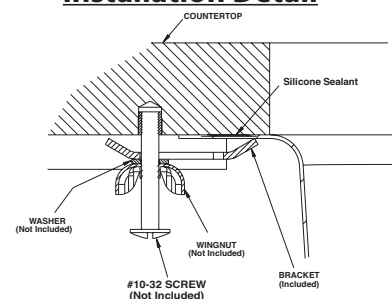
**MADE IN THE USA**



# 15" Marvel Clear Ice Machine with Arctic White Illuminice™ Lighting

Model # ML15CL & ML15CP

## Performance

- The quietest ice machine you can buy
- Energy-saving options conserve water and energy
- Engineered to consistently produce pure, clear ice with unrivaled clarity, immediate cooling and slower melt
- Its uniform size and compact density prove to be the optimal shape to provide faster cooling, while taking up less space in your glass
- Produces up to 39 pounds of clear ice daily, the equivalent of nearly eight convenience-store bags of ice
- Streamlined componentry and single-connection water fitting for simple installation

## Storage Capabilities

- Large-capacity bin stores 35 pounds of clear ice, while preserving quality and assuring fresh ice production
- Easy-to-clean, hygienic interior surface

## Touchpad Controls

- Marvel Intuit™ Integrated Controls feature all-new settings for ultimate programmability
- Eco Ice™ mode moderates ice production to conservative usage, saving 25% water (91 gallons monthly) and 25% energy (\$45 annually)\*\*
- Delay Start/Vacation option automatically postpones operation by 1/4/6/8 (hour or day) intervals, preventing wasteful water use
- Audible alerts and programmed cleaning reminders

## Aesthetics

- Illuminice™ feature projects arctic white LED light through clear ice for a dazzling illumination effect
- First-ever glass door model with midnight black interior adds drama to entertaining at home
- Easy-to-install panel-ready option includes soft-close integrated hinge
- Finish options: stainless steel, black or overlay panel

## Additional Convenience

- Close Door Assist System™ prevents energy loss by automatically drawing door to a gentle close
- Black toe kick adjustable to 4" with leveling legs
- 1-year parts and labor warranty, 5-year sealed system parts warranty (see owner's guide for details)

\*\*Based on national average of \$0.12 kWh at 100% operation  
Note: Ice production rate optimal when ambient air and water temperature is at or below 72° F.



## Marvel ML15CPS2RS Ice Machine



## Ordering Options

### Gravity Drain Applications

Solid Stainless Steel Door, Right Hinge	ML15CLS2RS
Solid Stainless Steel Door, Left Hinge	ML15CLS2LS
Stainless Frame, Glass Door, Right Hinge	ML15CLG2RS
Stainless Frame, Glass Door, Left Hinge	ML15CLG2LS
Black Door, Right Hinge	ML15CLS2RB
Black Door, Left Hinge	ML15CLS2LB
Panel-Ready Solid Overlay Door, Integrated Right Hinge*	ML15CLP3RP
Panel-Ready Solid Overlay Door, Integrated Left Hinge*	ML15CLP3LP

### Factory Installed Pump

Solid Stainless Door, Right Hinge	ML15CPS2RS
Solid Stainless Door, Left Hinge	ML15CPS2LS
Stainless Frame, Glass Door, Right Hinge	ML15CPG2RS
Stainless Frame, Glass Door, Left Hinge	ML15CPG2LS
Black Door, Right Hinge	ML15CPS2RB
Black Door, Left Hinge	ML15CPS2LB
Panel-Ready Solid Overlay Door, Integrated Right Hinge*	ML15CPP3RP
Panel-Ready Solid Overlay Door, Integrated Left Hinge*	ML15CPP3LP

\*Easy installation! No panel kit required. Consult your cabinet maker for overlay panel and handle options.



## Finish Options



Solid Stainless Steel



Stainless Steel Frame



Solid Overlay (Panel Ready)\*



Black

Technical drawing of a kitchen cabinet unit showing front, side, and top views with dimensions A through H.

- Front View:** Shows the main cabinet body with a width dimension **"A"** and a height dimension **"B"**. A circular handle is indicated.
- Side View:** Shows the depth of the cabinet with a dimension **"C"**. It also shows the height of the upper section as **"E"** and the total height as **"F"**.
- Top View:** Shows the width of the cabinet as **"H"** and the depth as **"G"**.
- Detail View:** A close-up of the bottom corner showing the internal structure and a dimension **"I"** for the base width.

**Left Hand Hinged Door**  
15" (38.1 cm) wide appliance

Clearance for screw head, 4 places

Hinge side of door

Clearance for hinge 2 places

14 1/4" (37.5 cm)

1/8" (6 mm) Deep

1" (25.4 mm) diameter counter bore 1/8" (6 mm) deep 4 places.

5" (12.7 cm)

4 1/4" (12.4 cm)

1 1/2" (3 cm)

3 1/8" (7.9 cm)

1 1/4" (4.4 cm)

1/8" (6 mm) radius is permissible

30 3/8" (77.1 cm)

1 1/8" (2.9 cm)

This side facing interior

1 1/8" (4.3 cm)

1 1/2" (3.8 cm) typical

3 1/8" (9.4 cm)

2" (5.1 cm)

**Right Hand Hinged Door**  
15" (38.1 cm) wide appliance

Top of door

Clearance for screw head, 4 places

Hinge side of door

Clearance for hinge 2 places

14 1/4" (37.5 cm)

1/8" (6 mm) Deep

1" (25.4 mm) diameter counter bore 1/8" (6 mm) deep 4 places.

4 1/4" (12.4 cm)

5" (12.7 cm)

1 1/2" (3 cm)

3 1/8" (7.9 cm)

1 1/4" (4.4 cm)

1/8" (6 mm) radius is permissible

30 3/8" (77.1 cm)

1 1/8" (2.9 cm)

This side facing interior

1 1/8" (4.3 cm)

2" (5.1 cm)

3 1/8" (9.4 cm)

1 1/2" (3.8 cm) typical

1 1/8" (4.3 cm)

A. Rough-In Width	15"
B. Rough-In Height	34" to 35"
C. Rough-In Depth	24"

D. Width	14 7/8"	
E. Height	33 3/4" to 34 3/4"	
Cabinet Depth	21 1/2"	
G. Depth to Front of Door	Solid Door	23 5/8"
	Overlay Door	22 7/8"
H. Depth to Handle	25 1/2" (Stainless Steel)	
I. Depth with door at 90°	Solid Door	37 3/8"
	Overlay Door	38 5/8"

Interior Cabinet Finish	Black
Capacity	35 lbs of Ice Storage
Shelving System	NA
Shelf Fronts	NA
Other Storage	Ice Bin
Interior Lighting	Illuminice™ LED Lighting
Toe Grill Finish	Black
Hinge	Classic Hinge
Handle	Slim Designer Handle (Panel Overlay Does Not Include Handle)
Control Type	Intuit™
Temperature Range	NA
Lock	No
Electrical Requirements	115V / 60Hz / 15A
Length of Power Cord	6'
Shipping Weight	127 lbs
Finishes	Stainless Steel, Overlay, Black
Vacation Mode	Yes
Agency Approvals	CSA

For comprehensive installation instructions, please visit [www.marvelrefrigeration.com](http://www.marvelrefrigeration.com) to access the owner's guide.