

## PRODUCT SPECIFICATIONS

Model	IC-24FI
Dimensions	24"W x 84"H x 24"D
Door Clearance	22 1/2"
Weight	340 lbs
Freezer Capacity	12.3 cu. ft.
Electrical Supply	115 VAC, 60 Hz
Electrical Service	15 amp dedicated circuit

## ELECTRICAL

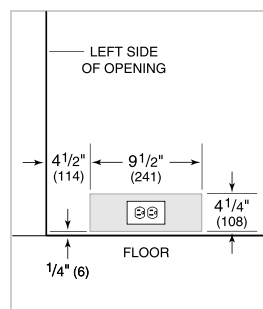

## PLUMBING

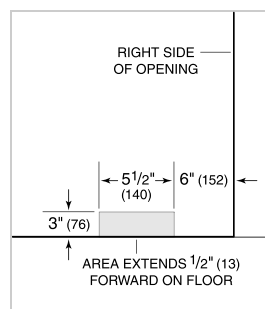

**PANEL SPECIFICATIONS** For complete panels specifications including width/height, weight requirements and thickness requirements visit [subzero-wolf.com/reveal](http://subzero-wolf.com/reveal).

**NOTE:** Dimensions in parenthesis are in millimeters unless otherwise specified

## INTERIOR VIEW

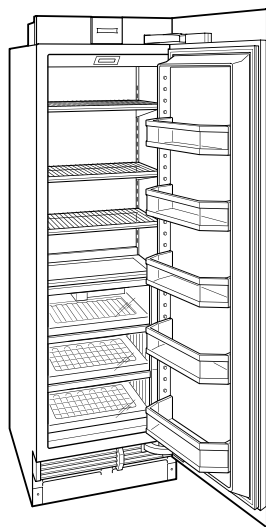

This illustration is intended for interior reference only and may not represent the exterior of the model being specified.

## DIMENSIONS

## Sub-Zero IC24FI Freezer

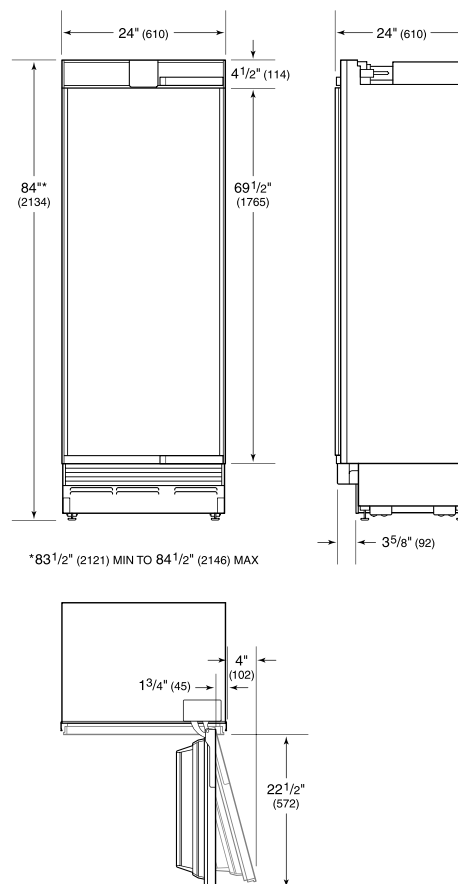

## STANDARD INSTALLATION

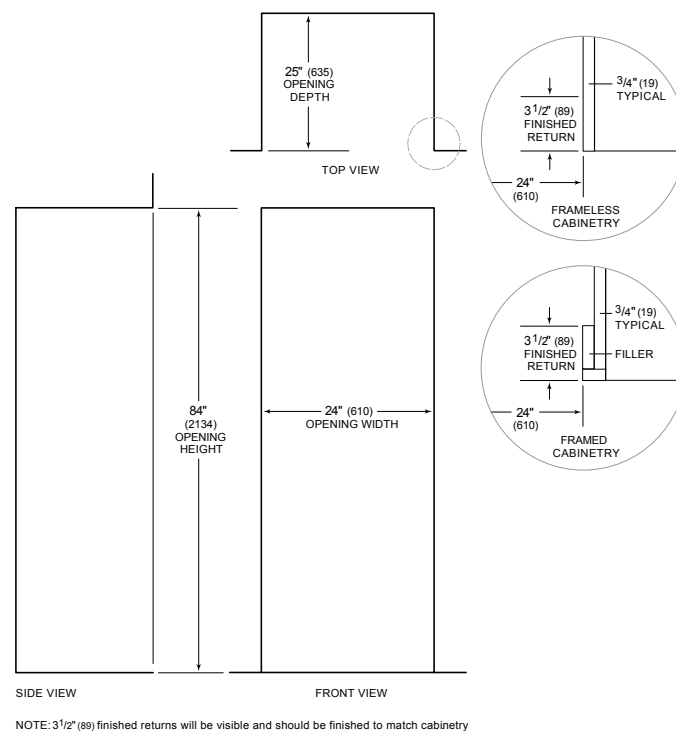

## PRODUCT SPECIFICATIONS

Model	WWD30
Dimensions	29 7/8"W x 10 3/8"H x 22 3/4"D
Capacity	1.6 cu. ft.
Electrical Supply	120 VAC, 60 Hz
Electrical Service	15 amp dedicated circuit
Power Cord Length	3 Feet
Receptacle	3-prong grounding-type

## ELECTRICAL

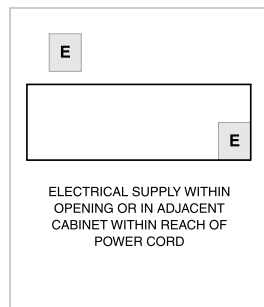

**INSTALLATION WITH FRONT PANEL** Accessory front panels may affect overall product dimensions and opening dimensions. Refer to Reveal for more information: [subzero-wolf.com/reveal](http://subzero-wolf.com/reveal)

**NOTE:** Dimensions in parenthesis are in millimeters unless otherwise specified

## DIMENSIONS

## Wolf WWD30 Warming Drawer

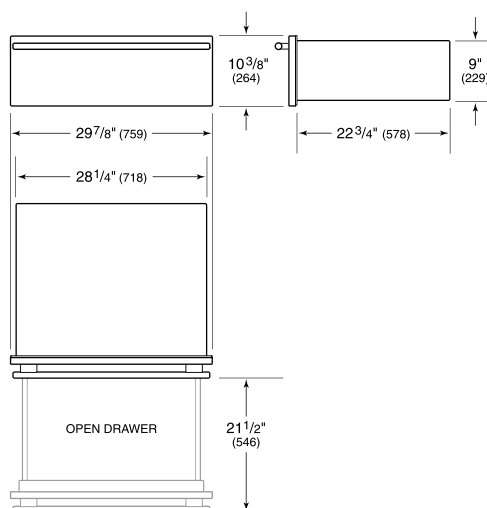

## FLUSH INSTALLATION

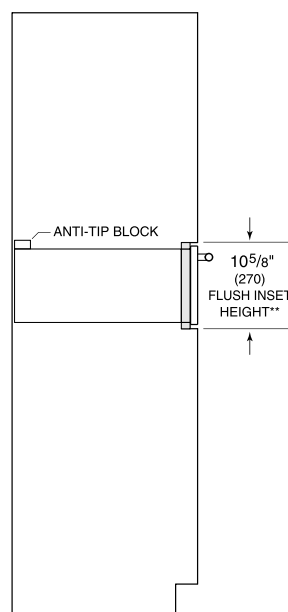
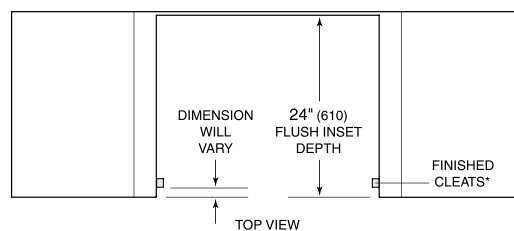

SIDE VIEW

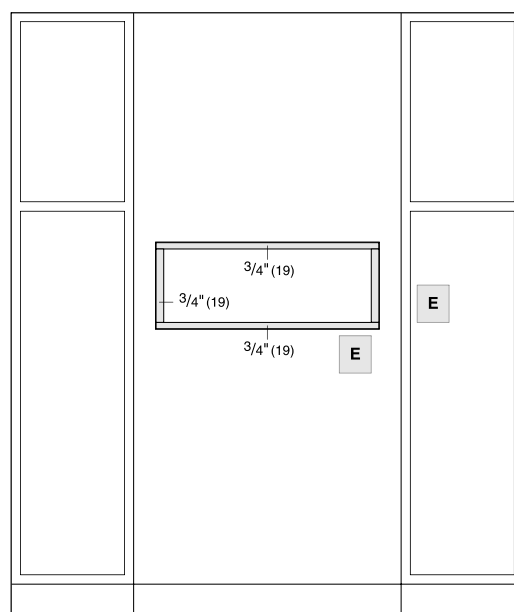

FRONT VIEW

*\*Will be visible and should be finished to match cabinetry.*

*NOTE: Location of electrical supply within opening may require additional cabinet depth.*

Warming Drawers

DRAWER FRONT OPTIONS

Wolf warming drawer fronts allow for many design options, but the warming drawer itself will be the same for all applications. A panel mounting kit is required when installing a custom panel. The panel mounting kit is available through an authorized Wolf dealer. For local dealer information, visit the find a showroom section of our website, [wolfappliance.com](http://wolfappliance.com).

The 2" (51) thick drawer front, in 30" and 36" widths, is designed to be installed below a sealed burner rangetop or outdoor gas grill, so the panel aligns properly with the front of the rangetop or grill. Dimensions for the warming drawer remain the same, even though the drawer front may be wider to match a Wolf 36" oven, sealed burner rangetop, or outdoor grill.

DIMENSIONS

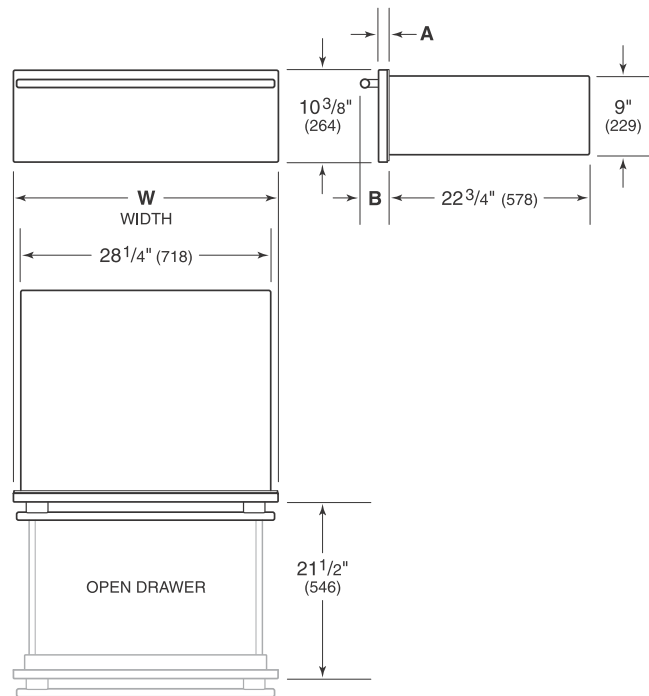

STAINLESS STEEL DRAWER FRONT

WIDTH	W	
30" Drawer Front	29 7/8" (759)	
36" Drawer Front	35 7/8" (911)	
M SERIES	A	B
Transitional/Professional	7/8" (22)	3 1/4" (83)
Contemporary Stainless	7/8" (22)	3 1/4" (83)
Contemporary Black	1" (25)	3 3/8" (86)
E SERIES	A	B
Transitional/Professional	1 1/8" (29)	3 1/2" (89)
Professional (2" thick)	2 1/8" (54)	4 1/2" (114)
Contemporary	1 1/4" (32)	3 5/8" (92)
L SERIES	A	B
Transitional	7/8" (22)	3 1/2" (89)

INTEGRATED DRAWER FRONT

CUSTOM PANEL	W	H	D
Dimensions (typical)	29 7/8" (759)	10 3/8" (264)	3/4" (19)
Min Thickness			5/8" (16)

## PRODUCT SPECIFICATIONS

Model	SO30CM/B
Dimensions	29 7/8"W x 28 1/2"H x 23"D
Oven 1 Interior Dimensions	25 1/4"W x 17 1/2"H x 19 7/8"D
Overall Capacity	5.1 cu. ft.
Usable Capacity	3.3 cu. ft.
Door Clearance	21 3/8"
Electrical Supply	240/208 VAC, 60 Hz
Electrical Service	30 amp dedicated circuit
Conduit Length	4 Feet

## ELECTRICAL

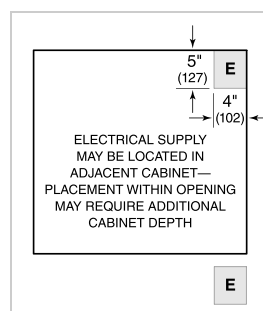

**NOTE:** Dimensions in parenthesis are in millimeters unless otherwise specified

## DIMENSIONS

### Wolf SO30CMB Oven

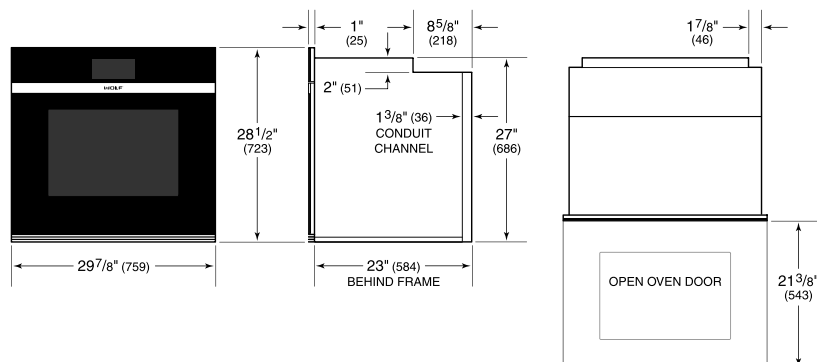

## FLUSH INSTALLATION

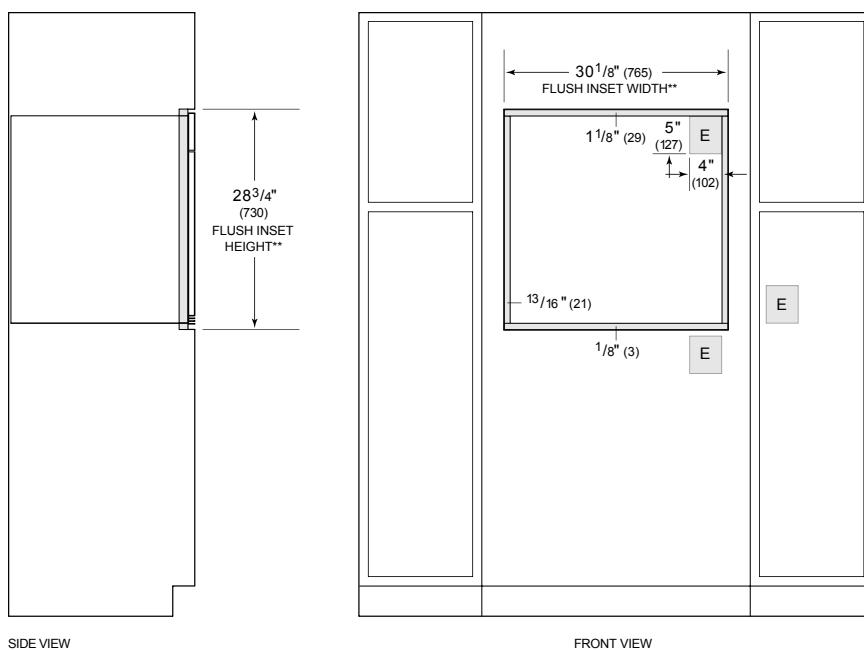
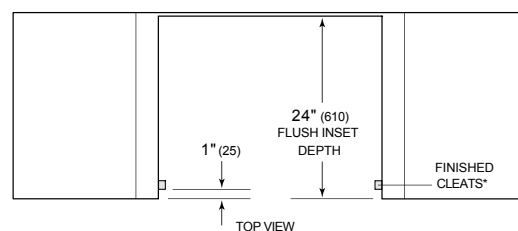

SIDE VIEW

FRONT VIEW

\*1" (25) minimum depth. Shaded areas will be visible and should be finished to match cabinetry.

\*\*Dimension provides minimum reveals

NOTE: Location of electrical supply within opening may require additional cabinet depth.

## PRODUCT SPECIFICATIONS

Model	IC-24R
Dimensions	24"W x 84"H x 24"D
Door Clearance	22 1/2"
Weight	340 lbs
Refrigerator Capacity	12.9 cu. ft.
Electrical Supply	115 VAC, 60 Hz
Electrical Service	15 amp dedicated circuit

## ELECTRICAL

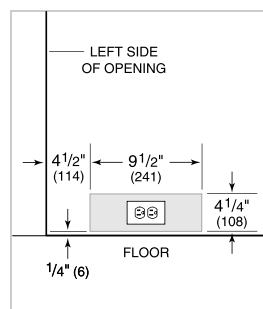

**PANEL SPECIFICATIONS** For complete panels specifications including width/height, weight requirements and thickness requirements visit [subzero-wolf.com/reveal](http://subzero-wolf.com/reveal).

**NOTE:** Dimensions in parenthesis are in millimeters unless otherwise specified

## INTERIOR VIEW



This illustration is intended for interior reference only and may not represent the exterior of the model being specified.

## DIMENSIONS

## Sub-Zero IC24R Refrigerator

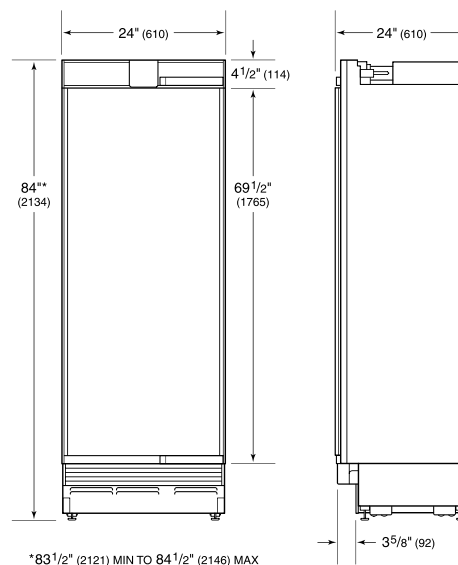

\*83 1/2" (2121) MIN TO 84 1/2" (2146) MAX

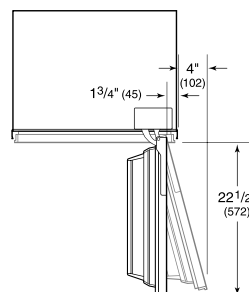

## STANDARD INSTALLATION

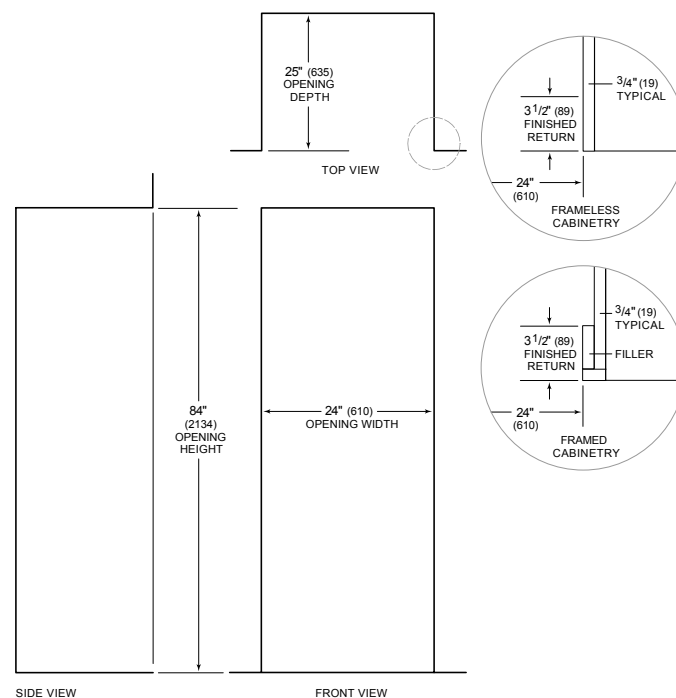

SIDE VIEW

FRONT VIEW

NOTE: 3 1/2" (89) finished returns will be visible and should be finished to match cabinetry

Custom Panels

TYPICAL PANEL DIMENSIONS

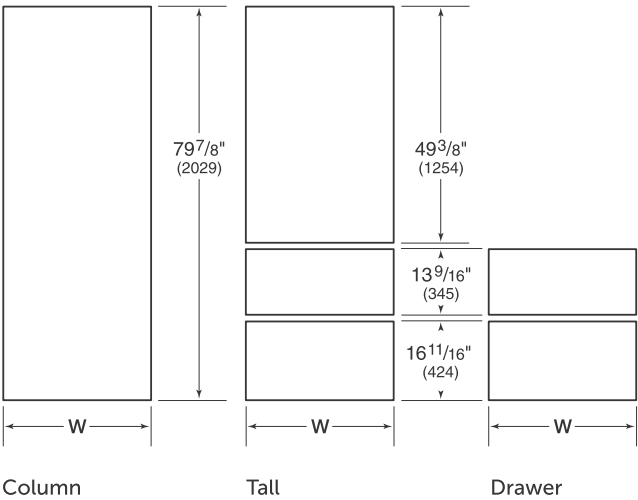

Typical panel dimensions are based on an 84" (2134) finished height for column and tall models and 34 1/2" (876) for drawer models, with a 4" (102) toe kick and 1/8" (3) reveals. Panel dimensions must be adjusted accordingly for all other installations. Refer to the illustration for panel height and the chart below for panel width.

PANEL WIDTH	W
18" Model	17 3/4" (451)
24" Model	23 3/4" (603)
27" Model	26 3/4" (679)
30" Model	29 3/4" (756)
36" Model	35 3/4" (908)

DUAL INSTALLATION

For dual installations, refer to the illustration for panel height and the chart below for panel width.

PANEL WIDTH	W
18" Model	17 13/16" (452)
24" Model	23 13/16" (605)
27" Model	26 13/16" (681)
30" Model	29 13/16" (757)
36" Model	35 13/16" (910)

DOOR PANEL HEIGHT

The height of the custom door panel can extend beyond the typical panel height, provided it does not exceed the weight limit. Refer to the illustration below.

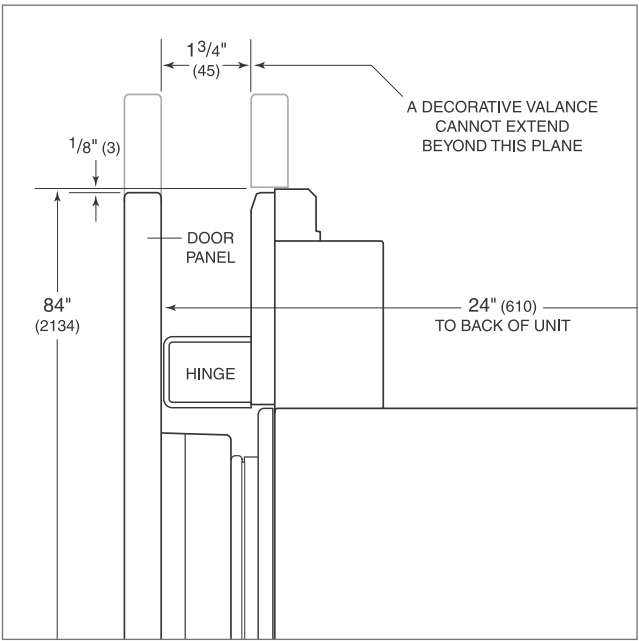

Upper valance—column and tall (side view)

# KOHLER®

## Prolific® Under-Mount Kitchen Sink K-5540

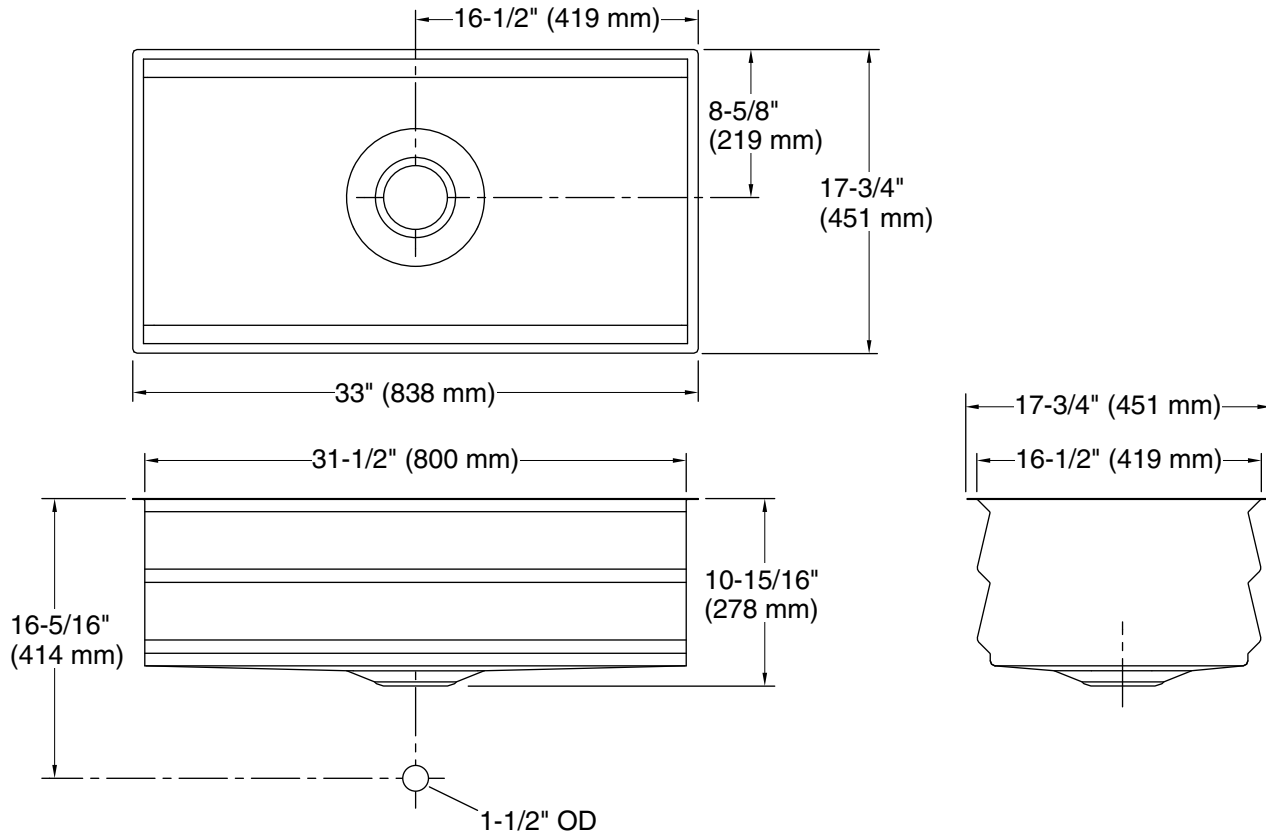

### Technical Information

All product dimensions are nominal.

Bowl configuration: Single

Installation: Under-mount

Min. base cabinet width: 36" (914 mm)

Bowl area (Only):

- Length: 31-1/2" (800 mm)
- Width: 16-1/2" (419 mm)
- Bowl depth: 10" (254 mm)
- Water depth: 10" (254 mm)

Drain hole: 3-3/4" (94 mm)

Template: 1093327-7, required, included

### Notes

Install this product according to the installation instructions.

PRODUCT SPECIFICATIONS

Model	DFI664XXL
Width	23 <sup>5</sup> / <sub>8</sub> "
Height	34" – 35 <sup>3</sup> / <sub>4</sub> "
Depth	22"
Door Clearance	24 <sup>5</sup> / <sub>8</sub> "
Weight	115 lb
Electrical Supply	115 VAC, 60 Hz
Service	15 amp dedicated circuit
Receptacle	3-prong grounding-type
Power Cord	4'
Water Connection	6' PEX tubing with 3/8" NPT female connection
Drain Connection	5' corrugated tubing
Pressure	4.2–140 psi

Product dimensions do not include panel and handle.  
Dimensions will vary with panel thickness.

Electrical supply, plumbing supply, and drain should be  
located in an adjacent cabinet. If not, they must be located  
within the shaded area shown in the illustrations below.

ELECTRICAL | PLUMBING

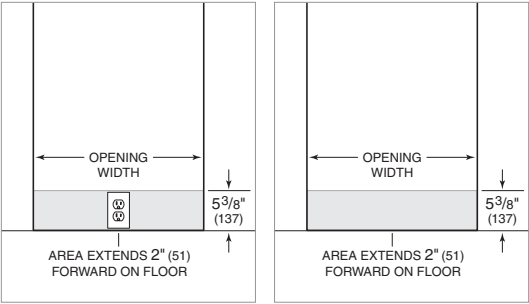

DIMENSIONS

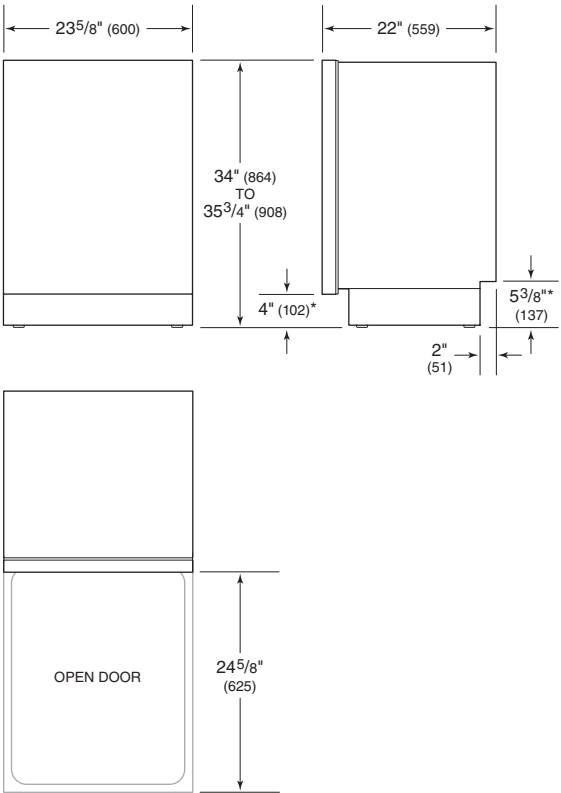

\*Dimension will vary with product height.

INSTALLATION

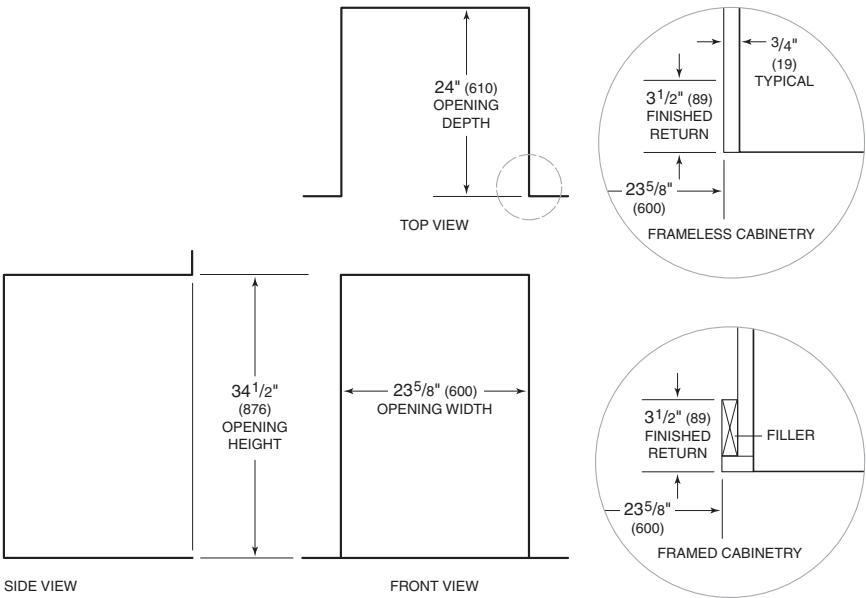

NOTE: 3<sup>1</sup>/<sub>2</sub>" (89) finished returns will be visible and should be finished to match cabinetry.



**MS24****FEATURES**

Utilizes 1200 watts of power to cook meals with delicious results

Rely on quick-start controls for tasks like melting, softening, defrosting, and popcorn

Choose freestanding or install into surrounding cabinetry to coordinate with other Wolf built-in ovens and warming drawers

Set the warm mode to hold temperature for up to 90 minutes

**ACCESSORIES**

Trim Kits - M Series

Trim Kits - E Series

Trim Kits - L Series

Accessories available through an authorized dealer.  
For local dealer information, visit [subzero-wolf.com/locator](http://subzero-wolf.com/locator).

**Wolf MS24 Microwave****TRIM OPTIONS****E SERIES STAINLESS****E SERIES BLACK****M SERIES STAINLESS****M SERIES BLACK**



PRODUCT SPECIFICATIONS

Model	MS24
Dimensions	24"W x 13 3/8"H x 19"D
Capacity	2 cu. ft.
Electrical Supply	120 VAC, 60 Hz
Electrical Service	15 amp dedicated circuit
Power Cord Length	4 Feet
Receptacle	3-prong grounding-type

ELECTRICAL

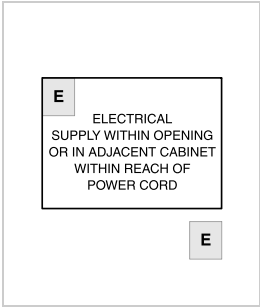

**INSTALLATIONS WITH ACCESSORY TRIM** Accessory trim may affect overall product dimensions and opening dimensions. Refer to Reveal for more information: [subzero-wolf.com/reveal](http://subzero-wolf.com/reveal)

**NOTE:** Dimensions in parenthesis are in millimeters unless otherwise specified

DIMENSIONS

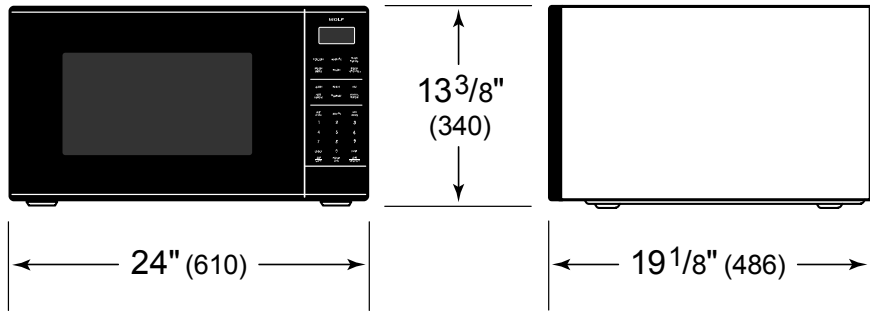

Convection Microwave Oven

M/E SERIES TRIM

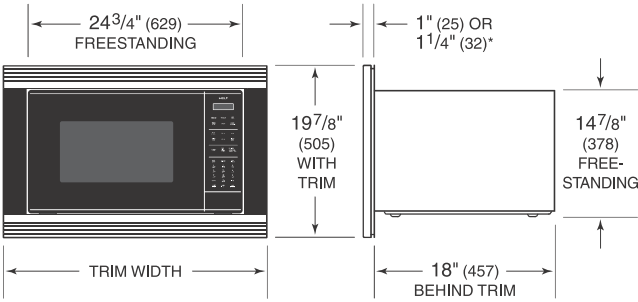

\*1 1/4" (32) for contemporary E series trim only.

L SERIES TRIM

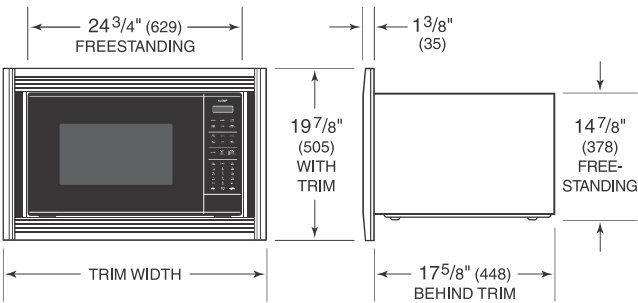

TRIM WIDTH	M SERIES	E SERIES	L SERIES
27" Trim	NA	26 7/8" (683)	NA
30" Trim	29 7/8" (759)	29 7/8" (759)	29 7/8" (759)
36" Trim	NA	NA	35 5/8" (905)

Standard Microwave Oven

M/E SERIES TRIM

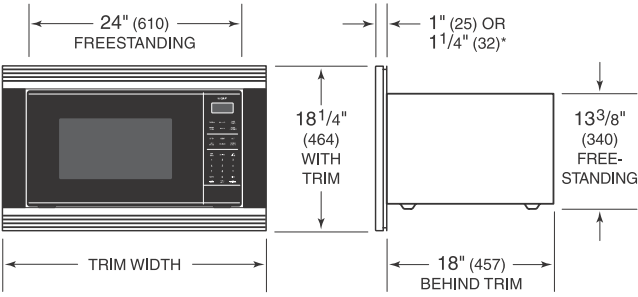

\*1 1/4" (32) for contemporary E series trim only.

L SERIES TRIM

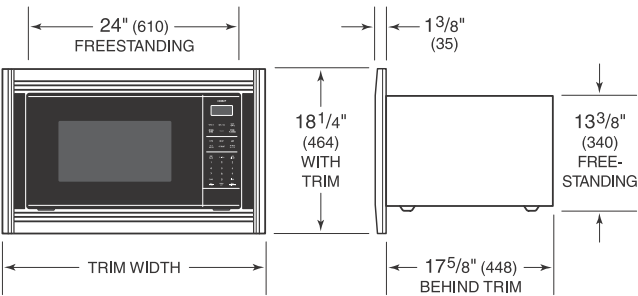

TRIM WIDTH	M SERIES	E SERIES	L SERIES
27" Trim	NA	26 7/8" (683)	NA
30" Trim	29 7/8" (759)	29 7/8" (759)	29 7/8" (759)



PRODUCT SPECIFICATIONS

Model	CI365T/S
Dimensions	36"W x 2"H x 21"D
Electrical Supply	3-wire, 240/208 VAC, 60 Hz
Electrical Service	50 amp dedicated circuit
Conduit Length	4 Feet

ELECTRICAL

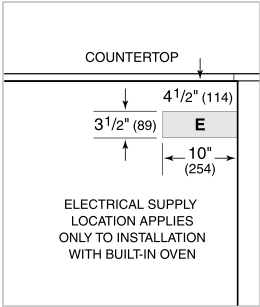

**NOTE:** Dimensions in parenthesis are in millimeters unless otherwise specified

DIMENSIONS

Wolf CI365TS Cooktop

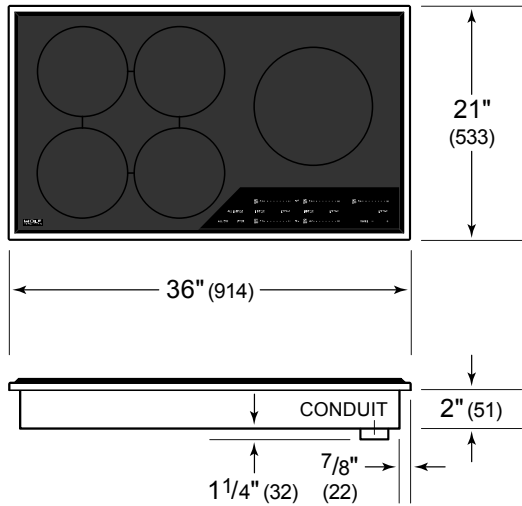

STANDARD INSTALLATION

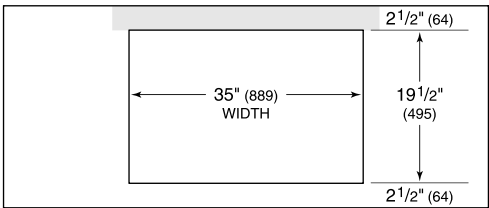

COUNTERTOP CUT-OUT

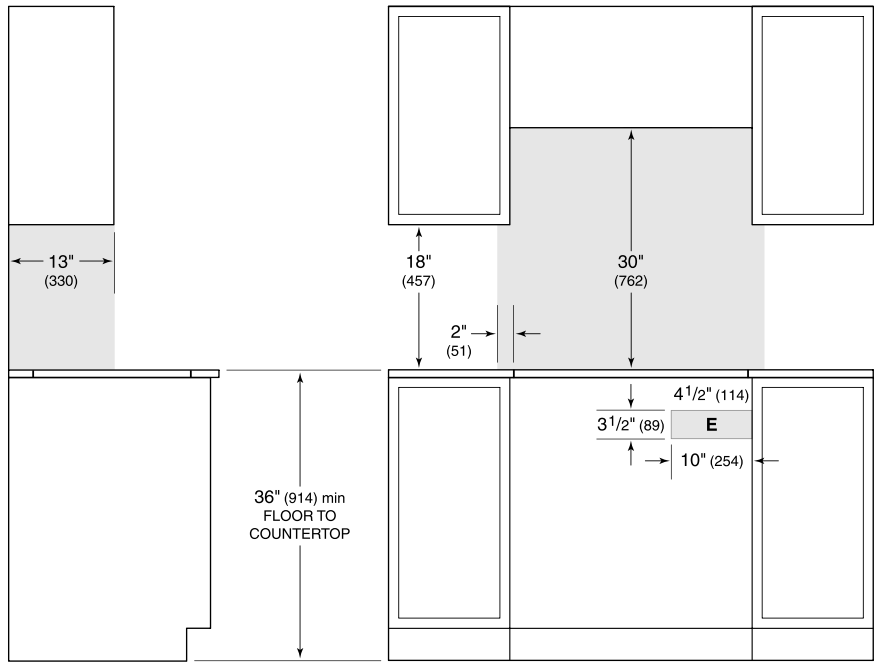

SIDE VIEW

FRONT VIEW

**NOTE:** Shaded area above countertop indicates minimum clearance to combustible surfaces, combustible materials cannot be located within this area.  
Electrical supply location only applies to installations with built-in oven.

## PRODUCT SPECIFICATIONS

Model	DD36
Dimensions	36"W x 14"H x 2"D
Weight	80 lbs
Electrical Supply	110/120 VAC, 60 Hz
Electrical Service	15 amp dedicated circuit
Discharge Location	Vertical or Horizontal
Discharge Dimensions	6" round internal or 10" round inline or remote
Receptacle	3-prong grounding-type

## ELECTRICAL

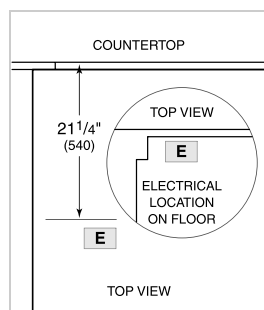

**NOTE:** Dimensions in parenthesis are in millimeters unless otherwise specified

## DIMENSIONS

### Wolf DD36 Downdraft

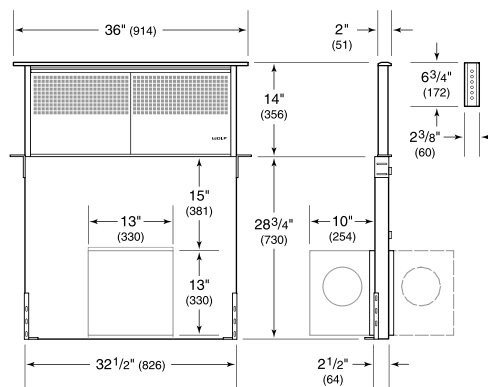

**NOTE:** Shown with front mounted internal blower with 6" (152) round discharge, dashed line represents rear mount.

## STANDARD INSTALLATION

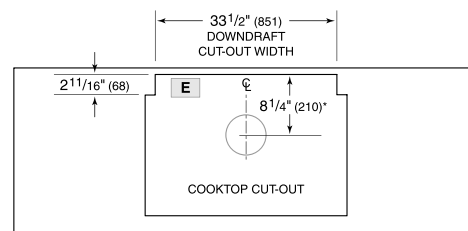

TOP VIEW

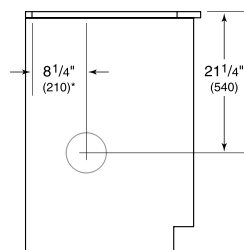

SIDE VIEW

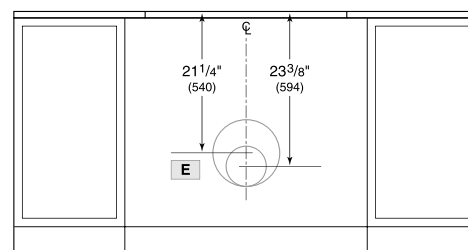

FRONT VIEW

\*6" (152) back from countertop cut-out when internal blower is rear mounted.

**NOTE:** Internal blower 6" (152) round, side, rear or bottom discharge. In-line and remote blower 10" (254) round, rear discharge. Centerline indicates center of downdraft cut-out.