

Fully Integrated 18" MasterCool

SPECIFICATIONS		
Overall Unit Dimensions	17 ³ / ₄ " (451 mm) W x 83 ³ / ₄ "- 85 ³ / ₁₆ " (2127 - 2164 mm) H x 24" (610 mm) D [Depth does not include door panel]	
Niche		
Minimum Cabinet Niche Opening	18" (458 mm) W* x 84" - 85 ³ / ₁₆ " (2134 - 2164 mm) H x 24 ³ / ₄ " (629 mm) D	
Electrical	F 24x2 Vi	
Electrical Requirements	110V / 120V, 60Hz, 15 Amps In the case of side-by-side installations, a separate outlet must be used for each appliance.	
Power Cord	NEMA 5-15 plug, 5 ft (1.52 m)	
Plumbing	F 24x2 Vi	
Water Supply Requirements	Connect to a cold water supply only. Do not connect to a low-mineral or a reverse osmosis system. Must be connected to a shut-off valve. The water shut-off valve must be accessible after installation. The water pressure must be between 29 psi (2 bar) and 116 psi (8 bar). If the pressure is higher than 120 psi (8.3 bar), a pressure reducing valve must be installed.	
Water Connection Line	Standard 1/4" O.D flexible water line. The maximum outer diameter of the water pipe (without fittings): 3/8" (10 mm). Water line is not included.	
Shipping	F 2412 Vi	F 2462 Vi / F 2472 Vi
Shipping Weight	306 lbs (139 kg)	328 lbs (149 kg)
Shipping Dimensions	21 ¹ / ₁₆ " (535 mm) W x 84 ¹ / ₄ " (1,240 mm) H x 29 ⁷ / ₈ " (759 mm) D	

Please note the following:

- This specification sheet is for a single built-in unit.
- When combining multiple MasterCool units side-by-side, please refer to the Merging Kit specification sheet.

*If design calls for a partition less than 6 ⁵/₁₆" (160 mm) the left unit's cutout will require an additional ¹/₈" (3 mm) to the width to allow installation of the Heating Mat/Merge Kit.



F 2412 Vi (Left Hinged)
Material# 11503300



F 2462 Vi (Right Hinged)
Material# 11503420

F 2472 Vi (Left Hinged)
Material# 11503430

Fully Integrated 18" MasterCool

CUTOUT DIMENSIONS

- Niche depth assumes a 3/4" (19 mm) panel, please adjust according to custom panel thickness

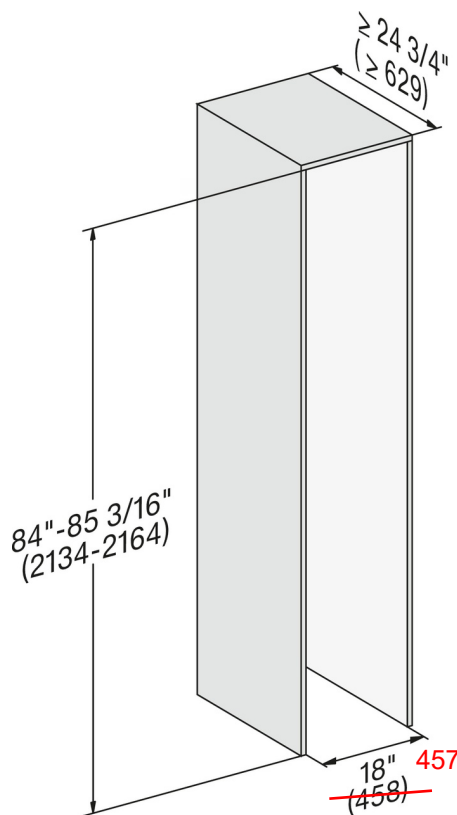

CUTOUT DETAILS

- The electrical connection must not be positioned higher than 9" (228.6 mm) above the floor.
- The 1/4" (6.4 mm) plumbed water connection should not be positioned higher than 2" (50.8 mm) above the floor.

Notes:

In case of an emergency the electrical outlet must be easily accessible and must not be concealed behind the appliance.

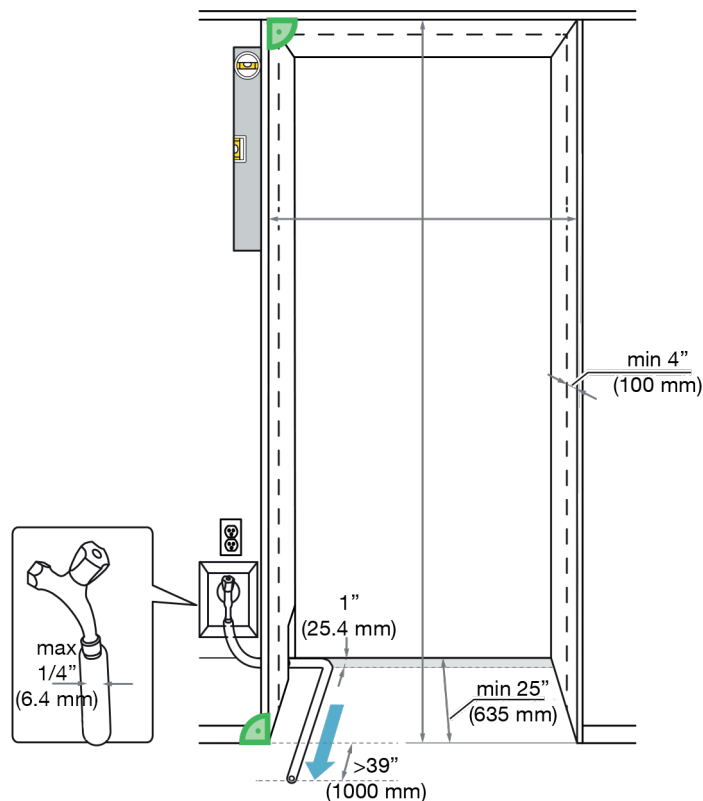

Fully Integrated 18" MasterCool

CUSTOM PANEL INSTALLATIONS

For Models:

- F 2412 Vi

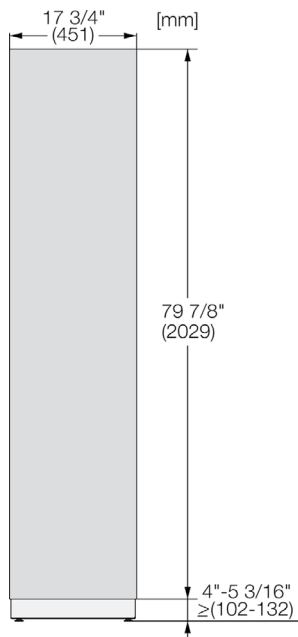

Max. Panel Weight: 134 lbs

Optional Accessory:

Clean Touch Steel Panel:

- KFP1805

Material# 11499020

For Models:

- F 2462 Vi
- **F 2472 Vi**

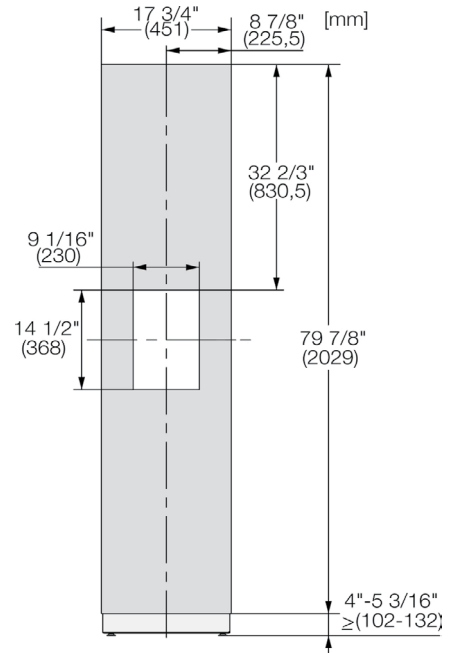

Max. Panel Weight: 159 lbs

Optional Accessory:

Clean Touch Steel Panel:

- KFP1845

Material# 11499570

PANELS NOTES

If the adjoining cabinets are taller than the height of the machine the panel may be extended accordingly

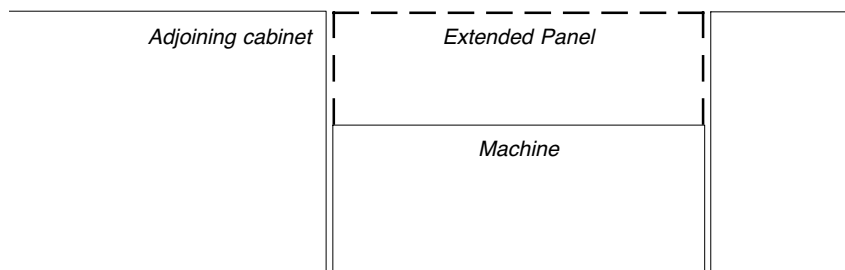

Fully Integrated 18" MasterCool

HINGING DETAILS 115° OPENING

Available for the following models:

- F 24x2 Vi

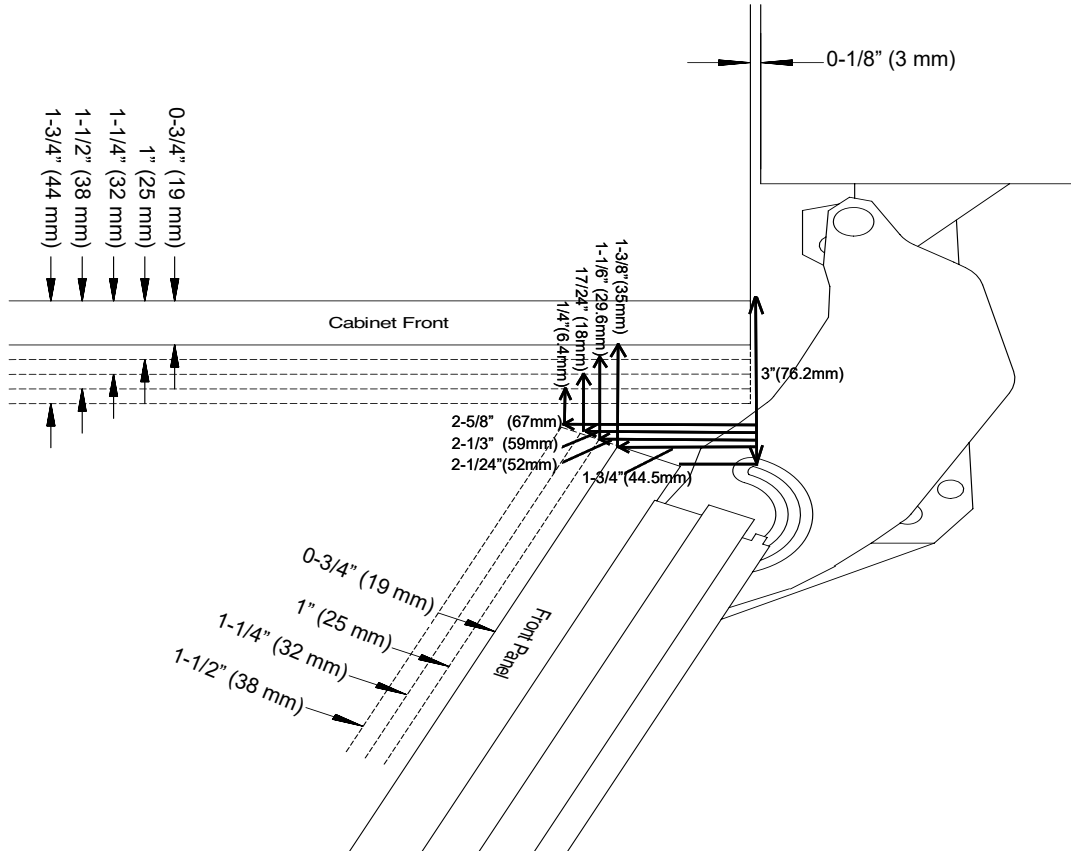

DOOR SWING AT 115° OPENING

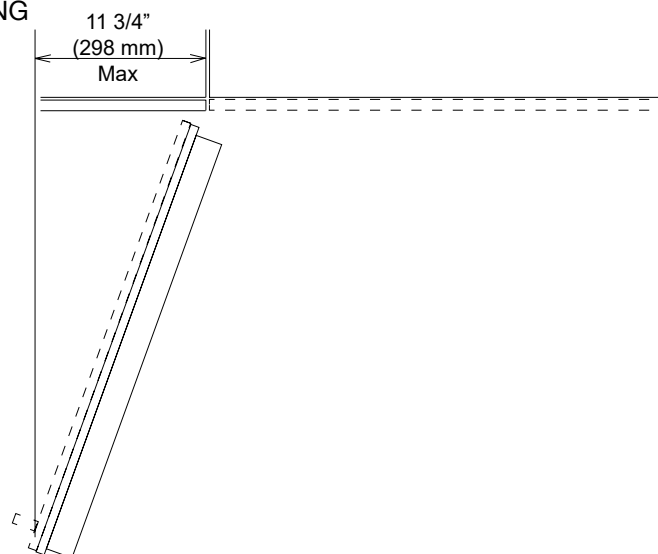

NOTE: Additional space needed depending on
thickness of front panels and handle used

Fully Integrated 30" MasterCool

SPECIFICATIONS			
Overall Unit Dimensions	29 ³ / ₄ " (756 mm) W x 83 ³ / ₄ "- 85 ³ / ₁₆ " (2127 - 2164 mm) H x 24" (610 mm) D [Depth does not include door panel]		
Niche			
Minimum Cabinet Niche Opening	30" (762 mm) W* x 84" - 85 ³ / ₁₆ " (2134 - 2164 mm) H x 24 ³ / ₄ " (629 mm) D		
Electrical	K 28x2 Vi	F 28x2 Vi	KF 28x2 Vi
Electrical Requirements	110V / 120V, 60Hz, 15 Amps In the case of side-by-side installations, a separate outlet must be used for each appliance.		
Power Cord	NEMA 5-15 plug, 5 ft (1.52 m)		
Plumbing	K 28x2 Vi	F 28x2 Vi	KF 28x2 Vi
Water Supply Requirements	-	Connect to a cold water supply only. Do not connect to a low-mineral or a reverse osmosis system. Must be connected to a shut-off valve. The water shut-off valve must be accessible after installation. The water pressure must be between 29 psi (2 bar) and 116 psi (8 bar). If the pressure is higher than 120 psi (8.3 bar), a pressure reducing valve must be installed.	
Water Connection Line	-	Standard 1/4" O.D flexible water line. The maximum outer diameter of the water pipe (without fittings): 3/8" (10 mm). Water line is not included.	
Shipping	K 28x2 Vi	F 28x2 Vi	KF 28x2 Vi
Shipping Weight	395 lbs (179 kg)	399 lbs (181 kg)	450 lbs (204 kg)
Shipping Dimensions	33 ⁵ / ₈ " (950 mm) W x 89 ¹³ / ₁₆ " (1,294 mm) H x 29 ¹ / ₄ " (800 mm) D		

Please note the following:

- This specification sheet is for a single built-in unit.
- When combining multiple MasterCool units side-by-side, please refer to the Merging Kit specification sheet.

*If design calls for a partition less than 6 ⁵/₁₆" (160 mm) the left unit's cutout will require an additional ¹/₈" (3 mm) to the width to allow installation of the Heating Mat/Merge Kit.



K 2802 Vi (Right Hinged)

Material# 11502590

K 2812 Vi (Left Hinged)

Material# 11502640



F 2802 Vi (Right Hinged)

Material# 11503330

F 2812 Vi (Left Hinged)

Material# 11503340



KF 2802 Vi (Right Hinged)

Material# 11502850

KF 2812 Vi (Left Hinged)

Material# 11502870

Fully Integrated 30" MasterCool

CUTOUT DIMENSIONS

- Niche depth assumes a 3/4" (19 mm) panel, please adjust according to custom panel thickness

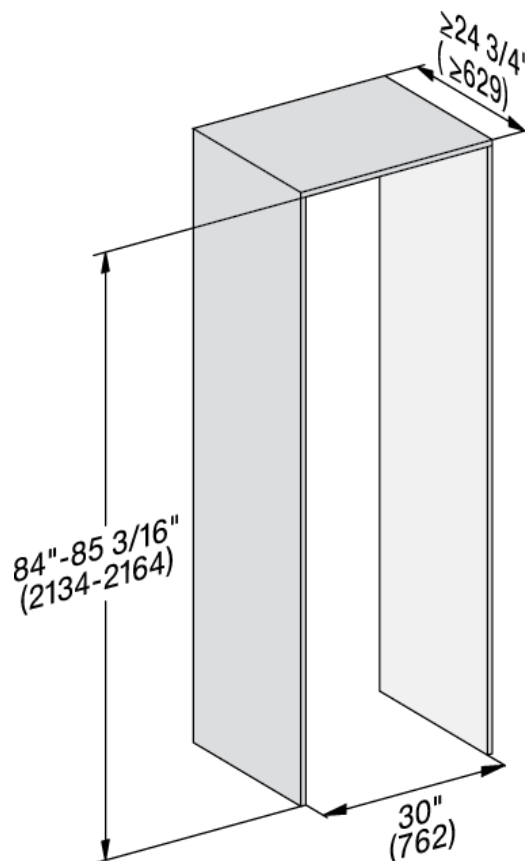

CUTOUT DETAILS

- The electrical connection must not be positioned higher than 9" (228.6 mm) above the floor.
- The 1/4" (6.4 mm) plumbed water connection should not be positioned higher than 2" (50.8 mm) above the floor.

Notes:

In case of an emergency the electrical outlet must be easily accessible and must not be concealed behind the appliance.

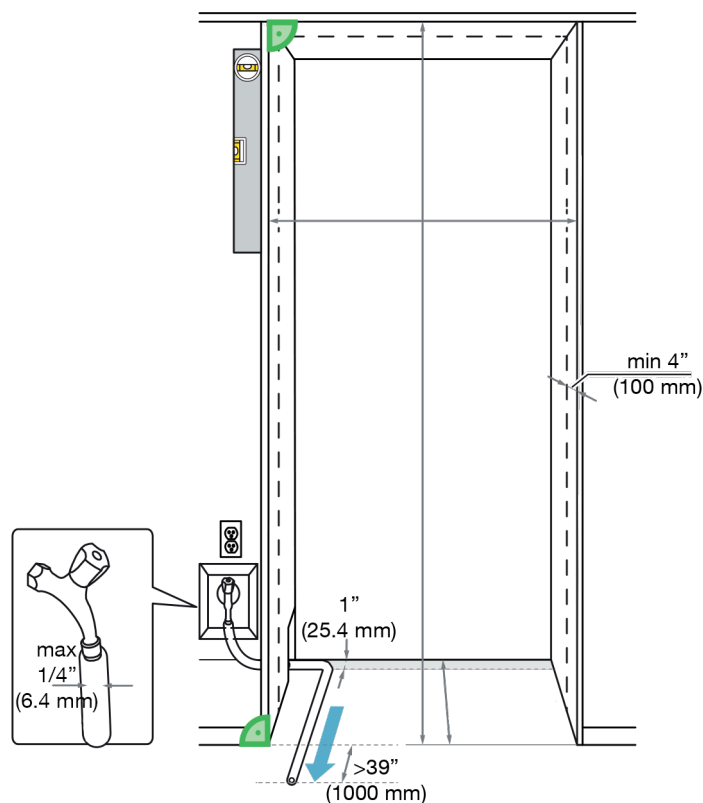

Fully Integrated 30" MasterCool

CUSTOM PANEL INSTALLATIONS

For Models:

- F 2802 Vi • F 2812 Vi
- **K 2802 Vi** • K 2812 Vi

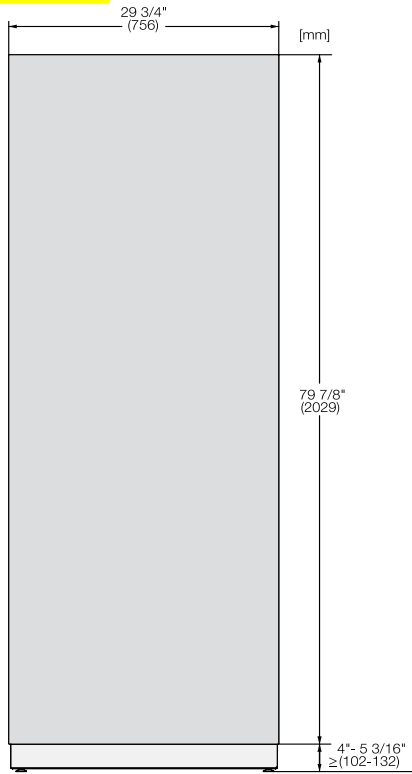

Max. Panel Weight:

F 28x2 Vi - 77 lbs

K 28x2 Vi - 106 lbs

Optional Accessory:

Clean Touch Steel Panel:

- KFP 3005

Material# 11499080

For Models:

- KF 2802 Vi • KF 2812 Vi

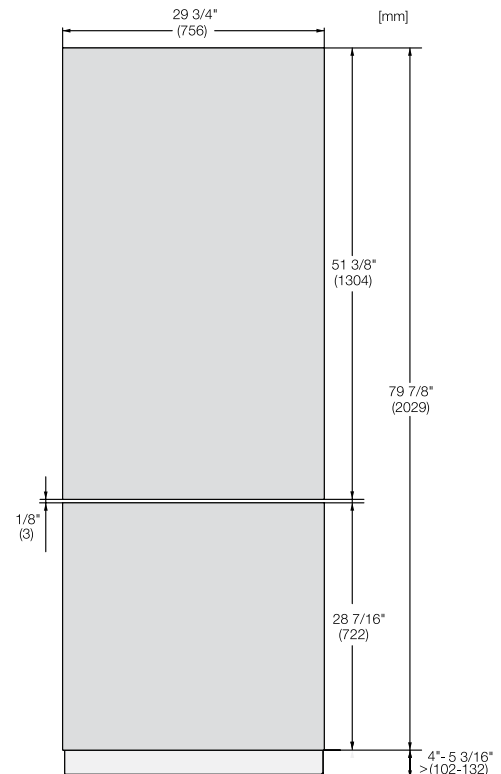

Max. Top Panel Weight: 99 lbs

Max. Bottom Panel Weight: 39 lbs

Optional Accessory:

Clean Touch Steel Panel:

- KFP 3015 - Top Panel

Material# 11499120

- KFP 3025 - Bottom Panel

Material# 11499130

Panel Notes

If the adjoining cabinets are taller than the height of machine (HOM) - the front panel may be extended accordingly. Simply maintain the toekick height and extend the panel the needed distance.

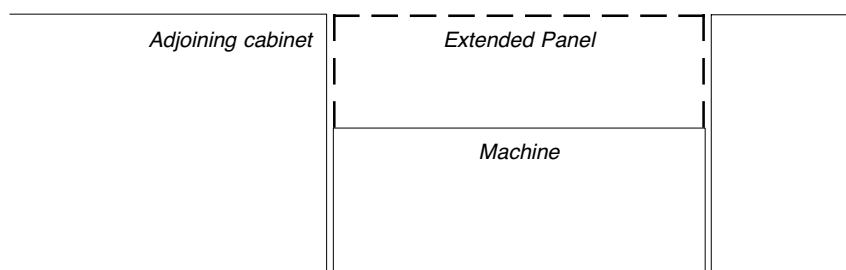

Fully Integrated 30" MasterCool

HINGING DETAILS 115° OPENING

Available for the following models:

- K 28x2 Vi
- F 28x2 Vi
- KF 28x2 Vi

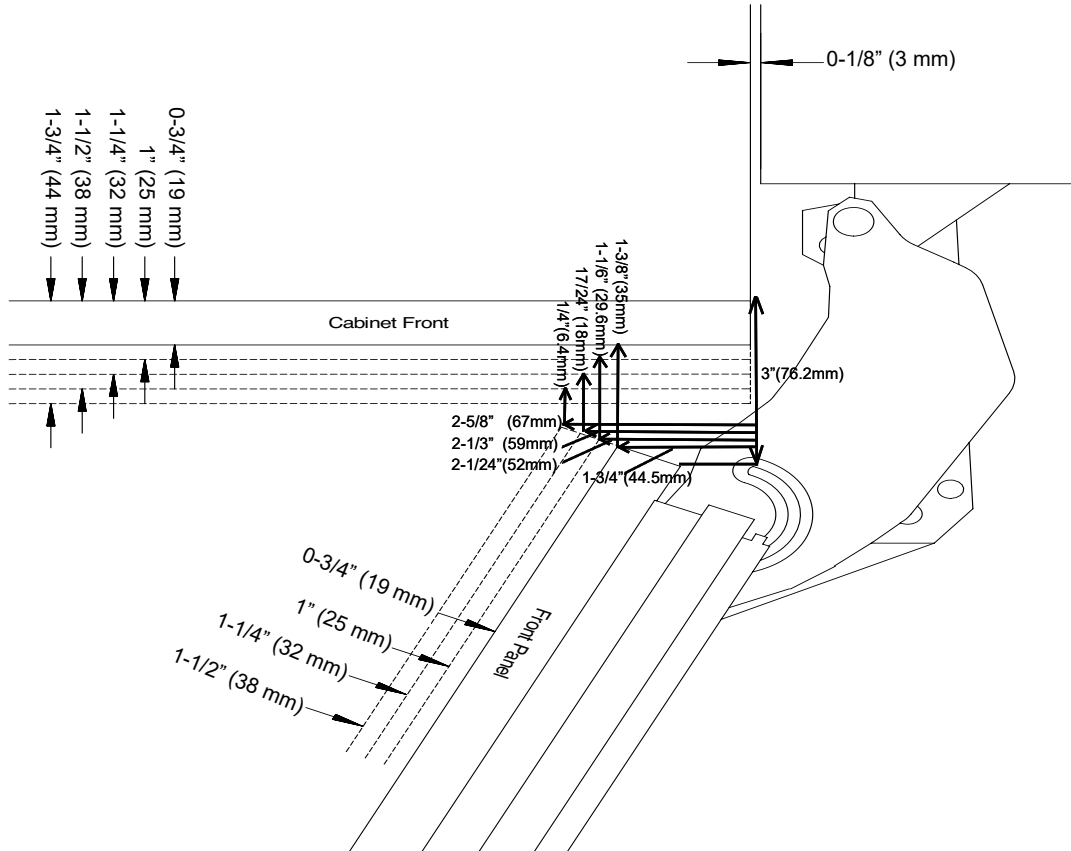

Top View)
(K29x2Vi, F29x2Vi, KF29x2Vi)

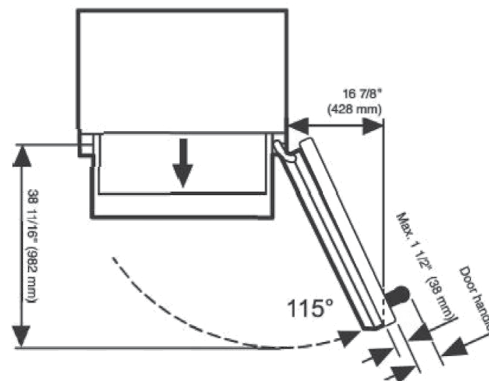

30" Flush-Mounted Induction Cooktop KM 6365



INSTALLATION DIMENSIONS

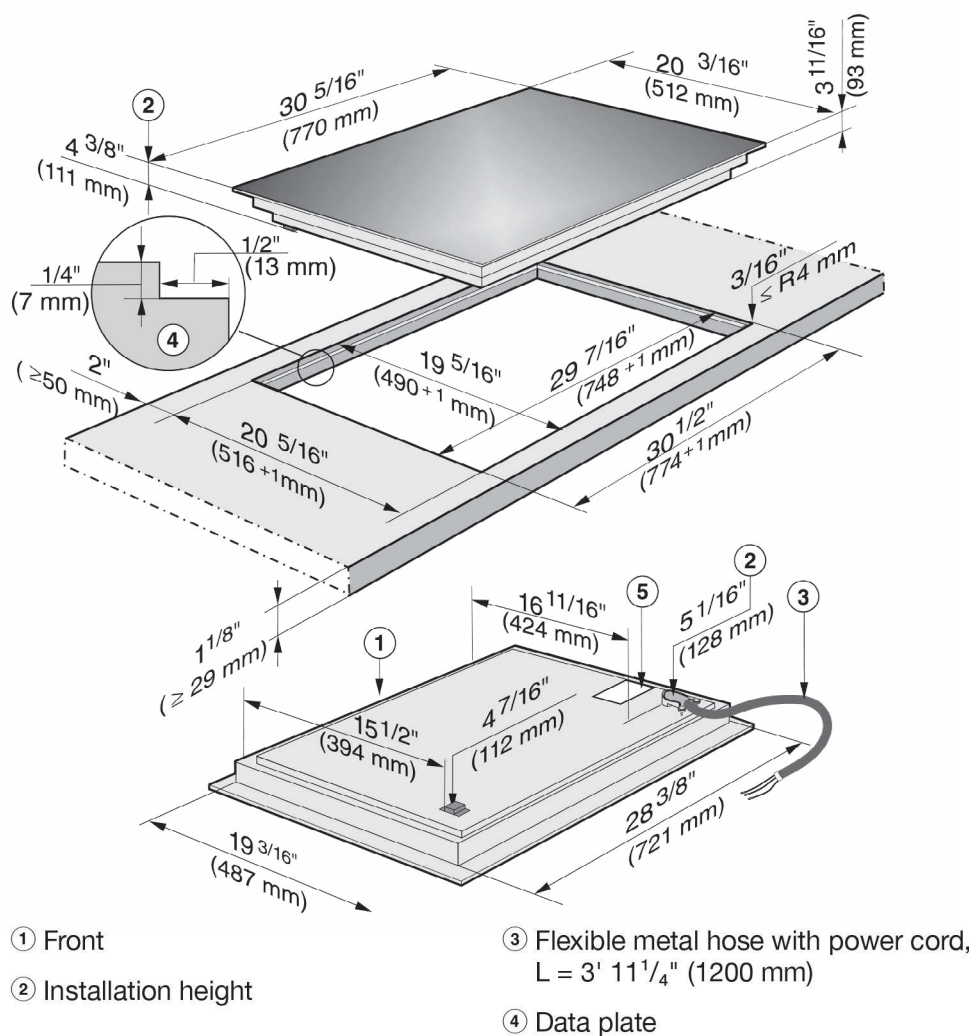

Cut-out dimensions for granite or marble counters. Please take careful note of the diagram.

This unit must only be flush mounted! Proud mounting of unit may damage the unit and will void warranty.

30" Flush-Mounted Induction Cooktop KM 6365



INSTALLATION SAFETY CLEARANCE

Front Side View Of Flush Mount
Installation With Granite, Marble,
Or Solid Surface Countertops

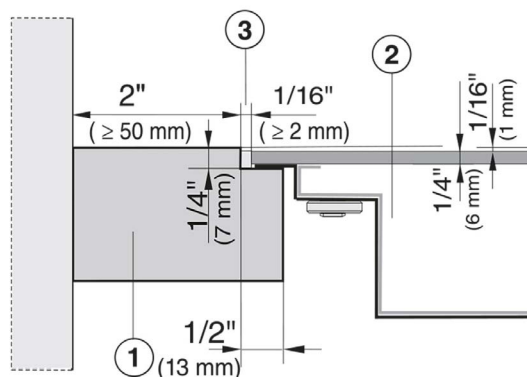

- ① Countertop
- ② Cooktop
- ③ Gap

As the ceramic glass slab and the counter cut-out have a certain dimensional tolerance, the width of the gap ③ (min. 1/16" [2 mm]) can vary.

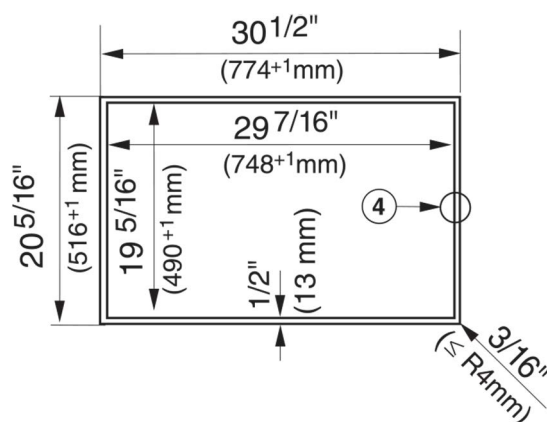

- ④ Stepped cut-out

30" Flush-Mounted Induction Cooktop KM 6365



INSTALLATION

Ventilations

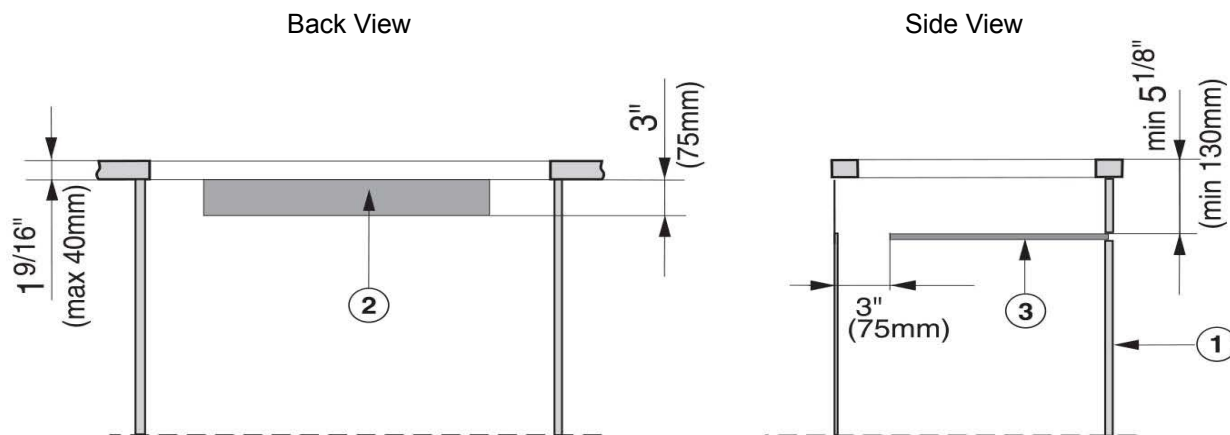

① Front of cooktop

② Cut-out in cabinet for ventilation.

Shown as an example in the rear wall of the cabinet.

③ Protective base

Installation of a protective base under the cooktop is allowed but not required.

If a protective base is fitted, there must be a clearance of at least 5 1/8"

(130 mm) between the top of the protective base and the top of the countertop, for proper ventilation of the cooktop.

At the back there has to be a gap of 3" (75 mm) for the power cord.

Cooktop	Measurements cut-out
KM 6360 / KM 6365	73.5 sq-in. Example: 24 1/2" x 3" (622 x 75mm)

DAS 4720

30" Built-In Slimline Ventilation Hood with WiFi

Features:

- LED strip for bright, even light distribution
- Stainless steel canopy
- 10-ply grease filters for efficient filtration
- WiFi Connected

MATERIAL

11878520



SPECIFICATIONS	
Overall Unit Dimensions	29 ¹³ / ₁₆ " (758 mm) W x 17 ¹ / ₈ " (436 mm) H x 10 ³ / ₄ " (273 mm) D
Niche	
Minimum Cabinet Niche Opening	22 ¹ / ₈ " (562 mm) W x 16 ³ / ₁₆ " (411 mm) H x 11 ⁵ / ₈ " (295 mm) D
Electrical	
Electrical Requirements	120V, 60Hz, 15 Amps
Power Cord	NEMA 5-15 plug, 2.5 ft (0.75 m)
Shipping	
Shipping Weight	40 lbs (18 kg)
Shipping Dimensions	38" (965 mm) W x 15 ³ / ₈ " (390 mm) H x 19 ¹ / ₁₆ " (500 mm) D

PRODUCT DIMENSIONS

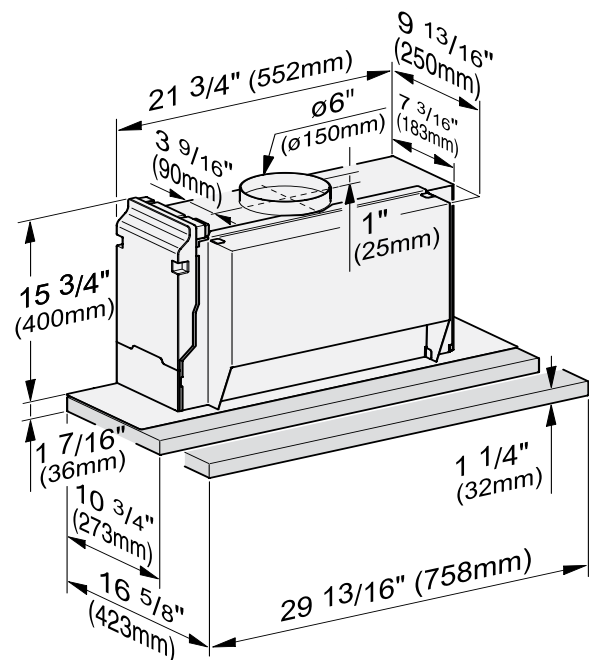

NICHE DIMENSIONS

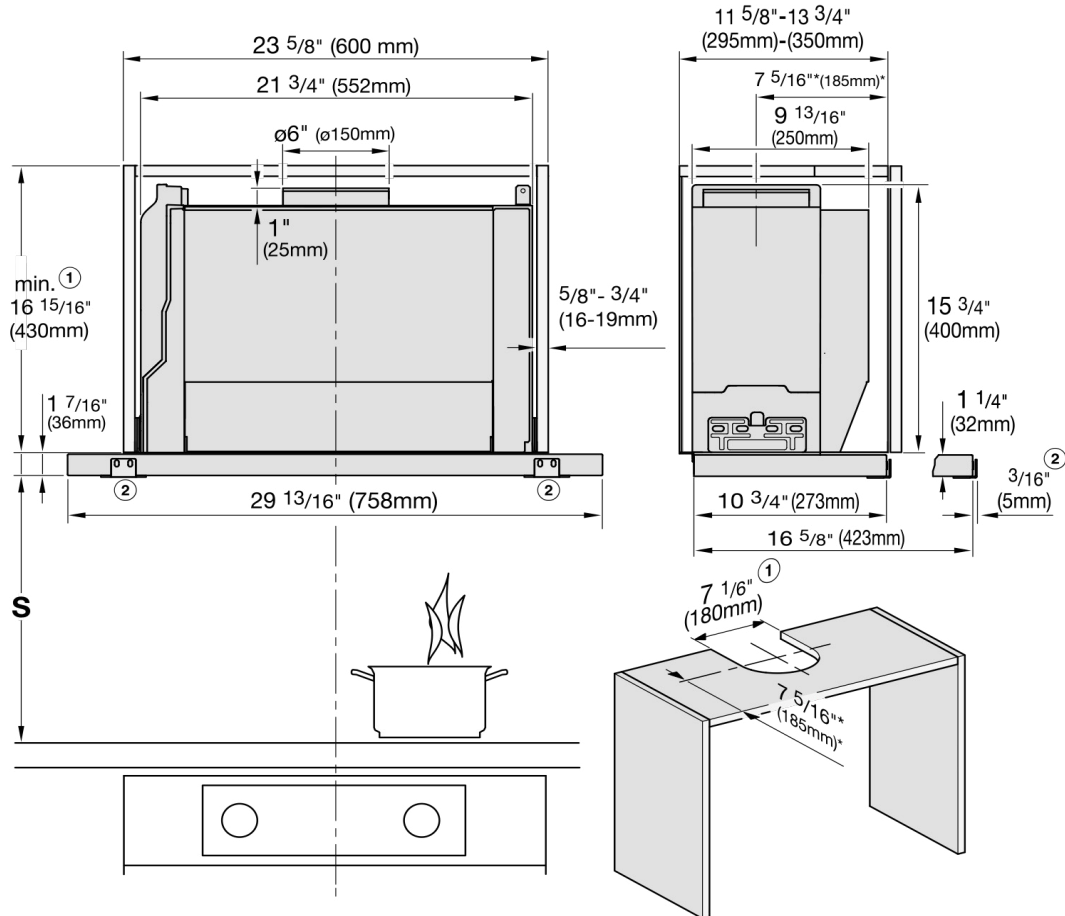

DISTANCE BETWEEN COOKTOP AND VENTILATION HOOD (S)

Distance between cooktop and ventilation hood (S)

Provided a larger distance is not given by the manufacturer of the cooktop, follow the minimum distances between a cooktop and the bottom of the hood.

Please also observe the information contained in the "IMPORTANT SAFETY INSTRUCTIONS" section of the manual.

Cooking appliance	Minimum distance S	
	Miele appliance	Non-Miele appliance
Electric Cooktops	24" (610 mm)	
Electric Barbeques and Fryers	26" (660 mm)	
Multiburner Gas Cooktops ≤ 43,000 BTU/hr (12.6 kW), no burner > 15,000 BTU/hr (4.5 kW).	26" (660 mm)	30" (760 mm)
Multiburner Gas Cooktops ≤ 73,800 BTU/hr (21.6 kW), no burner > 16,500 BTU/hr (4.8 kW)	30" (760 mm)	
Multiburner Gas Cooktops > 73,800 BTU/hr (21.6 kW), or one of the burners > 16,500 BTU/hr (4.8 kW)	Not possible	
Single Burner Gas Cooktops ≤ 20,500 BTU/hr (6 kW)	26" (660 mm)	30" (760 mm)
Single Burner Gas Cooktops > 20,500 BTU/hr (6 kW) ≤ 27,600 BTU/hr (8.1 kW)	30" (760 mm)	
Single Burner Gas Cooktops > 27,600 BTU/hr (8.1 kW)	Not possible	

G 7591 SCVi x 2

24" Fully Integrated Dishwasher, K2o (ADA)

Features:

- AutoDos - an integrated automatic detergent dispensing system
- DirectSensor Controls - intuitive touch controls
- QuickIntenseWash - a full wash and dry cycle in 58 minutes
- 40 dBa (38 dBa when using ExtraQuiet)
- 3D MultiFlex Cutlery Tray
- WifiConn@ct
- Panel-Ready
- Knock2Open
- Water Softener
- ADA Compliant
- EnergyStar

MATERIAL

11388260



SPECIFICATIONS	
Overall Unit Dimensions	23 ⁹ / ₁₆ " (598 mm) W x 32 ¹ / ₁₆ " - 34 ¹ / ₄ " (814 - 870 mm) H x 22 ⁷ / ₁₆ " (570 mm) D [Depth does not include door panel]
Niche	
Minimum Cabinet Niche Opening	23 ⁵ / ₈ " (600 mm) W x 32 ¹ / ₈ " (814 mm) H x 22 ⁷ / ₁₆ " (570 mm) D
Plumbing	
Water Supply Requirements	<ul style="list-style-type: none"> • Cold or Hot (max 150°F/65°C) water connection • Male 3/8" compression fitting • Water pressure range 7.25 psi (0.5 bar) and 145 psi (10 bar)
Water Connection Line (Supplied)	Length: 5 ft (1.5 m) Female 3/8" compression.
Drain Hose (Supplied)	Length: 5 ft (1.5 m) 7/8" (22 mm) internal diameter
Electrical	
Electrical Requirements	110V / 120V, 60Hz, 15 Amps
Power Cord (Convertible to hardwire)	NEMA 5-15 plug, 5 ft (1.52 m)
Shipping	
Shipping Weight	121 lbs (55 kg)
Shipping Dimensions	27 ¹ / ₈ " W x 38 ¹ / ₈ " H x 26 ³ / ₈ " D

PRODUCT DIMENSIONS

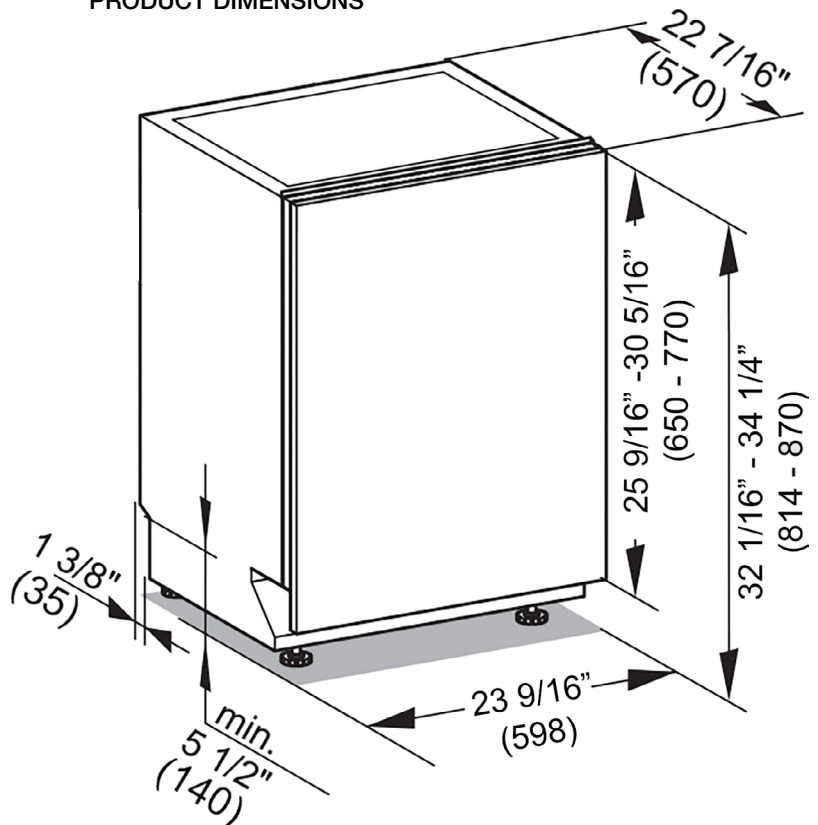

CUTOUT DIMENSIONS

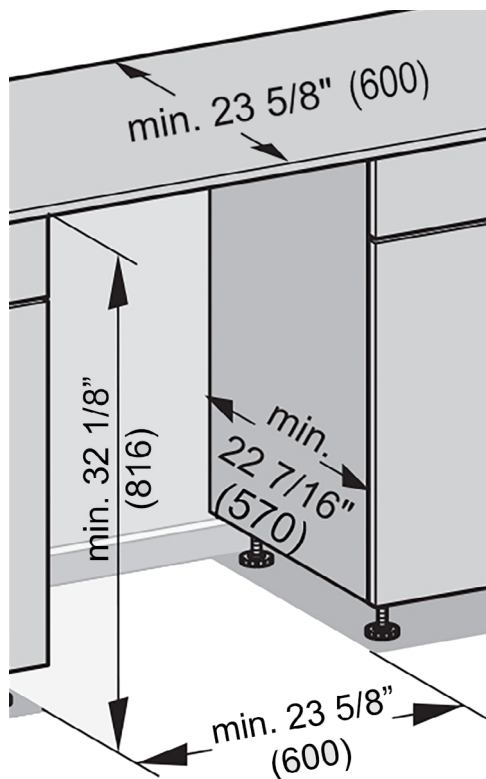

CUSTOM PANEL

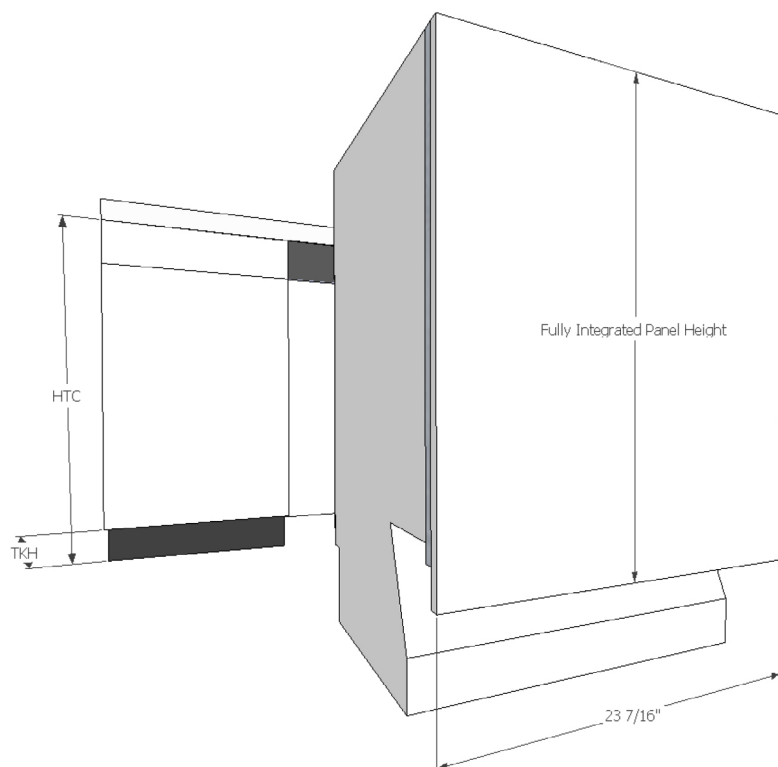

Width: 23 7/16" (598 mm) in all cases

Thickness: 3/4" (19 mm) in all cases

Height: Determined using the following calculation:

$$\text{Panel Height} = \text{HTC} - \text{TKH}$$

HTC = Height to the underside of countertop

TKH = Toe kick height

Note: Control panel is along the top edge of the unit. It is not visible when the unit is closed. A handle **MUST** be located on the front panel in order to open the unit.

Maximum panel height: 30 3/8" (772 mm)

Minimum panel height: 25 5/8" (650 mm)

Maximum panel weight: 26 lbs (12 kg)

DGC 7860 XXL

24" Combi-Steam Oven - PureLine and VitroLine

Features:

- Combi-Steam Ovens: Steam ovens with full fledged oven function
- XXL Cooking Compartment - Large enough to cook complete menus for up to 10 people
- Lift up panel - conveniently stores the water containers
- M-Touch Display with Motion React - Simple to use touch controls that react when approached
- Roast Probe - Precise temperature control of food
- Mix & Match - use your Miele@home app or the WiFi enabled appliance to create recipes for full meals

Included:

- 1 Universal Tray with Perfect Clean
- 1 Wire rack with Perfect Clean
- 1 pair FlexiClip runners with Perfect Clean
- 2 perforated stainless steel containers
- 1 solid stainless steel container



MATERIAL

11876980

SPECIFICATIONS	
Overall Unit Dimensions	23 ⁷ / ₁₆ " (595 mm) W x 23 ⁷ / ₁₆ " (596 mm) H x 23 ¹ / ₄ " (590 mm) D
Niche	
Minimum Cabinet Niche Opening	22 ¹ / ₂ " (562 mm) W x 23 ¹ / ₄ " (590 mm) H x 24" (610 mm) D
Electrical	
Electrical Requirements	208 - 240V, 60Hz, 20 Amps
Power Cord	NEMA 6-20 plug, 5 ft (1.52 m)
Shipping	
Shipping Weight	?? lbs (?? kg)
Shipping Dimensions	28 ⁷ / ₈ " (733 mm) W x 28 ³ / ₈ " (721 mm) H x 26 ⁵ / ₈ " (676 mm) D

PRODUCT DIMENSIONS

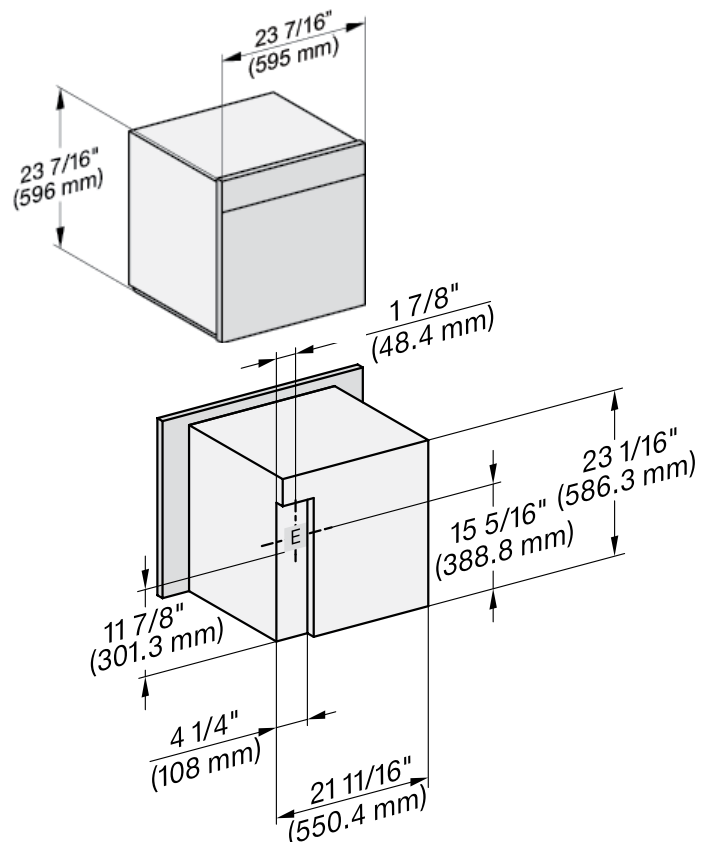

PROUD CUTOUT DIMENSIONS

Front View

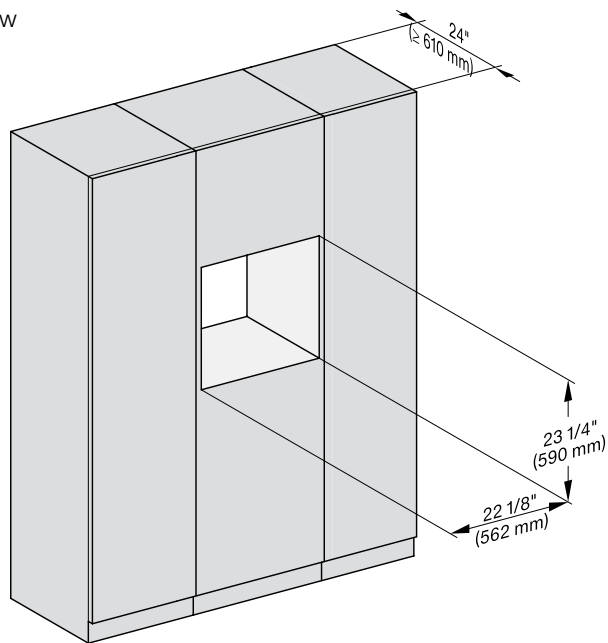

Side View

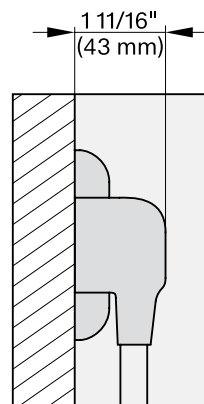
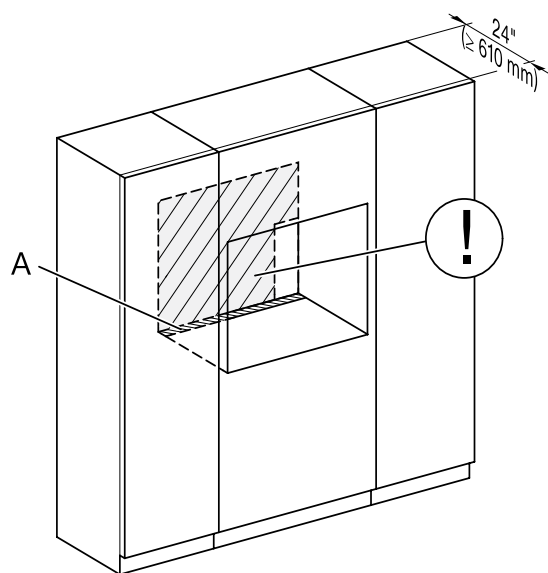
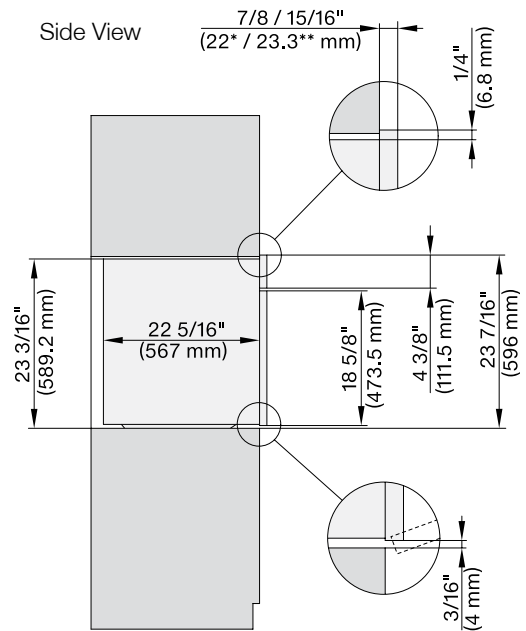

A - Cut-out (4" x 28" [100 mm x 720 mm]) in the bottom of the cabinet for the power cord and Ventilation

ⓘ - Electrical and water supplies are recommended to be placed in adjacent cabinetry.

Additional cabinet depth is required when placing the electrical and water supplies behind the appliance.

H 7840 BM

24" Speed Oven - PureLine

Features:

- Speed ovens combine the functionality of a microwave and compact convection oven into one appliance
- M-Touch Display - Simple to use touch controls
- WifiConn@ct - Monitor appliances from your mobile device
- Motion React - Appliance reacts to you when approached
- Roast Probe - Precise temperature control of food
- Automatic programs - easily master new recipes

Included:

- 1 Baking and Roasting Rack with Perfect Clean
- 2 Glass Dishes



MATERIAL

11804640

SPECIFICATIONS	
Overall Unit Dimensions	23 ⁷ / ₁₆ " (595 mm) W x 17 ¹⁵ / ₁₆ " (455.5 mm) H x 21 ⁵ / ₈ " (549 mm) D
Niche	
Minimum Cabinet Niche Opening	22 ¹ / ₈ " (562 mm) W x 17 ¹ / ₁₆ " (450 mm) H x 24" (610 mm) D
Electrical	
Electrical Requirements	120/208-240V, 60Hz, 30 Amps
Power Cord (Convertible to hardwire)	NEMA 14-30 plug, 5 ft (1.52 m)
Shipping	
Shipping Weight	101 lbs (46 kg)
Shipping Dimensions	27 ³ / ₈ " (695 mm) W x 23 ⁵ / ₈ " (600 mm) H x 38 ³ / ₈ " (975 mm) D

PRODUCT DIMENSIONS

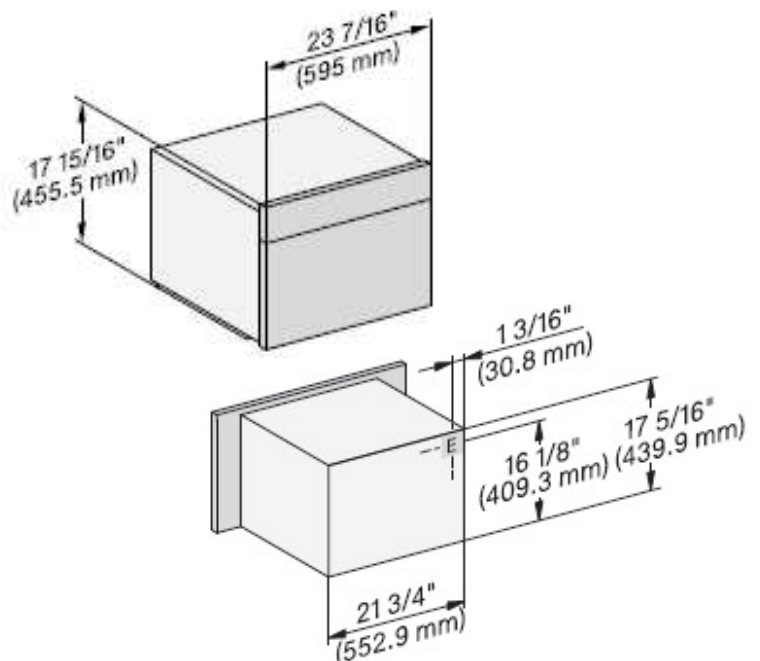

E = Electrical connection

PROUD CUTOUT DIMENSIONS

Front View

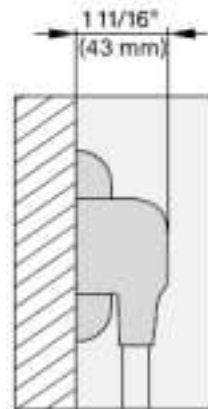
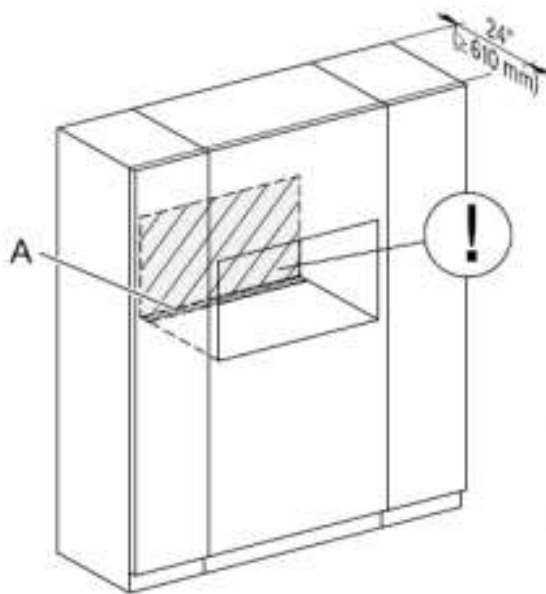
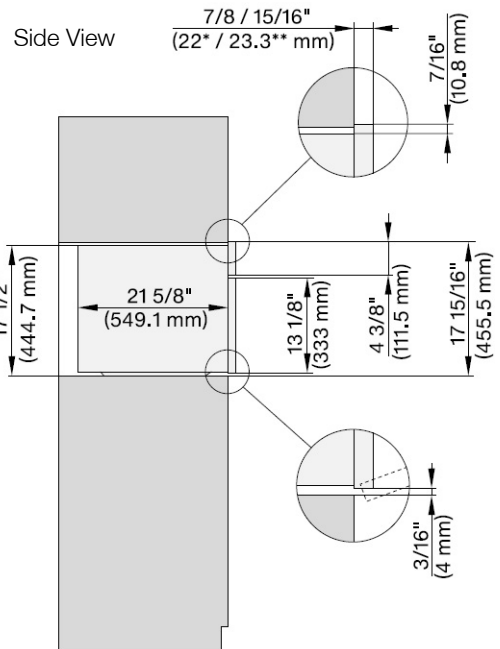
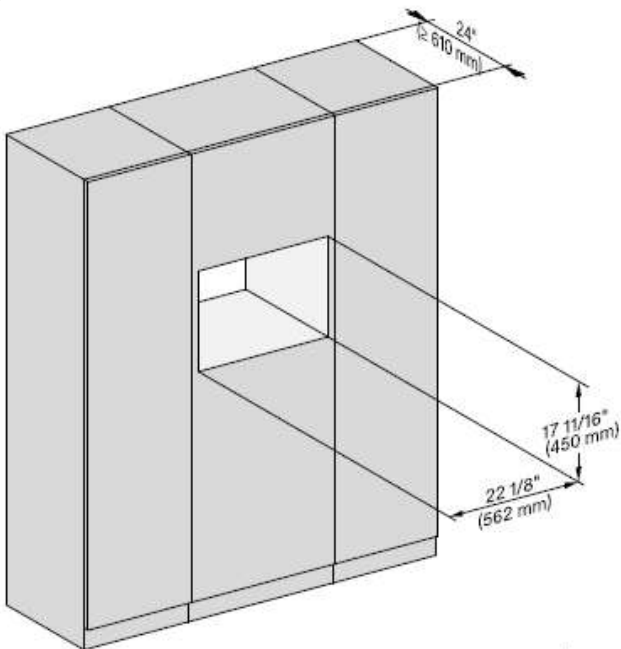

A - Cut-out (4" x 28" [100 mm x 720 mm]) in the bottom of the cabinet for the power cord and Ventilation

! - Electrical and water supplies are recommended to be placed in adjacent cabinetry.

Additional cabinet depth is required when placing the electrical and water supplies behind the appliance.