

IC-30R

PRODUCT SPECIFICATIONS

Model	IC-30R
Dimensions	30"W x 84"H x 24"D
Door Clearance	28 1/2"
Weight	400 lb
Refrigerator Capacity	17.3 cu ft
Electrical Supply	115 VAC, 60 Hz
Electrical Service	15 amp dedicated circuit
Plumbing Supply	1/4" OD copper, braided stainless steel or PEX tubing
Plumbing Pressure	35-120 psi
Receptacle	3-prong grounding-type

ELECTRICAL

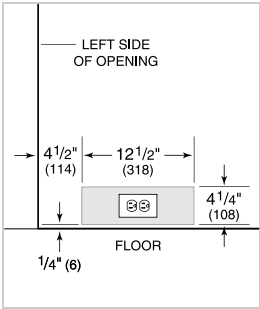

INTERIOR VIEW

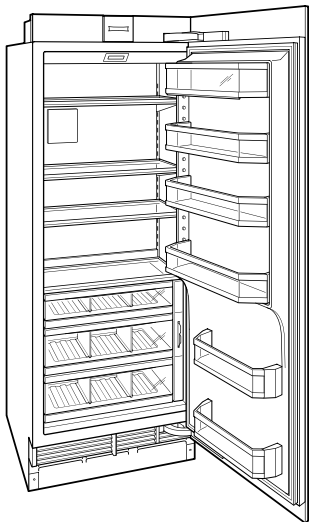

This illustration is intended for interior reference only and may not represent the exterior of the model being specified.

DIMENSIONS

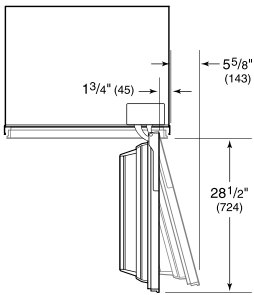
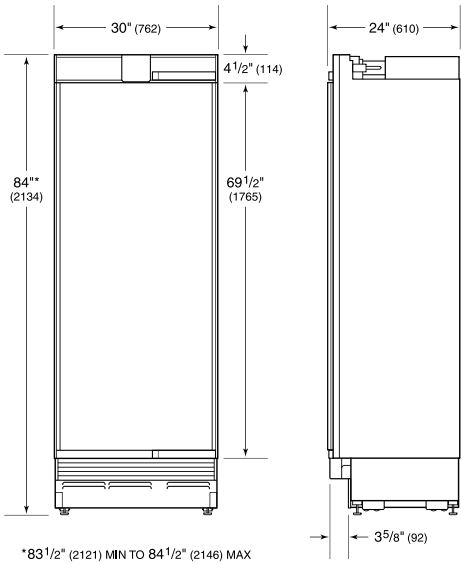

STANDARD INSTALLATION

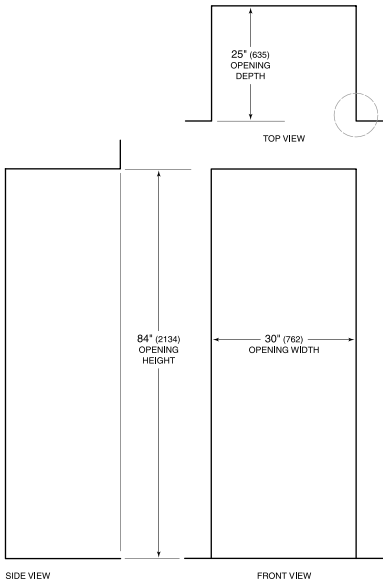

NOTE: 3 1/2" (89) finished returns will be visible and should be finished to match cabinetry.

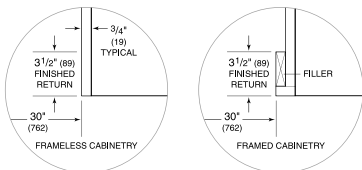

## STANDARD INSTALLATION

Custom Panels

For integrated models, custom door panels and handle hardware must be provided. Refer to the panel requirements chart and typical panel dimensions.

The thickness of the custom panel can vary. A minimum 5/8" (16) thick panel is required, but the thickness can be increased provided it does not exceed the weight limit. The depth of each integrated model is 24" (610). Allow for panel thickness when planning the finished opening depth. Refer to the full-scale template on page 55.

⚠ CAUTION

As reveals between cabinetry and the unit decrease, severe finger pinching can occur while door is closing.

Finish all sides of custom panels. They will be visible when the door/drawer is open.

D-style handles are recommended. Door handles must be located near the edge of the panel opposite the hinge and should be centered top to bottom. Drawer handles must be located near the top edge of each panel. Stainless steel tubular and pro handles are available through an authorized Sub-Zero dealer. For local dealer information, visit the find a showroom section of our website, subzero.com.

PANEL REQUIREMENTS

WEIGHT PER PANEL		MAX
18" Column		45 lb (20 kg)
24" Column		60 lb (27 kg)
30" Column		75 lb (34 kg)
36" Column		75 lb (34 kg)
WEIGHT PER PANEL		MAX
30" Tall (door)		50 lb (22 kg)
36" Tall (door)		60 lb (27 kg)
Drawer		15 lb (7 kg)
PANEL THICKNESS		MIN
All Panels		5/8" (16)

TYPICAL PANEL DIMENSIONS

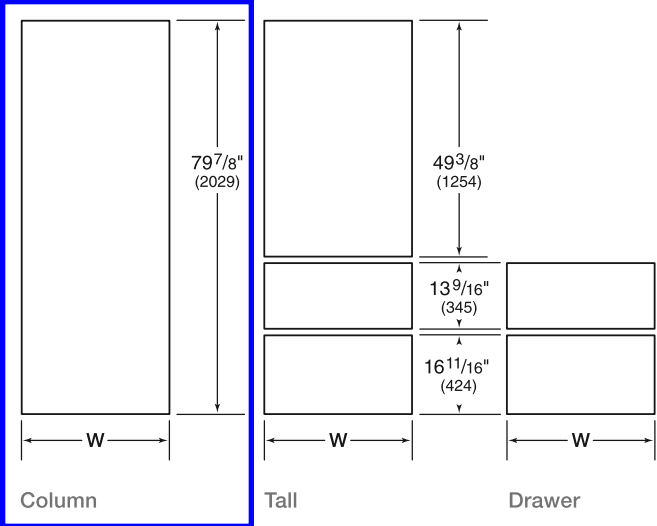

Typical panel dimensions are based on an 84" (2134) finished height for column and tall models and 34 1/2" (876) for drawer models, with a 4" (102) toe kick and 1/8" (3) reveals. Panel dimensions must be adjusted accordingly for all other installations. Refer to the illustration for panel heights and the chart below for panel widths.

PANEL WIDTH	W
18" Model	17 3/4" (451)
24" Model	23 3/4" (603)
27" Model	26 3/4" (679)
30" Model	29 3/4" (756)
36" Model	35 3/4" (908)

DUAL INSTALLATION

For dual installations, refer to the illustration for panel heights and the chart below for panel widths.

PANEL WIDTH	W
18" Model	17 13/16" (452)
24" Model	23 13/16" (605)
27" Model	26 13/16" (681)
30" Model	29 13/16" (757)
36" Model	35 13/16" (910)

## PRODUCT SPECIFICATIONS

Model	IW-24
Dimensions	24"W x 84"H x 24"D
Door Clearance	22 1/2"
Weight	410 lbs
Electrical Supply	115 VAC, 60 Hz
Electrical Service	15 amp dedicated circuit
Wine Storage Capacity	102 Bottles
Receptacle	3-prong grounding-type

## ELECTRICAL

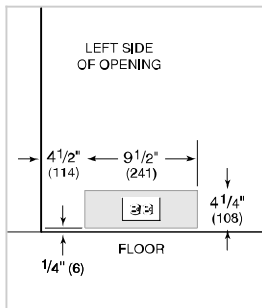

**NOTE:** Dimensions in parenthesis are in millimeters unless otherwise specified

## INTERIOR VIEW

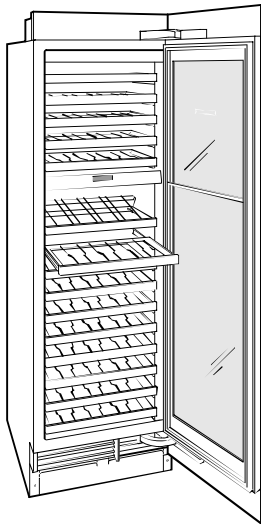

This illustration is intended for interior reference only and may not represent the exterior of the model being specified.

## DIMENSIONS

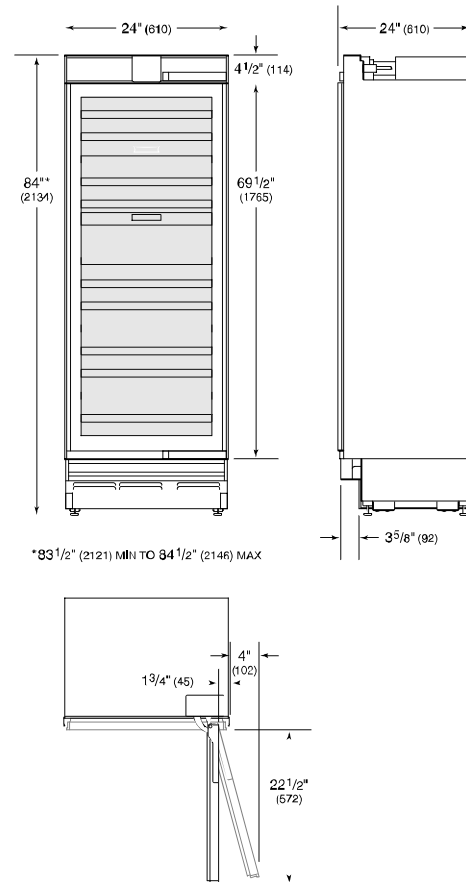

## STANDARD INSTALLATION

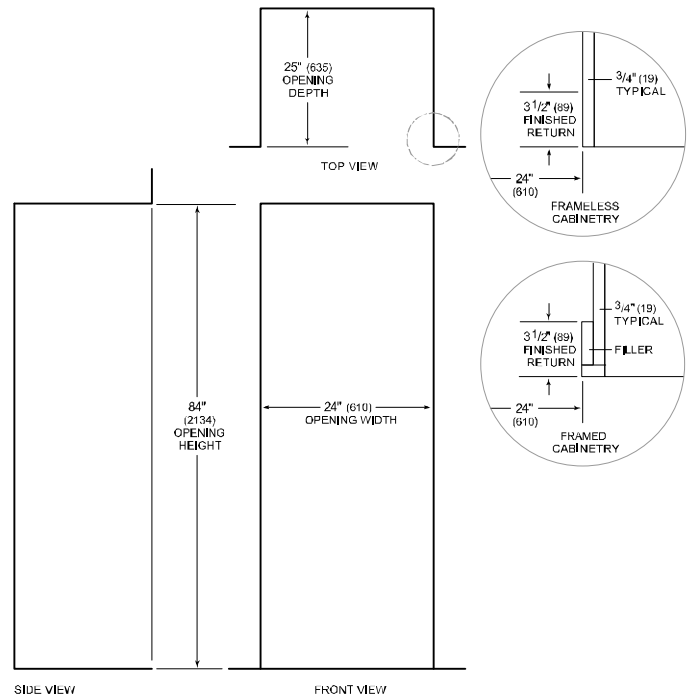

**NOTE:** 3 1/2" (89) finished returns will be visible and should be finished to match cabinetry

Custom Panel—Integrated

For integrated (IW) models, a custom door panel and handle hardware must be provided. Refer to the panel requirements chart and typical panel dimensions.

Do not install a solid panel on the glass door unit. A solid door is available as a sales accessory through an authorized Sub-Zero dealer.

The thickness of the custom panel can vary. A minimum 5/8" (16) thick panel is required, but the thickness can be increased provided it does not exceed the weight limit. The depth of each integrated model is 24" (610). Allow for panel thickness when planning the finished opening depth. Refer to the full-scale template on page 55.

⚠ CAUTION

As reveals between cabinetry and the unit decrease, severe finger pinching can occur while door is closing.

Finish all sides of custom panels. They will be visible when the door/drawer is open.

D-style handles are recommended. Door handles must be located near the edge of the panel opposite the hinge and should be centered top to bottom. Drawer handles must be located near the top edge of each panel. Stainless steel tubular and pro handles are available through an authorized Sub-Zero dealer. For local dealer information, visit the find a showroom section of our website, subzero.com.

PANEL REQUIREMENTS

WEIGHT PER PANEL		MAX
Door Frame (column)		35 lb (16 kg)
Door Frame (tall)		25 lb (11 kg)
Drawer Panel (tall)		15 lb (7 kg)
PANEL THICKNESS		MIN
All Panels		5/8" (16)

TYPICAL PANEL DIMENSIONS

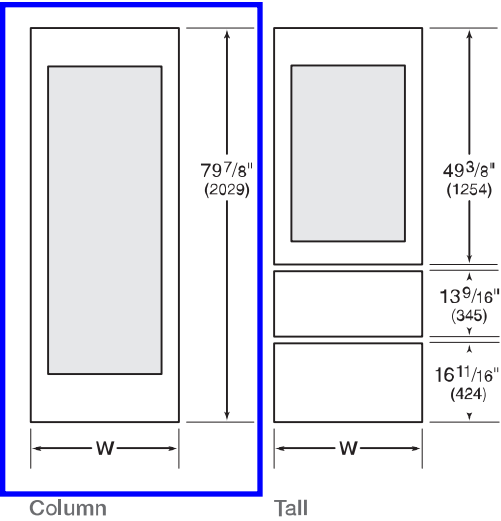

Typical panel dimensions are based on an 84" (2134) finished height, 4" (102) toe kick and 1/8" (3) reveals. Panel dimensions must be adjusted accordingly for all other installations. Refer to the illustration for panel height and the chart below for panel width.

PANEL WIDTH

MODEL	W
18" Model	17 3/4" (451)
24" Model	23 3/4" (603)
30" Model	29 3/4" (756)

STILES | RAILS

	MIN
Stiles	3 1/4" (83)
Top Rail	7 3/4" (197)
Bottom Rail (column)	9 1/2" (241)
Bottom Rail (tall)	4 1/2" (114)

DUAL INSTALLATION

For dual installations, refer to the illustration for panel height and the chart below for panel width.

PANEL WIDTH

MODEL	W
18" Model	17 13/16" (452)
24" Model	23 13/16" (605)
30" Model	29 13/16" (757)

# 24" Panel Ready Special Application

800 Series – Panel Ready **SGV68U53UC**



**BOSCH**  
Invented for life

## Installation Details

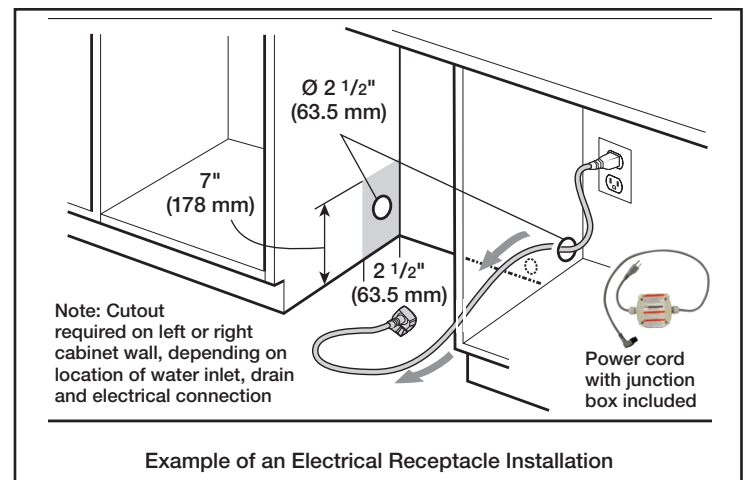
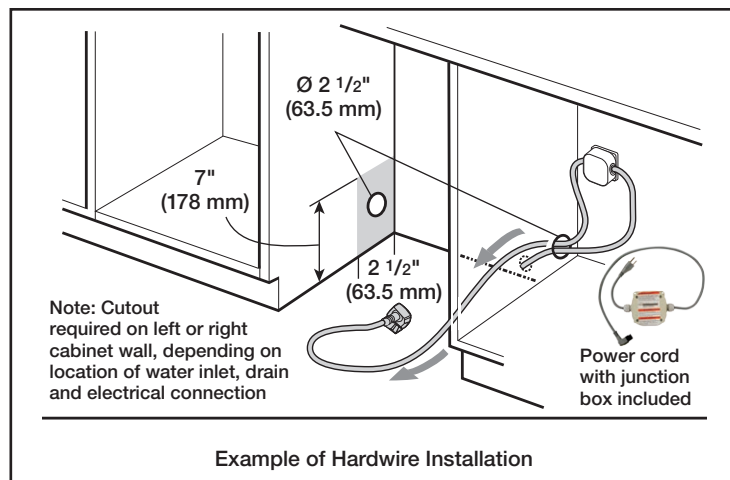
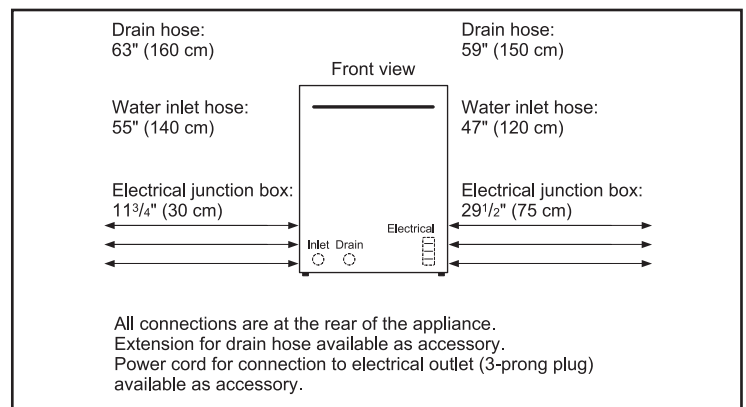
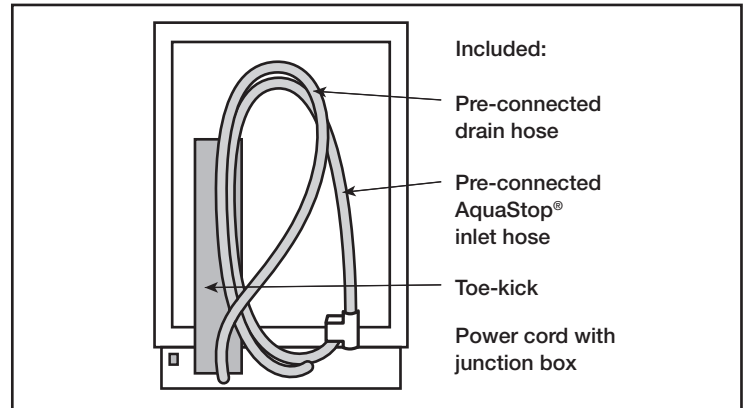
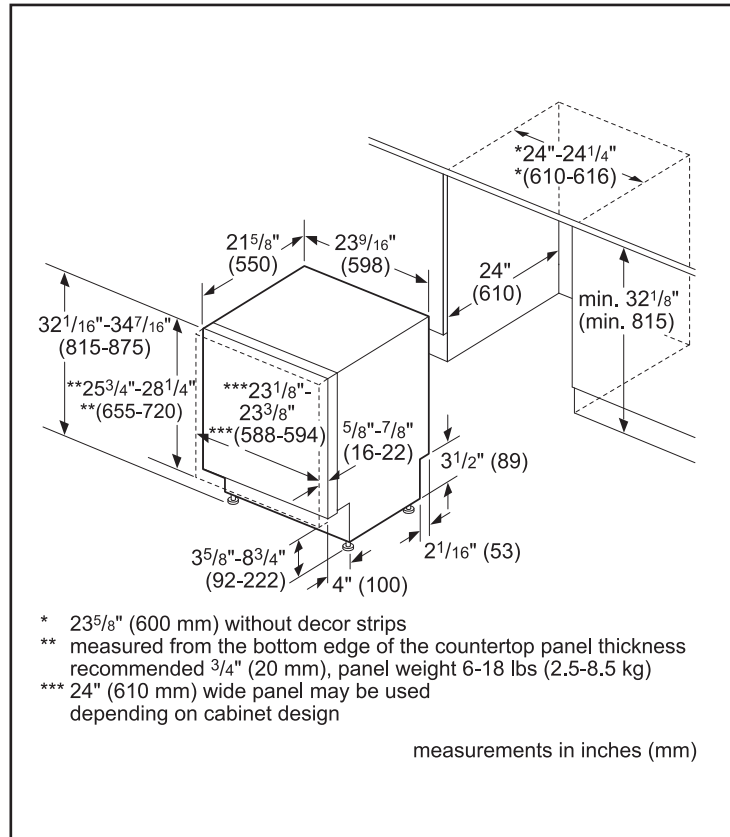

For help and assistance with Bosch accessories please visit: [www.bosch-eshop.com/eshop/bosch/us](http://www.bosch-eshop.com/eshop/bosch/us) or call 1-800-944-2904 Mon-Fri 5am to 6pm PST Sat 6am to 3pm PST

Notes: All height, width and depth dimensions are shown in inches. BSH reserves the absolute and unrestricted right to change product materials and specifications, at any time, without notice. Consult the product's installation instructions for final dimensional data and other details prior to making cutout. Applicable product warranty can be found in accompanying product literature or you may contact your account manager for further details.

Warranties: Bosch warrants that the Product is free from defects in materials and workmanship for a period of three hundred and sixty-five (365) days from the date of purchase. The foregoing timeline begins to run upon the date of purchase, and shall not be stalled, tolled, extended, or suspended, for any reason whatsoever. This Product is also warranted to be free from cosmetic defects in material and workmanship (such as scratches of stainless steel, paint/porcelain blemishes, chip, dents, or other damage to the finish) of the Product, for a period of thirty (30) days from the date of purchase or closing date for new construction. This cosmetic warranty excludes slight color variations due to inherent differences in painted and porcelain parts, as well as differences caused by kitchen lighting, product location, or other similar factors. This cosmetic warranty specifically excludes any display, floor, "As Is", or "B" stock appliances.

For more information on our entire line of products, go to [www.bosch-home.com/us](http://www.bosch-home.com/us) or call 1-800-944-2904

© BSH Home Appliances Corporation. All rights reserved. Bosch is a registered trademark of Robert Bosch GmbH.

09/15

### PRODUCT VIEWS

#### Isometric View

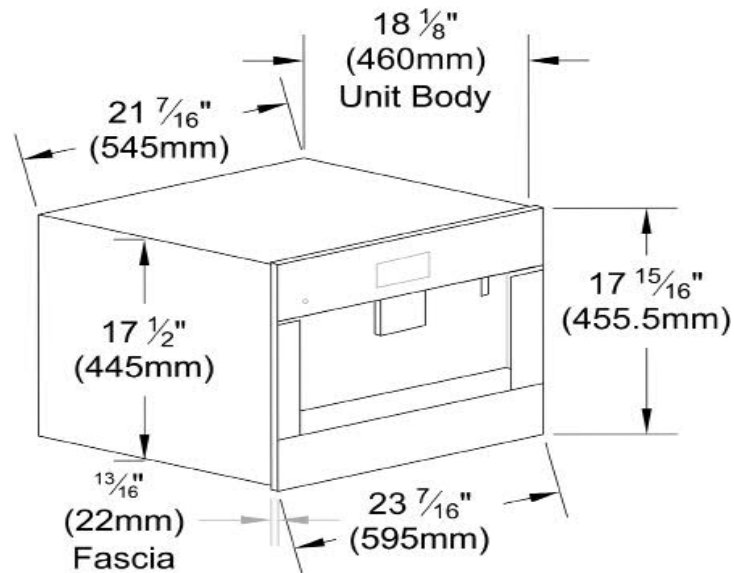

#### Top View, Door Open

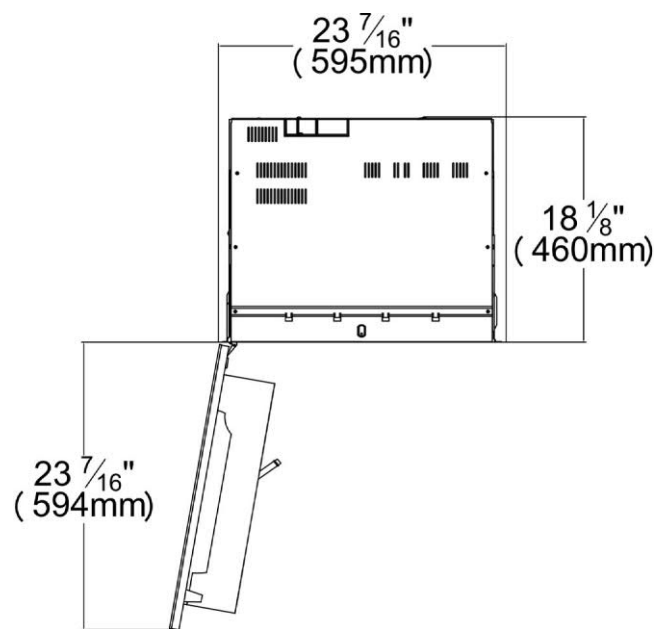

### INSTALLATION SPECIFICATIONS

#### Cutout Dimensions

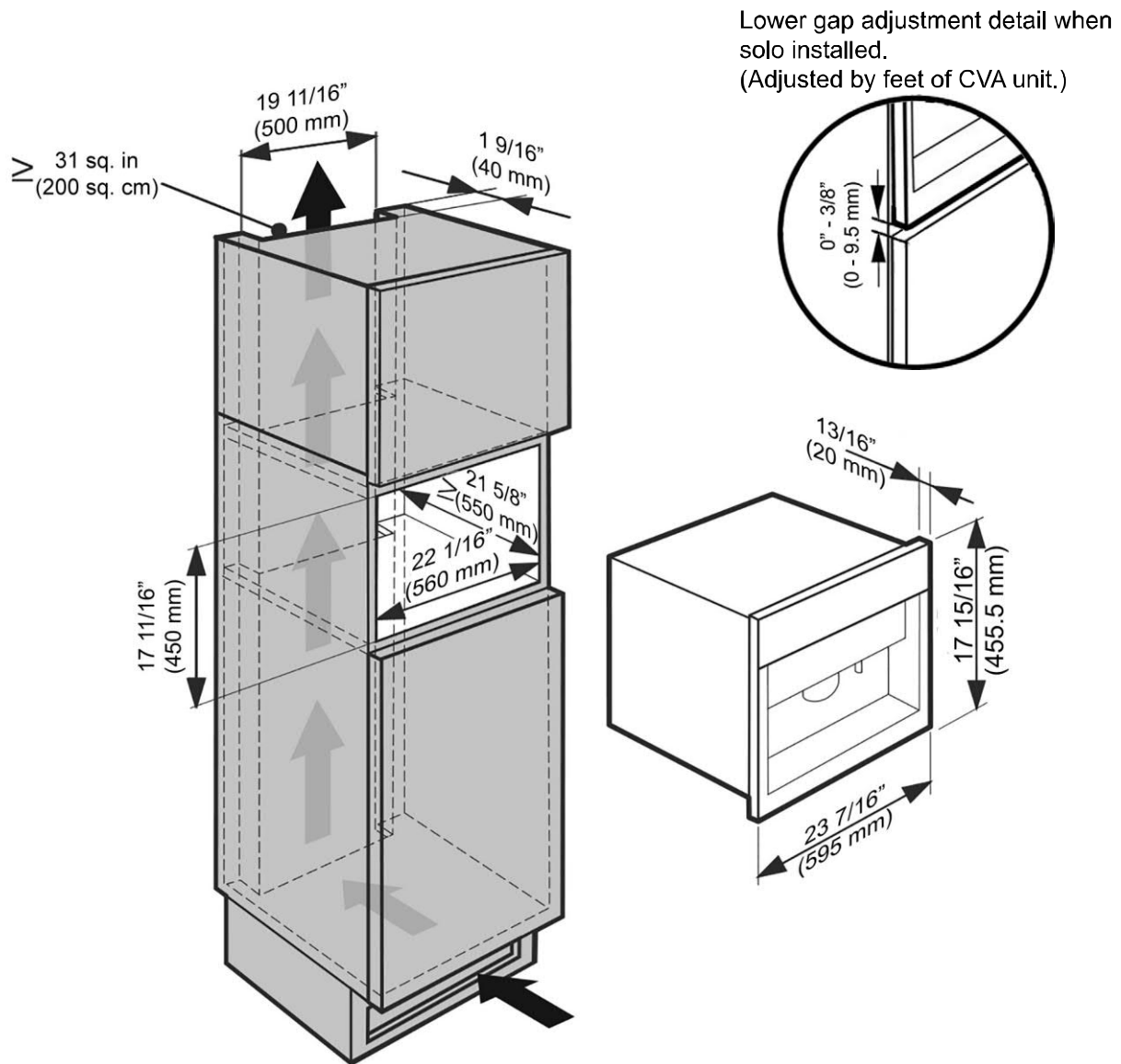

**PLEASE NOTE:** Condensation water can damage the coffee system or surrounding cabinets. The specified ventilation cross-sections absolutely must be observed.







PRODUCT SPECIFICATIONS

Model	PWC482418
Dimensions	48"W x 18"H x 24"D
Weight	94 lbs
Electrical Supply	110/120 VAC, 60 Hz
Electrical Service	15 amp dedicated circuit
Discharge Location	Vertical
Discharge Dimensions	10" Round
Bottom of Hood to Countertop	30" to 36"

ELECTRICAL

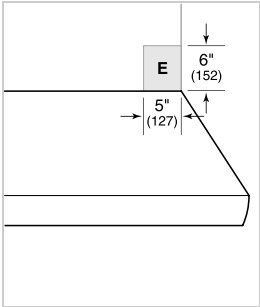

**NOTE:** Dimensions in parenthesis are in millimeters unless otherwise specified

DIMENSIONS

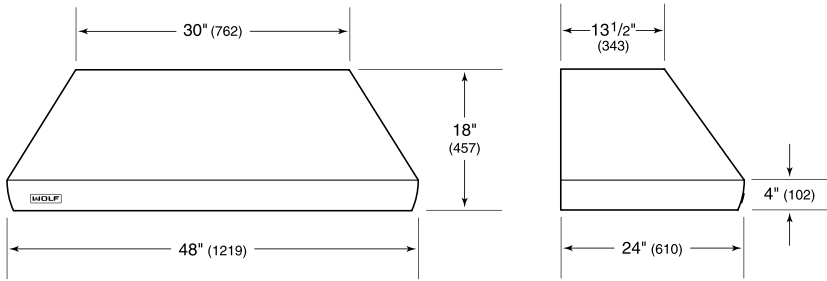

# Microwave Drawer: **SMD2489ES**

## CLEARANCES AND DIMENSIONS

- Dimensions that are shown in Figure 1 must be used. Given dimensions provide minimum clearance. Locate electrical outlet in the shaded area in the upper left-hand corner of the cutout. See Figure 9.
- Contact surface must be solid and level. Pay special attention to the floor on which the Microwave Drawer will sit. The floor of the opening should be constructed of plywood strong enough to support the weight of the oven (about 100 pounds).
- Check location where the Microwave Drawer will be installed for proper electrical supply.

- Your oven can be built into a cabinet or wall as a stand-alone unit. It can also be installed under gas or electric wall ovens, the SuperSteam oven model SSC2489DS or under the cooktop models SDH3042DB and SDH3652DB.
- Be sure that the clearance of the floor between the wall oven and the microwave drawer is a minimum of 2-inches.
- The microwave interior will easily accommodate a 9" x 13" oblong dish or a bag of microwave popcorn.
- The oven can also be mounted flush. Please see instructions for flush mounting.

## 24" MICROWAVE DRAWER STANDARD MOUNT AND MEASUREMENTS

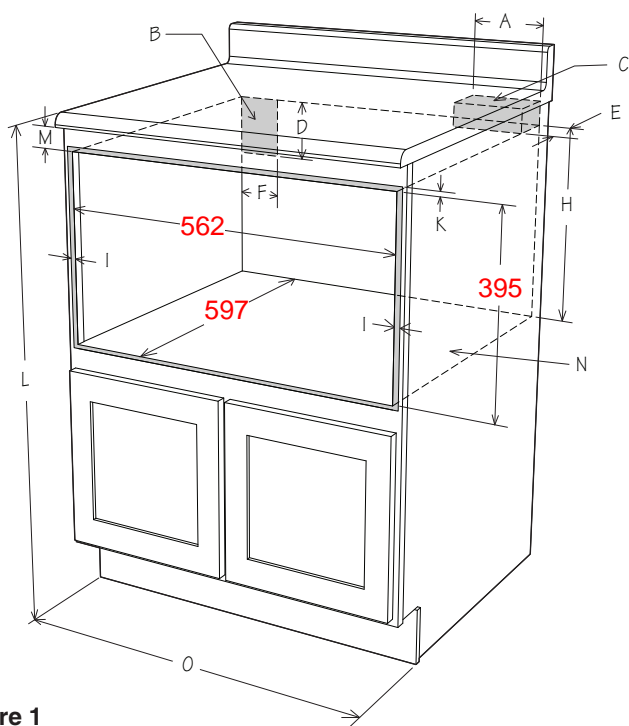

**Figure 1**

- |  |  |
|--|--|
| A. 6" (152.40 mm)  | minimum depth                                      |
| B. Suggested electrical outlet location*                       | K. Allow $\frac{7}{16}$ " (11.11 mm) overlap       |
| C. Anti-Tip block  | L. 36" (914.40 mm) countertop height               |
| D. 5" (127 mm)   | M. Allow $\frac{7}{16}$ " (11.11 mm) minimum space |
| E. $3\frac{1}{2}$ " (88.90 mm)                                 | N. Floor must support 100 lb (45.4 kg)             |
| F. 4" (101.60 mm)  | O. 24" (609.60 mm) cabinet minimum                 |
| G. $22\frac{1}{8}$ " (561.98 mm) opening                       | P. $15\frac{9}{16}$ " (395.29 mm) opening          |
| H. $14\frac{13}{16}$ " (376.24 mm) to bottom of Anti-Tip block |  |
| I. Allow $\frac{7}{8}$ " (22.22 mm) overlap                    |  |
| J. $23\frac{1}{2}$ " (596.90 mm)                               |  |

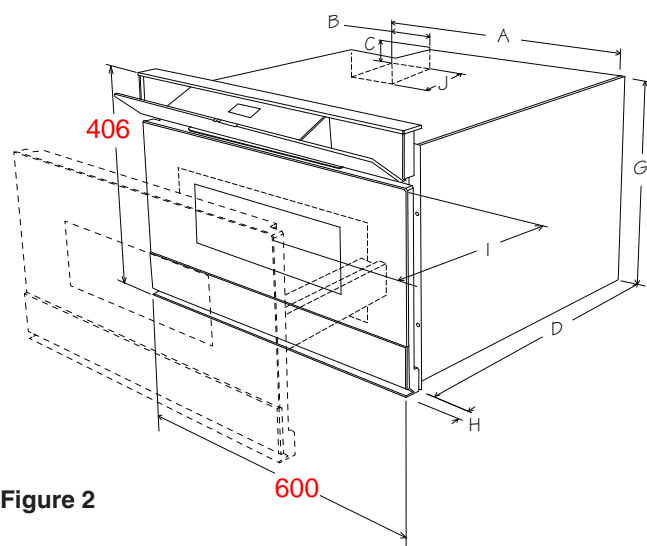

**Figure 2**

- |                                   |   |
|-----------------------------------|---|
| A. $21\frac{5}{8}$ " (549.28 mm)  | F. 16" (406.4 mm)                               |
| B. $4\frac{11}{16}$ " (119.06 mm) | G. $14\frac{19}{32}$ " (370.68 mm)              |
| C. $1\frac{3}{4}$ " (44.45 mm)    | H. $1\frac{17}{32}$ " (38.89 mm) door thickness |
| D. $21\frac{7}{8}$ " (555.63 mm)  | I. 15" (381 mm) auto drawer opening             |
| E. $23\frac{5}{8}$ " (600.07 mm)  | J. 4" (101.60 mm)                               |

Figures 1 and 2 contain many Microwave Drawer measurements for reference when planning the drawer's location.

Your oven can be built into a cabinet or wall as a stand-alone unit. It can also be installed under gas or electric wall ovens, the SuperSteam oven model SSC2489DS or under the cooktop models SDH3042DB and SDH3652DB.

\* Can also be installed using an electrical outlet in an adjacent cabinet within the area where the provided electrical cord can reach. Power cord access hole in cabinet should be a minimum  $1\frac{1}{2}$ " diameter hole and deburred of all sharp edges.

**IMPORTANT** Always allow sufficient power cord length to the electrical outlet to prevent tension.

Figure 3 represents a typical standard cabinet. If installed in custom cabinets with extended countertops, take into account visibility and access to controls. See Figure 4.

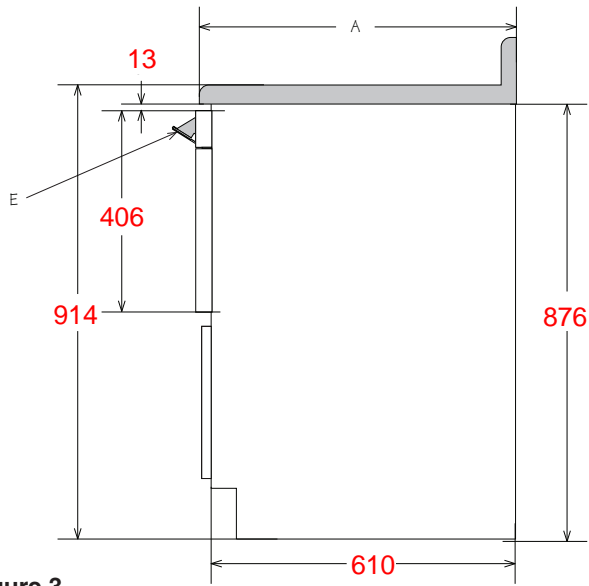

**Figure 3**

- |                           |   |
|---------------------------|---|
| A. 25" (635 mm)           | E. Control panel shown in open position |
| B. 1/2" (12.7 mm) minimum |   |
| C. 16" (406.4 mm)         | F. 24" (609.60 mm)                      |
| D. 36" (914.40 mm)        | G. 34 1/2" (876.30 mm)                  |

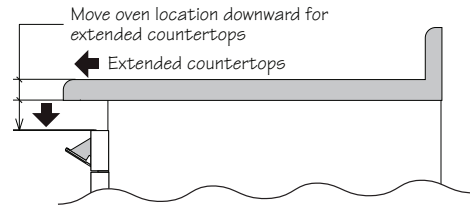

**Figure 4**