

48" Dual Fuel Range with Grill

Model: HR 1955 DF GR / HR 1955 DF GR LP



PRODUCT VIEWS

Isometric

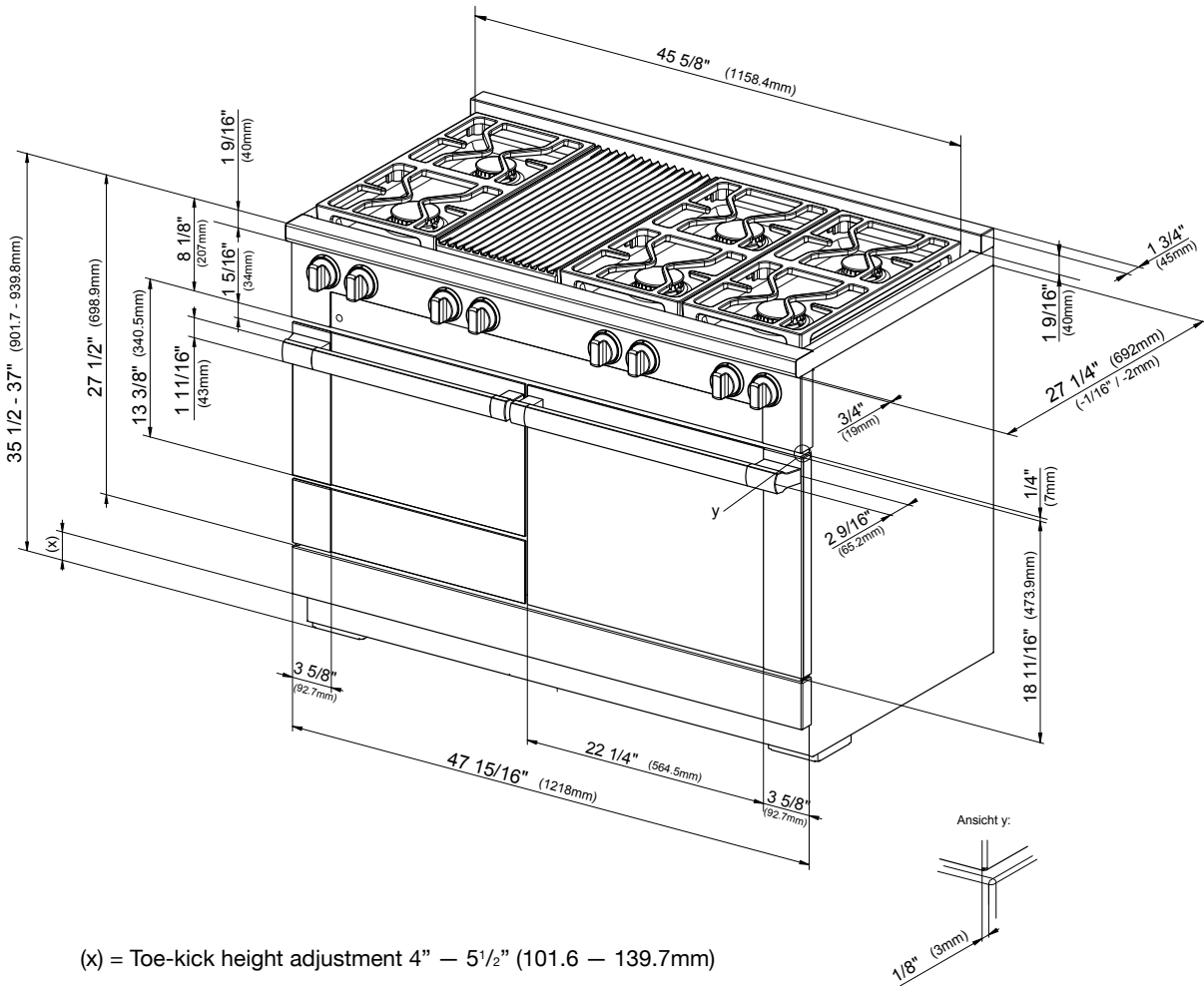

48” Range Wall Hood

Model: DAR 1250



PRODUCT VIEW

Duct Cover options

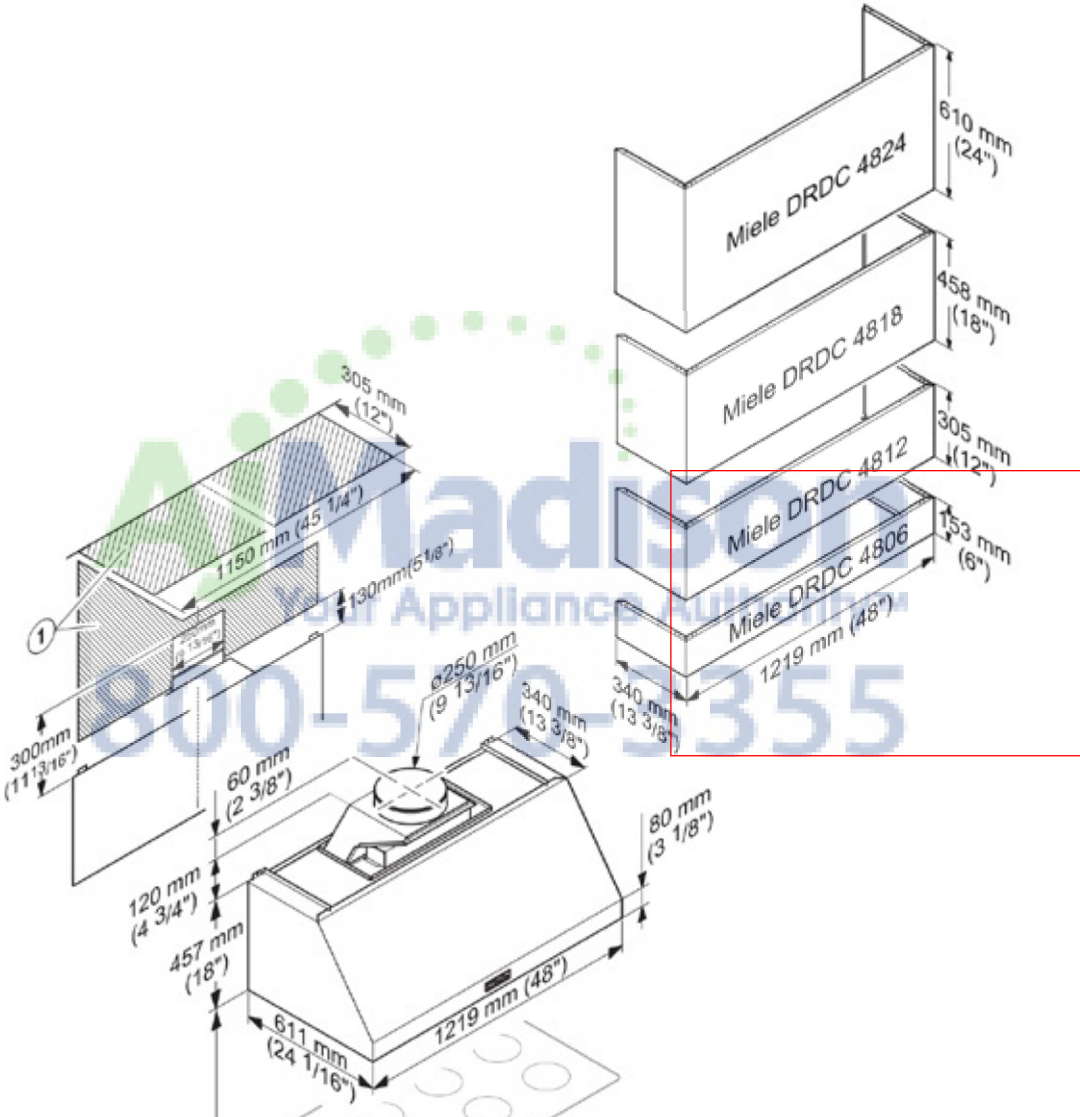

Recommended Combinations		INTERNAL BLOWER		EXTERNAL BLOWER	
		700 CFM DRIB XL	1100 CFM DRIB XXL	700 CFM DREB XL	1100 CFM DREB XXL
30"	DAR 1120 DAR 1220 ²	•		•	
36"	DAR 1130 DAR 1230 ²	• ¹	•	• ¹	•
48"	DAR 1150 DAR 1250		•		•

¹Can not be combined with HR 1134 G/LP, HR 1934 DF G/LP, KMR 1134 G/LP

²Recirculating kit can only be used in conjunction with DRIB XL 700 CFM Internal Blower

INSTALLATION SPECIFICATIONS

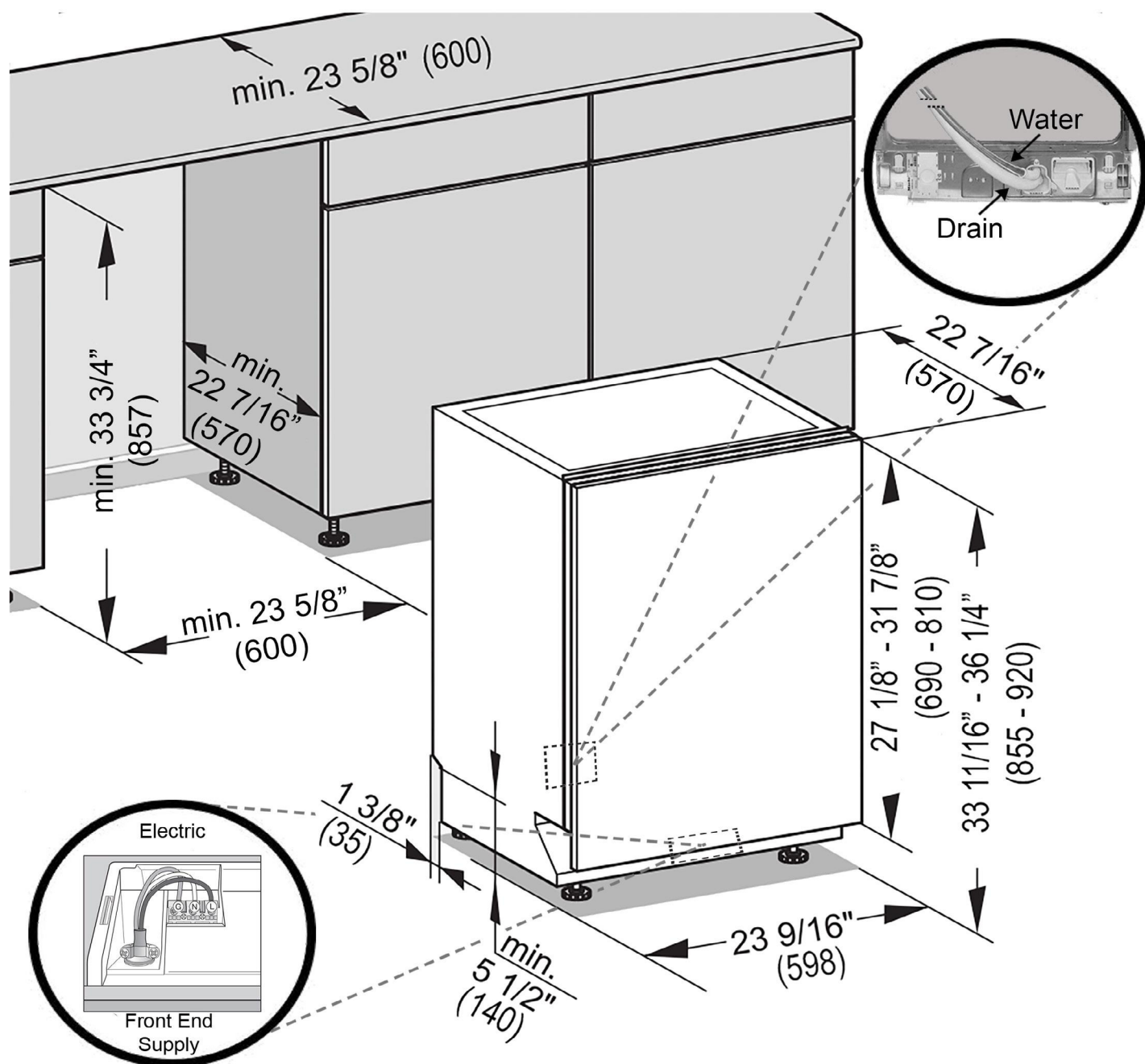

- Drain -** 4 ft 11 in (1.5 m) flexible drain hose.
(Connects from lower center rear)
- Water -** 4 ft 11 in (1.5 m) flexible water intake hose with 3/8" compression fitting.
(Connects from lower center rear)
- Electric -** 4 ft 11 in (1.5 m) 120V 15 A 3 wire molded NEMA 5-15 plug power supply. (Connects via Front End Supply or may be hardwired)

EcoFlex Series

Fully Integrated Dishwasher



Custom Panel Installation

Some Miele dishwashers do not come equipped with a front panel. These dishwashers are designed to accept a custom door panel supplied by a cabinet maker. Miele has a unique panel integration system which allows the dishwasher to align with the surrounding cabinets.

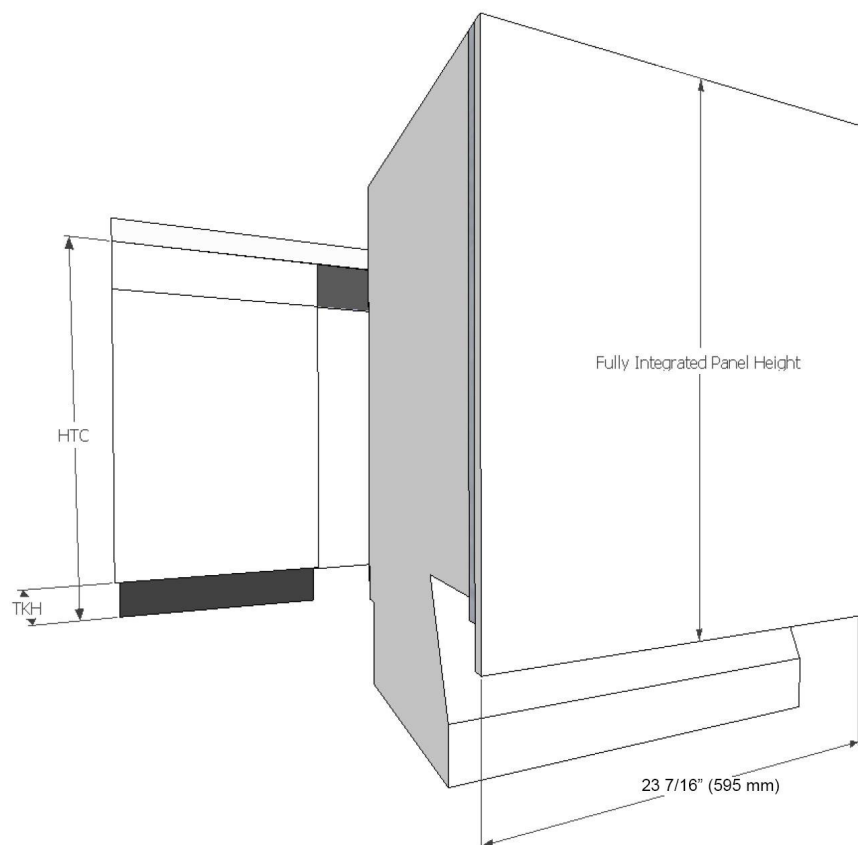

Width: 23 7/16" (595 mm) in all Cases
Thickness: 3/4" (19 mm) in all Cases
Height: Determined using the following calculation:

$$\text{Panel Height} = \text{HTC} - \text{TKH}$$

HTC = Height to the underside of countertop
TKH = Toe kick height

Note: Control panel is along the top edge of the unit. It is not visible when the unit is closed. A handle **MUST** be located on front of panel in order to open unit. (Except K2o models).

Maximum panel height: 31 7/8" (810 mm)

Minimum panel height: 27 1/8" (690 mm)

Maximum panel weight: 21 lbs (9.5 kg)

GFVI Installations

Miele offers pre-fabricated stainless steel panels for all fully integrated units. These panels are designed for various toe-kick heights and offer a choice of handle options. See Miele Product Brochure for more info.

For Knock2open (K2o) models, an additional kit is required for use with stainless steel panel. Please contact Miele for further details.

Fully Integrated 18" Freezer with Internal Ice Maker F 1413 Vi

FOR FLUSH INSTALLATION

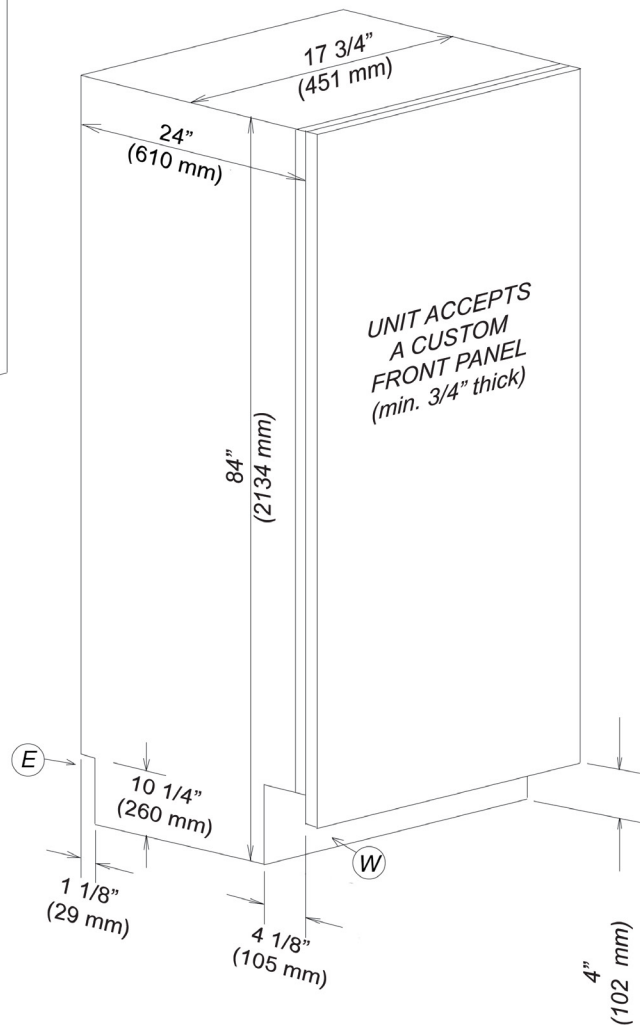
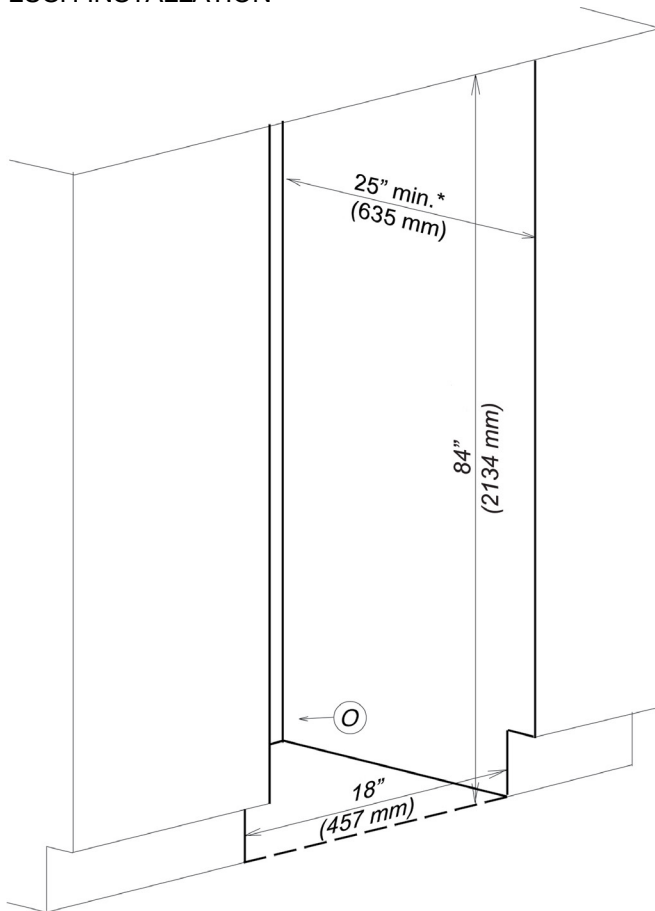

* Niche depth assumes a 3/4" (19 mm) panel, please adjust according to custom panel thickness

Location Codes

- E - 5 foot - Nema 5-15 molded plug power cord - connects lower left rear
- O - Standard NEMA 5-15 Outlet - locate less than 9" above finished floor
- W - 1/4" flexible water line - not included

Notes

- All Installations must be done in accordance with local codes
- Sides of adjoining cabinets should be filled (flush to frame) to insure proper fit and finish
- For side-by-side installation please refer to the Miele merging kit specification sheet - Some merge kits will require the location of the Electrical outlet(s) to be in adjacent cabinetry
- If design calls for a partition less than 6 5/16" (160 mm) the left unit's cutout will require an additional 1/8" (3 mm) to the width to allow installation of the Heating Mat.

Fully Integrated 18" Freezer with Internal Ice Maker F 1413 Vi

CUSTOM INSTALLATIONS

These units do not come equipped with a front panel. They are designed to accept a custom door panel supplied by the cabinet maker. Miele has a unique panel integration system which allows the panels to align with the surrounding cabinets.

Panel size is determined in the following manner:

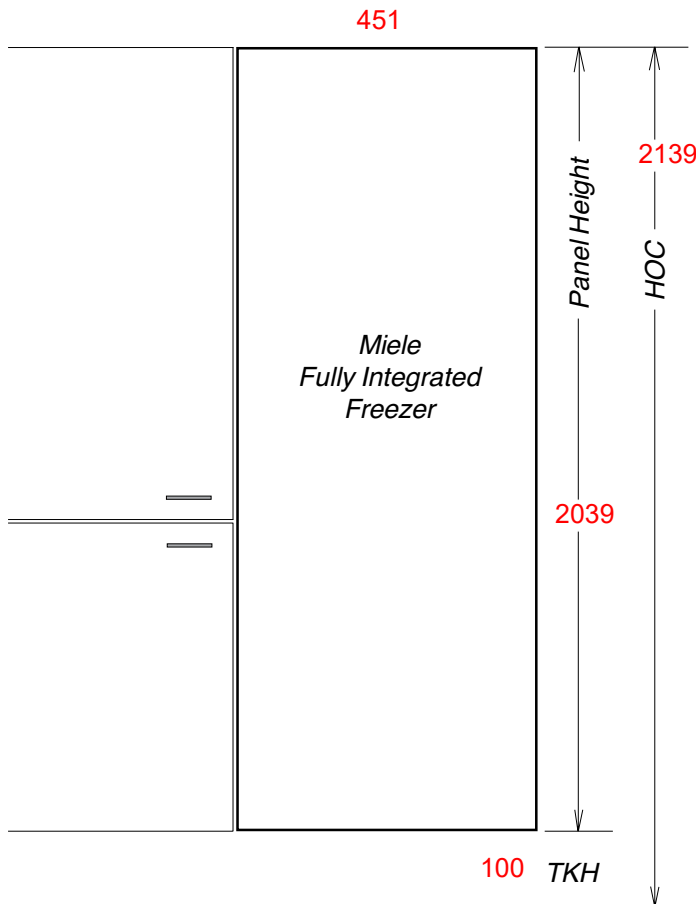

Width: 17 3/4" (451 mm) in all cases

Thickness: Minimum 3/4" (19 mm) outside frame

Height: Determined using the following calculation:

$$\text{Panel Height} = \text{HOC} - \text{TKH}$$

HOC = Total height of cabinet or side panel

TKH = Toe-kick height

Note: Finish back side of panels to insure appearance
Panel may extend above unit. This is **not** considered in height calculation

Maximum panel weight: 123 Pounds

Panel Notes

If the adjoining cabinets are taller than the height of machine (HOM) - the front panel may be extended accordingly. Simply maintain the toekick height and extend the panel the needed distance.

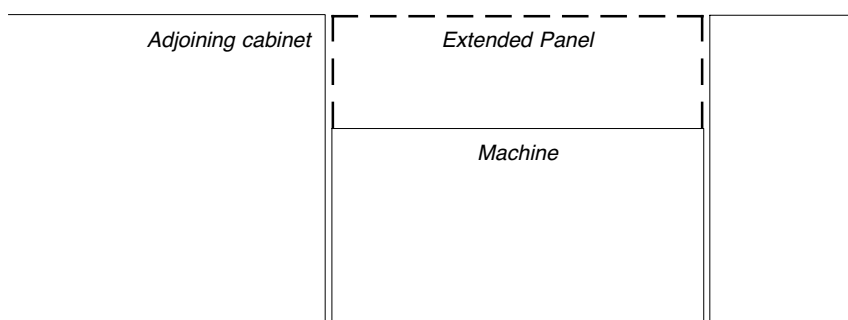

Fully Integrated 30" Refrigerator K 1813 Vi / K 1803 Vi

FOR FLUSH INSTALLATION

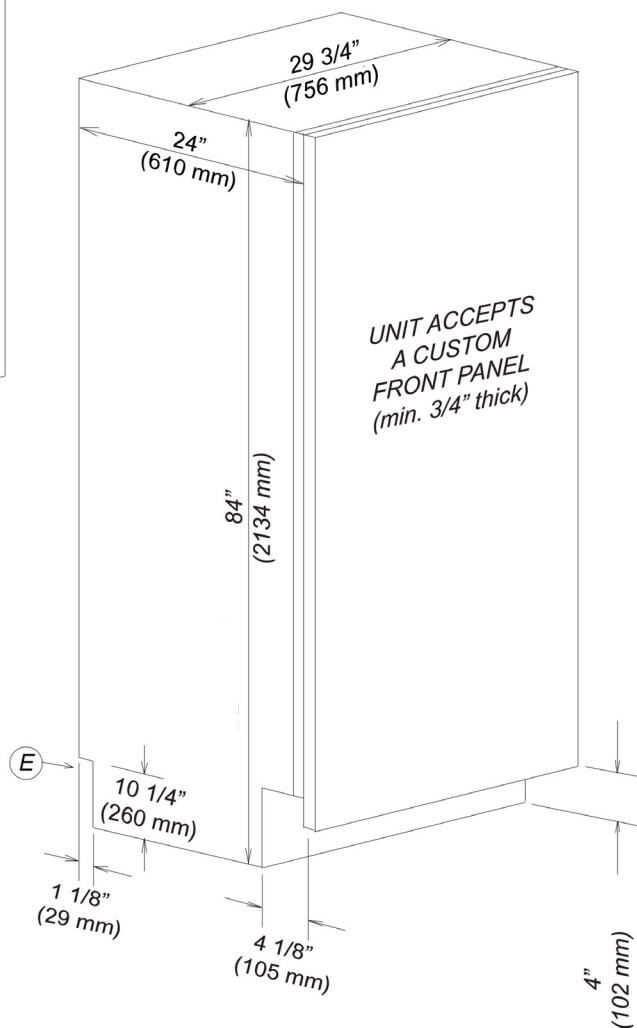
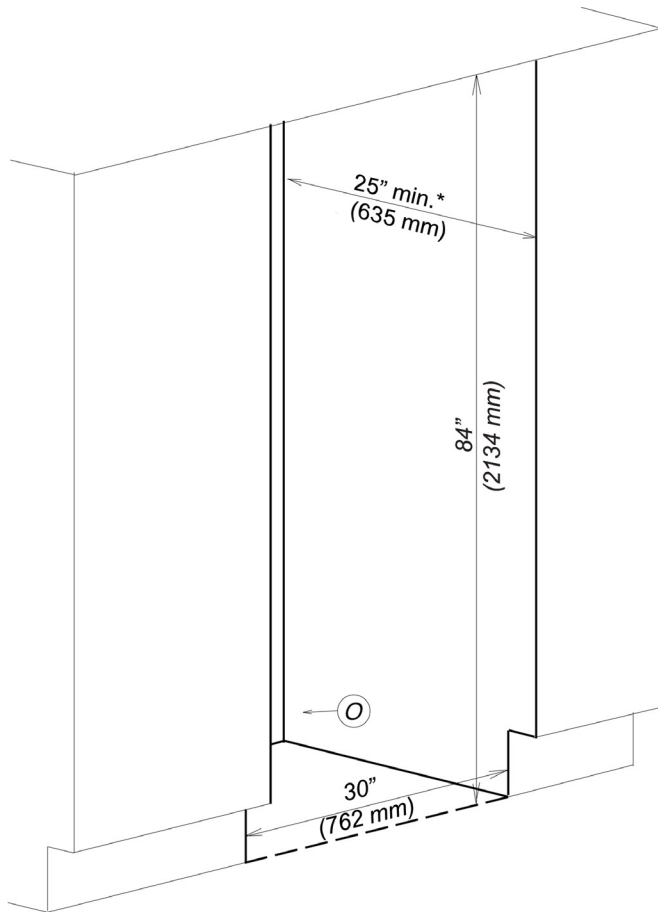

* Niche depth assumes a 3/4" (19 mm) panel, please adjust according to custom panel thickness

- E - 5 foot - Nema 5-15 molded plug power cord - connects lower left rear
- O - Standard NEMA 5-15 Outlet - locate less than 9" above finished floor

Notes

- All Installations must be done in accordance with local codes
- Sides of adjoining cabinets should be filled (flush to frame) to insure proper fit and finish
- For side-by-side installation please refer to the Miele merging kit specification sheet - Some merge kits will require the location of the Electrical outlet(s) to be in adjacent cabinetry
- If design calls for a partition less than 6 5/16" (160 mm) the left unit's cutout will require an additional 1/8" (3 mm) to the width to allow installation of the Heating Mat.

Fully Integrated 30" Refrigerator K 1813 Vi / K 1803 Vi

CUSTOM PANEL INSTALLATIONS

These units do not come equipped with a front panel. They are designed to accept a custom door panel supplied by the cabinet maker. Miele has a unique panel integration system which allows the panels to align with the surrounding cabinets.

Panel size is determined in the following manner:

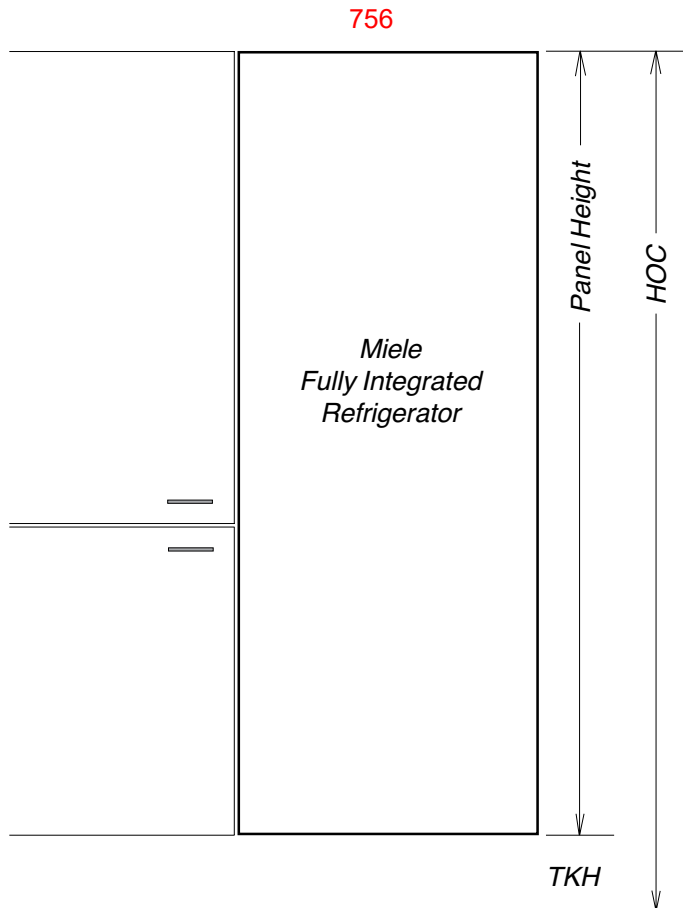

Width: 29 3/4" (756 mm) in all cases

Thickness: Minimum 3/4" (19 mm) outside frame

Height: Determined using the following calculation:

$$\text{Panel Height} = \text{HOC} - \text{TKH}$$

HOC = Total height of cabinet or side panel

TKH = Toe-kick height

Note: Finish back side of panels to insure appearance
Panel may extend above unit. This is **not** considered in height calculation

Maximum panel weight: 110 Pounds

Panel Notes

If the adjoining cabinets are taller than the height of machine (HOM) - the front panel may be extended accordingly. Simply maintain the toe-kick height and extend the panel the needed distance.

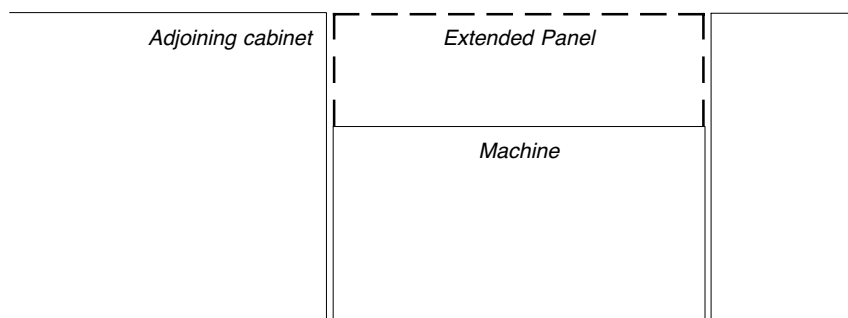

Product and Cut-out Dimensions

48" Side-by-Side Combination



FOR FLUSH INSTALLATION

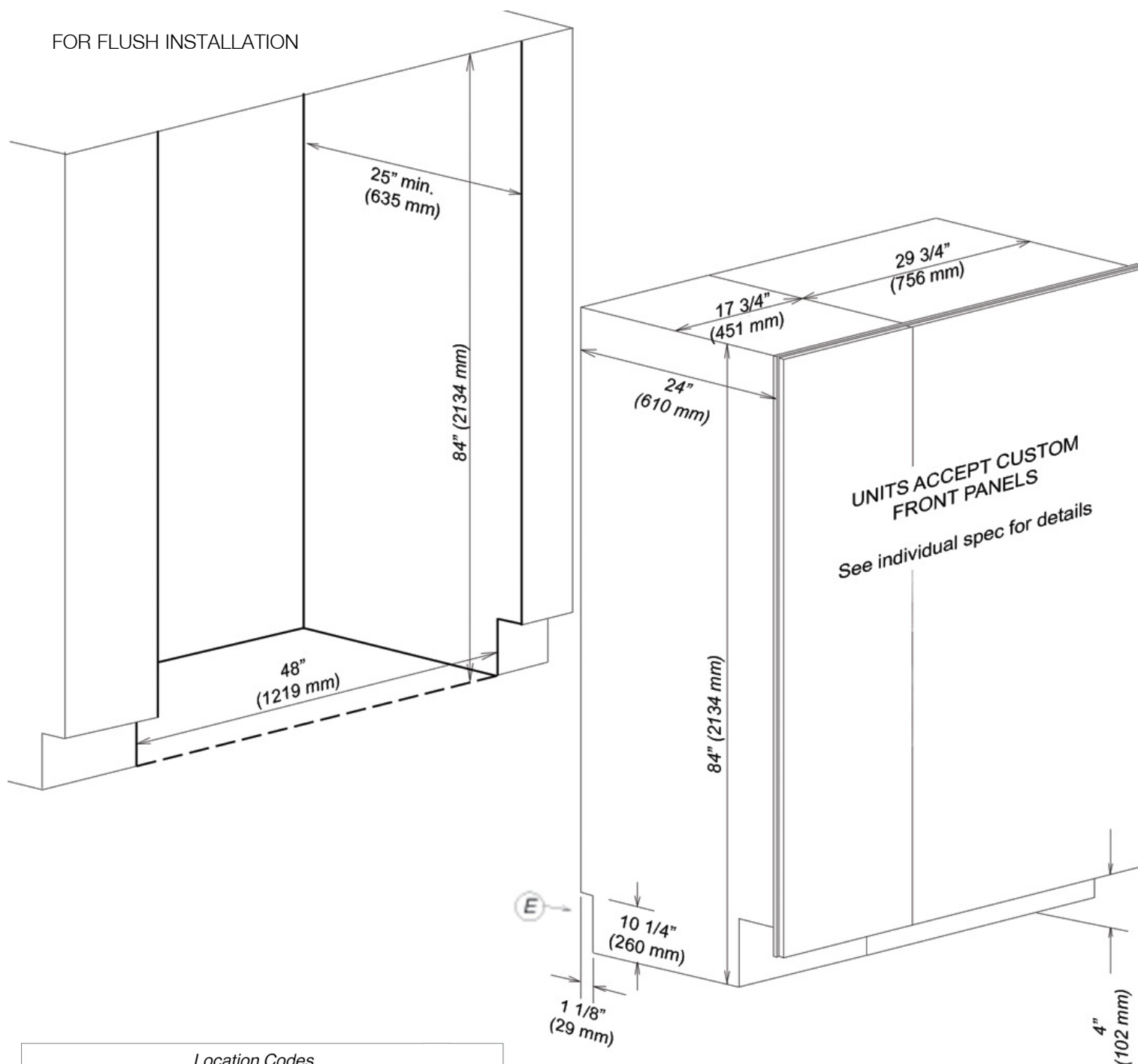

Location Codes

E- power cord for refrigeration unit- 5 foot- NEMA 5-15 molded plug power supply connects lower left rear of units

Notes

- Merging kit must be used when combining units
- All installations must be done in accordance with local codes
- Sides of adjoining cabinets should be filled (flush to frame) to insure proper fit and finish
- For Proud Installation - please adjust accordingly

*Depth assumes a 3/4" panel, please adjust according to custom panel thickness