

36" Counter-Depth 4-Door Refrigerator

800 Series – Stainless Steel B36CL80ENS



BOSCH
Invented for life

Installation Details

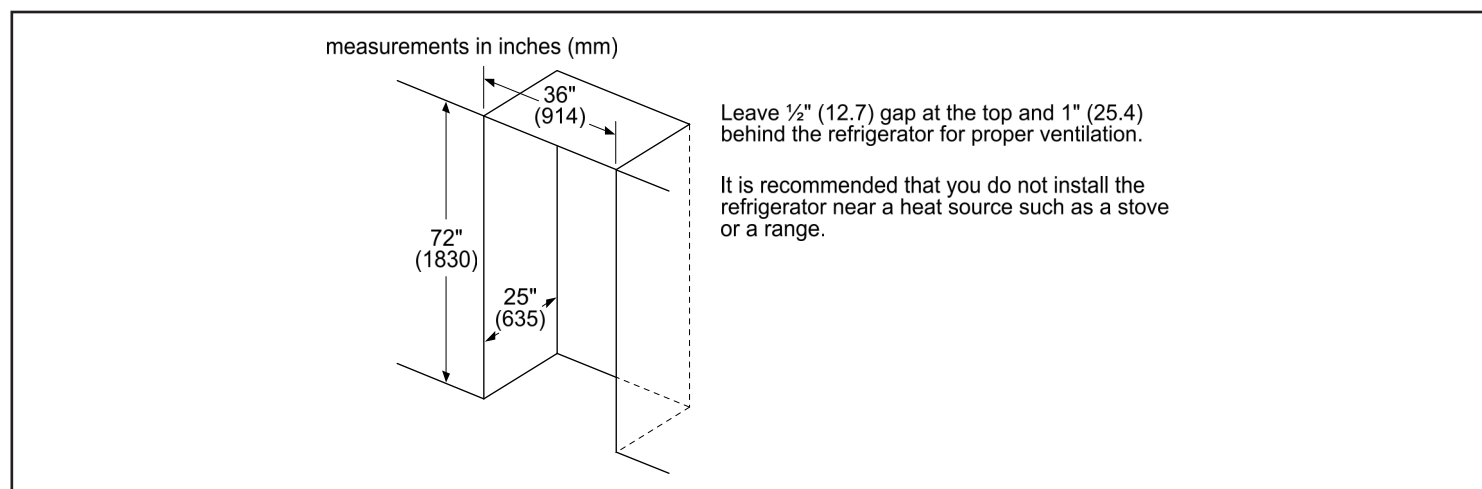
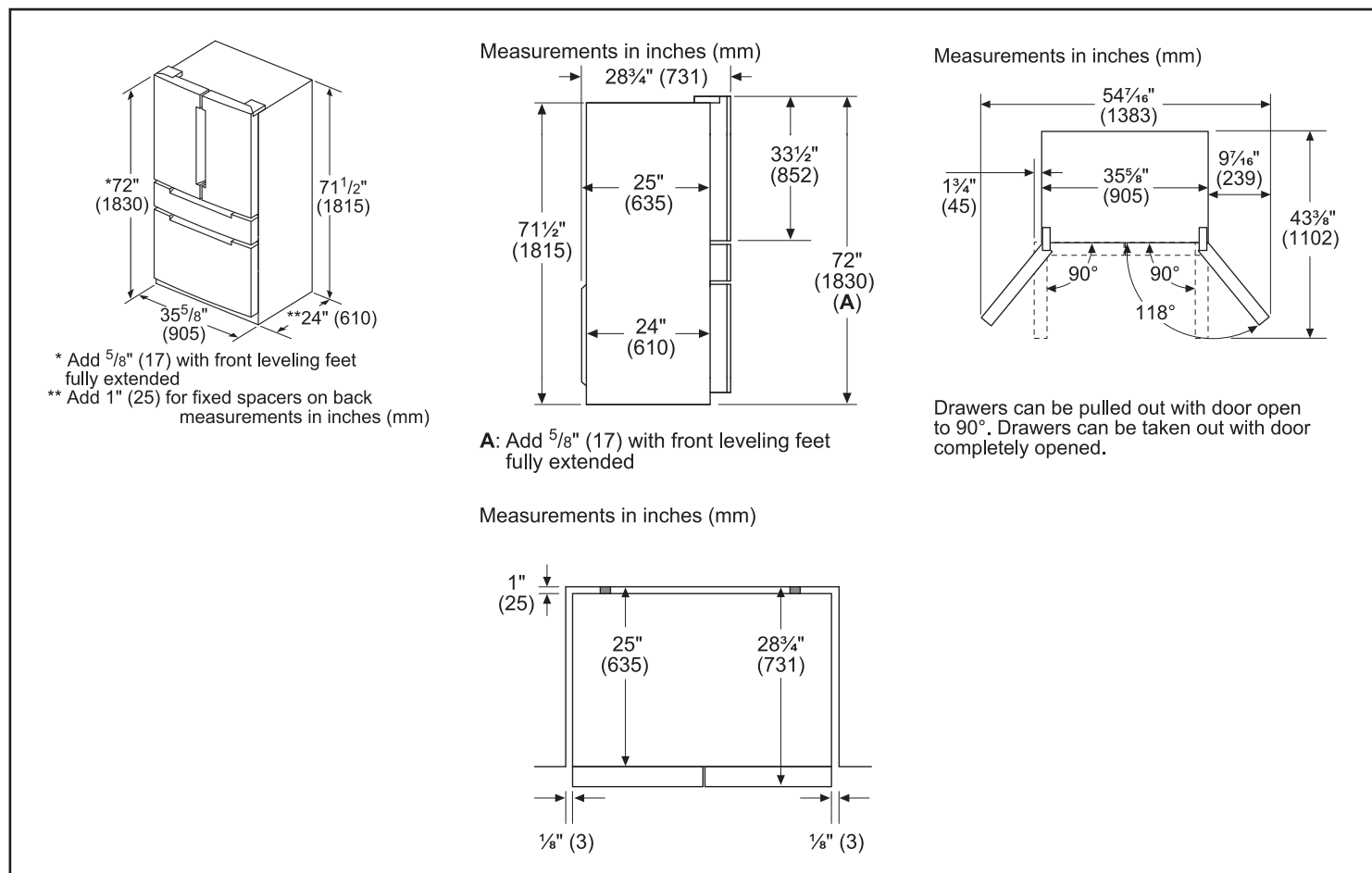

Accessories: To purchase Bosch accessories, cleaners & parts please visit www.bosch-home.com/us/store or call 1-800-944-2904 (Mon to Fri 5 am to 6 pm PST, Sat 6 am to 3 pm PST).

Notes: All height, width and depth dimensions are shown in inches. BSH reserves the absolute and unrestricted right to change product materials and specifications, at any time, without notice. Consult the product's installation instructions for final dimensional data and other details prior to making cutout.

Warranties: Please see Use & Care manual or Bosch website for statement of limited warranty.

For more information on our entire line of products, go to www.bosch-home.com/us or call 1-800-944-2904

© BSH Home Appliances Corporation. All rights reserved. Bosch is a registered trademark of Robert Bosch GmbH.



PRODUCT SPECIFICATIONS

Model	DO30PM/S/PH
Dimensions	29 7/8"W x 50 7/8"H x 23"D
Oven 1 Interior Dimensions	25 1/4"W x 17 1/2"H x 19 7/8"D
Oven 2 Interior Dimensions	25 1/4"W x 17 1/2"H x 19 7/8"D
Overall Capacity	5.1 cu ft
Usable Capacity	3.3 cu ft
Door Clearance	21 3/8"
Weight	466 lb
Electrical Supply	240/208 VAC, 60 Hz
Electrical Service	50 amp dedicated circuit
Conduit Length	5 feet

ELECTRICAL

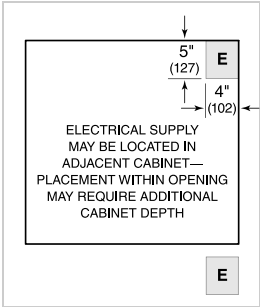

DIMENSIONS

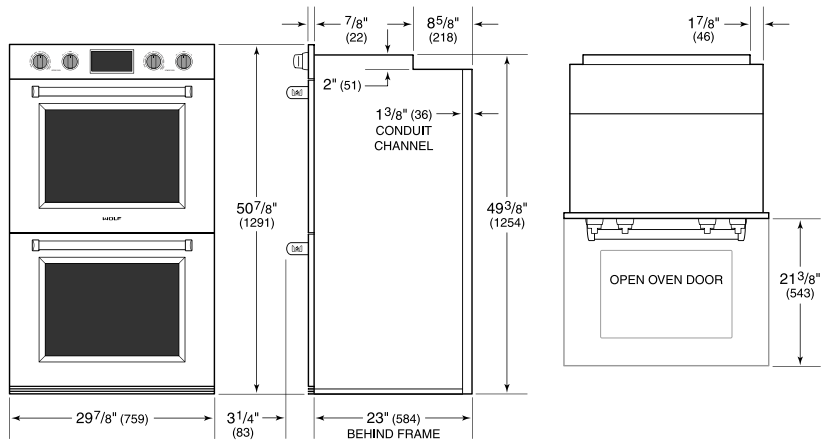

STANDARD INSTALLATION

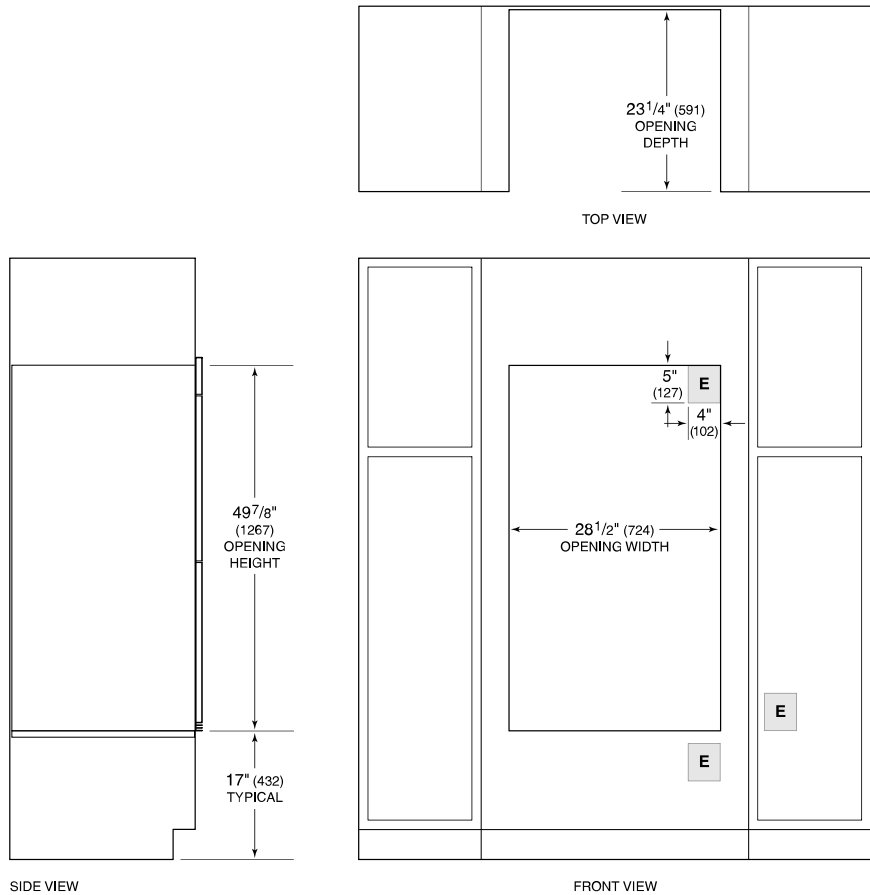

NOTE: Location of electrical supply within opening may require additional cabinet depth.

PRODUCT SPECIFICATIONS

Model	CG365P/S
Dimensions	36"W x 4"H x 21"D
Weight	68 lbs
Electrical Supply	120 VAC, 60 Hz
Electrical Service	15 amp dedicated circuit
Gas Supply	3/4" ID line
Gas Inlet	1/2" NPT female

ELECTRICAL

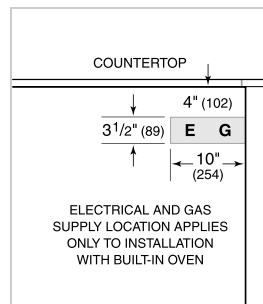

GAS

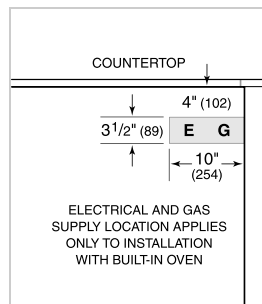

NOTE: Dimensions in parenthesis are in millimeters unless otherwise specified

DIMENSIONS

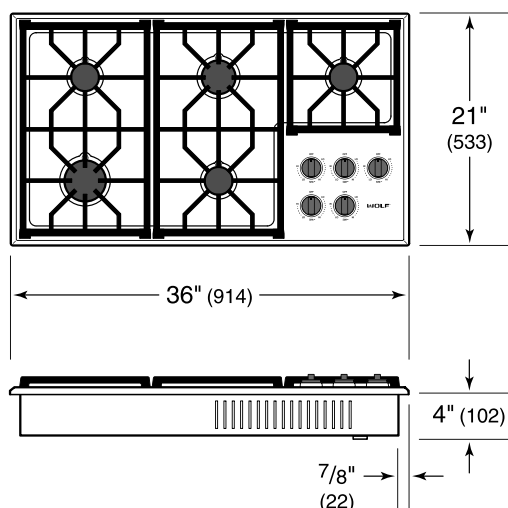

STANDARD INSTALLATION

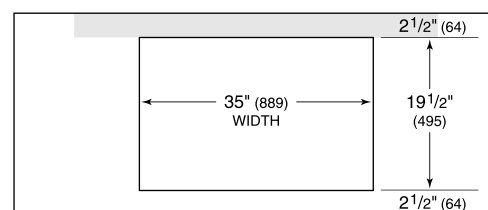

COUNTERTOP CUT-OUT

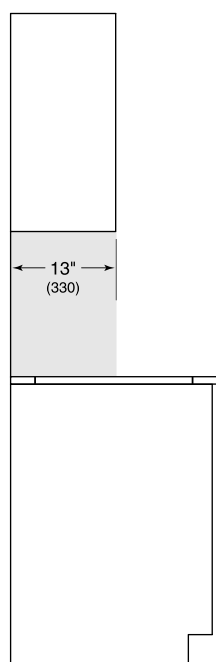

SIDE VIEW

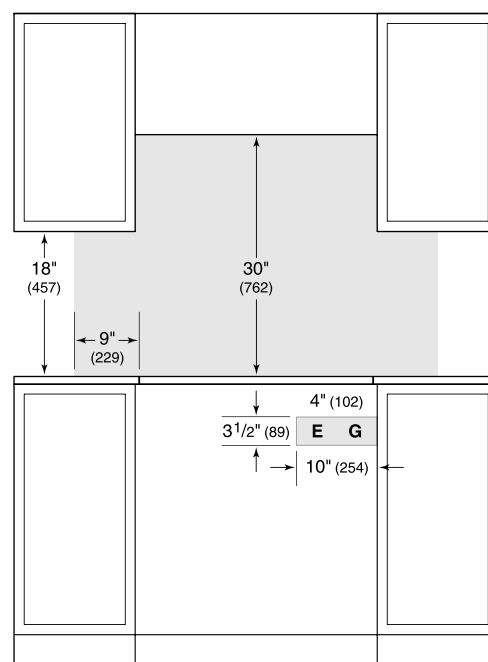

FRONT VIEW

NOTE: Shaded area above countertop indicates minimum clearance to combustible surfaces, combustible materials cannot be located within this area.
Electrical and gas supply location only applies to installations with built-in oven.

④ PRODUCT DIMENSIONS

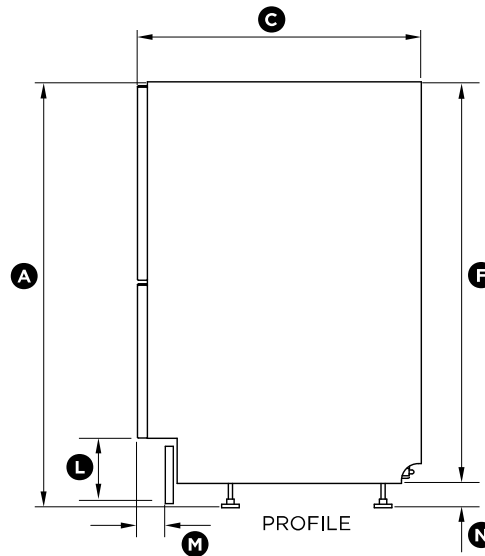
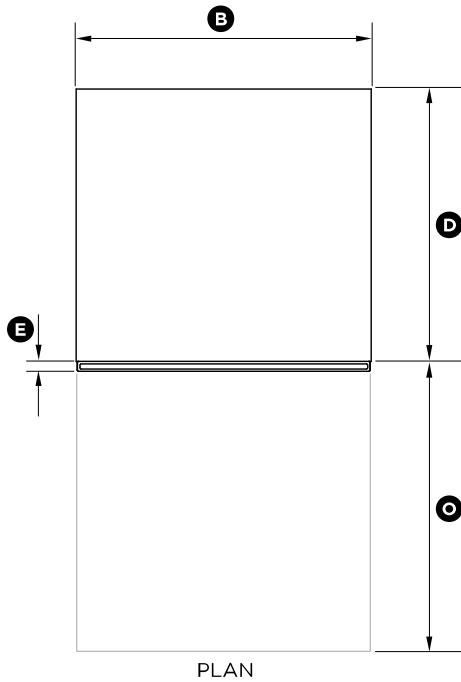
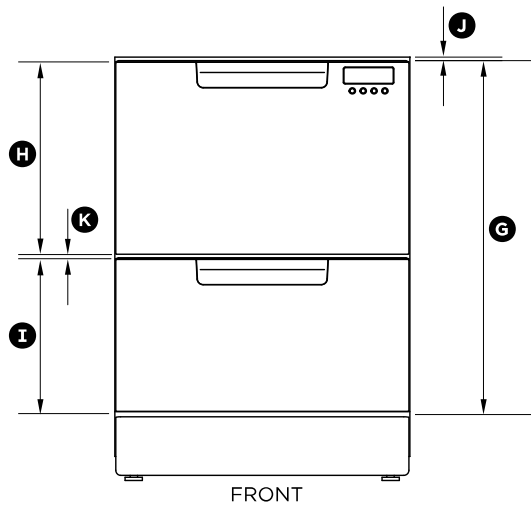

PRODUCT DIMENSIONS	DD24DA	DD24DCT
	INCHES (MM)	INCHES (MM)
Ⓐ Overall height of product ¹	32 5/16 - 34 5/8" (820-880) ²	34 - 36 3/8" (864-924) ²
Ⓑ Overall width of product	23 9/16" (599)	23 9/16" (599)
Ⓒ Overall depth of product	22 9/16" (573)	22 9/16" (573)
Ⓓ Depth of chassis (to back of front drawer panel)	21 3/4" (553)	21 3/4" (553)
Ⓔ Depth of drawer front panel	13/16" (20)	13/16" (20)
Ⓕ Height of chassis ¹	31 15/16" (811)	33 11/16" (855)
Ⓖ Height of drawer front panels	29 3/4" (756)	29 3/4" (756)
Ⓗ Height of upper drawer front panel	15 1/2" (393)	17 3/16" (437)
Ⓘ Height of lower drawer front panel	14" (356)	12 1/4" (312)
Ⓙ Height from top of drawer front panel to top of chassis	5/16" (8)	5/16" (8)
Ⓚ Ventilation gap between drawer front panels	1/4" (7)	1/4" (7)
Ⓛ Height of toekick (customisable)	2 13/16 - 5" (72-127)	2 13/16 - 5" (72-127)
Ⓜ Depth from front of drawer panel to front of toekick (adjustable) ³	1 1/2 - 4" (38-102)	1 1/2 - 4" (38-102)
Ⓝ Height of leveling feet (adjustable)	3/8 - 2 11/16" (9-69) ²	3/8 - 2 11/16" (9-69) ²
Ⓞ Maximum extension of drawer	21 9/16" (547)	21 9/16" (547)
¹ includes 1/16" (2mm) high bracket slots ² depending on adjustment of leveling feet		
³ adjustable to match toekick recess on adjoining cabinetry		

5 CABINETY DIMENSIONS

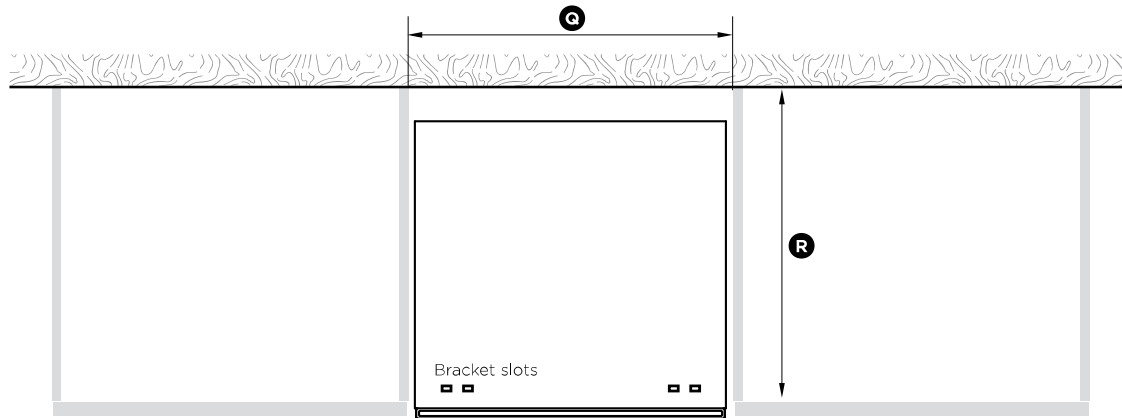

PLAN

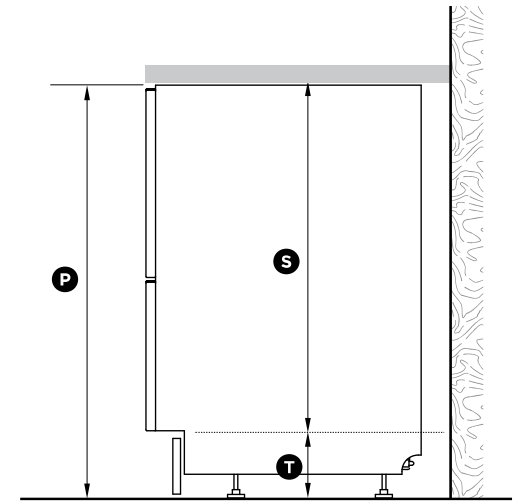

PROFILE

CABINETY DIMENSIONS	DD24DA	DD24DCT
	INCHES (MM)	INCHES (MM)
(P) Inside height of cavity*	min. 32 5/16" (820)	min. 34" (864)
(Q) Inside width of cavity	23 5/8" (600)	23 5/8" (600)
(R) Inside depth of cavity	min. 22 1/16" (560)	min. 22 1/16" (560)
(S) Recommended height of adjacent cabinet space	30" (762)	30" (762)
(T) Height of toekick space*	2 3/8 - 4 3/4" (60-120)	3 15/16" - 6 5/16" (100-160)

* depending on adjustment of leveling feet

Minimum clearances from adjacent cabinetry

