

## SITE PREPARATION CABINET CUTOUT OPTIONS

#JS48NFXDE

### AIRFLOW VENTING RECOMMENDATIONS

#### IMPORTANT:

- Armoire-style installations recommends a minimum of 1/8" (3.2 mm) of open space above the refrigerator. It is recommended that this space not be blocked in any way, including soffits.
- Models may be installed using either Option 1, Option 2 or option 3.

Option 1 - Open to Ceiling

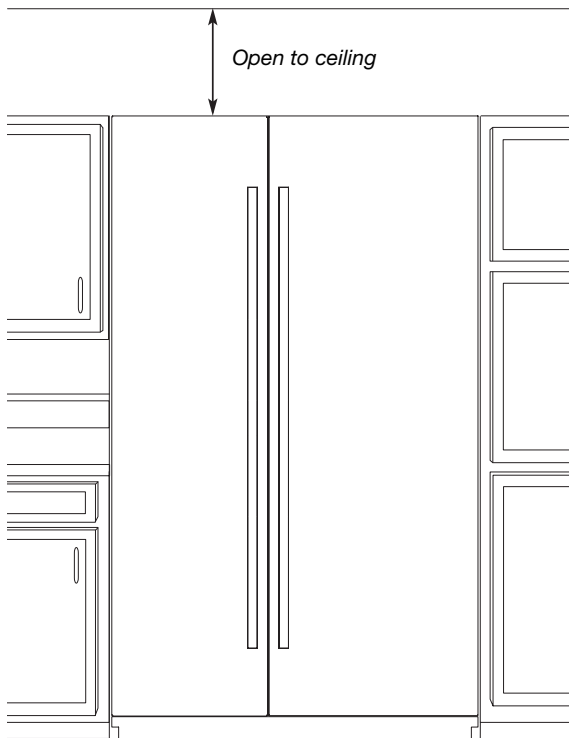

Option 2 - False Front (cabinet face only)

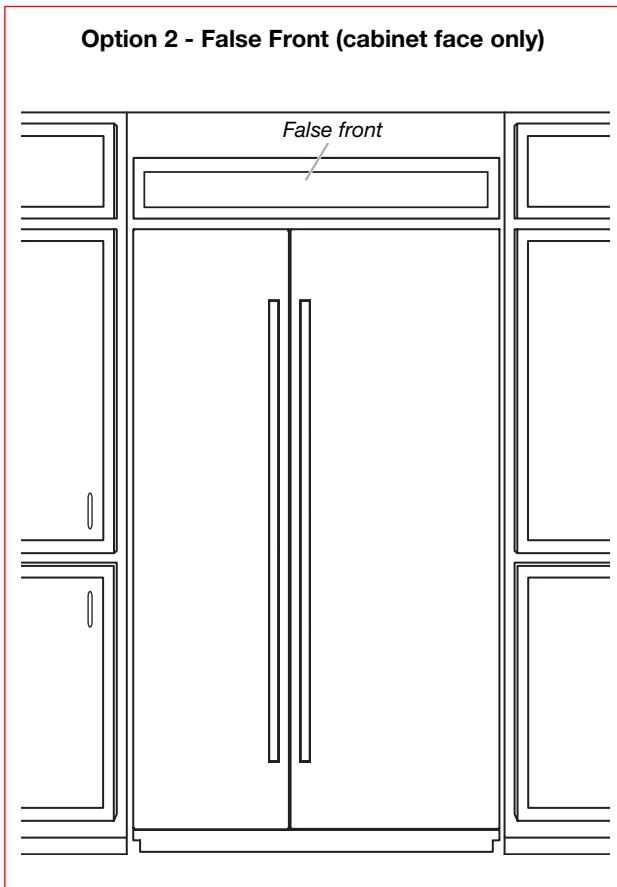

Option 3 - Closed Soffit

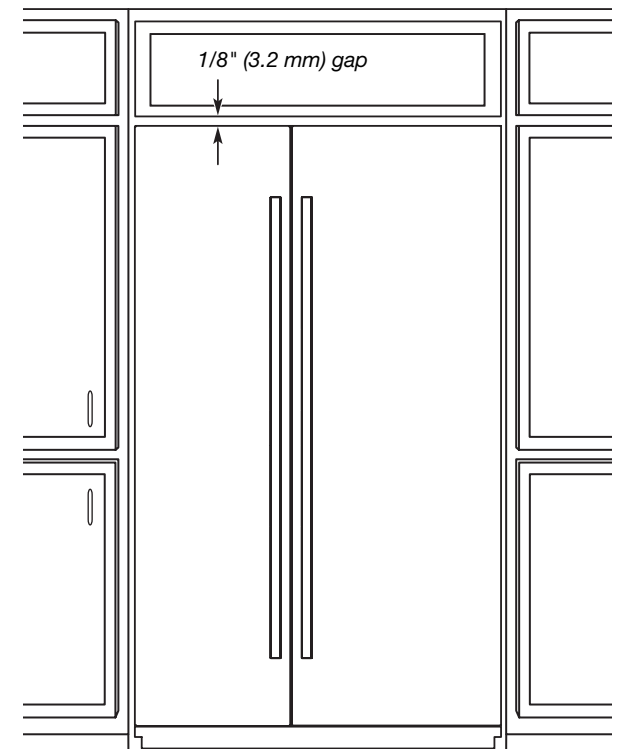

# SITE PREPARATION

## PANEL DIMENSIONS

#JS48NXFXDE

### BOTTOM MOUNT MODEL

- ! Maximum allowable weights:
- Door panel - 60 lbs (27.2 kg)
  - Drawer panel - 25 lbs (11.3 kg)

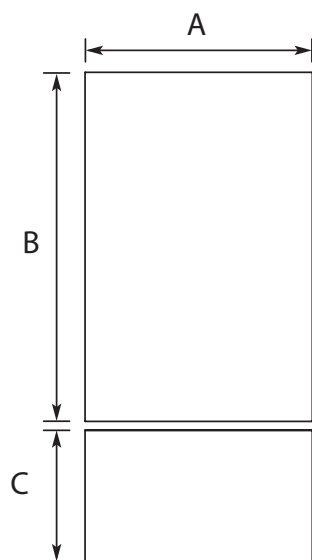

Legend	Model	Dimension
<b>A</b>	36"	35 <sup>3</sup> / <sub>4</sub> " (90.81 cm)
<b>B</b>	36"	59 <sup>1</sup> / <sub>8</sub> " (150.2 cm)
<b>C</b>	36"	20 <sup>1</sup> / <sub>2</sub> " (52.07 cm)

### FRENCH DOOR BOTTOM MOUNT MODELS

- ! Maximum allowable weights:
- Door panel - 38 lbs (17.2 kg)
  - Drawer panel (36" model) - 25 lbs (11.3 kg)
  - Drawer panel (42" model) - 30 lbs (13.6 kg)

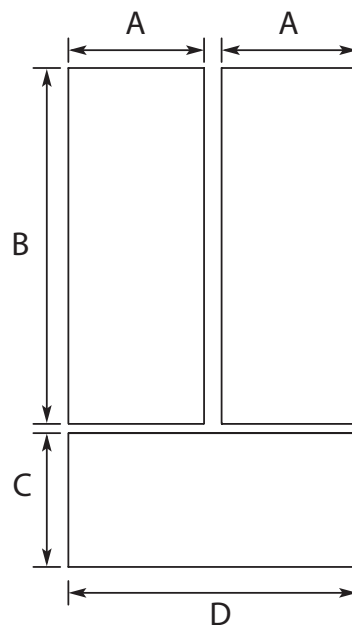

Legend	Model	Dimension
<b>A</b>	36"	17 <sup>3</sup> / <sub>4</sub> " (45.24 cm)
<b>B</b>		59 <sup>1</sup> / <sub>8</sub> " (150.2 cm)
<b>C</b>		20 <sup>1</sup> / <sub>2</sub> " (52.07 cm)
<b>D</b>		35 <sup>3</sup> / <sub>4</sub> " (90.81 cm)
<b>A</b>	42"	20 <sup>3</sup> / <sub>4</sub> " (52.86 cm)
<b>B</b>		59 <sup>1</sup> / <sub>8</sub> " (150.2 cm)
<b>C</b>		20 <sup>1</sup> / <sub>2</sub> " (52.07 cm)
<b>D</b>		41 <sup>3</sup> / <sub>4</sub> " (106.05 cm)

### SIDE BY SIDE MODELS

- ! Maximum allowable weights (42" models):
- Refrigerator Door panel - 65 lbs (29.5 kg)
  - Freezer Door panel - 49 lbs (22.2 kg)
- Maximum allowable weights (48" models):
- Refrigerator Door panel - 66 lbs (29.9 kg)
  - Freezer Door panel - 50 lbs (23 kg)

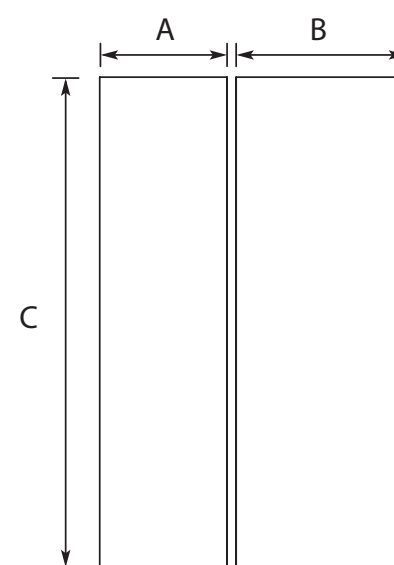

Legend	Model	Dimension
<b>A</b>	42"	17 <sup>3</sup> / <sub>4</sub> " (45.24 cm)
<b>B</b>		23 <sup>3</sup> / <sub>4</sub> " (60.48 cm)
<b>C</b>		81" (205.7 cm)
<b>A</b>	48"	20 <sup>1</sup> / <sub>4</sub> " (51.59 cm)
<b>B</b>		27 <sup>1</sup> / <sub>4</sub> " (69.37 cm)
<b>C</b>		81" (205.7 cm)



# 48" FULLY INTEGRATED SIDE-BY-SIDE REFRIGERATORS

## DETAILED PLANNING DIMENSIONS GUIDE

(BASE UNIT REQUIRES SUITE-COORDINATING FULL HEIGHT PANEL KIT OR CUSTOM PANELS AND HANDLES)

**#JS48NFXDE**

**JS48NFXDE** – 47<sup>3</sup>/<sub>4</sub>" (W) x 83<sup>1</sup>/<sub>8</sub>" (H) x 24" (depth without door panels/handles)

### PRODUCT DIMENSIONS (INCLUDING STAINLESS STEEL DOOR PANEL KIT DIMENSIONS)

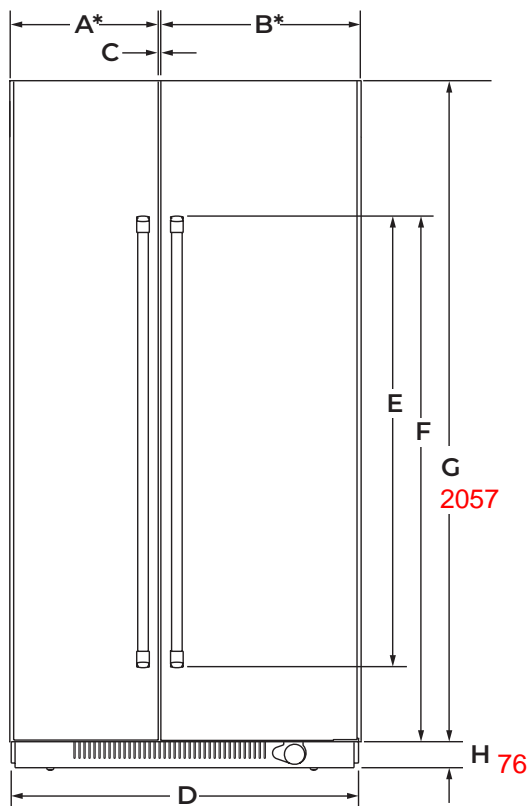

FRONT VIEW

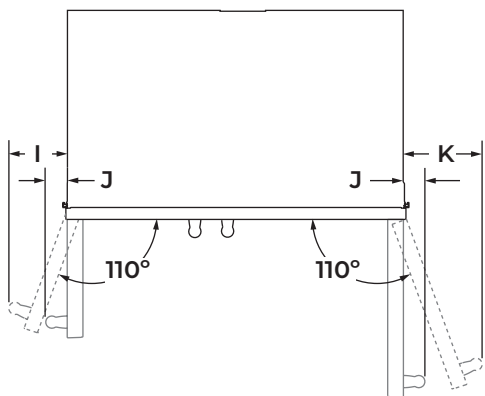

TOP VIEW

DIMENSION	DESCRIPTION	JS48NFXDE
A*	Width of freezer door	20 <sup>5</sup> / <sub>16</sub> " (51.6 cm)
B*	Width of refrigerator door	27 <sup>5</sup> / <sub>16</sub> " (69.4 cm)
C	Space between doors	1/8" (0.3 cm)
D	Overall width (including vinyl side trim)	47 <sup>3</sup> / <sub>4</sub> " (121.3 cm)
E	<b>Height of door handle</b>	
	RISE™ Stainless	58" (147.3 cm)
	NOIR™ Stainless	40 <sup>5</sup> / <sub>8</sub> " (103.2 cm)
F	<b>Height to top of door handle</b>	
	RISE™ Stainless	71 <sup>11</sup> / <sub>16</sub> " (182.1 cm)
	NOIR™ Stainless	69 <sup>13</sup> / <sub>16</sub> " (177.3 cm)
G	Height of door	81" (205.7 cm)
H	Height of bottom grille	3" (7.6 cm)
I	<b>Width from side of refrigerator to freezer door handle – door fully open 110°</b>	
	RISE™ Stainless	8 <sup>3</sup> / <sub>8</sub> " (20.7 cm)
	NOIR™ Stainless	7 <sup>5</sup> / <sub>8</sub> " (19.3 cm)
J	<b>Width from side of refrigerator to handle – door open 90°</b>	
	RISE™ Stainless	2 <sup>3</sup> / <sub>8</sub> " (6.1 cm)
	NOIR™ Stainless	1 <sup>5</sup> / <sub>8</sub> " (4.1 cm)
K	<b>Width from side of refrigerator to refrigerator door handle – door fully open 110°</b>	
	RISE™ Stainless	10 <sup>9</sup> / <sub>16</sub> " (26.8 cm)
	NOIR™ Stainless	10 <sup>1</sup> / <sub>16</sub> " (25.5 cm)

\*Door width dimensions are for stainless steel panel kit only.

Because Whirlpool Corporation policy includes a continuous commitment to improve our products, we reserve the right to change materials and specifications without notice.

Dimensions are for planning purposes only. For complete details, see Installation Instructions packed with product. Specifications subject to change without notice.



# 48" FULLY INTEGRATED SIDE-BY-SIDE REFRIGERATORS

## DETAILED PLANNING DIMENSIONS GUIDE

(BASE UNIT REQUIRES SUITE-COORDINATING FULL HEIGHT PANEL KIT OR CUSTOM PANELS AND HANDLES)

**#JS48NFXDE**

JS48NFXDE – 47<sup>3</sup>/<sub>4</sub>" (W) x 83<sup>1</sup>/<sub>8</sub>" (H) x 24" (depth without door panels/handles)

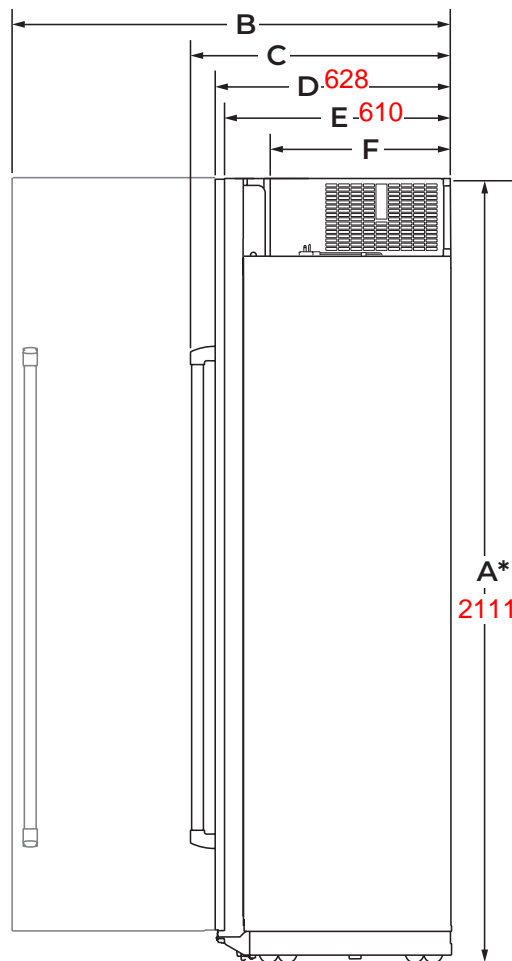

SIDE VIEW

DIMENSION	DESCRIPTION	JS48NFXDE
<b>A*</b>	Height of recessed refrigerator (min.)	83 <sup>1</sup> / <sub>8</sub> " (211.1 cm)
<b>B</b>	Depth with refrigerator door open 90° (min.)	50 <sup>3</sup> / <sub>4</sub> " (128.8 cm)
<b>C</b>	<b>Depth with handles (min.)</b>	
	RISE™ Stainless	27 <sup>11</sup> / <sub>16</sub> " (70.2 cm)
	NOIR™ Stainless	26 <sup>7</sup> / <sub>8</sub> " (68.2 cm)
<b>D</b>	<b>Depth with doors (min.)</b>	
	RISE™ Stainless	24 <sup>3</sup> / <sub>4</sub> " (62.8 cm)
	NOIR™ Stainless	24 <sup>3</sup> / <sub>4</sub> " (62.8 cm)
	Custom panel (3/4"/1.9 cm)	24 <sup>3</sup> / <sub>4</sub> " (62.8 cm)
<b>E</b>	Depth without door panel kit (min.)	24" (61 cm)
<b>F</b>	Depth of compressor cover (min.)	19 <sup>7</sup> / <sub>8</sub> " (50.5 cm)

\*Add 1<sup>1</sup>/<sub>4</sub>" (3.2 cm) to the height dimension when leveling legs are fully extended.



# 48" FULLY INTEGRATED SIDE-BY-SIDE REFRIGERATORS

## DETAILED PLANNING DIMENSIONS GUIDE

(BASE UNIT REQUIRES SUITE-COORDINATING FULL HEIGHT PANEL KIT OR CUSTOM PANELS AND HANDLES)

**#JS48NXXFXDE**

JS48NXXFXDE – 47<sup>3</sup>/<sub>4</sub>" (W) x 83<sup>1</sup>/<sub>8</sub>" (H) x 24" (depth without door panels/handles)

### AIRFLOW VENTING RECOMMENDATIONS

#### CLOSED SOFFIT CABINET

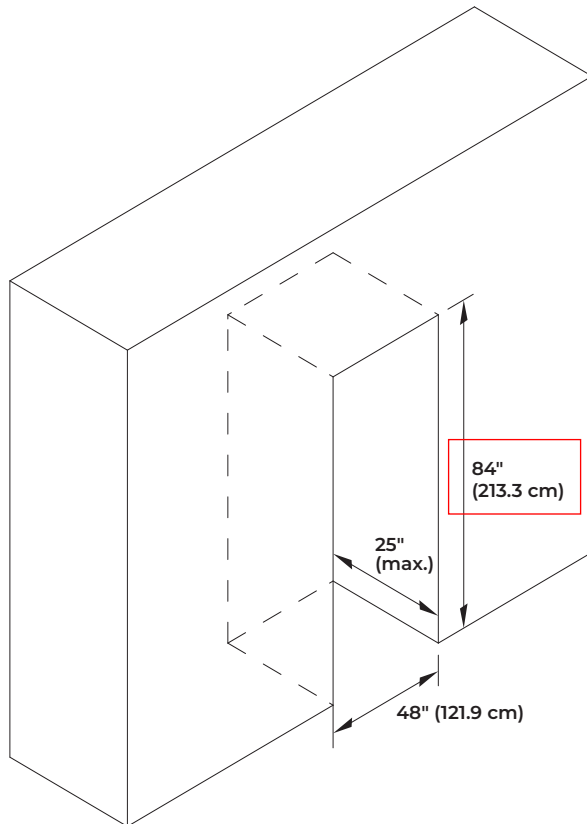

- Depth of cabinet must be less than 25" (63.5 cm).
- Height of soffit must not exceed 84" (213.3 cm).

- Following illustrations explain the cabinet construction (soffit and rear wall positions) required for optimum ventilation and airflow.

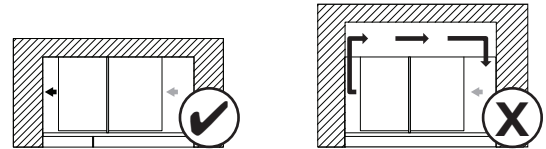

Top View

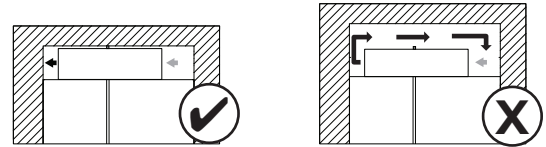

Front View

Grey arrow = ambient air; Black arrow = warm air  
Cabinet depth 25" and soffit located at 84", provides proper airflow/ventilation to the refrigerator. Efficient cooling is achieved.

Cabinet depth more than 25" and/or soffit located at more than 84", causes air gap at back and/or top of the refrigerator. Air gap allows warm air recirculation causing loss in cooling efficiency.

- If your opening does not meet these requirements, you will need to make modifications.

DIMENSIONS

JENNAIR® RANGETOPS

PRODUCT

36" Range top

#JGCP536HM

	30" RANGETOP JGCP430H	36" RANGETOP JGCP436H	48" RANGETOP JGCP548H
Overall Width (A)	29-3/4" (75.6 cm)	35-3/4" (90.8 cm)	47-7/8" (121.6 cm)
Grate Depth (B)	22" (55.9 cm)	22" (55.9 cm)	22" (55.9 cm)
Depth without Control Panel (C)	23-1/4" (59.1 cm)	23-1/4" (59.1 cm)	23-1/4" (59.1 cm)
Depth with Control Panel Overhang (D)	27-1/2" (69.9 cm)	27-1/2" (69.9 cm)	27-1/2" (69.9 cm)
Depth with Knobs: RISE™ (E)	29-1/8" (74 cm)	29-1/8" (74 cm)	29-1/8" (74 cm)
Depth with Knobs: NOIR™ (E)	29" (73.7 cm)	29" (73.7 cm)	29" (73.7 cm)

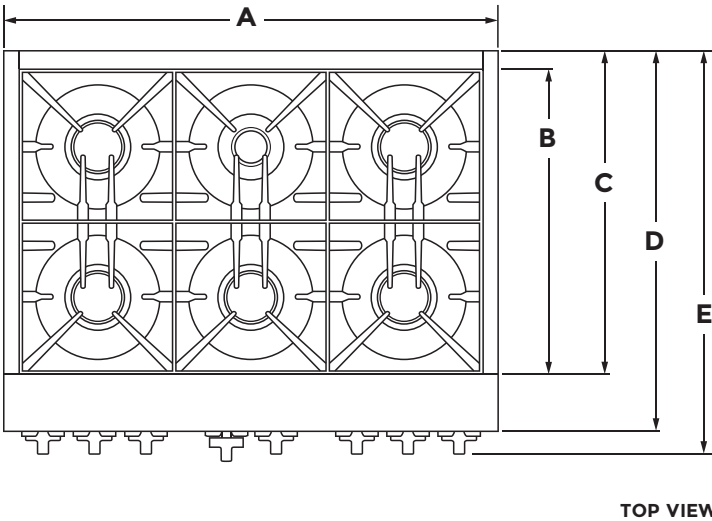

★

**IMPORTANT:** Dimensional specifications are provided for planning purposes only. Do not make any cutouts based on this information. Refer to the Installation Guide before selecting cabinetry, verifying electrical/gas connections, making cutouts or beginning installation. All JennAir® appliances are appropriately UL, CUL or CSA approved.

DIMENSIONS

JENNAIR® RANGETOPS

PRODUCT

36" Range top

#JGCP536HM

	30" RANGETOP JGCP430H	36" RANGETOP JGCP436H	48" RANGETOP JGCP548H
Grate Width (F)*	27-7/16" (69.7 cm)	33" (83.8 cm)	44-3/8"* (112.7 cm)
Gas Inlet to Surface (G)	10-3/4" (27.3 cm)	10-3/4" (27.3 cm)	10-3/4" (27.3 cm)
Center to Gas Inlet (H)	11" (27.9 cm)	14-1/8" (35.9 cm)	19-5/8" (49.8 cm)
Recessed Rangetop Width (I)	29-1/8" (74 cm)	35" (88.9 cm)	47-1/4" (120 cm)

\*Includes width of grates and griddle.

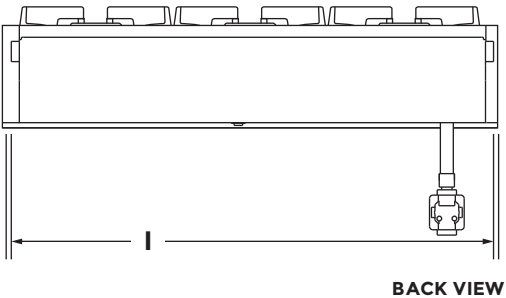
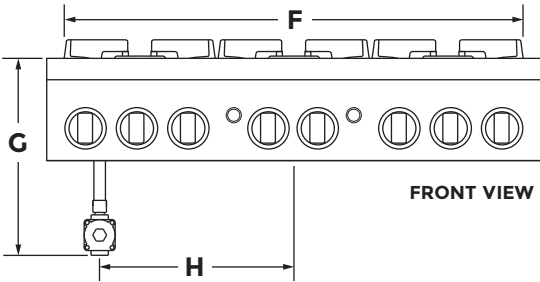

# DIMENSIONS

## JENNAIR® RANGETOPS

### PRODUCT

★ 36" Range top  
#JGCP536HM

	30" RANGETOP JGCP430H	36" RANGETOP JGCP436H	48" RANGETOP JGCP548H
Height with G rates (J)	9" (22.9 cm)	9" (22.9 cm)	9" (22.9 cm)
Control Panel Height (K)	7-13/16" (19.8 cm)	7-13/16" (19.8 cm)	7-13/16" (19.8 cm)
Recessed Rangetop Height (L)	7" (17.8 cm)	7" (17.8 cm)	7" (17.8 cm)
Cooking Surface Height (M)	7-7/16" (18.9 cm)	7-7/16" (18.9 cm)	7-7/16" (18.9 cm)
Recessed Rangetop Depth (N)	21-7/8" (55.6 cm)	21-7/8" (55.6 cm)	21-7/8" (55.6 cm)
Depth with Control Panel (O)	25-1/2" (64.8 cm)	25-1/2" (64.8 cm)	25-1/2" (64.8 cm)

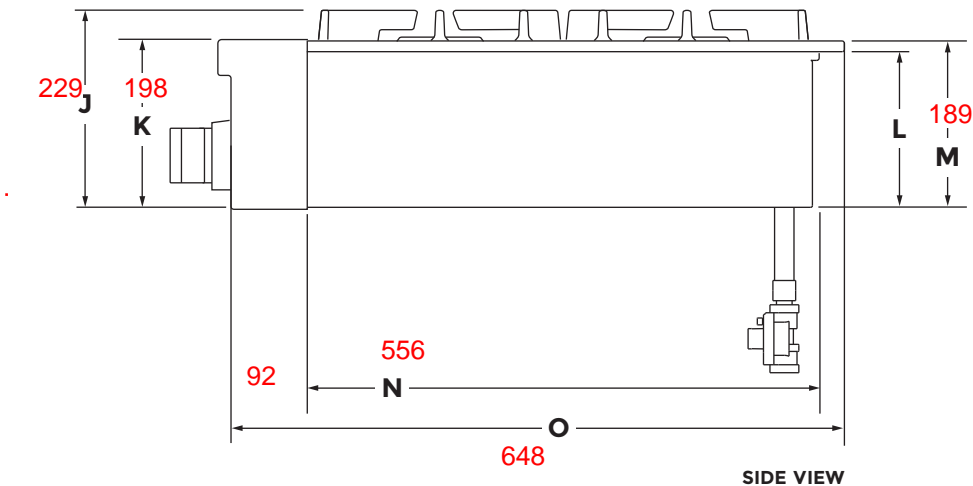

★ **IMPORTANT:** Supplied regulator does not come preattached and is pictured for reference purposes only.



DIMENSIONS

JENNAIR® RANGETOPS

OPENING AND CLEARANCE

36" Range top

#JGCP536HM

	30" RANGETOP JGCP430H	36" RANGETOP JGCP436H	48" RANGETOP JGCP548H
Combustible Area Above Cooking Surface Width (A)	30" (76.2 cm) min.	36" (91.4 cm) min.	48" (121.9 cm) min.
Bottom of Cabinet Height Above Cooking Surface (B)*	42" (106.7 cm) min.	58" (147.3 cm) min.	58" (147.3 cm) min.
Bottom of Cabinet Height Above Countertop (C)	18" (45.7 cm) min.	18" (45.7 cm) min.	18" (45.7 cm) min.
Distance to Fixed Wall or Combustible Material (D)	12" (30.5 cm) min.	12" (30.5 cm) min.	12" (30.5 cm) min.

\*Dimension reduced by 6" (15.2 cm) when bottom of wood or metal cabinet is covered by at least 1/4" (0.6 cm) flame retardant millboard, which is in turn covered with at least No. 28 MSG sheet metal, 0.015" (0.4 mm) stainless steel, 0.024"(0.6 mm) aluminum or 0.020" (0.5 mm) copper. If installing a hood above the rangetop, follow the hood instructions for dimensional clearances above the cooking surface.

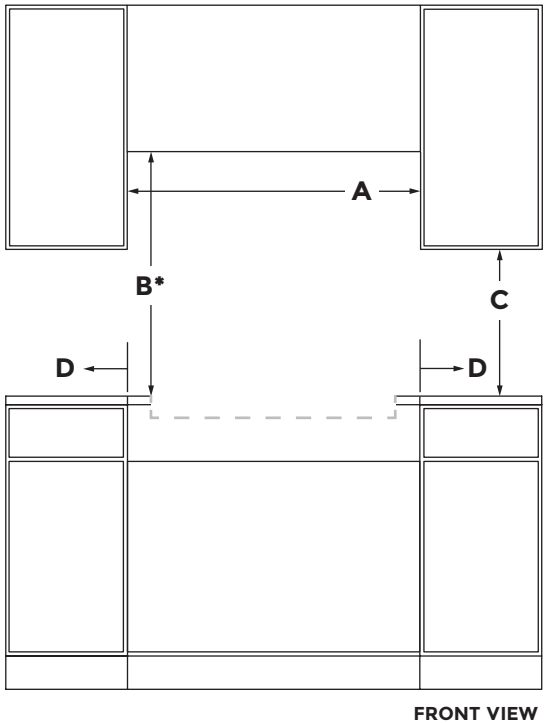

DIMENSIONS

JENNAIR® RANGETOPS

OPENING AND CLEARANCE

36" Range top

#JGCP536HM

	30" RANGETOP JGCP430H	36" RANGETOP JGCP436H	48" RANGETOP JGCP548H
Recommended Upper Cabinet Depth (E)	13" (33 cm)	13" (33 cm)	13" (33 cm)
Cutout to Wall Depth (F)*	1-1/2" (3.8 cm) min.	1-1/2" (3.8 cm) min.	1-1/2" (3.8 cm) min.
Cabinet to Countertop Height (G)	7-1/4" (18.4 cm)	7-1/4" (18.4 cm)	7-1/4" (18.4 cm)
Cabinet Depth (H)	24" (61 cm)	24" (61 cm)	24" (61 cm)

\*If the back wall is constructed of a combustible material and a backsplash is not installed, a 7-1/2" (19.1 cm) minimum clearance is required from the cutout or 6" (15.2 cm) minimum clearance from the back edge of the rangetop.

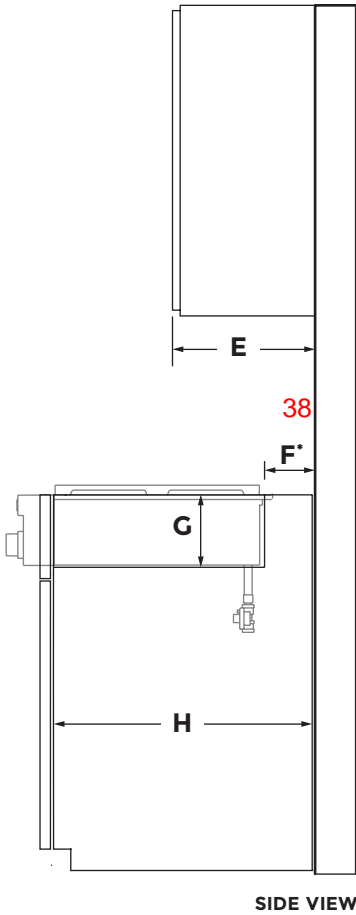

DIMENSIONS

JENNAIR® RANGETOPS

OPENING AND CLEARANCE

36" Range top

#JGCP536HM

	30" RANGETOP JGCP430H	36" RANGETOP JGCP436H	48" RANGETOP JGCP548H
Countertop and Cabinet Cutout Width (I)	29-1/4" (74.3 cm)	35-1/4" (89.5 cm)	47-3/8" (120.3 cm)
Countertop and Cutout Depth (J)	22-1/4" (56.5 cm)	22-1/4" (56.5 cm)	22-1/4" (56.5 cm)
Notch Width (K)	5/16" (0.8 cm)	5/16" (0.8 cm)	5/16" (0.8 cm)
Cutout Width (L)	29-7/8" (75.9 cm)	35-3/4" (90.8 cm)	47-7/8" (121.6 cm)

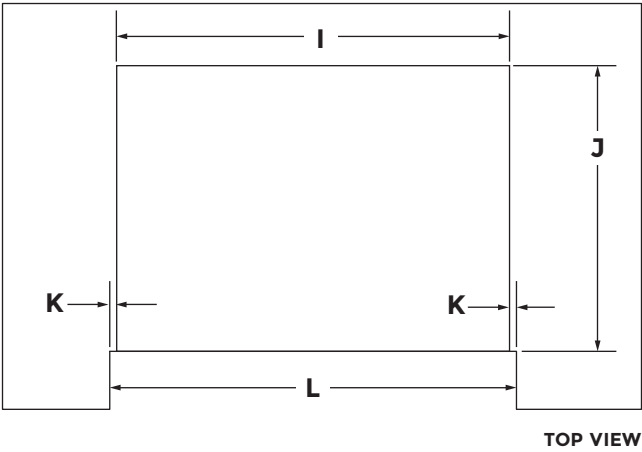

## 30"/27" WARMING DRAWERS

JWD3030E – 29<sup>3</sup>/<sub>4</sub>" x 10<sup>1</sup>/<sub>4</sub>" x 26<sup>1</sup>/<sub>4</sub>"JWD3027E – 26<sup>3</sup>/<sub>4</sub>" x 10<sup>1</sup>/<sub>4</sub>" x 26<sup>1</sup>/<sub>4</sub>"

## PRODUCT DIMENSIONS

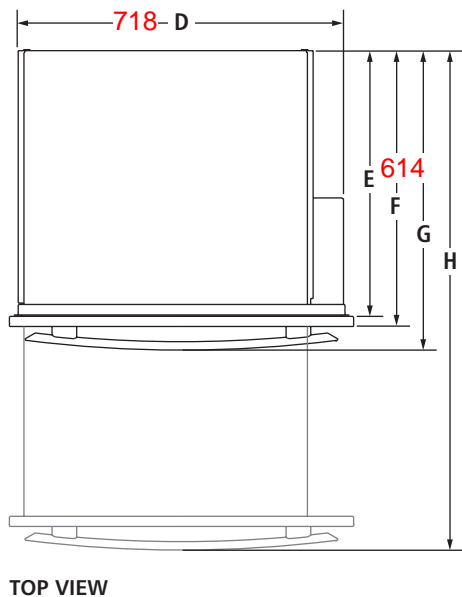
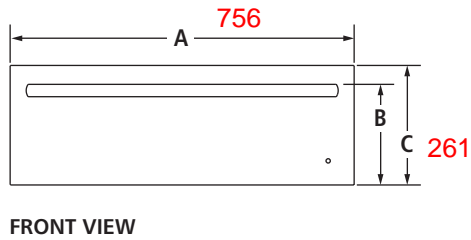

MODEL #		JWD3030E		JWD3027E	
		in	cm	in	cm
A	Overall width (max.)	29 <sup>3</sup> / <sub>4</sub>	75.6	26 <sup>3</sup> / <sub>4</sub>	67.9
	Height to top of handle				
B	Pro-Style® Stainless	9 <sup>1</sup> / <sub>8</sub>	23.2	—	—
	Euro-Style Stainless	9	23.0	9	23.0
	Custom panel (¾"/1.9 cm)	*	*	*	*
C	Overall height (max.)	10 <sup>1</sup> / <sub>4</sub>	26.1	10 <sup>1</sup> / <sub>4</sub>	26.1
D	Width of recessed warming drawer	28 <sup>1</sup> / <sub>4</sub>	71.8	25 <sup>1</sup> / <sub>4</sub>	64.1
E	Depth of recessed warming drawer	23 <sup>1</sup> / <sub>8</sub>	58.7	23 <sup>1</sup> / <sub>8</sub>	58.7
F	Depth with drawer	24 <sup>1</sup> / <sub>2</sub>	61.4	24 <sup>1</sup> / <sub>2</sub>	61.4
G	Depth with handle				
	Pro-Style® Stainless	26 <sup>7</sup> / <sub>8</sub>	68.1	—	—
	Euro-Style Stainless	26 <sup>1</sup> / <sub>4</sub>	66.6	26 <sup>1</sup> / <sub>4</sub>	66.6
	Custom panel (¾"/1.9 cm)	*	*	*	*
H	Depth with drawer fully open including handle				
	Pro-Style® Stainless	46 <sup>1</sup> / <sub>8</sub>	117.1	—	—
	Euro-Style Stainless	45 <sup>1</sup> / <sub>2</sub>	115.6	45 <sup>1</sup> / <sub>2</sub>	115.6
	Custom panel (¾"/1.9 cm)	*	*	*	*

\*These dimensions to be determined by the custom cabinet maker.

**IMPORTANT:** Dimensional specifications are provided for planning purposes only.

**Do not make any cutouts based on this information.** Refer to the Installation Guide *before* selecting cabinetry, verifying electrical/gas connections, making cutouts or beginning installation. All Jenn-Air® appliances are appropriately UL, CUL or CSA approved.

## 30"/27" WARMING DRAWERS

JWD3030E – 29<sup>3</sup>/<sub>4</sub>" x 10<sup>1</sup>/<sub>4</sub>" x 26<sup>1</sup>/<sub>4</sub>"JWD3027E – 26<sup>3</sup>/<sub>4</sub>" x 10<sup>1</sup>/<sub>4</sub>" x 26<sup>1</sup>/<sub>4</sub>"

## DIMENSIONS AS INSTALLED

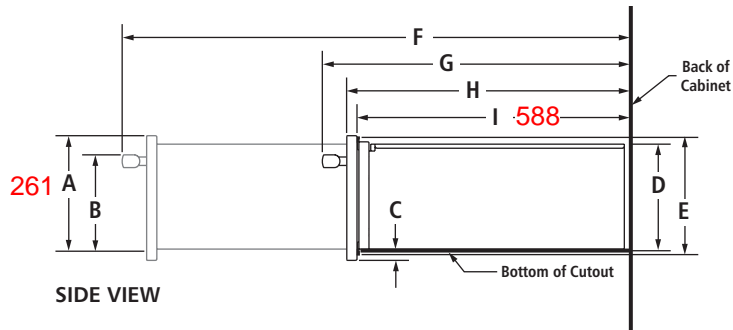

MODEL #		JWD3030E		JWD3027E	
		in	cm	in	cm
<b>A</b>	Height to top of drawer (max.)	10 <sup>1</sup> / <sub>4</sub>	26.1	10 <sup>1</sup> / <sub>4</sub>	26.1
<b>B</b>	Height to top of handle Pro-Style® Stainless	8 <sup>5</sup> / <sub>8</sub>	21.9	—	—
	Euro-Style Stainless	8 <sup>1</sup> / <sub>2</sub>	21.5	8 <sup>1</sup> / <sub>2</sub>	21.5
	Custom panel (¾"/1.9 cm)	*	*	*	*
<b>C</b>	Height of drawer extending below cutout	5 <sup>5</sup> / <sub>8</sub>	1.6	5 <sup>5</sup> / <sub>8</sub>	1.6
<b>D</b>	Height of recessed warming drawer	9	23.0	9	23.0
<b>E</b>	Height of warming drawer flange	9 <sup>7</sup> / <sub>8</sub>	25.0	9 <sup>7</sup> / <sub>8</sub>	25.0
<b>F</b>	Depth with drawer fully open including handle Pro-Style® Stainless	46 <sup>1</sup> / <sub>8</sub>	117.1	—	—
	Euro-Style Stainless	45 <sup>1</sup> / <sub>2</sub>	115.6	45 <sup>1</sup> / <sub>2</sub>	115.6
	Custom panel (¾"/1.9 cm)	*	*	*	*
<b>G</b>	Depth with handle Pro-Style® Stainless	26 <sup>7</sup> / <sub>8</sub>	68.1	—	—
	Euro-Style Stainless	26 <sup>1</sup> / <sub>4</sub>	66.6	26 <sup>1</sup> / <sub>4</sub>	66.6
	Custom panel (¾"/1.9 cm)	*	*	*	*
<b>H</b>	Depth with drawer	24	61.0	24	61.0
<b>I</b>	Depth of recessed warming drawer	23 <sup>1</sup> / <sub>8</sub>	58.8	23 <sup>1</sup> / <sub>8</sub>	58.8

\*These dimensions to be determined by the custom cabinet maker.

**IMPORTANT:** Dimensional specifications are provided for planning purposes only.

**Do not make any cutouts based on this information.** Refer to the Installation Guide *before* selecting cabinetry, verifying electrical/gas connections, making cutouts or beginning installation. All Jenn-Air® appliances are appropriately UL, CUL or CSA approved.

## 30"/27" WARMING DRAWERS

JWD3030E – 29¾" x 10¼" x 26¼"

JWD3027E – 26¾" x 10¼" x 26¼"

## OPENING/CLEARANCE DIMENSIONS

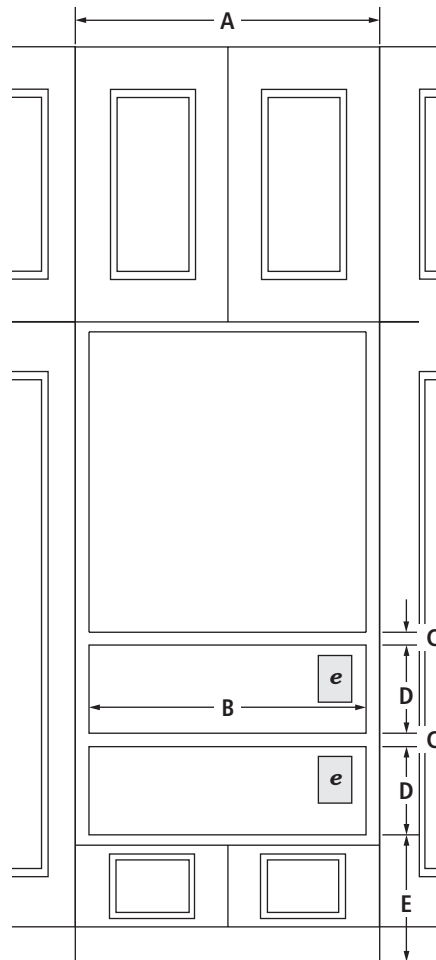

FRONT VIEW

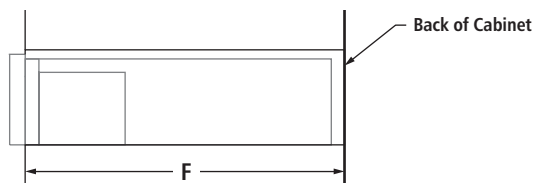

SIDE VIEW

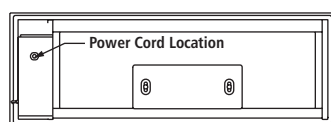

BACK VIEW

MODEL #		JWD3030E		JWD3027E	
		in	cm	in	cm
<b>A</b>	Width of cabinet (min.)	30	76.2	27	68.6
<b>B</b>	Width of cutout	28½	72.4	25½	64.8
<b>C</b>	Height between cutouts (min.)	2½	6.4	2½	6.4
<b>D</b>	Height of cutout	9⅞	23.2	9⅞	23.2
<b>E</b>	Bottom of cutout to floor (recommended)	4¼	10.8	4¼	10.8
	Bottom of cutout to floor (min.)	1	2.5	1	2.5
<b>F</b>	Depth of cutout (min.)	24	61.0	24	61.0
<b>e</b>	Recommended outlet location				

## ELECTRICAL REQUIREMENTS

120 volt, 60 Hz, AC only, 15-amp fused, electrical circuit is required. A dedicated circuit is recommended.

If the outlet is on the rear wall behind the warming drawer, it must be recessed and located in the upper right-hand corner. If outlet is located in an adjacent cabinet, drill a 1⅞" (3.5 cm) minimum diameter hole in the side wall or support surface to access the power supply cord.

**C 64** LOCATION REQUIREMENTS

**232** Support surface must be solid, level and flush with the bottom of the cabinet cutout. The warming drawer must be leveled before completing installation.

**IMPORTANT:** Dimensional specifications are provided for planning purposes only.

**Do not make any cutouts based on this information.** Refer to the Installation Guide *before* selecting cabinetry, verifying electrical/gas connections, making cutouts or beginning installation. All Jenn-Air® appliances are appropriately UL, CUL or CSA approved.

## 30"/27" WARMING DRAWERS – FLUSH INSTALLATION

JWD3030E – 29¾" x 10¼" x 24½" (depth without handle)

JWD3027E – 26¾" x 10¼" x 24½" (depth without handle)

## OPENING/CLEARANCE DIMENSIONS

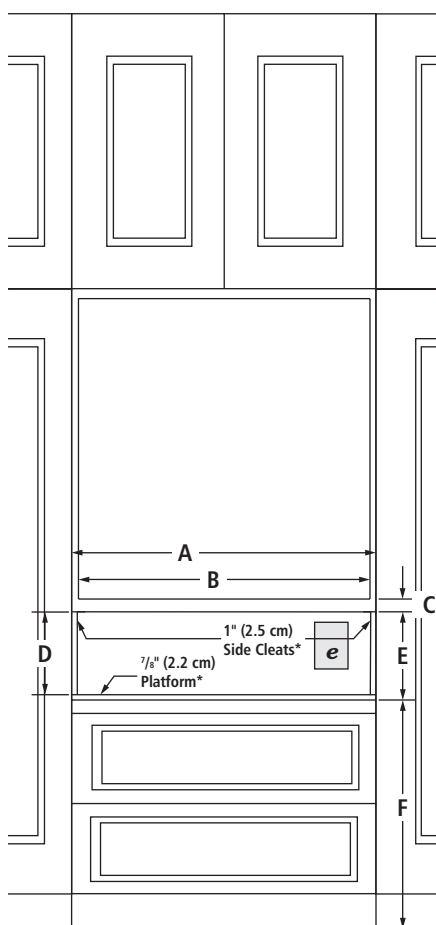

FRONT VIEW

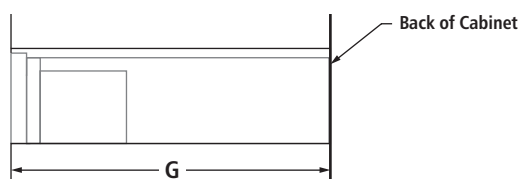

SIDE VIEW

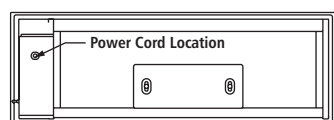

BACK VIEW

MODEL #		JWD3030E		JWD3027E	
		in	cm	in	cm
<b>A</b>	Width of flush inset cutout (min.)	30¼	76.8	27¼	69.2
<b>B</b>	Width of opening (min.)	28¼	71.8	25¼	64.1
<b>C</b>	Height between cutouts (min.)	2½	6.4	2½	6.4
<b>D</b>	Height of opening (min.)	9⅞	23.2	9⅞	23.2
<b>E</b>	Height of flush inset cutout (min.)	10¾	27.3	10¾	27.3
<b>F</b>	Bottom of cutout to floor (recommended)	8¼	21.0	8¼	21.0
	Bottom of cutout to floor (min.)	5	12.7	5	12.7
<b>G</b>	Depth of cutout (min.)	25	63.5	25	63.5
<b>e</b>	Recommended outlet location				

## ELECTRICAL REQUIREMENTS

120 volt, 60 Hz, AC only, 15-amp fused, electrical circuit is required. A dedicated circuit is recommended.

If the outlet is on the rear wall behind the warming drawer, it must be recessed and located in the upper right-hand corner. If outlet is located in an adjacent cabinet, drill a 1⅝" (3.5 cm) minimum diameter hole in the side wall or support surface to access the power supply cord.

## LOCATION REQUIREMENTS

Support surface must be solid, level and flush with the bottom of the cabinet cutout. The warming drawer must be leveled before completing installation.

## FLUSH INSTALLATION REQUIREMENTS

A 25" (63.5 cm) minimum cutout depth is required.

These dimensions will result in a ¼" (0.6 cm) reveal on all sides of the warming drawer.

The front face of the cleats and platforms will be visible and should be treated as a finished surface.

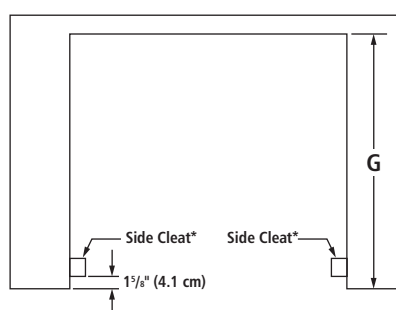

TOP VIEW

\*Cleats and platform must be recessed 1⅝" (4.1 cm) from the front of the cabinet.

**IMPORTANT:** Dimensional specifications are provided for planning purposes only.

**Do not make any cutouts based on this information.** Refer to the Installation Guide *before* selecting cabinetry, verifying electrical/gas connections, making cutouts or beginning installation. All Jenn-Air® appliances are appropriately UL, CUL or CSA approved.

# INSTALLATION REQUIREMENTS

## Tools and Parts

Gather the required tools and parts before starting installation. Read and follow the instructions provided with any tools listed here.

### Tools needed

- Phillips screwdriver
- Flat-blade screwdriver
- Measuring tape
- Level
- Drill
- 1<sup>3</sup>/<sub>8</sub>" (3.5 cm) hole saw

### Parts supplied

- Two #8-18 x 1<sup>1</sup>/<sub>2</sub>" screws
- Lens (for panel ready models)

Check local codes. Check existing electrical supply. See "Electrical Requirements."

It is recommended that all electrical connections be made by a licensed, qualified electrical installer.

## Location Requirements

**IMPORTANT:** Observe all governing codes and ordinances.

- Cutout dimensions that are shown must be used. Given dimensions provide minimum clearance with warming drawer.
- Recessed installation area must provide complete enclosure around the recessed portion of the warming drawer.
- Grounded electrical supply is required. See "Electrical Requirements" section.
- Electrical supply outlet should be located in the rear wall on the upper right-hand side of the cutout or in an adjacent cabinet. The outlet must be recessed. If the electrical outlet is located in an adjacent cabinet, a 1<sup>3</sup>/<sub>8</sub>" (3.5 cm) minimum diameter hole should have been drilled in the back of the cutout or support surface to pass the power supply cord through to the outlet.
- Warming drawer support surface must be solid, level, and flush with bottom of cabinet cutout.
- Warming drawers with oiled bronze, black glass, and white glass panels are approved for indoor use only.
- Support surface must be solid, level, and flush with the bottom of the cabinet cutout.
- 24" (61.0 cm) minimum cabinet depth.

For best performance results make sure the warming drawer is leveled before completing installation. There is no way to level the warming drawer after it has been installed. If the installation is not level, the door may slide open or not seal tightly, allowing heat to escape.

**NOTE:** If installing the warming drawer below another product, refer to that product's literature for any installation requirements.

## Product Dimensions

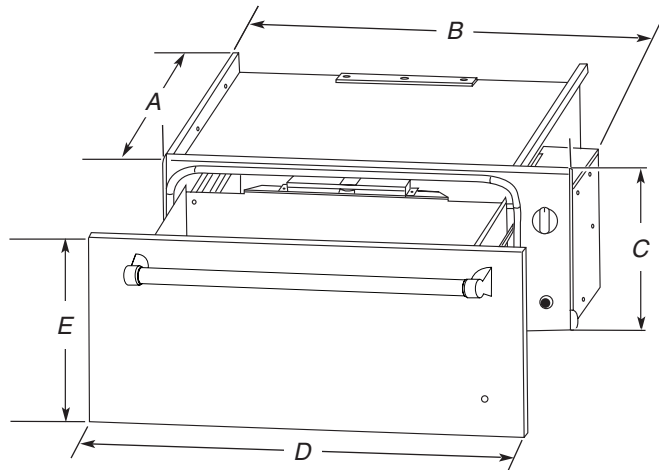

WARMING DRAWER SIZE	OVEN DEPTH (A)	RECESSED WIDTH (B)	RECESSED HEIGHT (C)	OVERALL WIDTH (D)	DRAWER FRONT HEIGHT (E)
24" (60.9 cm)	23 <sup>1</sup> / <sub>8</sub> " (58.7 cm)	22 <sup>1</sup> / <sub>4</sub> " (56.5 cm)	9" (22.9 cm)	23 <sup>3</sup> / <sub>4</sub> " (60.3 cm)	10 <sup>1</sup> / <sub>4</sub> " (26.1 cm)
27" (68.6 cm)	23 <sup>1</sup> / <sub>8</sub> " (58.7 cm)	25 <sup>1</sup> / <sub>4</sub> " (64.1 cm)	9" (22.9 cm)	26 <sup>3</sup> / <sub>4</sub> " (67.9 cm)	10 <sup>1</sup> / <sub>4</sub> " (26.1 cm)
30" (76.2 cm)	23 <sup>1</sup> / <sub>8</sub> " (58.7 cm)	28 <sup>1</sup> / <sub>4</sub> " (71.8 cm)	9" (22.9 cm)	29 <sup>3</sup> / <sub>4</sub> " (75.6 cm)	10 <sup>1</sup> / <sub>4</sub> " (26.1 cm)



## 30" Oven-#JJW3430LM

- Floor must be able to support a double oven weight of 357 lbs (162 kg).

**IMPORTANT:** To avoid damage to your cabinets, check with your builder or cabinet supplier to make sure that the materials used will not discolor, delaminate, or sustain other damage. This oven has been designed in accordance with the requirements of UL and CSA International and complies with the maximum allowable wood cabinet temperatures of 194°F (90°C).

### Undercounter Installation (with Cooktop Installed Above):

Refer to the Cutout Dimensions for Ovens Installed Under Cooktop (separate sheet). See product website for list of cooktop models approved for use above select wall-oven models.

### Product Dimensions - Single Ovens

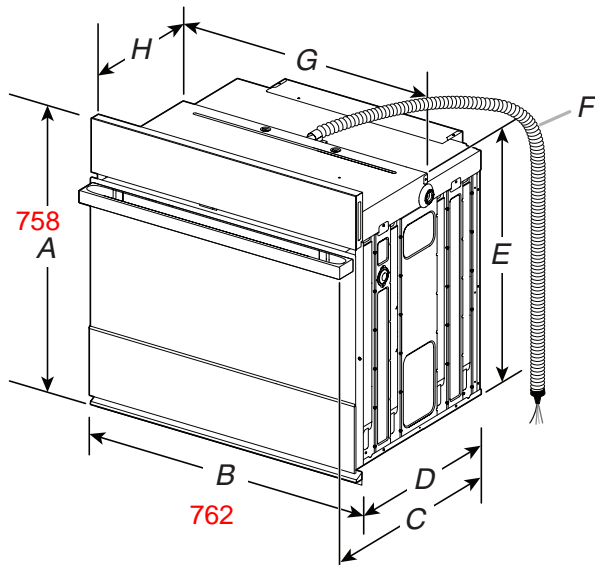

- A. 29<sup>7</sup>/<sub>8</sub>" (75.8 cm) max. overall height
- B. 30" (76.2 cm) overall width
- C. **JJW3430IM - 26<sup>3</sup>/<sub>8</sub>" (67 cm)**  
JJW3430IL - 27<sup>3</sup>/<sub>16</sub>" (69 cm)
- D. 23<sup>1</sup>/<sub>4</sub>" (59.1 cm) max. recessed depth
- E. 27<sup>3</sup>/<sub>16</sub>" (69 cm) recessed height
- F. 48" (121.9 cm) flexible conduit length
- G. 28<sup>7</sup>/<sub>16</sub>" (72.2 cm) max. recessed width
- H. 12" (30.5 cm) from back of control panel to start of strain relief

### Cabinet Dimensions - Single Ovens

#### Single Oven Undercounter (Without Cooktop Installed Above)

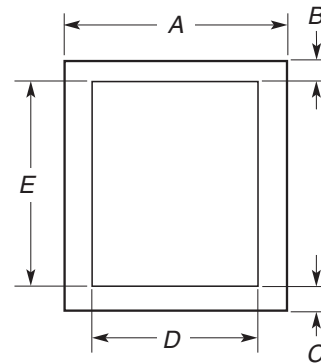

- A. 30" (76.2 cm) min. cabinet width
- B. 1<sup>1</sup>/<sub>2</sub>" (3.8 cm) min. top of cutout to underside of countertop
- C. 5<sup>1</sup>/<sub>4</sub>" (13.3 cm) bottom of cutout to floor
- D. 28<sup>1</sup>/<sub>2</sub>" (72.4 cm) cutout width
- E. 28" (71.2 cm) min. cutout height

#### Single Ovens Installed in Cabinet

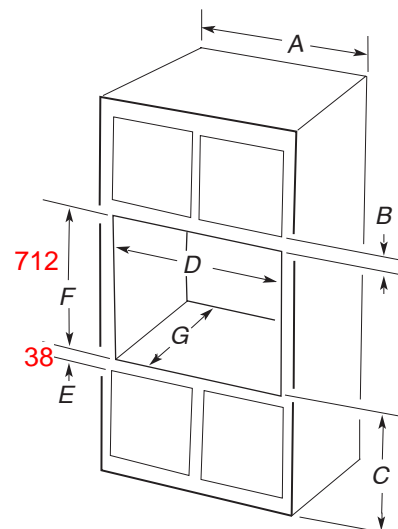

- A. 30" (76.2 cm) min. cabinet width
- B. 2<sup>3</sup>/<sub>16</sub>" (5.5 cm) top of cutout to bottom of upper cabinet door
- C. 32" (81.3 cm) bottom of cutout to floor
- D. 28<sup>1</sup>/<sub>2</sub>" (72.4 cm) cutout width
- E. 1<sup>1</sup>/<sub>2</sub>" (3.8 cm) min. bottom of cutout to top of cabinet door
- F. 28" (71.2 cm)\* recommended cutout height
- G. 24" (60.7 cm) cutout depth

\* **NOTE:** The cutout height can be between 27<sup>1</sup>/<sub>4</sub>" and 29<sup>7</sup>/<sub>16</sub>" (69.2 cm and 74.8 cm) for single ovens.

# 30" Microwave #JMC2430LM

## INSTALLATION REQUIREMENTS

### Tools and Parts

Gather the required tools and parts before starting installation. Read and follow the instructions provided with any tools listed here.

#### Tools Needed

- Phillips screwdriver
- Flat-blade screwdriver
- Measuring tape
- Level
- Drill (for wall cabinet installations)
- 1/8" (3 mm) drill bit (for wall cabinet installations)
- 1" (2.5 cm) drill bit (for wall cabinet installations)

#### Parts Needed

- UL listed or CSA approved conduit connector
- UL listed wire connectors

#### Parts Needed – Flush Installation

- W10801485 Stainless steel flush installation kit for 27" (68.6 cm) models
- W10801486 Stainless steel flush installation kit for 30" (76.2 cm) models
- W10801487 Black flush installation kit for 30" (76.2 cm) models

To order, see the "Assistance or Service" section of the Use and Care Guide.

#### Parts Supplied

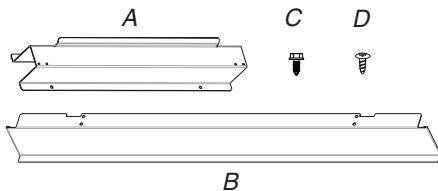

- A. Spacer bars (2)
- B. Bottom vent (1)
- C. 3/8" (9.5 mm) hex-head washer screws (4)
- D. 3/4" (1.9 cm) pan-head screws (4)

Check local codes. Check existing electrical supply. See "Electrical Requirements."

It is recommended that all electrical connections be made by a licensed, qualified electrical installer.

### Location Requirements

**IMPORTANT:** Observe all governing codes and ordinances.

- Cabinet opening dimensions that are shown must be used. Given dimensions provide minimum clearance with microwave oven.
- Recessed installation area must provide complete enclosure around the recessed portion of the microwave oven.
- Grounded electrical supply is required. See "Electrical Requirements" section.
- Electrical supply junction box should be located 3" (7.6 cm) maximum below the support surface when the microwave oven is installed in a wall cabinet. A 1" (2.5 cm) minimum diameter hole should have been drilled in the left rear corner of the support surface to pass the appliance cable through to the junction box.

- For installation above single built-in oven, the junction box must be located inside upper cabinet.
- If you are installing the junction box on rear wall behind the microwave oven, the junction box must be recessed and located in the upper or lower right or left corner of the cabinet; otherwise, the microwave oven will not fit into the cabinet opening.
- Microwave oven support surface must be solid, level, and flush with bottom of cabinet cutout. Floor must be able to support a weight of 108 lbs (49.0 kg).

**IMPORTANT:** To avoid damage to your cabinets, check with your builder or cabinet supplier to make sure that the materials used will not discolor, delaminate, or sustain other damage. This oven has been designed in accordance with the requirements of UL and CSA International and complies with the maximum allowable wood cabinet temperatures of 194°F (90°C).

### Product Dimensions

#### 27" (68.6 cm) and 30" (76.2 cm) Microwave Ovens

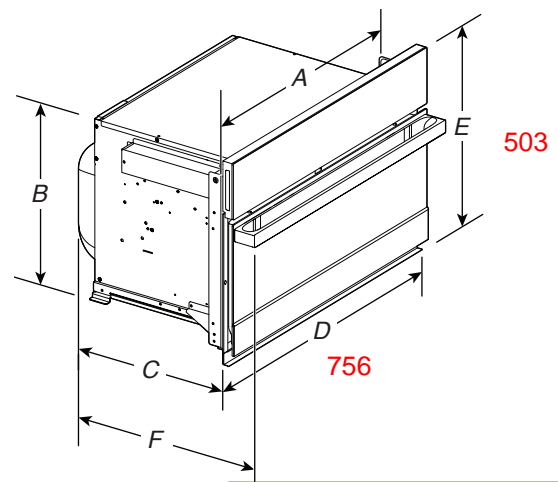

#### 27" (68.6 cm) models

- A. 25<sup>3</sup>/<sub>8</sub>" (64.5 cm)
- B. 17<sup>3</sup>/<sub>8</sub>" (44.1 cm)
- C. 22<sup>1</sup>/<sub>16</sub>" (57.7 cm)
- D. 26<sup>3</sup>/<sub>4</sub>" (68.0 cm) overall width
- E. 19<sup>7</sup>/<sub>8</sub>" (50.3 cm) overall height
- F. JMC2427IM: 25<sup>3</sup>/<sub>16</sub>" (64.9 cm)  
JMC2427IL: 24<sup>3</sup>/<sub>4</sub>" (62.9 cm)

#### 30" (76.2 cm) models

- A. 28<sup>3</sup>/<sub>8</sub>" (72.1 cm)
- B. 17<sup>3</sup>/<sub>8</sub>" (44.1 cm)
- C. 22<sup>1</sup>/<sub>16</sub>" (57.7 cm)
- D. 29<sup>3</sup>/<sub>4</sub>" (75.6 cm) overall width
- E. 19<sup>7</sup>/<sub>8</sub>" (50.3 cm) overall height
- F. JMC2430IM: 25<sup>3</sup>/<sub>16</sub>" (64.9 cm)  
JMC2430IL: 24<sup>3</sup>/<sub>4</sub>" (62.9 cm)

#### 27" (68.6 cm) and 30" (76.2 cm) Microwave Oven Spacer Kit

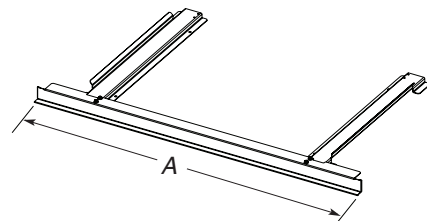

#### 27" (68.6 cm) models

- A. 26<sup>3</sup>/<sub>4</sub>" (67.9 cm) overall width

#### 30" (76.2 cm) models

- A. 29<sup>3</sup>/<sub>4</sub>" (75.6 cm) overall width

**NOTE:** The microwave oven spacer kit will allow the microwave oven to be installed in a 17<sup>3</sup>/<sub>8</sub>" to 17<sup>3</sup>/<sub>4</sub>" (44.1 to 45.1 cm) maximum cutout height.

A microwave oven spacer kit is available from your dealer that will allow the microwave oven to be installed in a 19" to 19<sup>13/16</sup>" (48.3 to 50.2 cm) maximum cutout height. Match the oven size to the following kits:

■ 27" (68.6 cm) Stainless Steel – Model W10469901

■ 30" (76.2 cm) Stainless Steel – Model W10469903

To order, see the "Assistance or Service" section of the Use and Care Guide.

## Cabinet Dimensions

### 27" (68.6 cm) and 30" (76.2 cm) Microwave Ovens

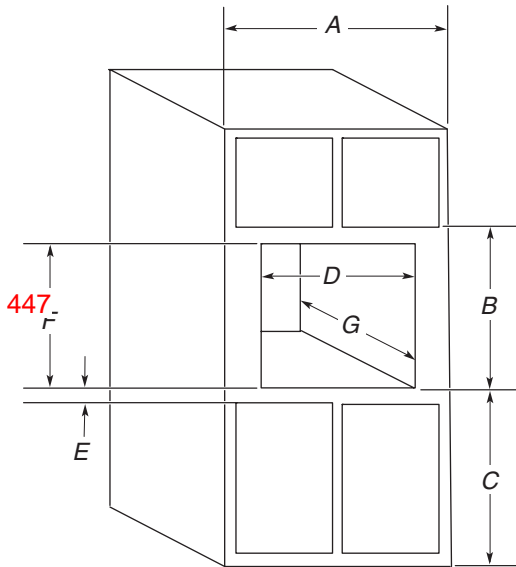

#### 27" (68.6 cm) models

- A. 27" (68.6 cm) minimum cabinet width
- B. 19<sup>7/8</sup>" (50.3 cm) from bottom of cutout to bottom of upper cabinet door
- C. 40" (101.6 cm) bottom of cutout to floor (recommended)
- D. 25<sup>1/2</sup>" (64.8 cm) cutout width
- E. 1<sup>1/2</sup>" (3.8 cm) minimum bottom of cutout to top of cabinet door
- F. 17<sup>5/8</sup>" (44.7 cm) recommended cutout height (will fit cutout height from 17<sup>3/8</sup>" [44.1 cm] to 17<sup>3/4</sup>" [45.1 cm])
- G. 21<sup>7/8</sup>" (55.5 cm) minimum cutout depth

#### 30" (76.2 cm) models

- A. 30" (76.2 cm) minimum cabinet width
- B. 19<sup>7/8</sup>" (50.3 cm) from bottom of cutout to bottom of upper cabinet door
- C. 40" (101.6 cm) bottom of cutout to floor (recommended)
- D. 28<sup>1/2</sup>" (72.4 cm) cutout width
- E. 1<sup>1/2</sup>" (3.8 cm) minimum bottom of cutout to top of cabinet door
- F. 17<sup>5/8</sup>" (44.7 cm) recommended cutout height (will fit cutout height from 17<sup>3/8</sup>" [44.1 cm] to 17<sup>3/4</sup>" [45.1 cm])
- G. 21<sup>7/8</sup>" (55.5 cm) minimum cutout depth

## Minimum Installation Clearances

For proper installation, the following minimum clearances must exist above and below the cabinet opening.

## Installation Above Single Built-In Oven

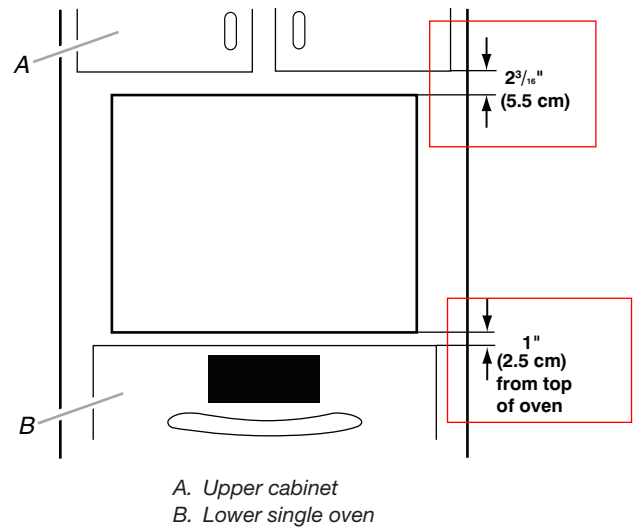

## Electrical Requirements

### GROUNDING INSTRUCTIONS

#### For a permanently connected microwave oven:

The microwave oven must be connected to a grounded, metallic, permanent wiring system, or an equipment grounding conductor should be run with the circuit conductors and connected to the equipment grounding terminal or lead on the microwave oven.

### SAVE THESE INSTRUCTIONS

If codes permit and a separate ground wire is used, it is recommended that a qualified electrical installer determine that the ground path and wire gauge are in accordance with local codes.

Check with a qualified electrical installer if you are not sure the oven is properly grounded.

This oven must be connected to a grounded metal, permanent wiring system.

Be sure that the electrical connection and wire size are adequate and in conformance with the National Electrical Code, ANSI/NFPA 70 – latest edition or CSA Standards C22.1-94, Canadian Electrical Code, Part 1 and C22.2 No. O-M91 – latest edition, and all local codes and ordinances.

A copy of the above code standards can be obtained from:

National Fire Protection Association  
1 Batterymarch Park  
Quincy, MA 02169-7471  
CSA International  
8501 East Pleasant Valley Road  
Cleveland, OH 44131-5575

### Electrical Connection

To properly install your microwave oven, you must determine the type of electrical connection you will be using and follow the instructions provided for it here.

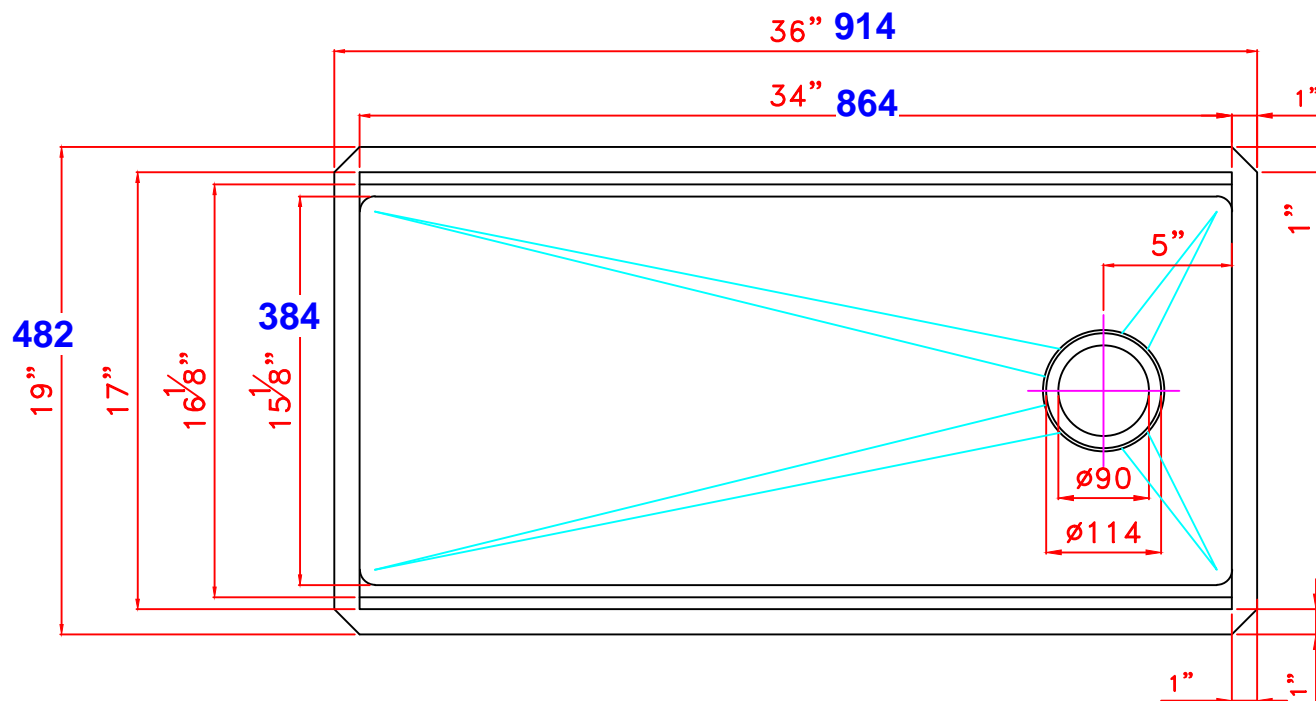

NO. : WSR3619-BLK

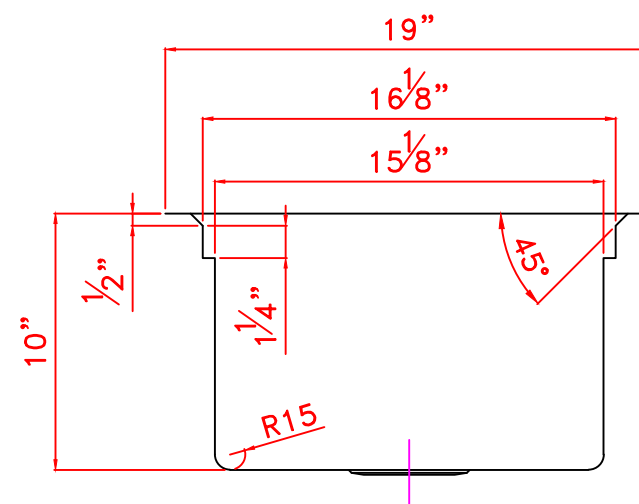
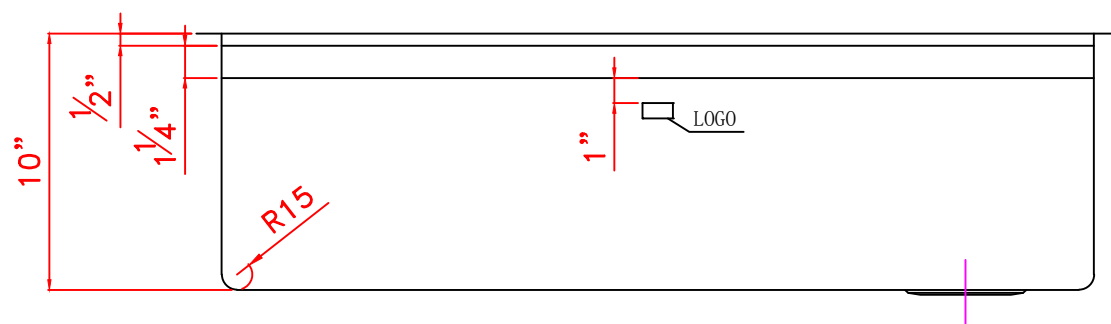

## G 7566 SCVi 24" Fully Integrated Dishwasher

### Features:

- AutoDos
- 3D MultiFlex Cutlery Tray
- QuickIntenseWash
- WifiConn@ct
- DirectSensor Controls
- Panel-Ready
- Water Softener



SPECIFICATIONS	
Overall Unit Dimensions	23 <sup>9</sup> / <sub>16</sub> " (598 mm) W x 33 <sup>11</sup> / <sub>16</sub> " - 36 <sup>1</sup> / <sub>4</sub> " (855 - 920 mm) H x 22 <sup>7</sup> / <sub>16</sub> " (570 mm) D [Depth does not include door panel]
Niche	
Minimum Cabinet Niche Opening	23 <sup>5</sup> / <sub>8</sub> " (600 mm) W x 33 <sup>3</sup> / <sub>4</sub> " (857 mm) H x 22 <sup>7</sup> / <sub>16</sub> " (570 mm) D
Plumbing	
Water Supply Requirements	<ul style="list-style-type: none"> <li>• Cold or Hot (max 150°F/65°C) water connection</li> <li>• Male 3/8" compression fitting</li> <li>• Water pressure range 7.25 psi (0.5 bar) and 145 psi (10 bar)</li> </ul>
Water Connection Line (Supplied)	Length: 5 ft (1.5 m) Female 3/8" compression.
Drain Hose (Supplied)	Length: 5 ft (1.5 m) 7/8" (22 mm) internal diameter
Electrical	
Electrical Requirements	110V / 120V, 60Hz, 15 Amps
Power Cord (Convertible to hardwire)	NEMA 5-15 plug, 5 ft (1.52 m)
Shipping	
Shipping Weight	121 lbs (55 kg)
Shipping Dimensions	27 <sup>1</sup> / <sub>8</sub> " W x 38 <sup>1</sup> / <sub>8</sub> " H x 26 <sup>3</sup> / <sub>8</sub> " D

### PRODUCT DIMENSIONS

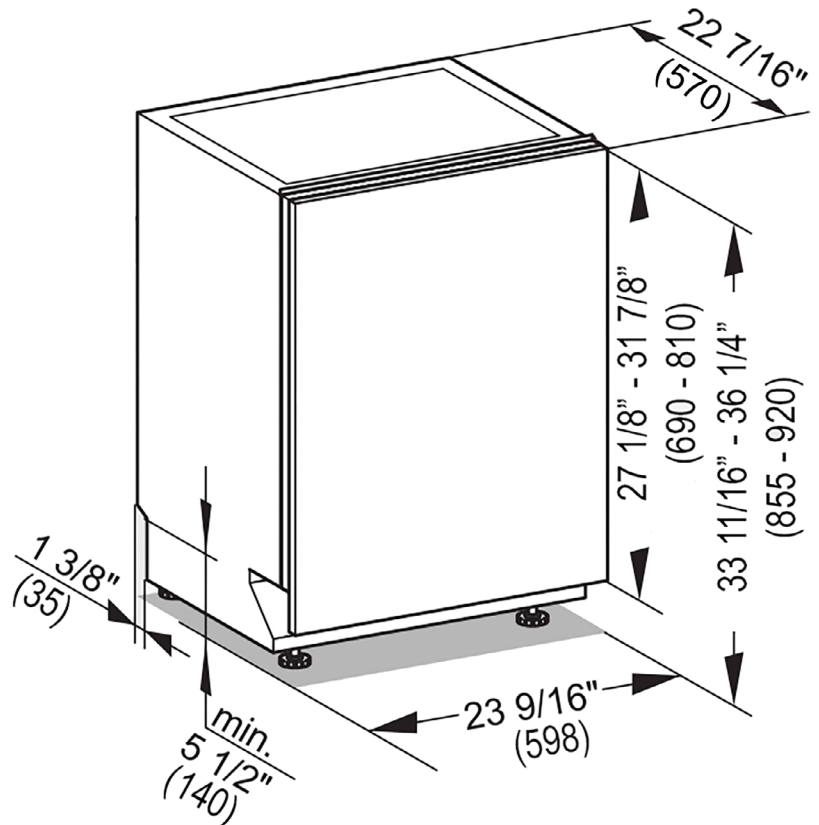

## CUTOUT DIMENSIONS

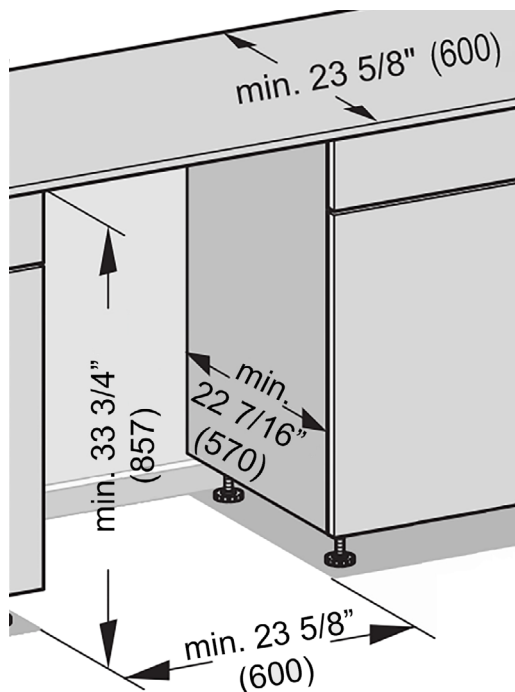

## CUSTOM PANEL

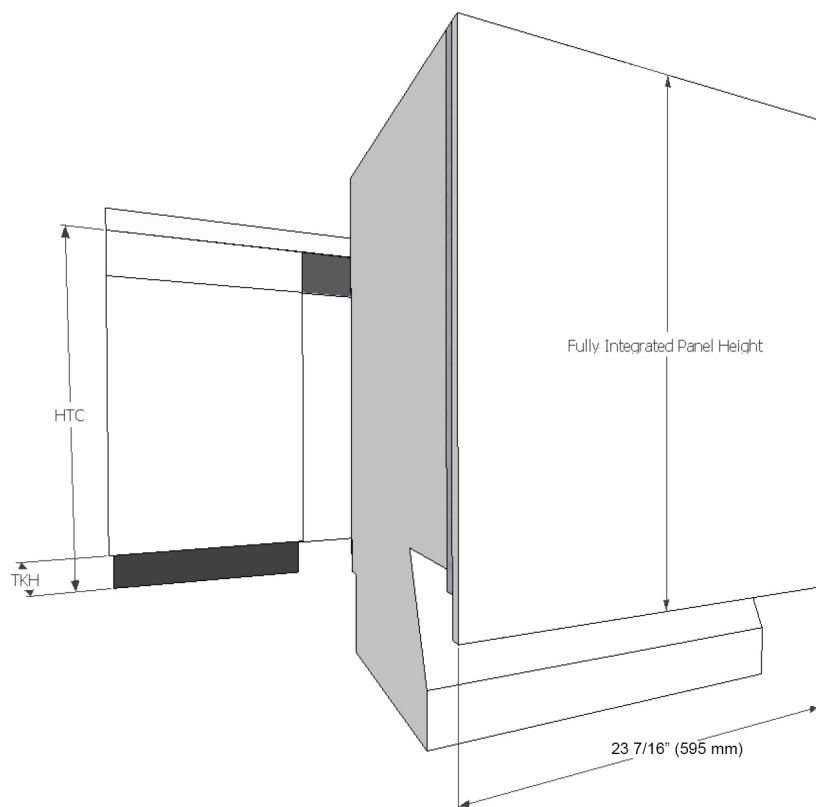

**Width:** 23 7/16" (595 mm) in all Cases  
**Thickness:** 3/4" (19 mm) in all Cases  
**Height:** Determined using the following calculation:

$$\text{Panel Height} = \text{HTC} - \text{TKH}$$

**HTC** = Height to the underside of countertop  
**TKH** = Toe kick height

**Note:** Control panel is along the top edge of the unit. It is not visible when the unit is closed. A handle **MUST** be located on front of panel in order to open unit. (Except K2o models).

Maximum panel height: 31 7/8" (810 mm)

Minimum panel height: 27 1/8" (690 mm)

Maximum panel weight: 26 lbs (12 kg)

## MODEL

Dual Zone Wine Cooler  
Black Stainless Steel

PRW24C02BBSG

Size	24"
Dimensions	23-7/8"W x 33-7/8"H x 23-5/8"D
Weight	129lbs.
Installation Type	Compact / Built-in / Freestanding
Refrigerant Type	R600a

## FEATURES

Capacity	45 bottles (750 ml)
Volume	5.2 cu/ft
Temperature Range	40° - 65° F (both zones)
Sound Level	39 dBA
Door Finish	Black Stainless + Glass
Cabinet Finish	Black
Interior Finish	Black
Field-Reversible Door	Yes
Zero-Clearance Door Hinge	Yes
Door Glass	Dual-pane, Low-e Argon-filled
Shelving	5 full-extension, black wood racks w/ black stainless trim
Controls	Electronic Capacitive Touch
Lighting	3-Color LED Cloud White, Deep Blue, Amber
Door Open Alarm	Yes, after 3 minutes
Sabbath Mode	Yes
Air Filtration	Yes, w/ carbon filter
PreciseTemp™	Yes
Active Cooling Technology	Yes
Vibration Dampening System	Yes

AC POWER	115V, 60Hz at Max. 1.5A
----------	-------------------------

## OPTIONAL ACCESSORIES

Contemporary Handle Kit	PRHAN-C102 (Brushed Gold)
Contemporary Handle Kit	PRHAN-C104 (Matte Black)

WARRANTY	2 years parts, 5 years compressor 1 year labor
----------	---

## DID YOU KNOW?

The designated 7 bottle capacity rack easily stores large diameter bottles such as Pinot Noir, Chardonnay, and Champagne.

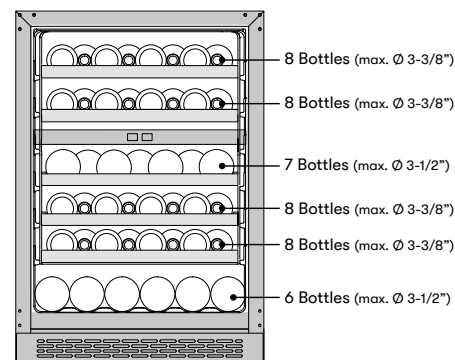
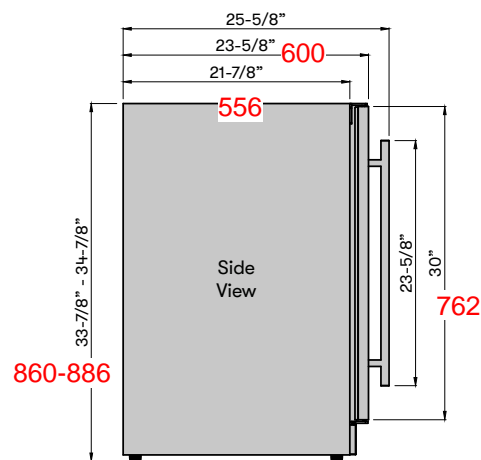
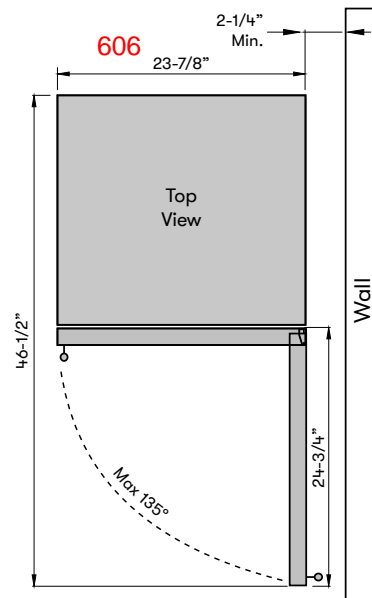

## Transforming the Kitchen through Design, Discovery, and Care

Specifications subject to change, check zephyronline.com for up-to-date information.  
Zephyr | 2277 Harbor Bay Parkway, Alameda, CA 94502 | 888.880.8368